

PRODUCT NO
10019594-001
10019594-001LF

NOTES: (UNLESS OTHERWISE SPECIFIED)

1. MATERIALS:

A. HOUSING: 30 PERCENT GLASS FILLED LCP.  
COLOUR: BLACK

B. CONTACTS: PHOSPHOR BRONZE.

PLATING: 50u" Ni UNDERPLATE OVERALL WITH ONE OF THE FOLLOWING:

A. 2~5 u" GOLD FLASH OVERALL

B. SELECTIVE GOLD FLASH 2~5u" ON CONTACT AREA AND 75u" TIN-LEAD ON SOLDER TAILS (NOTE 7 NOT APPLICABLE)

2. RELIABLE CONTACT FORCE SHALL BE MET.

▲A. CONTACT FORCE: 65±35 GRAMS EACH CONTACT AT A WORKING HEIGHT OF 2.11mm ABOVE DATUM 'C'.

B. CONTACT CURRENT RATING: 1 AMP MINIMUM.

C. CONTACT RETENTION: 200 GRAMS MINIMUM PER CONTACT.

3. FLASH MUST REMAIN WITHIN THE SIZE LIMITS ESTABLISHED BY THE TOLERANCE. NO FLASH IS ALLOWED ON DATUM SURFACES AND LOOSE FLASH MUST BE REMOVED. EJECTOR PIN MARKS TO BE FLUSH TO 0.254mm BELOW SURROUNDING SURFACE. DO NOT USE SILICONE MOLD RELEASE.

4. FCI ID OR LOGO AND CAVITY NUMBER TO BE IN AREA INDICATED. HEIGHT OF LETTERING TO BE FLUSH TO 0.254mm BELOW SURROUNDING SURFACE. HIGH SHINE MARKING IS ACCEPTABLE.

5. ALL IDENTIFIED CRITICAL PARAMETERS '▲' MUST MEET THE PROCESS AND CAPABILITY REQUIREMENTS OF CUSTOMER'S SPECIFICATION.

6. DIMENSIONS AND GEOMETRIC TOLERANCES ARE IN METRIC.

7. THIS PRODUCT MEETS EUROPEAN UNION DIRECTIVES AND OTHER COUNTRY REGULATIONS AS DESCRIBED IN GS-22-008.

8. THE HOUSING WILL WITHSTAND EXPOSURE TO 260°C PEAK TEMPERATURE FOR 10 SECONDS IN A CONVECTION, INFRA-RED OR VAPOR PHASE REFLOW OVEN.

9. 10019594-001LF IS SAME TO 10019594-001. THE "LF" IS ADDED JUST FOR EASY LEAD FREE IDENTIFICATION.

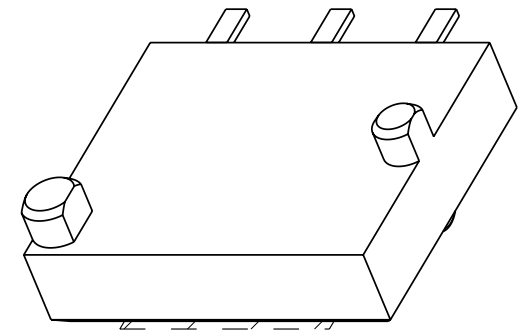
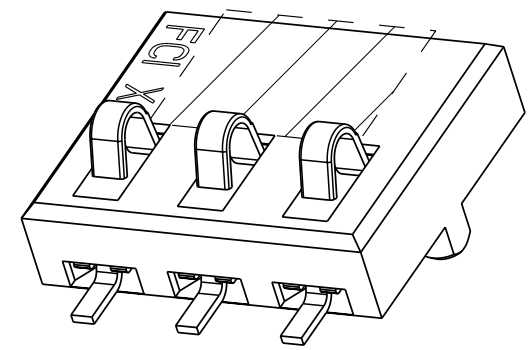

Copyright FCI.

rev	ecn no	dr	date
A	S03-0014	TAY	2003-01-22
B	S04-0235	TAY	2004-11-01
C	S05-0108	TAY	2005-04-12
D	S07-0259	TAY	2007-07-19
-	-	-	-
-	-	-	-
-	-	-	-

www.fciconnect.com		surface	tolerance std	projection	MM
		-	ASME Y14.5		
TOLERANCES UNLESS OTHERWISE SPECIFIED					
Dr	KP TAY	2003-01-22	ANGULAR	0.X	±0.33
Eng	KP TAY	2007-07-19	LINEAR	0.XX	±0.20
Chr	KP TAY	2007-07-19	0°	0.XXX	±0.13
Appr	JOEY NG	2007-07-19	Product family		Spec ref
FCI					COMPRESSION CONNECTOR
3 PINS SMT					dwg no
catalog no					10019594
CUSTOMER					Rev. D
sheet 1 of 2					

PRODUCT NO  
REFER TO PAGE  
1 OF 2

A

B

C

D

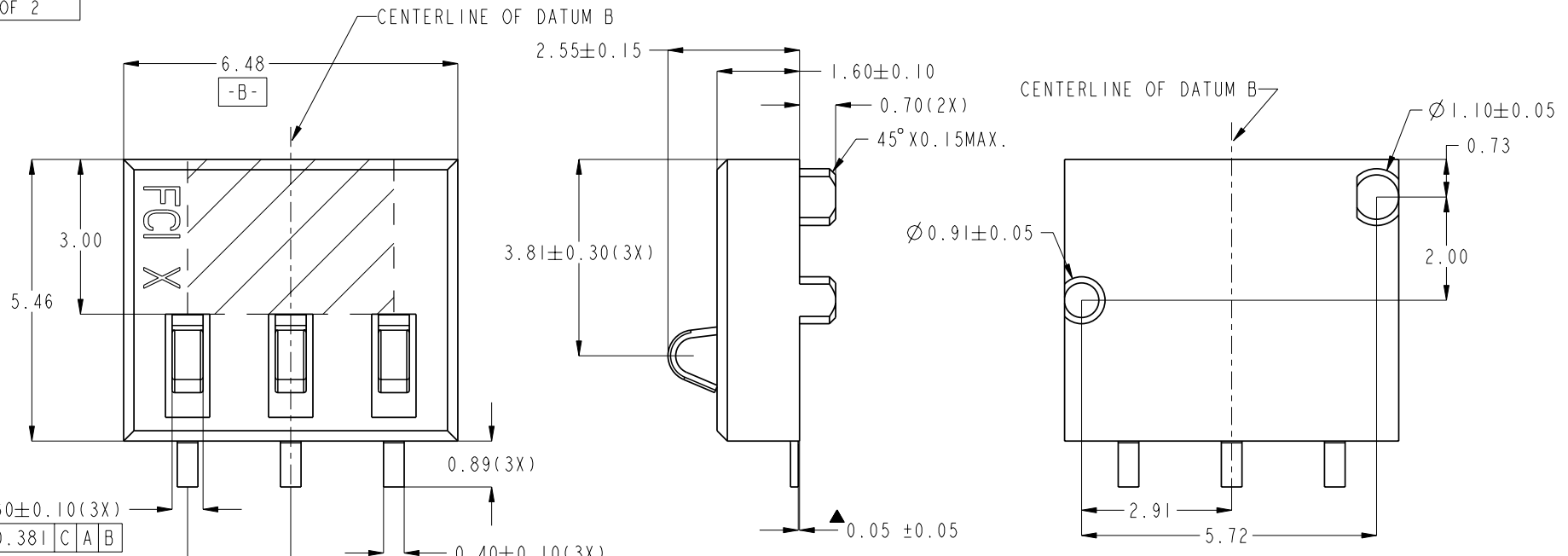

$0.60 \pm 0.10 (3X)$   
 $\oplus 0.38 | C | A | B$

$0.40 \pm 0.10 (3X)$   
 $\oplus 0.38 | C | A | B$

2.00(2X)

VACUUM PICK AND PLACE.  
THIS AREA SHALL BE  
FREE OF SINK MARK.

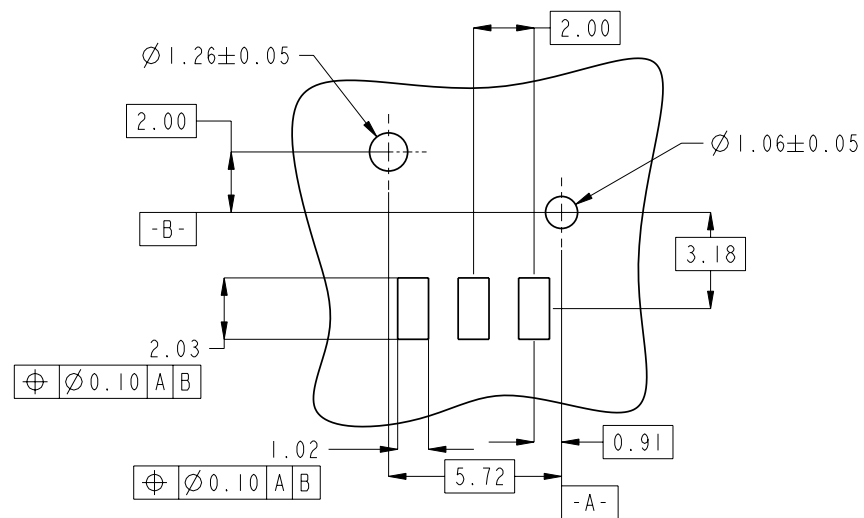

$\oplus \varnothing 0.10 | A | B$

$\oplus \varnothing 0.10 | A | B$

RECOMMENDED PAD GEOMETRY / MOUNTING  
PCB THICKNESS 0.6 +0.10 / -0.076

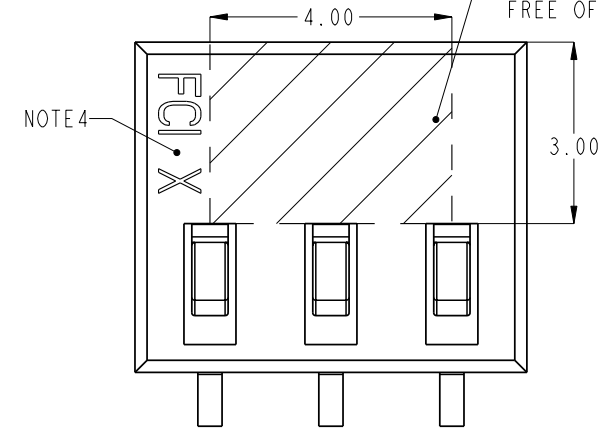

NOTE 4



TITLE  
COMPRESSION CONNECTOR  
3 PINS SMT  
catalog no

dwg no  
10019594  
CUSTOMER  
sheet 2 of 2

Rev.  
D



Copyright FCI.