

REVISIONS					
P	LTR	DESCRIPTION	DATE	DWN	APVD
D		REVISED PER ECO-18-012722	14AUG2018	JMS	WW
D1		REVISED PER ECO-20-012418	10SEP2020	AP	WW
D2		REVISED PER ECN-22-145617	23JUN2022	AP	MT

UNLESS OTHERWISE SPECIFIED:
 1. CA19400 BRASS, TENSILE STRENGTH: 379-455 MPg (55-66 KSI) (HARDNESS REF R30T 55-62)

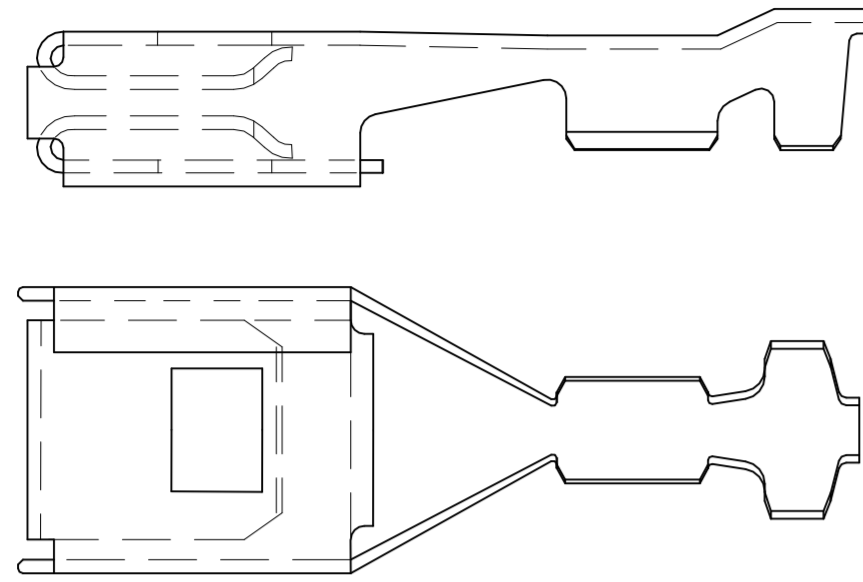

OPTIONAL CONSTRUCTION SHOWN

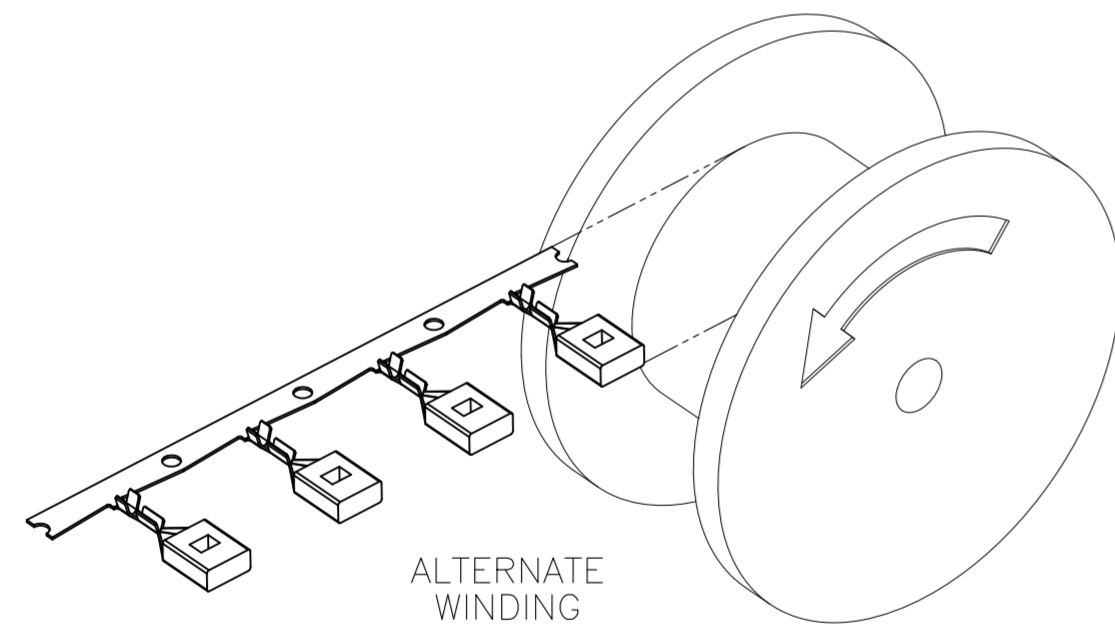
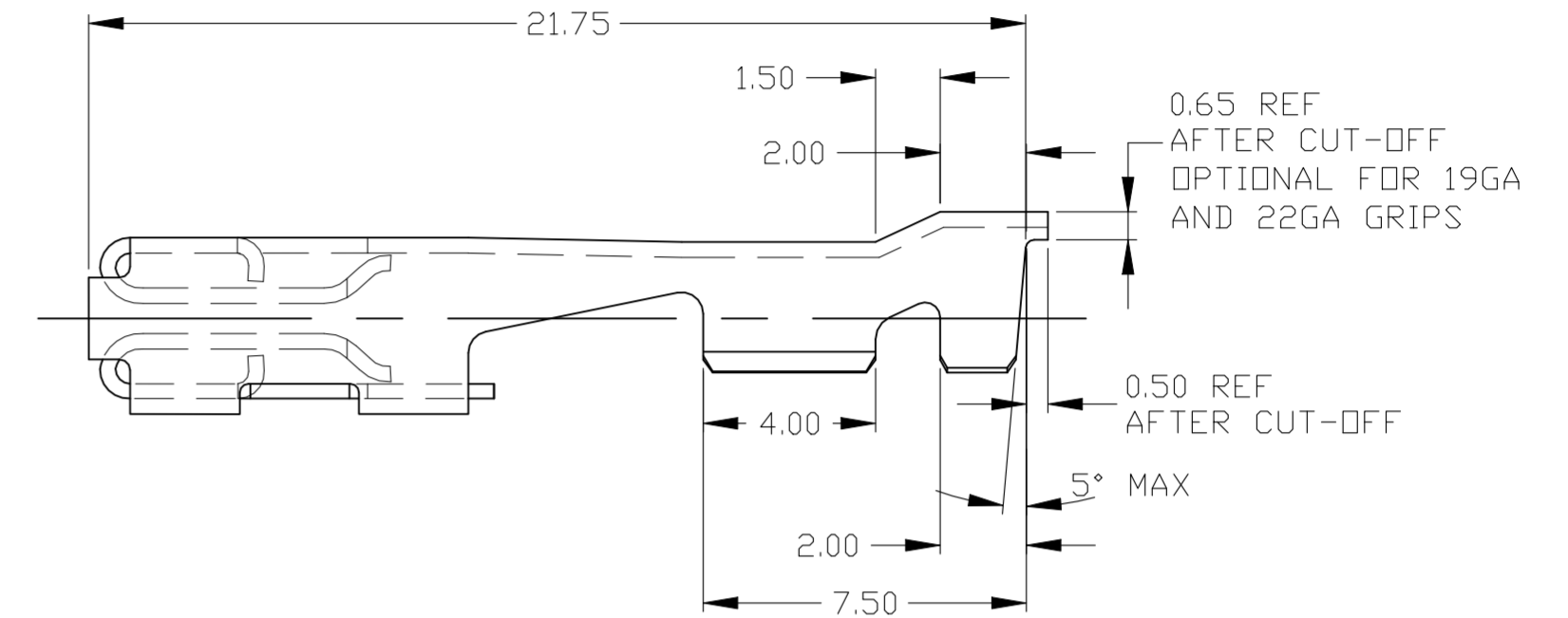

ALTERNATE WINDING

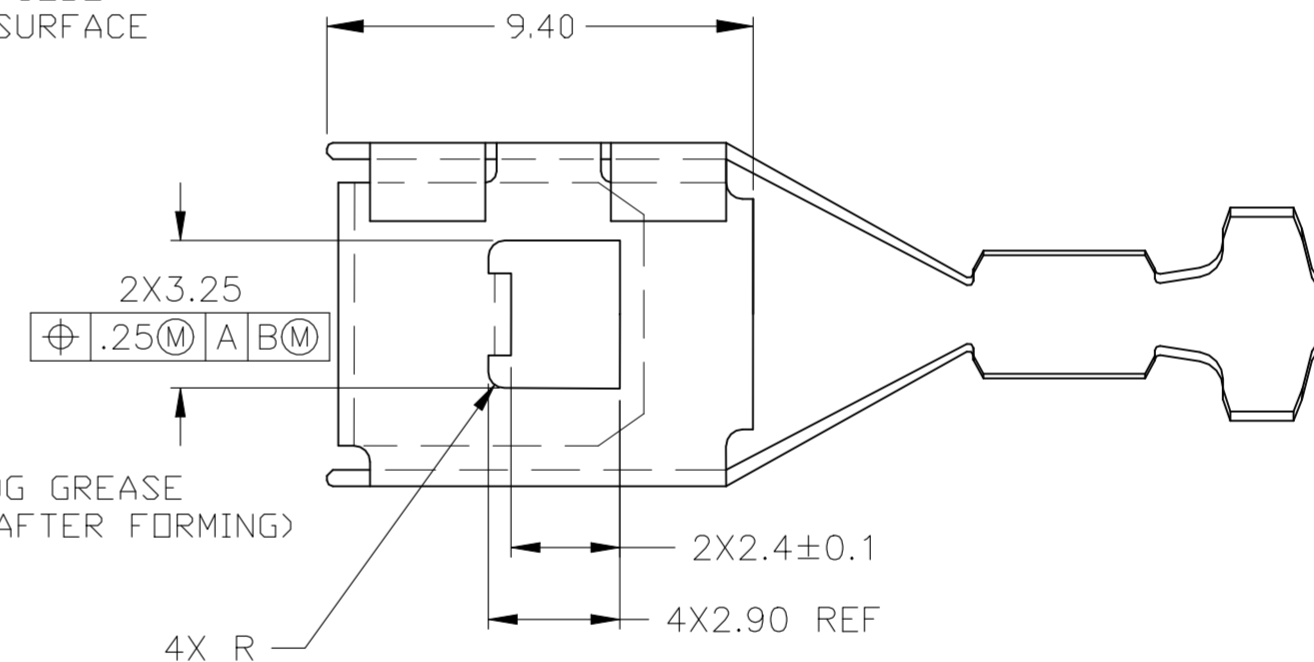
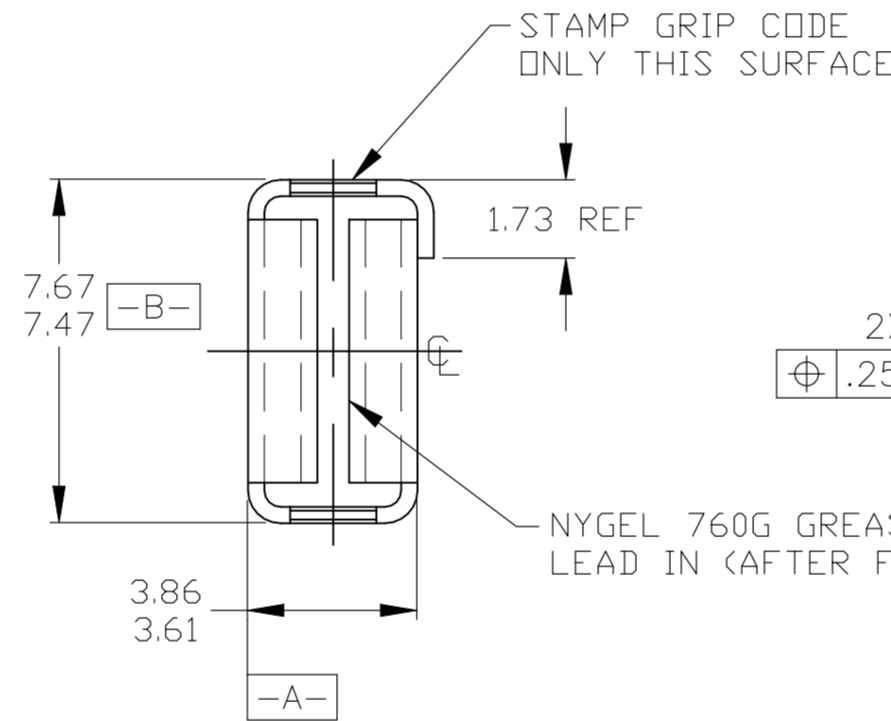

OBsolete	TE P/N	TE P/N	TE P/N	WIRE SIZE	INSERTION-EXTRACTION REQUIREMENTS
OBsolete	-	1438231-7	-	22	USING A POLISHED STEEL BLADE 6.22 [.245] X 0.81 [.032] FIRST INSERTION FORCE MAX 10.0N [2.2LBS] OR ANY INDIVIDUAL READING TO A DEPTH OF INSERTION OF 5.25/5.5 (UNGREASED AND GEASED)
OBsolete	-	1438231-6	-	19	
OBsolete	-	1438231-5	3-1438231-3	18	
	1438231-8	1438231-4	3-1438231-2	14	
OBsolete	-	1438231-3	-	13	FOR S.P.C. WITH CPK OF 16.7 MIN MAX FIRST INSERTION 11.0N [2.42LBS] BOTH GREASED AND UNGREASED
	-	1438231-2	-	11	
	1438231-9	1438231-1	3-1438231-1	10	FOURTH EXTRACTION FORCE MIN 6.8N [15.8LBS] UNGREASED
	TE P/N REWOUND	TE P/N UNGREASED	TE P/N GREASED		FOURTH EXTRACTION FORCE MIN 4.0N [0.89LBS] (GREASED)
	ALTERNATE WINDING	STANDARD WINDING			NOTE: REF ABOVE FOR INSERTION DEPTH

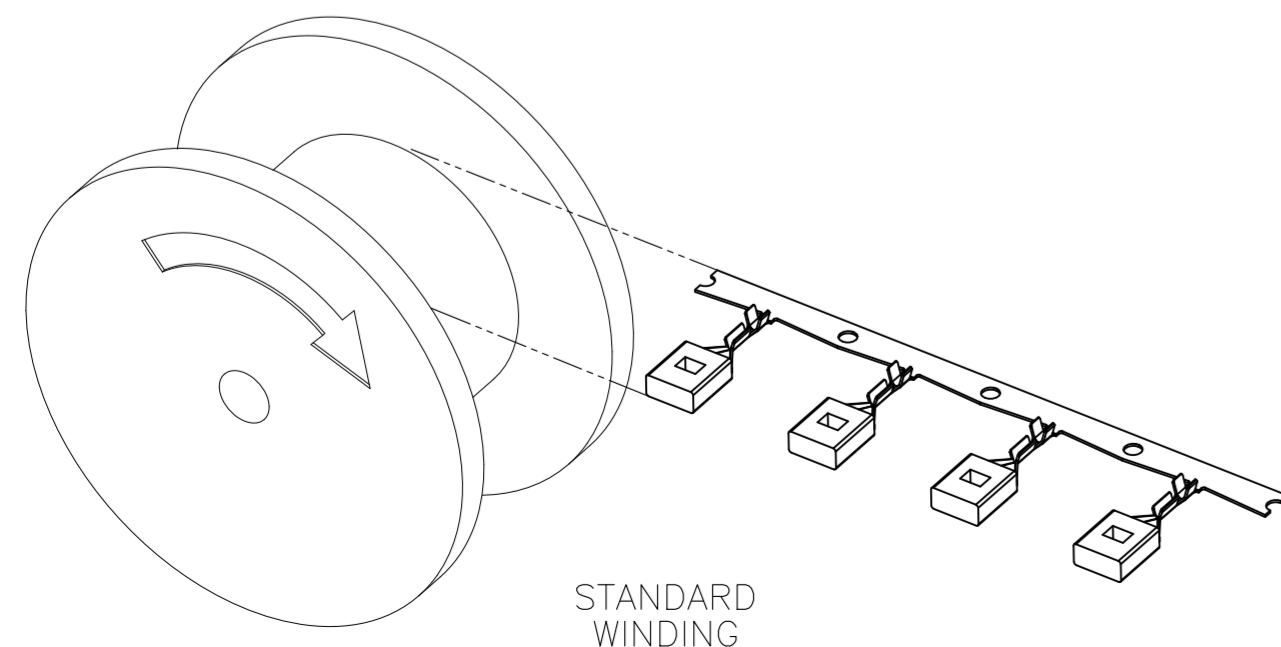

STANDARD WINDING

THIS DRAWING IS A CONTROLLED DOCUMENT.		DWN	JR BUSSARD	09MAY2003	
DIMENSIONS: mm		CHK	DM REVAK	09MAY2003	
TOLERANCES UNLESS OTHERWISE SPECIFIED:		APVD	DM REVAK	09MAY2003	
0 PLC ± - 1 PLC ± - 2 PLC ± 0.25 3 PLC ± - 4 PLC ± - ANGLES ± 2°		PRODUCT SPEC	-	-	
MATERIAL	FINISH	WEIGHT	0.000000	A2	00779
CUSTOMER DRAWING		SCALE	5:1	SHEET	1 of 1