

PART NUMBER	REV	FIRST USED	POWER UNIT	FEED TYPE	DESCRIPTION
1855250-1	A	122500-1	LEADMAKER	AIR FEED	CUTS CARRIER
1855250-2	A	565435-5	BENCH MODEL K	AIR FEED	CUTS CARRIER
1855250-3	A	354500-1	BENCH MODEL G	AIR FEED	CUTS CARRIER
1855250-6	A	122500-1	LEADMAKER	AIR FEED	CONTINUOUS CARRIER
7-1855250-7	A	-	-	-	SPARE PARTS

RECOMMENDED SPARE PARTS

GREASE LIGHTLY

GUARD MUST BE IN PLACE WHEN OPERATING APPLICATOR IN A BENCH MACHINE

**\* WARNING**

ON INSTALLATION, SET WIRE DISC TO LARGEST WIRE SIZE SETTING. USE OF SETTINGS BELOW MIN. REQUIRED CRIMP HEIGHT SETTING WILL CAUSE DAMAGE TO CRIMP TOOLING.

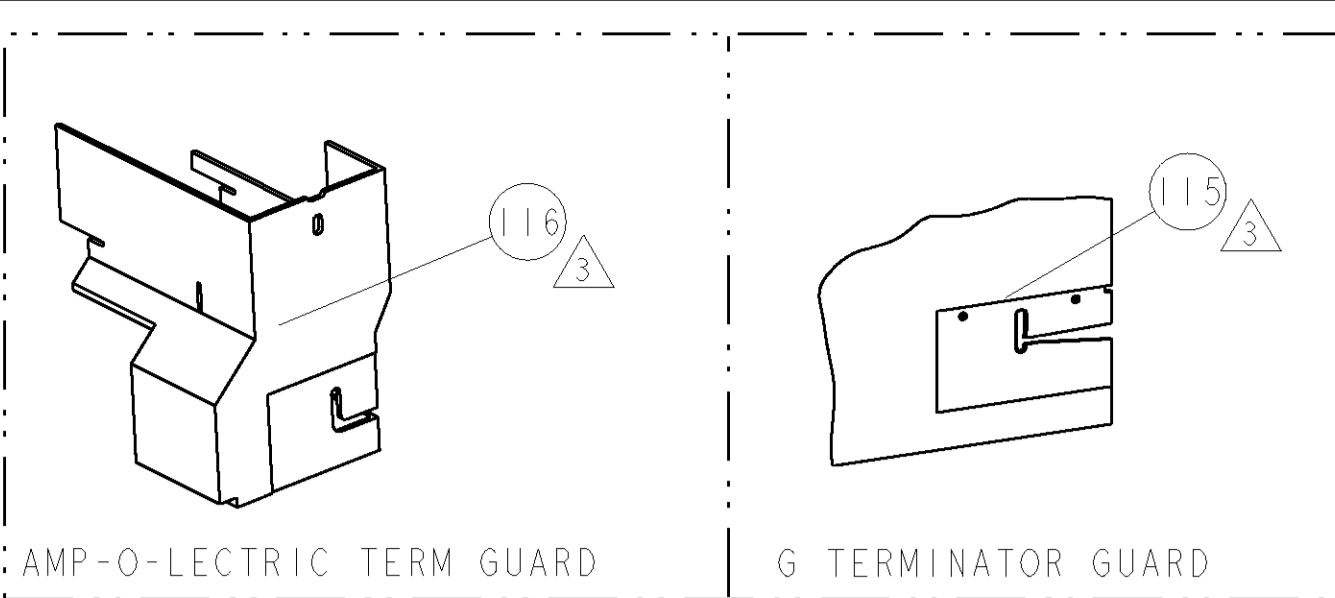

TERMINAL NAME: T-20 CROOUND TERMINAL, SINGLE CRIMP

TYCO PN	MANUF PN	CHRISTIANA IND TERMINAL - AMP CRIMP SPECS		
1949329	1302158			
		CRIMP HEIGHT	WIRE SIZE	REF SETTING
		2.02±0.05mm [.080±.002]	18AWG	B0
		1.88±0.05mm [.074±.002]	20AWG	C0
		CRIMP	SIZE	TYPE
		WIRE	1.78mm [.070]	F
		INSUL	3.30mm [.130]	F
				∅.100 MAX
WIRE STRIP LENGTH	TERM APPL SPEC	FEED	APPLICATOR INSTRUCTIONS	SET UP GAGE
.116 -.131	NONE	1.280	408-8040	458637-1

LOC	DIST	P	LTR	DESCRIPTION	DATE	DWN	APPR
A	66			RELEASED	11JUN2007	MEH	GB

D

C

B

A

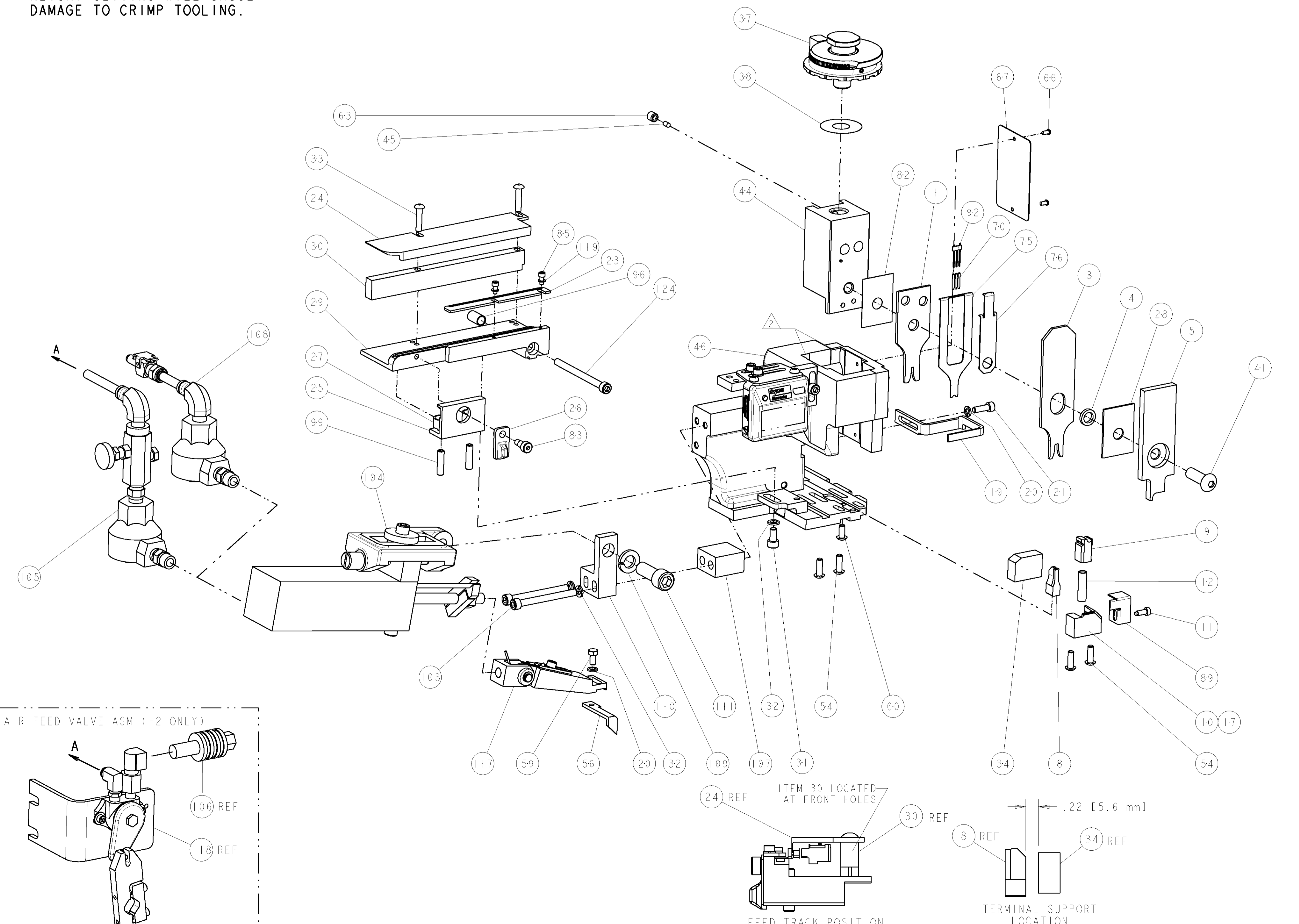

-	1	1	1	1	-	8-21000-7	SCR, SKT HD CAP 10-32 X 2.500	124
-	2	2	2	2	-	21024-2	WASHER, SPRG LOCK, REG NO 4	119
-	-	-	REF	-	-	692655-6	AIR FEED VALVE ASSEMBLY	118
-	1	1	1	1	-	461062-1	FEED FINGER ASSEMBLY	117
-	-	-	REF	-	-	455749-1	GUARD WINDOW	116
-	-	-	REF	-	-	679532-1	INSERT, GUARD	115
-	1	1	1	1	-	3-21001-5	SCR, SKT HD CAP 3/8-16 X 1.000	111
-	1	1	1	1	-	459610-9	MOUNT, FEED BRACKET	110
-	1	1	1	1	-	21024-8	WASHER, SPRG LOCK, REG 3/8	109
-	1	1	1	1	-	692655-7	AIR FEED VALVE ASSEMBLY	108
-	1	1	1	1	-	461690-1	SPACER, AIR FEED	107
-	-	-	REF	-	-	24024-2	VALVE, SHUT OFF	106
-	-	-	1	-	-	692655-5	AIR FEED VALVE ASSEMBLY	105
-	1	1	1	1	-	461065-2	ASSEMBLY, AIR FEED	104
-	2	2	2	2	-	4-21000-3	SCR, SKT HD CAP 10-32 X 2.000	103
-	2	2	2	2	-	5-21006-6	SCR, SET, CUP POINT 10-32 X .750	99
-	1	1	1	1	-	1-22281-8	SPRING, COMPRESSION	96
-	1	1	1	1	-	1424350-1	HOLDER, PIN, WIRED	92
-	1	1	1	1	-	318563-1	GUARD, FRONT CHIP	89
-	2	2	2	2	-	1-21000-3	SCR, SKT HD CAP 4-40 X .250	85
-	1	1	1	1	-	21989-8	SCR, SKT HD SHLDR 3/16 DIA X .250	83
-	1	1	1	1	-	455888-1	SPACER, CRIMPER	82
-	1	1	1	1	-	1490524-1	DEPRESSOR, SPACER	76
-	1	1	1	1	-	1490525-3	DEPRESSOR, WIRE	75
-	1	1	1	1	-	4088040	SF APPL INST 408-8040	72
-	1	1	1	1	-	217238-1	GENERAL INSTRUCTION PKG	71
-	3	3	3	3	-	2-23147-2	SPRING, COMPRESSION	70
-	1	1	1	1	-	461264-5	PLATE, IDENTIFICATION	67
-	2	2	2	2	-	21017-2	SCREW, DRIVE	66
-	1	1	1	1	-	21009-2	SCR, SET, SELF LOCKING 1/4-20 X .250	63
-	1	1	1	1	-	22733-8	SCR, BHSC, SELF-LOCKING, 8-32 X .375	60
-	1	1	1	1	-	2-22603-0	SCR, HEX HD CAP 8-32 X .312	59
-	1	1	1	1	-	4-694433-7	FEED PAWL	56
-	4	4	4	4	-	2-21002-2	SCR, BTN SKT HD CAP 8-32 X .500	54
-	1	1	1	1	-	1633399-1	APPL. BASIC AIR FEED SUB ASSY	46
-	1	1	1	1	-	690191-1	PLUG, NYLON	45
-	1	1	1	1	-	1-455673-4	RAM, SIDE FEED	44
-	1	1	1	1	-	7-21002-9	SCR, BTN SKT HD CAP 5/16-24 X 1.00	41
-	1	1	1	1	-	469367-3	SHIM	38
-	1	1	1	1	-	879103-2	FINE ADJUST HEAD ASSEMBLY	37
-	1	1	1	1	-	5-690786-7	TERMINAL SUPPORT	34
-	2	2	2	2	-	2-21002-4	SCR, BTN SKT HD CAP 8-32 X .750	33
-	3	3	3	3	-	21024-5	WASHER, SPRG LOCK, REG NO 10	32
-	1	1	1	1	-	3-21000-4	SCR, SKT HD CAP 10-32 X .375	31
-	1	1	1	1	-	1-1320908-9	SPACER, STRIP GUIDE	30
-	1	1	1	1	-	1-1633087-3	PLATE, STRIP GUIDE	29
-	1	1	1	1	-	1-455888-0	SPACER, CRIMPER	28
-	2	2	2	2	-	1-22284-0	SPRING, COMPRESSION	27
-	1	1	1	1	-	356835-1	LEVER, DRAG RELEASE	26
-	1	1	1	1	-	240792-1	DRAG, TERMINAL	25
-	1	1	1	1	-	1-1320928-4	PLATE, STRIP GUIDE	24
-	1	1	1	1	-	2-690438-0	FRONT STRIP GUIDE	23
-	2	2	2	2	-	2-21000-7	SCR, SKT HD CAP 8-32 X .500	21
-	2	2	2	2	-	21024-4	WASHER, SPRG LOCK, REG NO 8	20
-	1	1	1	1	-	456468-5	STRIPPER, SPECIAL	19
-	1	1	1	1	-	679625-1	SHEAR HOLDER, FRONT (NO CUT)	17
-	1	1	1	1	-	3-22280-3	SPRING, COMPRESSION	12
-	1	1	1	1	-	690461-1	STOP, SHEAR	11
-	-	-	1	1	-	690459-1	SHEAR HOLDER, FRONT	10
-	1	1	1	1	-	462006-1	FLOATING SHEAR, FRONT	9
-	1	1	1	1	-	2-1633108-0	ANVIL, COMBINATION .070	8
-	1	1	1	1	-	2-455889-0	DEPRESSOR, SHEAR	5
-	1	1	1	1	-	1-238011-0	BLOCK, CRIMPER SPACER	4
-	1	1	1	1	-	4-456134-4	CRIMPER, INSULATION F PREMIUM	3
-	1	1	1	1	-	456404-5	CRIMPER, WIRE PREMIUM	1

RECOMMENDED SPARE PARTS  
GREASE LIGHTLY  
GUARD MUST BE IN PLACE WHEN OPERATING APPLICATOR IN A BENCH MACHINE

QTY	PART NO	DESCRIPTION	ITEM NO					
-77	-6	-3	-2	-1	U/M	PART NO	DESCRIPTION	ITEM NO

DIMENSIONS: INCHES 	TOLERANCES UNLESS OTHERWISE SPECIFIED: 0 PLC ±. 1 PLC ±.01 2 PLC ±.01 3 PLC ±.001 4 PLC ±.0001 ANGLES ±.	DWG: HERR 27MAR2006 CHK: G. BAILEY 27MAR2007 APVD: I. BENCHOFF 27MAR2007 NAME: T. BENCHOFF PRODUCT SPEC: APPLICATION SPEC: MATERIAL: FINISH:	Tyco Electronics Harrisburg, PA 17105-3608 <b>FINE ADJUST SIDE FEED HDM APPLICATOR</b> SIZE: A1 CAGE CODE: 00779 DRAWING NO: 1855250 SCALE: 3:5 SHEET: 1 OF 1 REV: A
---------------------------	--	---	--

CUSTOMER VIEWABLE ASSEMBLY