

LOC		DIST		REVISIONS			
ES	00	REV	PER	DESCRIPTION	DATE	DMN	APVD
D		REV PER	ECR-09-014432		29JUN2009	KT	SY

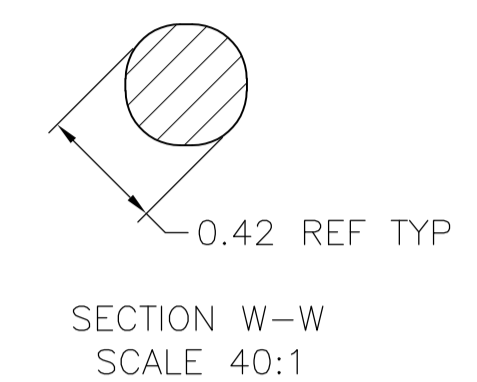

- 1 MATERIAL: HOUSING: POLYESTER. COLOR: GRAY.
CONTACT: PHOSPHOR BRONZE.
- 2 FINISH: CONTACT MATING AREA: 1.27um MIN GOLD PLATE,
ACTION PIN AREA: 0.5um MIN TIN PLATE,
ALL OVER 1.27um MIN NICKEL UNDERPLATE.
- 3 FINISH: CONTACT LUBRICATION WITH BELLCORE APPROVED
LUBRICANT. TECHNICAL REFERENCE: GR-1217-CORE, ISSUE 1,
NOVEMBER 1995.
- 4 THE 10.26±0.13 DIMENSION APPLIES IN THIS AREA.
- 5 FINISH: CONTACT MATING AREA: 0.0762um MIN GOLD PLATE
OVER 0.305 um MIN PdNi.
ACTION PIN AREA: 0.5um MIN TIN PLATE,
ALL OVER NICKEL 1.27um MIN UNDERPLATE.

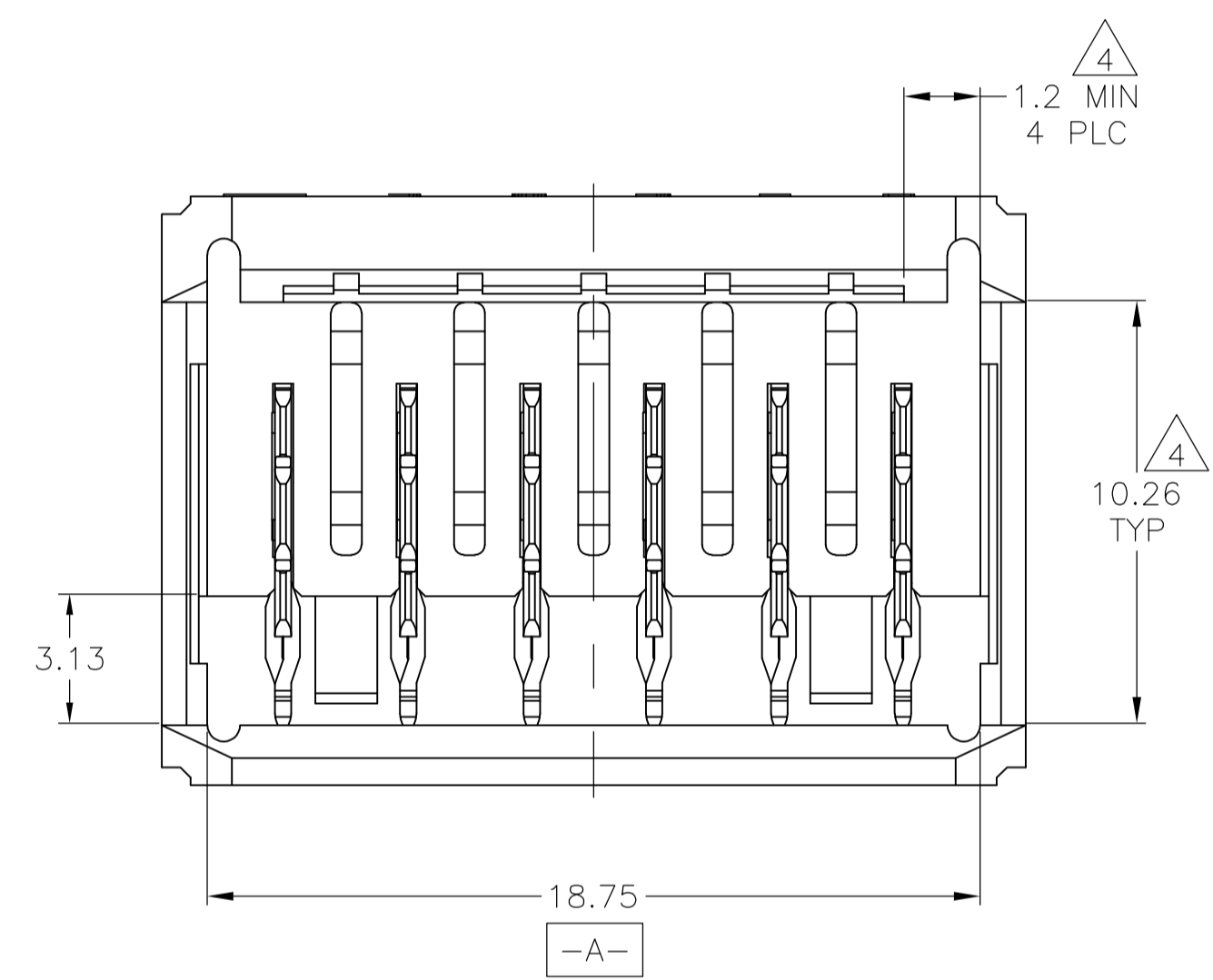
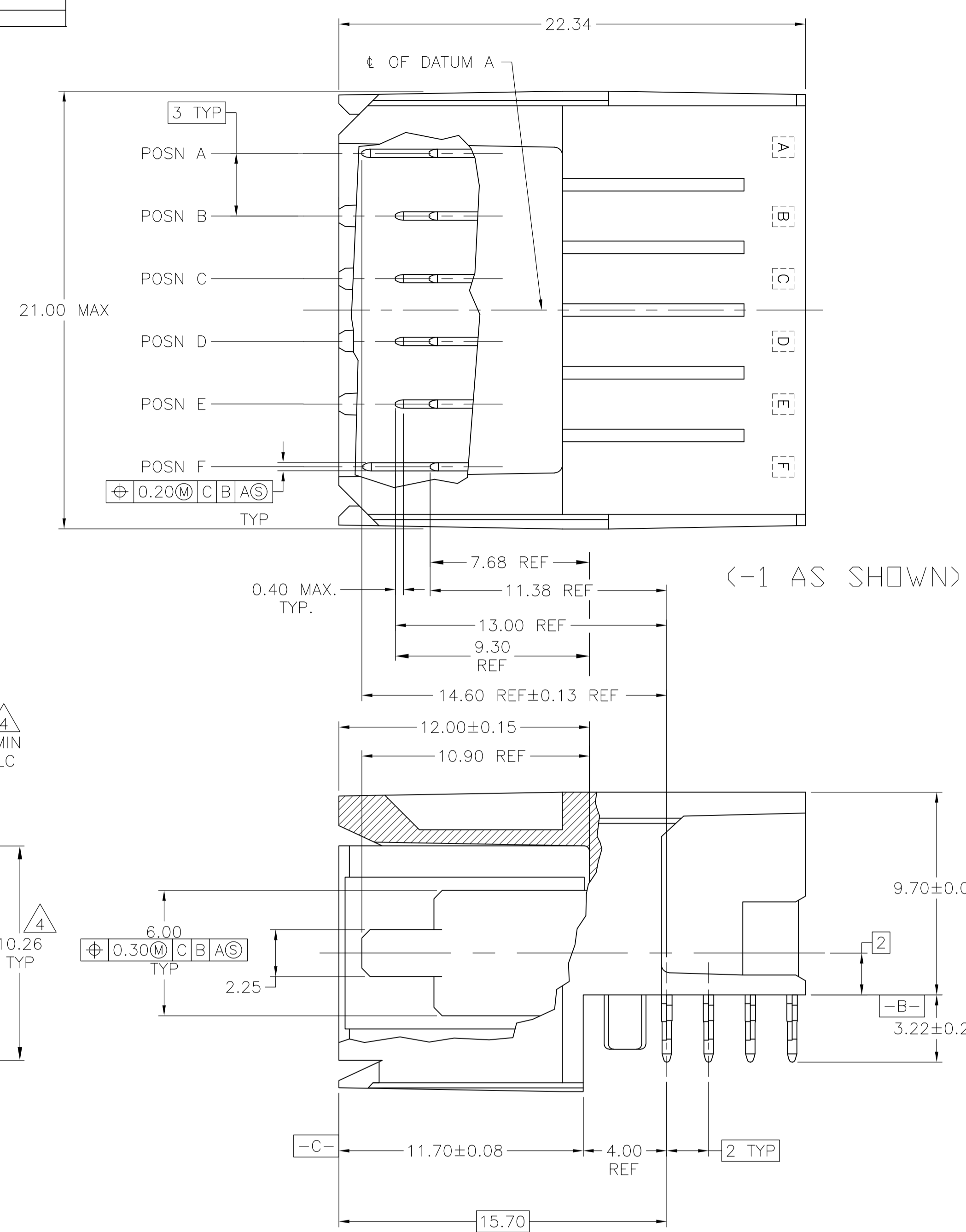
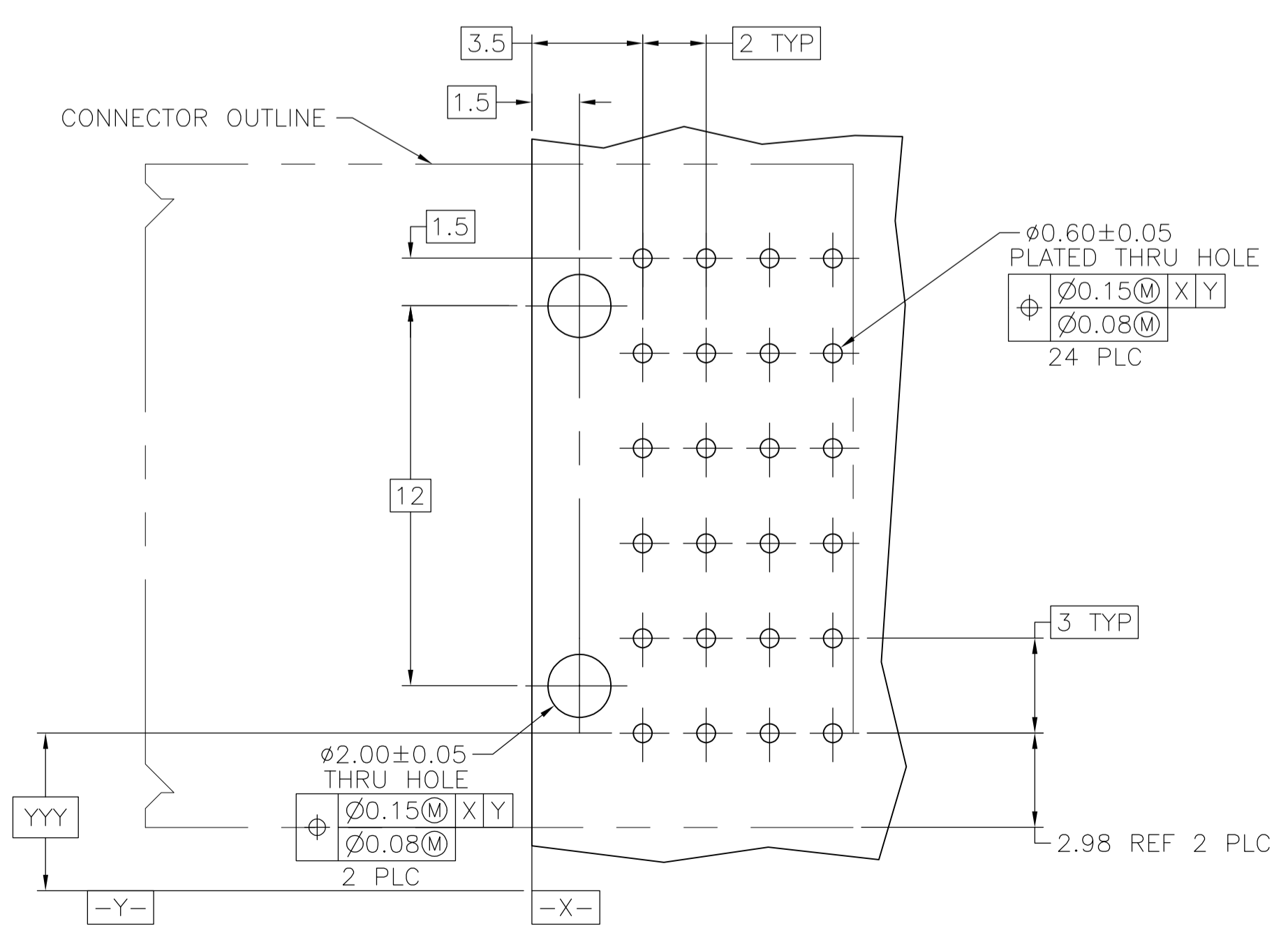
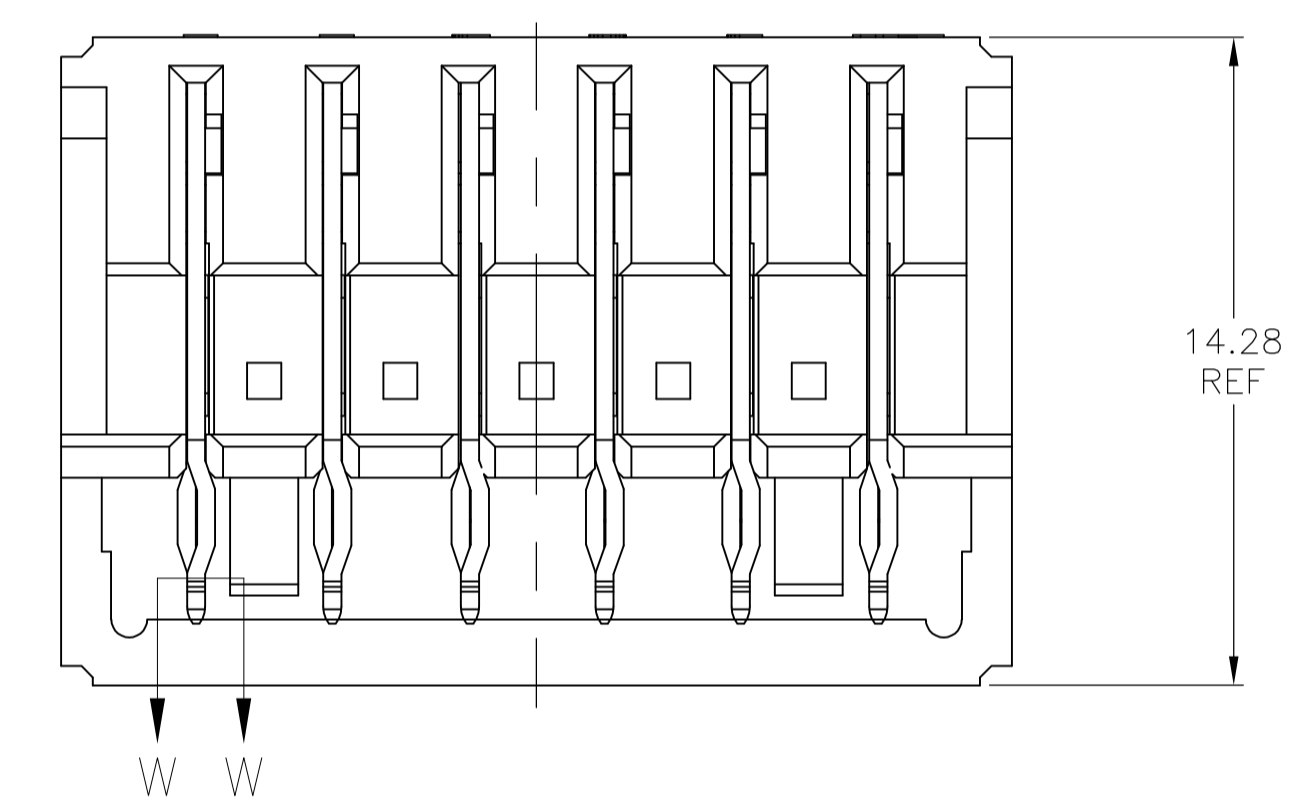

RECOMMENDED PCB HOLE LAYOUT

FINISH	POSITIONS LOADED WITH 10.90 REF CONTACTS	POSITIONS LOADED WITH 9.30 REF CONTACTS	POSITIONS LOADED WITH 7.68 REF CONTACTS	NO OF LOADED POSITIONS	PART NUMBER
5/3	A,F	B,C,D,E	-	6	292289-4
2/3	A,B	D,E,F	C	6	292289-3
2/3	A,D,E,F	B	C	6	292289-2
2/3	A,F	B,C,D,E	-	6	292289-1

THIS DRAWING IS A CONTROLLED DOCUMENT.		DIN ROY HAO 09SEP2003		Tyco Electronics Corporation Harrisburg, Pa 17105-3608	
DIMENSIONS: mm		CHK STEVEN YAO 09SEP2003		NAME	
TOLERANCES UNLESS OTHERWISE SPECIFIED:		APVD T.SASAKI 09SEP2003		PRODUCT SPEC	
0 PLC ± -		APPLICATION SPEC		SIZE CASE CODE DRAWING NO	
1 PLC ± -		WEIGHT		A1 00779 C=292289	
2 PLC ± 0.13		CUSTOMER DRAWING		SCALE NTS SHEET 1 of 1 REV D	
3 PLC ± -					
4 PLC ± -					
ANGLES ± -					
MATERIAL					
FINISH					