

REVISIONS				
REV	ECO	DESCRIPTION	DATE	BY APPR
A1	-	FIRST RELEASE	21-Nov-14	DRACK TOMMY

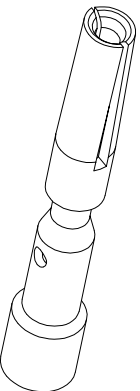
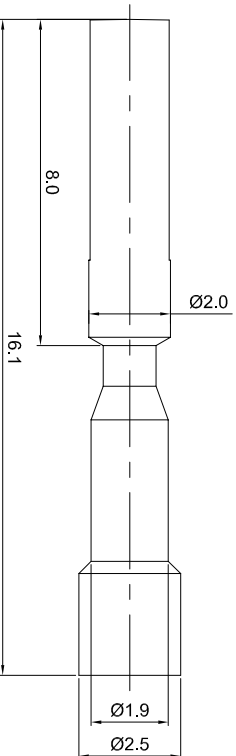
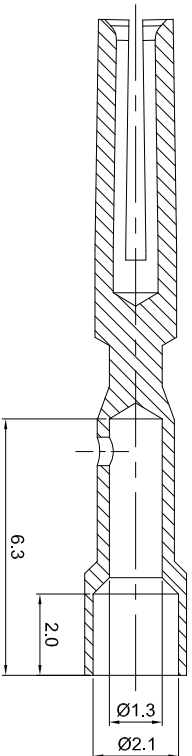
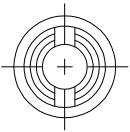

- NOTES: UNLESS OTHERWISE SPECIFIED
- MATERIAL: COPPER ALLOY, GOLD PLATED
  - SPECIFICATIONS:
    - RATED CURRENT: 7 AMPS
    - CONTACT RESISTANCE: <5 milliohm
    - AVAILABLE WIRE RANGE: 18-22AWG
    - ROHS COMPLIANT
  - ALL DIMENSIONS ARE FOR REFERENCE USE ONLY.

QUANTITY	SEE PART NUMBER CHART	PART NUMBER	DESCRIPTION	ITEM
<b>MATERIALS LIST</b>				
UNLESS OTHERWISE SPECIFIED				
1) All dimensions given in millimeters.				
2) Tolerances are as follows:				
1 Pt. DEC 40-30 Fractions .1754				
3 Pt. DEC 40-08 Angles 1°				
3) Note reference =  A				
MATERIAL SPECIFICATIONS:		CUSTOMER:	Socket 20# Chmp 18-22AGW	
PROCESS SPECIFICATIONS:		THIS DRAWING IS SUPPLEMENTARY TO THE DRAWING IT REFERS TO. SPECIFICATIONS AND PERFORMANCE DATA ARE THE PROPERTY OF SHINE SYSTEMS, INC. AND ARE NOT TO BE REPRODUCED OR TRANSMITTED IN ANY FORM OR BY ANY MEANS, ELECTRONIC OR MECHANICAL, INCLUDING PHOTOCOPYING, RECORDING, OR BY ANY INFORMATION STORAGE AND RETRIEVAL SYSTEM. ALL RIGHTS ARE RESERVED.	Shine Systems - www.amphenol-shine.com 44724 Morley Drive Clinton Township, MI 48036	
SCALE:	8 : 1	SIZE:	B	TYPE:
SCALE:	8 : 1	SIZE:	C-	DWG NO:
SCALE:	8 : 1	SIZE:	SC000326	REVISION:
SCALE:	8 : 1	SIZE:	A1	REVISION:

TITLE:

Socket 20# Chmp 18-22AGW

DWG NO:

SC000326

REV: A1

SH: 1

OF: 1