

4S-Series

Miniature Slide Switches

PRODUCT WEBPAGE

request sample, configure part

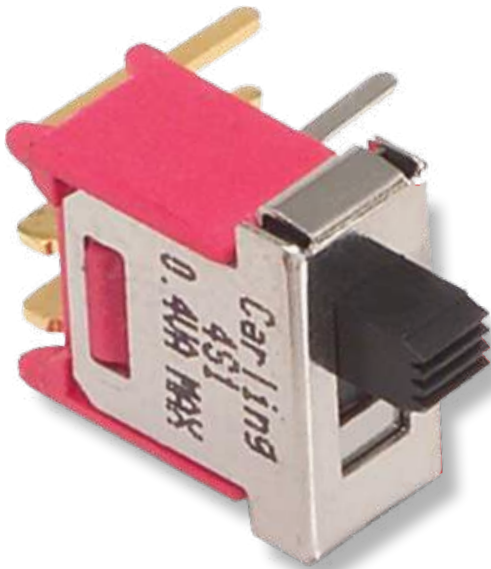
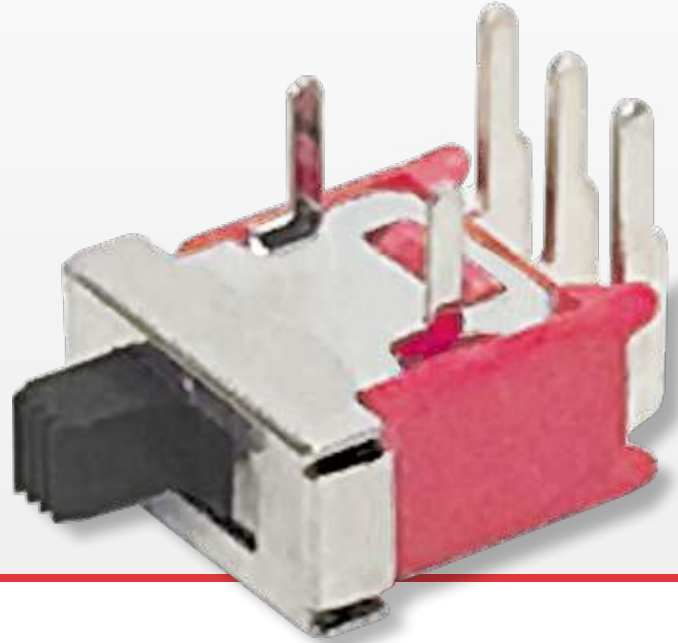

The 4S-Series sub-miniature slide switches feature maintained and momentary 2 or 3 position circuits, and offer a variety of ratings, contact materials, terminal platings, and mounting styles. These switches are able to withstand temperatures from -30°C to +85°C.

1	.4-3	125, 250	28
Pole	Amps	VAC	VDC

Typical Applications

- Consumer Electronics
- Instrumentation
- Computer Servers / Peripherals
- Test / Measurement

Tech Specs

Electrical

Contact Rating	refer to ordering scheme
Electrical Life	30,000 make & break cycles @ full load
Contact Resistance	10 mΩ max. initial @ 2-4 VDC 100mA for both silver & gold plated contacts
Insulation Resistance	1000 MΩ min.
Dielectric Strength	1500 Volts RMS @ sea level

Physical

Operating Temperature	-30°C to +85°C
Solder Heat Resistance	MIL-STD-202, Method 210

Material

Case	Dially phthalate (DAP) (UL 94V-0)
Slide Handle	Nylon
Housing	Stainless Steel
Terminal Seal	Epoxy

Ordering Scheme

Sample Part Number **4S1 - FSP 1 - M6 Q E T/R**

Selection 1 2 3 4 5 6 7

1. SERIES

4M1 Miniature Slide Switch

2. POLES

FSP Single Pole

3. CIRCUIT

() - momentary

Position:	1	2	3
	2-1	Connected Terminals	2-3
1	ON	NONE	ON
2	ON	NONE	(ON)
3	ON	OFF	ON

4. TERMINATION

M2 PCB
M6 PC Mount, horizontal, right angle
M7 PC Mount, vertical, right angle
M7I Snap-In, vertical, right angle

5. CONTACTS / TERMINALS

Contact Material	Terminal Plating	Rating
G silver ¹	gold over silver	3A 125VAC or 28VDC; 1.5A 250VAC
K gold ^{2,5}	tin ^{4,7}	0.4VA max 20V max (AC/DC)
P silver ^{1,6}	tin ^{4,7}	3A 125VAC or 28VDC; 1.5A 250VAC
Q silver ¹	silver ¹	3A 125VAC or 28VDC; 1.5A 250VAC
R gold ²	gold ³	0.4VA max 20V max (AC/DC)

6. EPOXY SEAL

E Epoxy Seal **0** without Epoxy Seal

7. PACKAGING

T/R tape reel - 500 pieces per reel
 Switches are bulk packed, unless T/R is specified at the end of the part number.

Notes:

- Movable contact / terminal platings: silver over copper alloy
- Movable contact platings: gold over nickel over copper alloy
- Terminal platings: gold over nickel over copper alloy
- Terminal platings: tin over copper alloy, available with PC type terminations only
- Terminal contact platings: gold over nickel alloy
- Terminal contact platings: silver over nickel alloy
- Tin option available with PC type terminations only

[Configure Complete Part Number >](#)

[Browse Standard Parts >](#)

Dimensional Specs

inches [millimeters]

M2 Single Pole

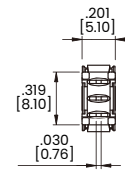
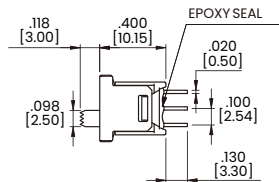
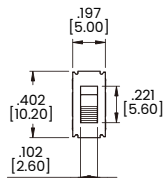

P.C.MOUNTING



M6 Single Pole

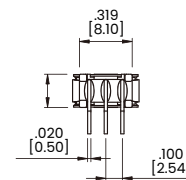
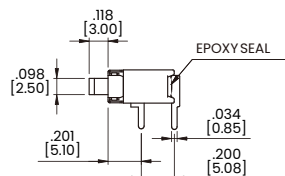
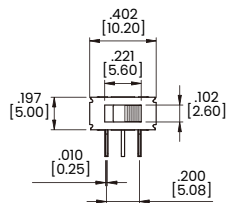

P.C.MOUNTING

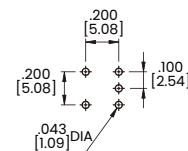

M7 Single Pole

M71 Snap-In Termination Single Pole

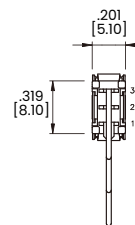
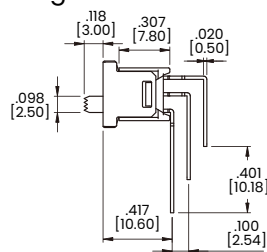
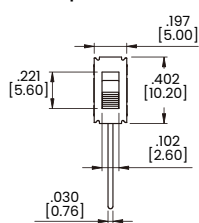

P.C.MOUNTING

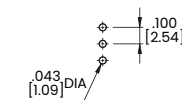

Authorized Sales Representatives and Distributors

Click on a region of the map below to find your local representatives and distributors or visit www.carlingtech.com/findarep.



About Carling

Founded in 1920, Carling Technologies is a leading manufacturer of electrical and electronic switches and assemblies, circuit breakers, electronic controls, power distribution units, and multiplexed power distribution systems. With six ISO9001 and IATF16949 registered manufacturing facilities and technical sales offices worldwide, Carling Technologies Sales, Service and Engineering teams do much more than manufacture electrical components, they engineer powerful solutions! To learn more about Carling please visit www.carlingtech.com/company-profile.

To view all of Carling's environmental, quality, health & safety certifications please visit www.carlingtech.com/environmental-certifications.

© Carling Technologies, Inc.

4. Carling is a registered trademark of Carling Technologies, Inc. in the U.S. and other countries.