

ISS.	AMEND	DATE
1	ISSUED	17/06/22

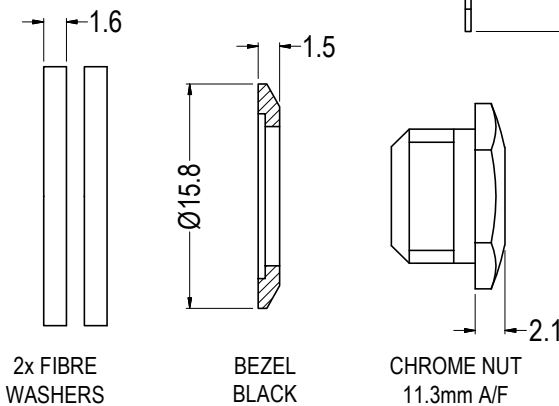
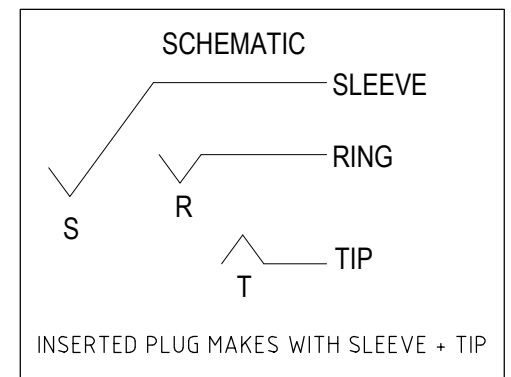
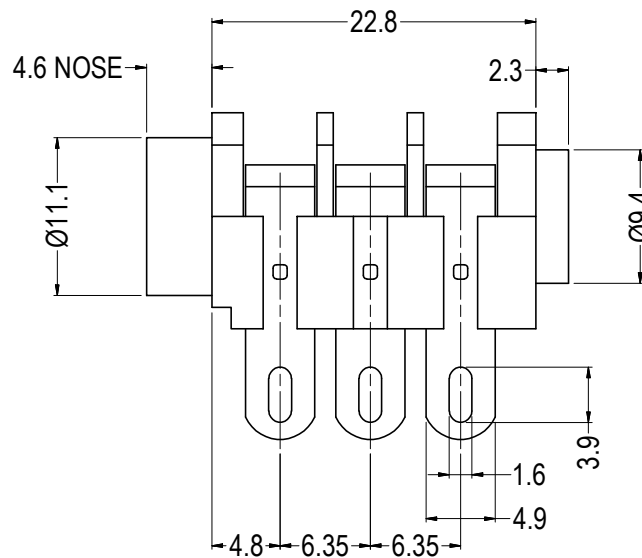
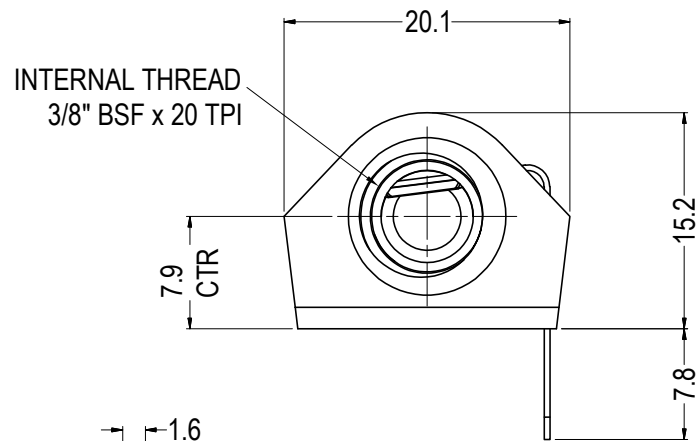
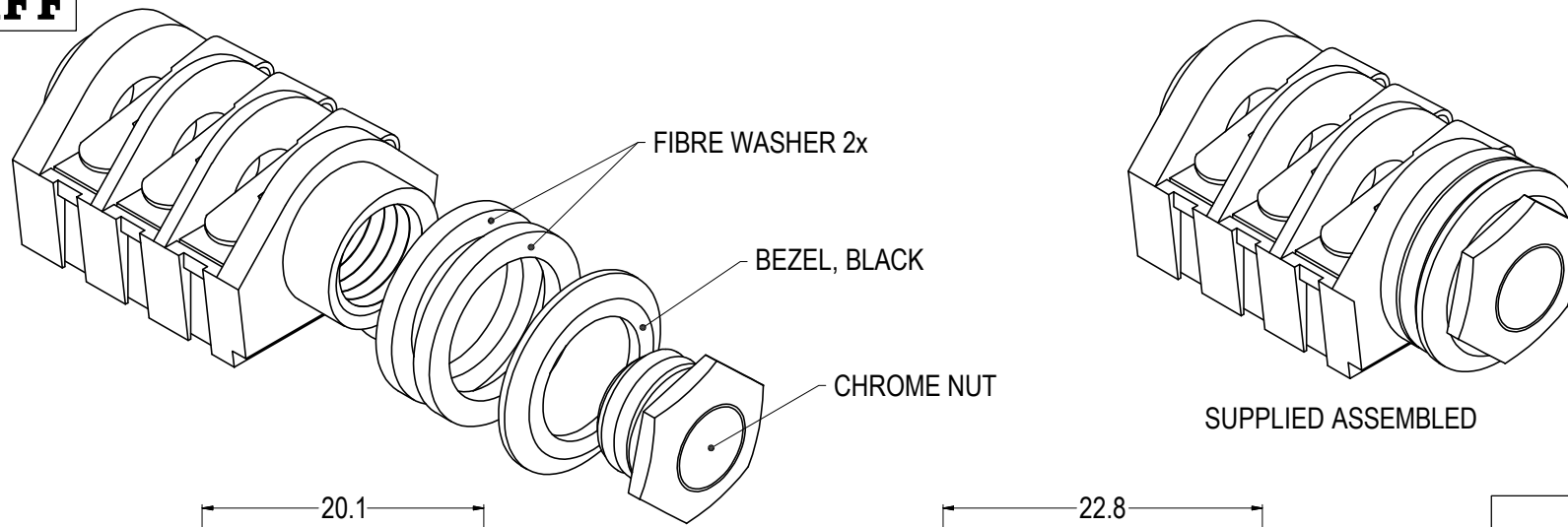

**SPECIFICATION**  
 Withstand voltage: 2000V DC Min.  
 Maximum Current: 5A  
 Temperature Rating: -10° C to +70° C  
 Life (Minimum): 10,000+ Operations  
 Nominal Contact Resistance: <50mΩ  
 Max Panel Thickness: 4.3mm

<b>RoHS</b> COMPLIANT
<b>TOLERANCE</b> NO DEC. PLACE ± 1 DEC. PLACE ± 2 DEC. PLACE ± HOLE Ø ± ANGLES ± UNLESS OTHERWISE STATED
DO NOT SCALE

**Cliff Electronic Components Ltd.**  
 76 Holmethorpe Avenue, Holmethorpe Industrial Estate,  
 Redhill, Surrey, RH1 2PF, England, UK  
 Tel: 01737-771375 Fax: 01737-766012 Website: www.cliffuk.co.uk

DIMENSIONS IN MILLIMETERS UNLESS OTHERWISE STATED. WORK TO DIMENSIONS. REMOVE ALL BURRS. IF IN DOUBT ASK.

3rd ANGLE PROJECTION:

MATERIAL: NYLON / NiAg / FIBRE / POM / BRASS
FINISH: AS MOULDED / MICROFINISH
DRAWN: T.J.O.

TITLE: JACK SOCKET S4/SSS ASSEMBLED
DRWG. No. CL1320A

FORM: A4DRWGH
---------------