

PART NUMBER	REV	FIRST USED
687388-5	P	-

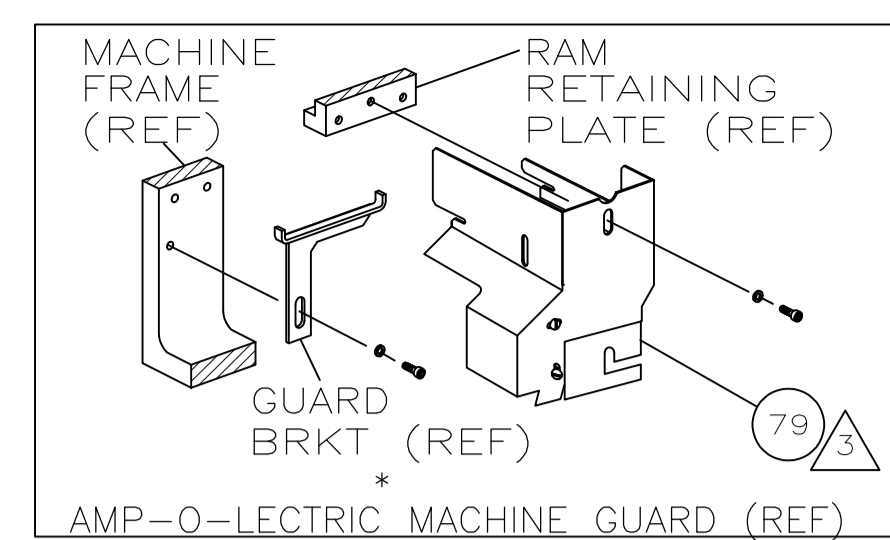

TERMINAL NAME: .250 FLAG FASTON™ TERMINAL					
CRIMPING DATA					
PAD LTR	CRIMP HEIGHT	WIRE SIZE			
42563-1					
42563-2					
42563-3					
42563-4	A	.085 ±.002 [2.16 ±0.05mm]	10		
42563-5	B	.071 ±.002 [1.80 ±0.05mm]	4.00mm <sup>2</sup>		
42563-7	C	.069 ±.002 [1.75 ±0.05mm]	12		
61229	D	NOT	USED		
CRIMP	SIZE	TYPE	RANGE		
WIRE	.200 [5.08mm]	TAB LOCK	12-10		
INSUL	.220 [5.59mm]	0	.110-.210		
WIRE STRIP LENGTH	TERM APPL SPEC	FEED	APPL INSTRUCTION	SET UP GAGE	LAYOUT
.205-.235	114-2078	.770	A18037	-	-

-5 BENCH MODEL K AIR FEED

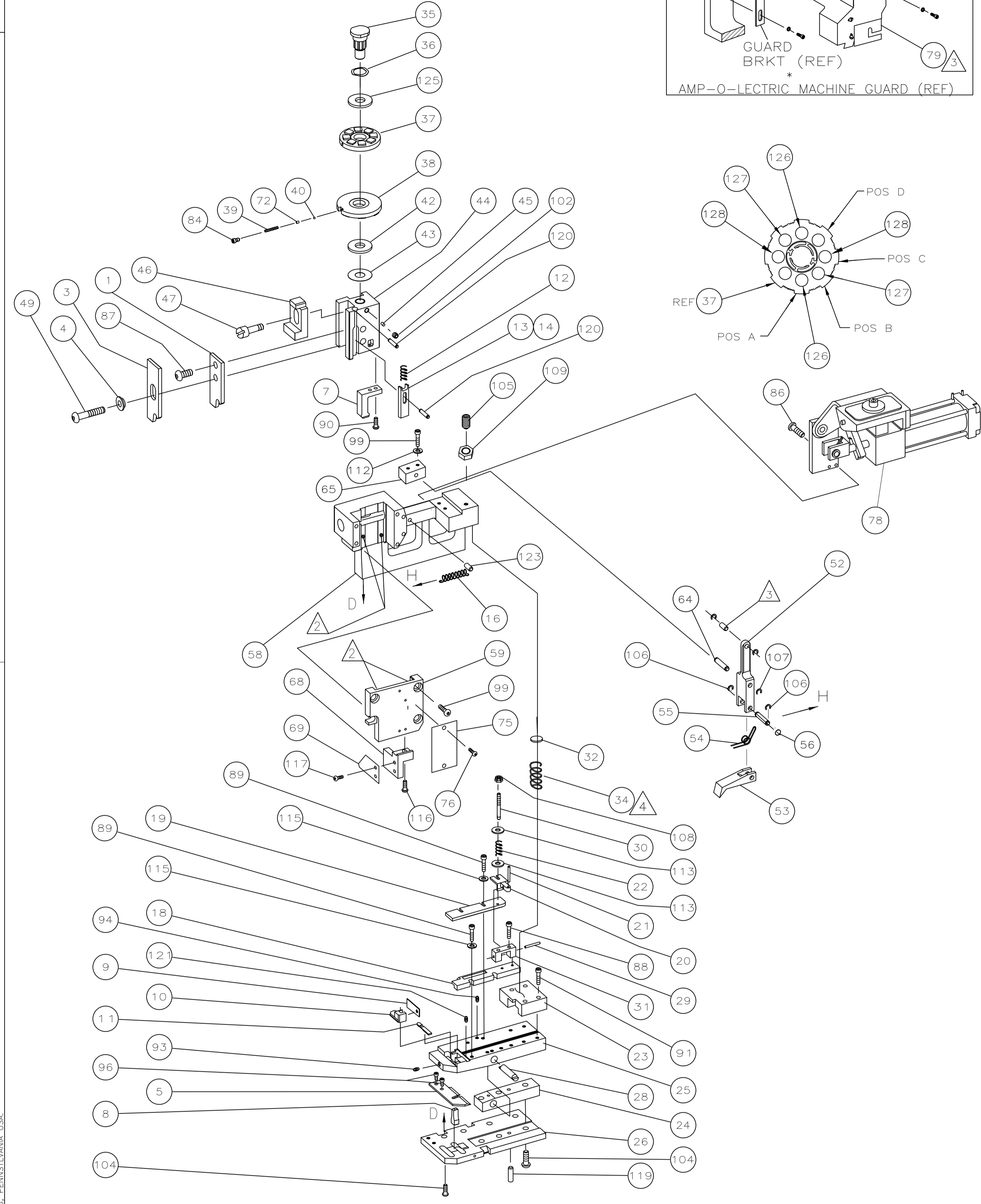

- 1 RECOMMENDED SPARE PARTS.
- 2 GREASE LIGHTLY.
- 3 LUBRICATE DAILY USING NO. 20 MACHINE OIL.
- 4 AFTER ASSEMBLY OF APPLICATOR, PROPER SPRING PRESSURE (ITEM 34) CAN BE OBTAINED BY TIGHTENING SET SCREW (ITEM 105) UNTIL CONTACT IS MADE WITH SPACER (ITEM 32) THEN TIGHTEN AN ADDITIONAL 5 1/2 - 6 REVOLUTIONS.
- 5 GUARD MUST BE IN PLACE WHEN OPERATING APPLICATOR IN A BENCH MACHINE
- 6. DO NOT EXCEED 80 C.P.M. WITH THIS APPLICATOR.

QTY	REQD PER ASSY	PART NO	DESCRIPTION	ITEM NO
-	-	-	-	129
2	-	9-354778-3	PIN, WIRE DISC (.2960)B	128
2	-	9-354778-1	PIN, WIRE DISC (.2950)B	127
2	-	5-354778-9	PIN, WIRE DISC (.2790)A	126
1	-	986950-1	WASHER, FLAT PRECISION	125
1	-	3-22183-9	PIN, DOWEL (Ø.187X1.25)	123
2	-	3-21028-2	PIN, SLOTTED SPRING (Ø.094X.25)	121
2	-	4-21028-9	PIN, SLOTTED SPRING (Ø.125X.38)	120
1	-	21029-5	PIN,SLOTTED SPRING (Ø.188X.75)	119
2	-	1-21002-6	SCREW, SBHC (6-32 x .25) STOP	117
1	-	2-21000-6	SCREW, SHC (8-32 x .38) MTG	116
4	-	21024-4	WASHER, LOCK (#8)	115
2	-	21899-2	WASHER, FLAT (#10)	113
2	-	21024-5	WASHER, LOCK (#10)	112
1	-	1-22202-7	NUT, HEX (5/16-24)	109
1	-	21022-3	NUT,HEX (LOCKING) (10-32)	108
1	-	1-21986-2	RING,RET "E" Ø3/16	107
2	-	21045-3	RING,RET "C" Ø3/16	106
1	-	8-21007-5	SCREW,SKT SET(5/16-24x.75)	105
7	-	2-22733-8	SCREW, BHC (1/4-20X.63)	104
1	-	21009-2	SCREW,SKT SET(1/4-20x.25)	102
6	-	3-21000-8	SCREW, SHC (10-32X.88)	99
2	-	7-21000-6	SCREW, SHC (10-32X.38)	96
1	-	4-21006-5	SCREW, SKT SET (8-32X.62)	94
1	-	21061-9	SCREW, SKT SET (8-32X.25)	93
4	-	2-21000-9	SCREW, SHC (8-32X.75)	91
2	-	1-23030-1	SCREW, SHC (NYLOK)(8-32X.62)	90
4	-	2-22603-3	SCREW, MACH (8-32X.62)	89
2	-	2-21000-8	SCREW, SHC (8-32X.62)	88
1	-	2-21002-1	SCREW, SBHC (8-32X.38)	87
2	-	21001-3	SCREW,SHC (1/4-20X.62)	86
1	-	23030-1	SCREW, SHC(NYLK)(6-32X.25)	84
1	-	457244-2	GUARD	79
1	-	457098-1	AIR FEED ASSEMBLY	78
1	-	694427-1	PLATE, APPLICATOR MOUNTING	77
2	-	21017-2	SCR,DRIVE(#2X.19)ID	76
1	-	461264-1	PLATE, IDENTIFICATION	75
1	-	690603-1	SPRING, ASSIST	72
-5	U/M	PART NO	DESCRIPTION	ITEM NO

QTY	REQD PER ASSY	PART NO	DESCRIPTION	ITEM NO
1	-	318530-3	STOP, WIRE	70
1	-	318529-1	BLOCK, MOUNTING	68
1	-	456987-1	BLOCK, PIVOT	65
1	-	457058-1	PIN, PIVOT	64
1	-	318528-1	CAP, RAM	59
1	-	457079-1	HOUSING	58
1	-	25745-1	RING, SPLIT	56
1	-	240624-1	PIN, FEED FINGER	55
1	-	691499-1	SPRING, FEED FINGER	54
1	-	454568-1	FINGER, FEED	53
1	-	457057-1	ARM, PIVOT	52
1	-	3-21002-5	BOLT, CRIMPER	49
1	-	22353-8	SCREW, SHOULDER	47
1	-	690578-1	BLOCK, INSULATION ADJUST	46
1	-	690191-1	PLUG, NYLON	45
1	-	454574-1	RAM	44
1	-	690125-1	WASHER, LAMINATED	43
1	-	1-690124-1	WASHER, RAM	42
1	-	23241-6	BALL, STEEL	40
1	-	690170-1	SPRING, COMPRESSION	39
1	-	690142-1	DISC, INSULATION	38
1	-	354777-1	WIRE DISC, PLASTIC	37
1	-	22480-5	WASHER, SPRING	36
1	-	690212-1	POST, RAM	35
1	-	3-23846-5	SPRING, HINGE BAR	34
1	-	690573-1	SPACER, SPRING	32
1	-	454569-1	MOUNT, DRAG	31
1	-	1-22354-8	STUD, DRAG	30
1	-	21030-2	PIN, MOUNT, DRAG	29
1	-	1633530-1	PIN, HINGE	28
1	-	684905-1	PLATE, BASE	26
1	-	454579-2	HINGE BAR	25
1	-	690571-1	BLOCK, STABILIZER	24
1	-	690585-1	BLOCK, PRESSURE	23
1	-	22282-5	SPRING, DRAG	22
1	-	21030-6	LEVER, DRAG	21
1	-	454570-1	DRAG, STOCK	20
1	-	454573-1	GUIDE, STRIP (REAR)	19
1	-	318739-6	GUIDE, STRIP (FRONT)	18
1	-	2-22287-6	SPRING, FEED RETURN	16
1	-	1-692134-6	POSITIONER,TERMINAL	14
1	-	692134-6	POSITIONER,TERMINAL	13
1	-	5-22280-5	SPRING,TERM. POSITIONER	12
1	-	454711-1	PLATE, REAR SHEAR	11
1	-	1633080-4	ANVIL INSERT	10
1	-	690569-1	PLATE, FRONT SHEAR	9
1	-	690761-1	ANVIL	8
1	-	454575-4	BLADE, SLUG	7
1	-	684906-1	PLATE,ANVIL RETAINING	5
1	-	690574-1	SPACER,TUBULAR INSUL CRIMPER	4
1	-	690764-1	CRIMPER, INSULATION	3
1	-	690763-4	CRIMPER, WIRE	2
-5	U/M	PART NO	DESCRIPTION	ITEM NO

LOC A  
DIST 66

P	ECR-10-009688	10-2010	MY	GB
P	LTR	REVISION RECORD	DATE	DWN

DIMENSIONS:	TOLERANCES UNLESS OTHERWISE SPECIFIED:
INCHES	0 PLC ±.010
	1 PLC ±.005
	2 PLC ±.003
	3 PLC ±.002
	4 PLC ±.001
ANGLES:	
SURFACE TEXTURE:	✓

DWN	M.YOUNGER	16MAR2009	MATERIAL	-	HEAT TREAT	-
CHK	G.BAILEY	17MAR2009				
APVD	T.ELBIN	17MAR2009				
NAME	END FEED HINGE BAR APPLICATOR					
SCALE	SIZE	DRAWING NO	SHEET	REV		
NTS	A1	687388-5	1 of 1	P		

CUSTOMER ACCESSIBLE PRODUCTION DRAWING