

order number	lens name
0019-002-000-50	inspec.x L 4/60

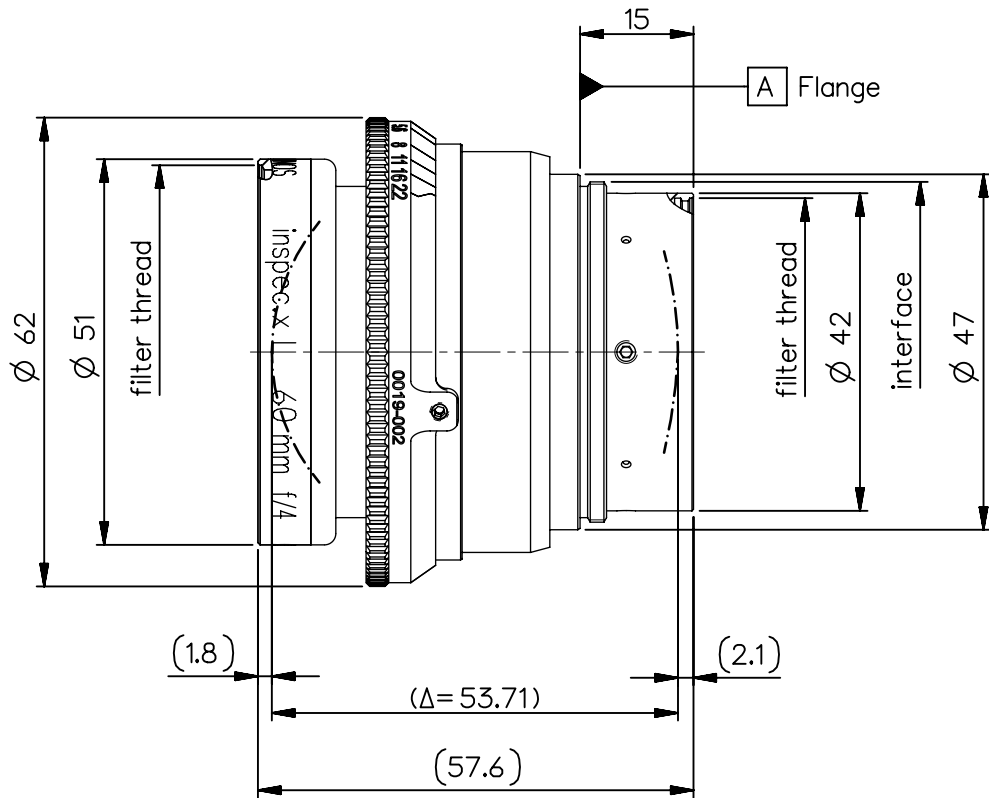

Specification		ON	7721-9011
image circle max. (mm)	70.9	working distance (mm)	334 ... ∞
focal length f' (mm)	60.6	interface	M45x0.75
magnification β' [range]	-0.033 [-0.2 ... 0]	filter thread	M49x0.75 / M40.5x0.5
spectral range λ (nm)	400 - 750	weight (g)	240

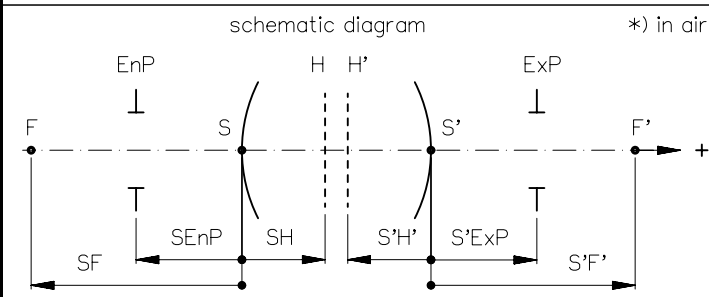

design includes CCD cover glass:		yes / 2mm N-BK7		
SF (mm)	-33.6	f-stop	Ø EnP	Ø Exp
S'F' (mm) *	42.3	4	14.4	14.5
HH' (mm) *	8.5	5.6	10.8	10.9
SH (mm)	26.9	8	7.6	7.6
S'H' (mm) *	-18.3	11	5.5	5.5
S'EnP (mm)	26.6	16	3.8	3.8
S'Exp (mm) *	-18.6	22	2.8	2.8

Schutzvermerk "DIN ISO 16016" beachten	EU-D	AL-T1A	US-D	US-ML	not export controlled
	Rev. a	Aenderung Neuausg	Datum 04.06.18	Freigabe Denk	PDM-Status Freigabe
	zul. Abweichung für Mass, Form & Lage				Maßstab 1:1
	Oberfläche				Werkstoff
Tolerierung				Benennung	
				inspec.x L 1:4 f=60mm	
Ersterstellung 04.06.18 Denk				Zeichnungsnummer	
Prüfung 04.06.18 Stauder				0019-002-100-50-0001a	
DIN A 4				Ersatz für	
Alle Maße in mm, inklusive Oberflächenbehandlung				Blatt 1 von 1	



inspec.x_L_4.0/60

MTF at ratio -0.03 f/ 4.0

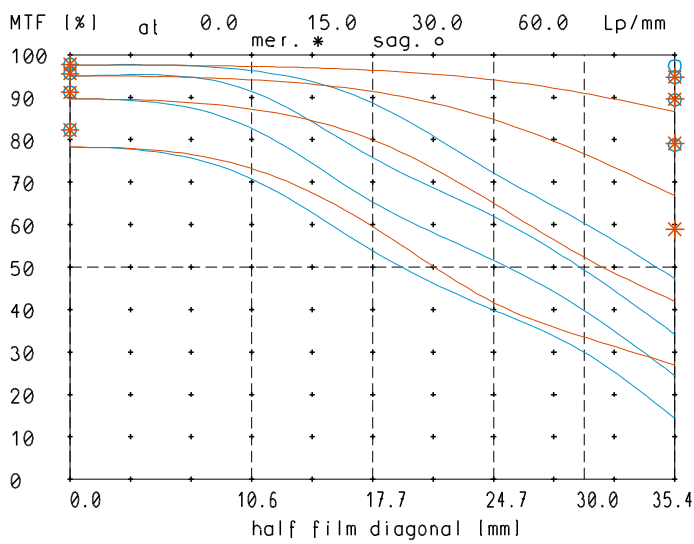

relative light fall-off at ratio -0.03

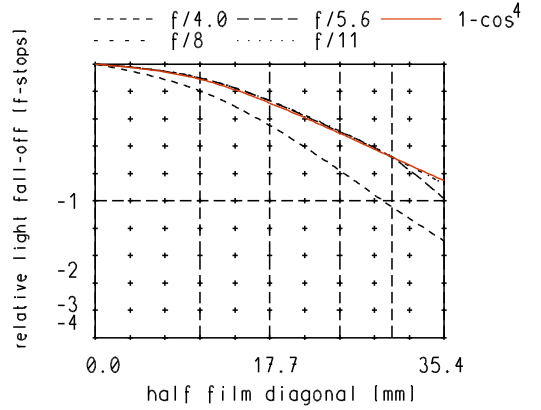

MTF at ratio -0.03 f/ 5.6

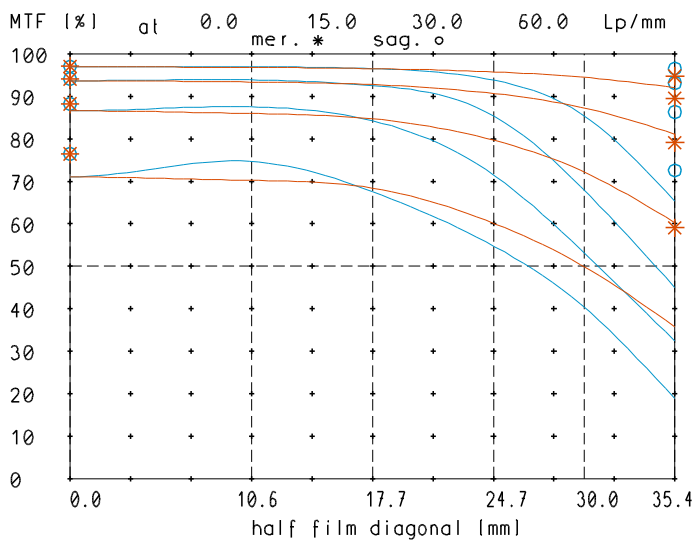

Distortion at ratio -0.02 to -0.05

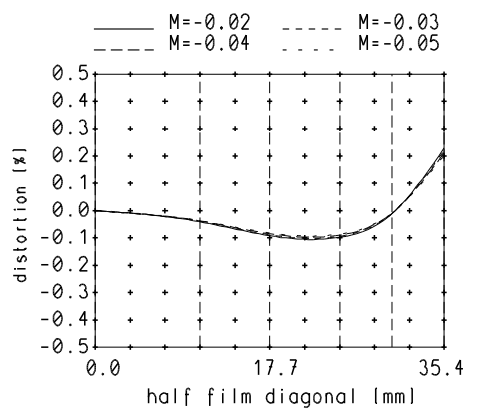

— sagittal, o Diffraction limited value
 — meridional* Diffraction limited value

Longitudinal color aberration at ratio -0.03

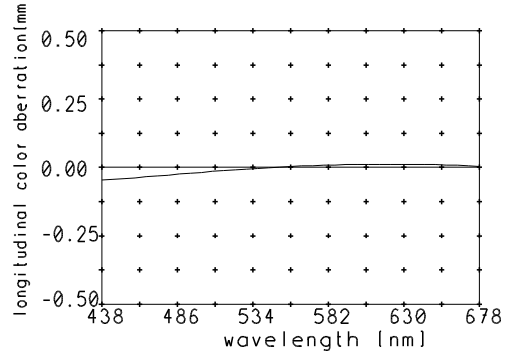

Named frequencies (line pairs/mm) in modular transfer function (MTF) as well as diagrams of relative light fall-off, distortion and longitudinal color aberration refer to film plane.