

used for: D-SUB HD FILTER

5:1

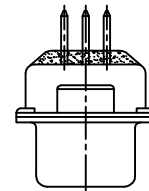
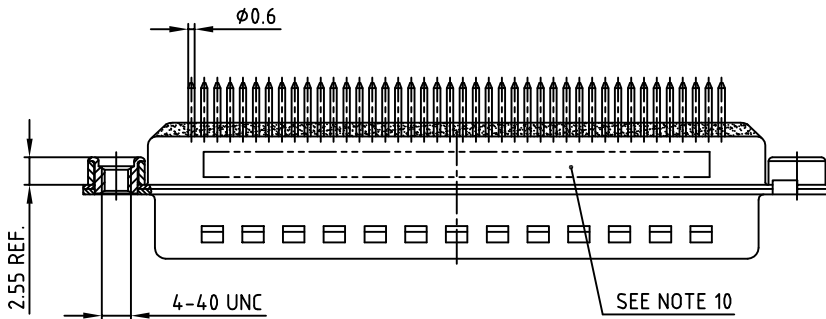
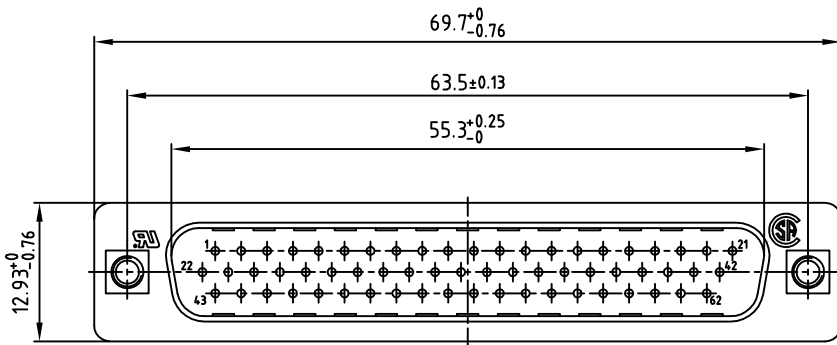
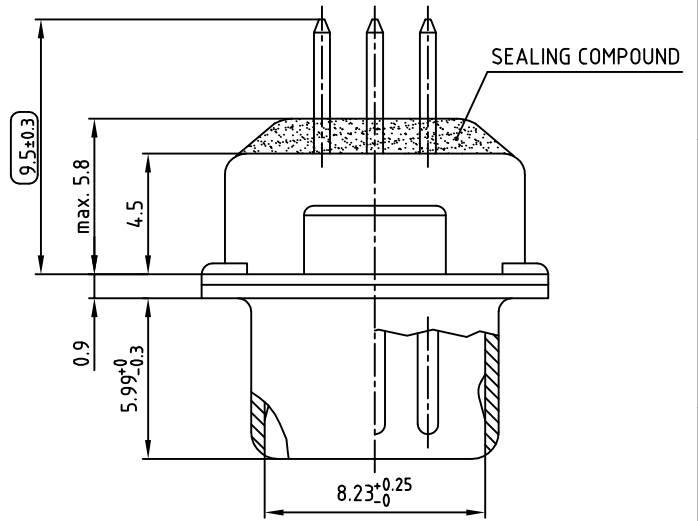

NOTES:

1. METALSHELLS: STEEL; min. 320µ" TIN
2. INSULATORS: PBT GF UL 94 V-0, BLACK
3. CONTACTS: COPPER ALLOY
PLATING: 8µ" HARD GOLD OVER min. 50µ" NICKEL
4. THREADED INSERT: COPPER ALLOY; min. 200µ" TIN over 80µ" NICKEL
5. COLLAR: COPPER ALLOY; min. 200µ" TIN over 80µ" NICKEL
6. P.C.B. HOLE DRILLINGS ON DRAWING NO.: 16V1IH5B
7. CAPACITANCE: SEE TABLE
8. DIELECTRIC WITHSTANDING VOLTAGE: 300V DC
9. MAXIMUM TORQUE VALUE FOR THREAD: 6" LBS
10. CONNECTOR IS PART MARKED: PART-NO. CONEC Y/WW
11. = CHECK DIMENSION

CAPACITANCE	PART NO.
180pF ±20%	241A27550X
370pF ±20%	241A16490X
830pF ±20%	241A16530X

APPROVAL * FREIGABE * DEBLOCAGE * AUTOR/ZACION * APPROVAL	
CUSTOMER APPROVAL DATE:	
NAME:	TITLE:
COMPANY NAME:	
APPROVAL * FREIGABE * DEBLOCAGE * AUTOR/ZACION * APPROVAL	

tolerance			
dim. in mm			
2003	date	name	
drawn	16.09.	Lehmenkühler	
appd.	19.09.	Mickenbecker	
norm	DIN 41652		
d-old			
rev.	description	date	name

scale: 2:1 (5:1)	
material: SEE NOTES	
title: D-SUB HD FILTER MALE 62pos. SOLDER PIN STRAIGHT with threaded insert	
dwg no: AutoCAD 2000	
24K1A449	
part no: SEE TABLE	
DIN-A 3 sh: 1/1	



THIS DRAWING MAY NOT BE COPIED OR REPRODUCED IN ANY WAY, AND MAY NOT BE PASSED ON TO A THIRD PARTY WITHOUT WRITTEN PERMISSION.
 OWNERSHIP AND COPYRIGHT OF CONEC GmbH
 DO NOT ALTER CAD DRAWING BY HAND