

PAGE 1/1	ISSUE 10-04-15A	SERIES MML	PART NUMBER R302000000 XXX
----------	-----------------	------------	-----------------------------------

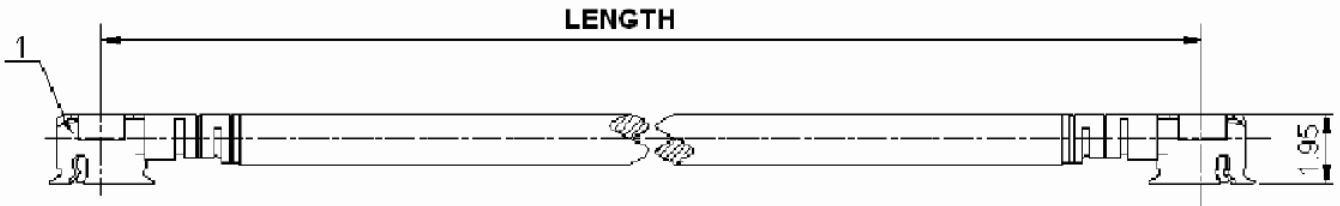

Length=XXX	Step	Tolerance
30 to 100	10	±2
110 to 200		±3
225 to 300	25	±5
325 to 500		±10

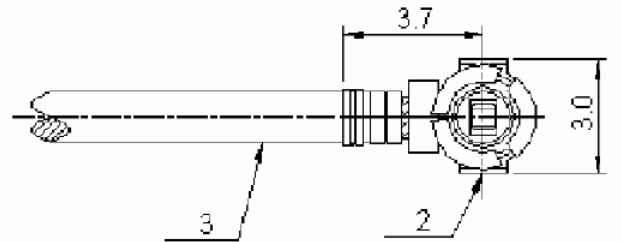

E.g. XXX=070 means length is 70±2, the part number is R302.000.000 070

All dimensions are in mm.

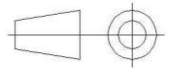

- * 1 * Connector A : **MML H2.5 PLUG (gold plated)**
- * 2 * Connector B : **MML H2.5 PLUG (gold plated)**
- * 3 * Cable **1.37/50S BLACK**
Type

ELECTRICAL CHARACTERISTICS

Impedance		50	Ω
Frequency		0-6	GHz
Operating temperature		-40/+90	° C
VSWR	1.3**	+	0.000 x F(GHz) Maxi
Insertion loss		0.63*	√F(GHz) dB Maxi
Voltage rating		250	Veff Maxi
Dielectric withstanding voltage		300	Veff mini
Insulation resistance		500	MΩ mini

SPECIFICATION

Weight	0.800*	g
Cable retention	4	N mini
Mating life	30	Cycles

Others

****VSWR up to 3GHz 1.3 max
Up to 6GHz 1.5 max**

Length	*Insertion loss(Maxi)	*Weight(Maxi)
30 to 100	0.73 dB	3.00 g
110 to 200	1.16 dB	3.5 g
225 to 400	2.02 dB	4.10 g

Mating status

