

REVISIONS					
#	LTR	DESCRIPTION	DATE	DMN	APVD
E		REVISED PER ECO-18-008015	24MAY2018	AP	DG

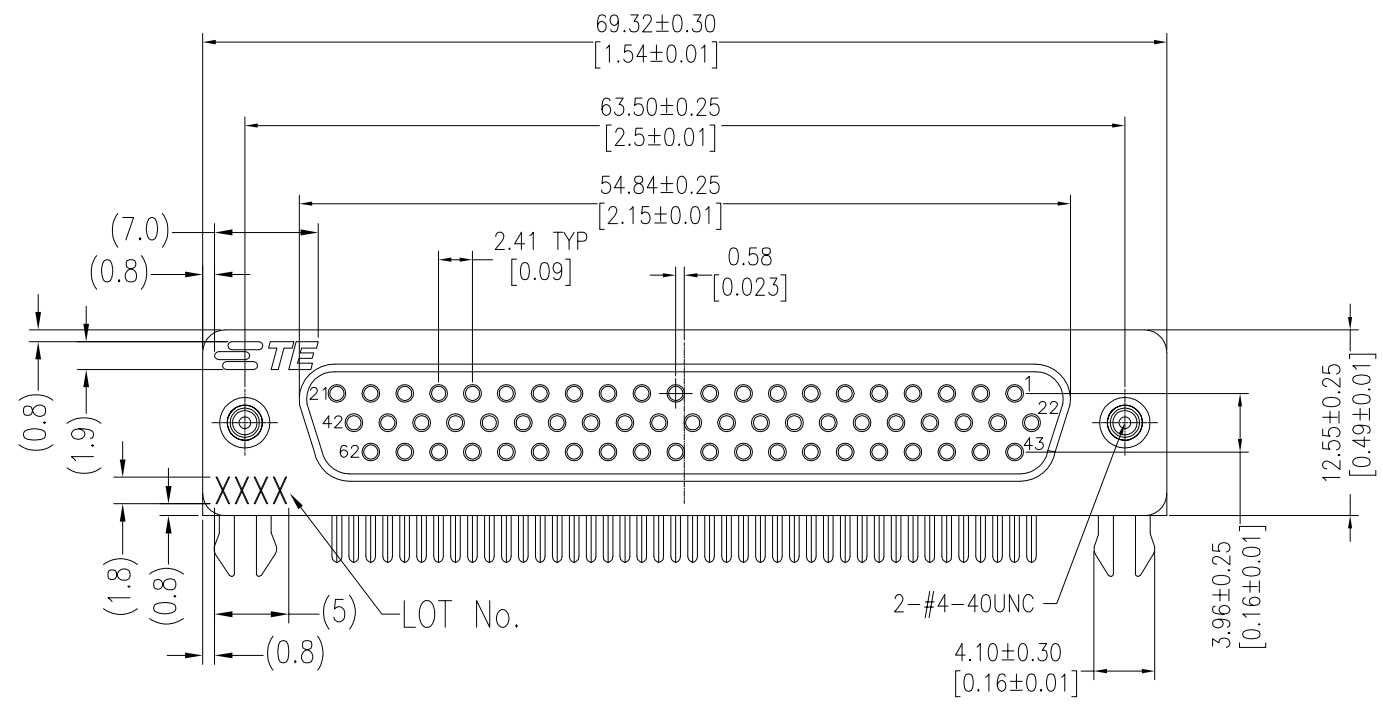

Recommended P.C.B Layout(Top Side)
 (PCB BOARD TOLERANCE±0.05)

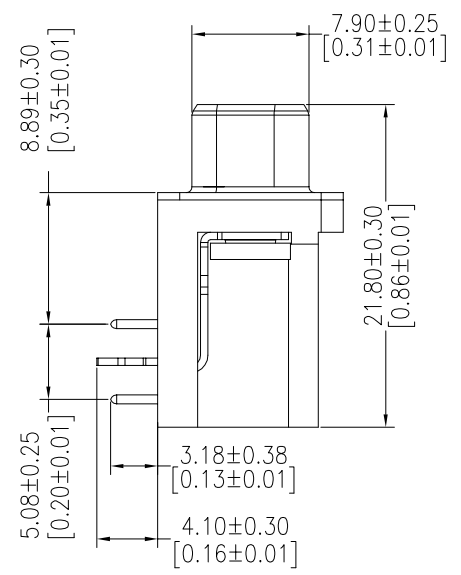
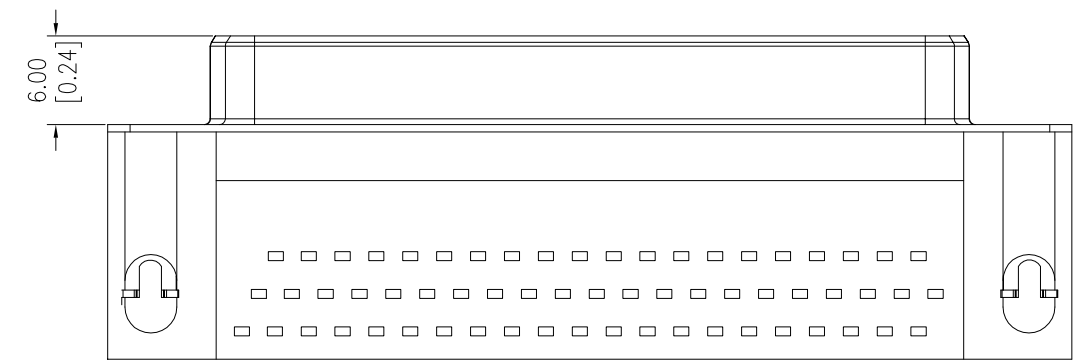
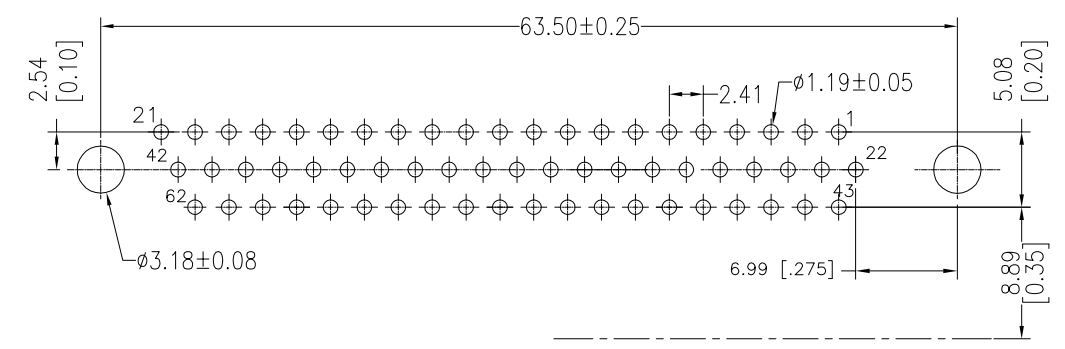

NOTES:
 Insulator:PBT+G.F UL94V-0 BLACK
 Contact:PHOSPHOR BRONZE
 " GOLD PLATING ON CONTACT AREA
 100u" MATTE TIN PLATING ON SOLDER TAIL
 50u" NICKEL UNDERPLATED OVERALL
 Holddown:Brass,100u" TIN OVER 50u" NICKEL
 Sheet: Cold Roller Steel, Ni Plated
 Rivetlock:Brass,Nickel Plated
 LOT NUMBER "XXXX"
 └ Stands For Calendar Year
 └ Stands For Week Number

THREADED	30μAu	2311771-1
TYPE	Contact Area	P/N
	Plating	

THIS DRAWING IS A CONTROLLED DOCUMENT.		DMN AJITH PAI 11MAR2017	TE Connectivity	
DIMENSIONS: mm [INCHES]		CHK DANIEL GORENC 11MAR2017	NAME DANIEL GORENC	
TOLERANCES UNLESS OTHERWISE SPECIFIED:		APVD DANIEL GORENC 11MAR2017	PRODUCT SPEC 108-130023	
0 PLC ± -	1 PLC ± -	APPLICATION SPEC	SIZE	CAGE CODE
2 PLC ± 0.25	3 PLC ± -		A1	00779
4 PLC ± -	ANGLES ± -	FINISH	DRAWING NO	RESTRICTED TO
			2311771	-
MATERIAL		WEIGHT	SCALE	SHEET
			1:1	1 OF 1
CUSTOMER DRAWING		REV E		