

REVISIONS				
SYM	ZONE	ECN, ERN NO.	DATE	APPRD.
A		PROPOSAL	APR8/08	L.CHAN

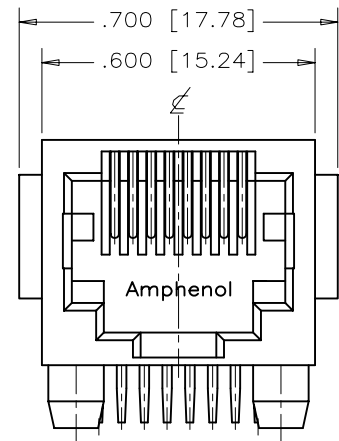

FRONT VIEW

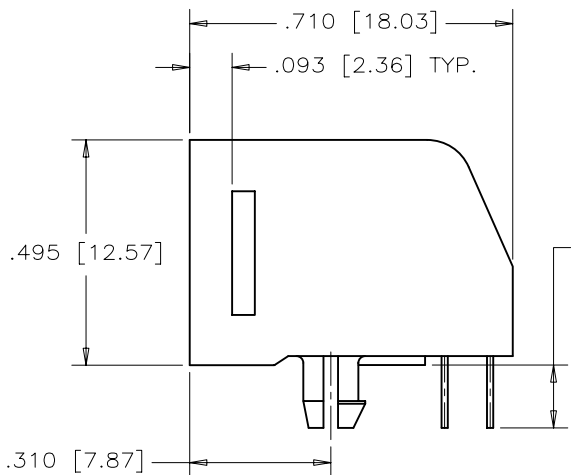

SIDE VIEW

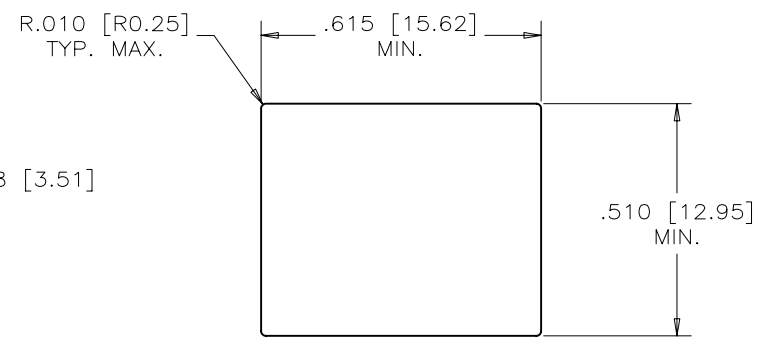

RECOMMENDED PANEL CUTOUT

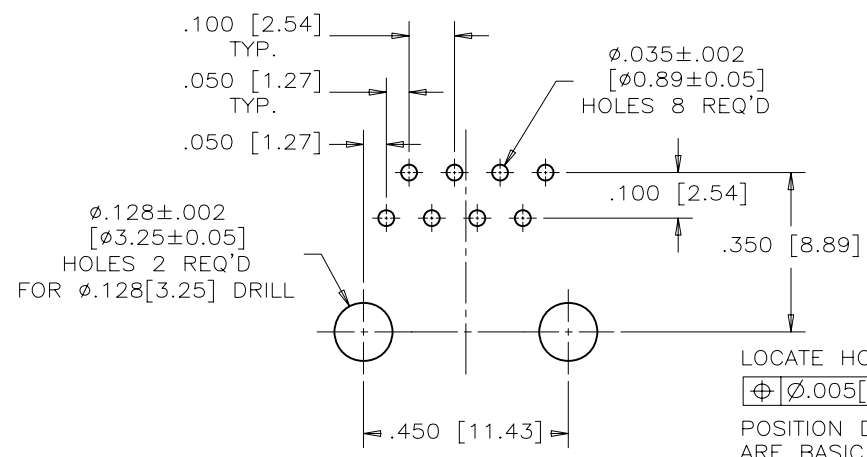

RECOMMENDED P.C.B. LAYOUT
(COMPONENT SIDE OF BOARD)



MATERIALS:

HOUSING: ENGINEERING THERMOPLASTIC
 FLAMMABILITY RATING UL 94V-0
 COLOR: BLACK
 CONTACTS: PHOSPHOR BRONZE
 PLATING: REFER TO PART NUMBER FOR GOLD THICKNESS ON MATING SURFACES.
 50 μ " [1.27 MICRONS] MIN. NICKEL UNDERPLATE
 100 μ " [2.54 MICRONS] MIN. MATTE TIN OR GOLD FLASH ON CONTACT TAILS.

PART NUMBER: RJE03-188-0X20

- 1 = 06 μ " GOLD
- 2 = 15 μ " GOLD
- 3 = 30 μ " GOLD
- 4 = 50 μ " GOLD

THIS DOCUMENT CONTAINS PROPRIETARY INFORMATION AND SUCH INFORMATION MAY NOT BE DISCLOSED TO OTHERS FOR ANY PURPOSE OR USED FOR MANUFACTURING PURPOSES WITHOUT WRITTEN PERMISSION FROM AMPHENOL CANADA CORP.

MATERIAL	DRAWN	J.OUYANG	DATE	APR8/08	Amphenol Canada Corp.			
	DESIGNED	MT.CHAN	APR8/08					
FINISH	CHECKED	L.CHAN	APR8/08	TITLE				
	I. E. APPRD.			MODULAR JACK, 8 POSITION, 8 CONTACTS, WITHOUT SHIELD WITH SIDE FLANGES- RoHS COMPLIANT				
Q. A. APPRD.			DWG. APPRD.			DWG	DRAWING NO.	REV.
ENG. REL. NO.			REF. EAR #A080402			C	P-RJE03-188-0X20	A
DIMENSIONS ARE IN INCHES [mm]			CODE ID. NO. 03554			SCALE	4/1	WT. SURF. SHEET 1 OF 1