

# Wireless Alert CM

Wireless Alert CM is a battery-powered device that can be connected to a volt-free contact and will send a warning email when it detects that the contact has opened or closed. Simply select your settings and connect to your Wi-Fi network using the FilesThruTheAir mobile app.

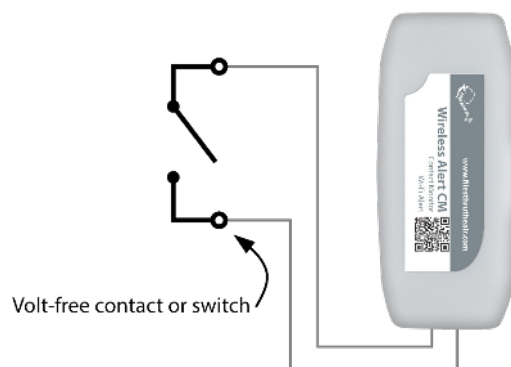

- User-configurable alerts for contact open, closed or both
- Alert delay settings to prevent unwanted alerts
- Customisable alert messages
- Sends email alerts and scheduled status reports
- Wi-Fi connected
- Simple to set up using the free mobile app
- Two years' battery life (typical)
- No ongoing subscription fees
- Includes sticky pad for mounting



The Wireless Alert CM monitors whether a volt-free contact, such as a relay or volt-free switch is open or closed. The device body can be secured in position using an adhesive pad (supplied) and is provided with 1.5m of cable with bare ends, ready to connect to your equipment or switch. The device can be set to trigger a notification email, sent to a user-selected address, if the monitored contact opens, closes, or both. The user can also configure delays (between 1 minute and 12 hours), whereby the contact must remain opened or closed for a certain period of time before an alert is sent. In addition to this, the device can send a scheduled summary email detailing number of alert events, percentage of contact open and closed time, and battery level.

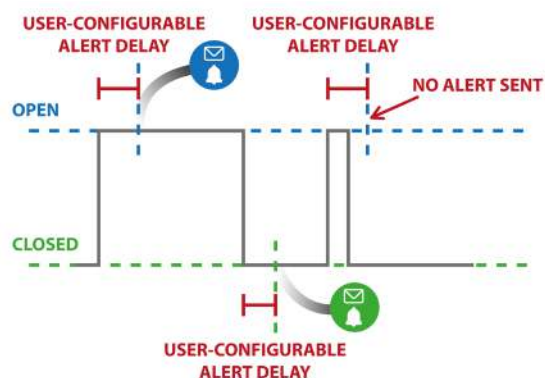

## Specifications

	Minimum	Typical	Maximum	Unit
Device Operating Temperature	-18 (0)		54 (129)	°C (°F)
Alert Notification States	Contacts Open and/or Closed			
Alert Delay Range	1 minute to 12 hours (user-selectable)			
Environmental Conditions	Indoor use only - IP5X			
Product Dimensions	69 x 32 x 22 (2.7 x 1.3 x 0.9)			mm (inches)
Cable length	1500 (59)			mm (inches)
Battery Type	2 x 1.5V Alkaline LR03/UM4/AAA			
Battery Life*	2			Years
Wi-Fi	WPA/WPA-2 Personal - 802.11bgn (2.4GHz)			

Specifications liable to change without prior warning.

Wi-Fi networks cannot be guaranteed to have 100% uptime, this product should therefore not be relied upon as a stand-alone security device.

\* Battery life is dependent on: signal strength between router/access point and Wireless Alert device, presence, volume and type of Wi-Fi traffic from other devices, operating temperature and number of alerts sent.



### DO NOT CONNECT TO MAINS VOLTAGE.

The Wireless Alert CM is designed to monitor volt-free contacts only. If you are unsure, do not connect this product and seek professional advice.

## Other Wi-Fi connected products from FilesThruTheAir™

FilesThruTheAir offer a variety of Wi-Fi connected sensors and data loggers. Visit [www.filesthrutheair.com](http://www.filesthrutheair.com) to find out if we have something to fit your application.

## FilesThruTheAir App

The Wireless Alert CM is simple to set up, using the free FilesThruTheAir app, available on Google Play or the App Store.



[www.filesthrutheair.com/wireless-alert](http://www.filesthrutheair.com/wireless-alert)

FilesThruTheAir™ is a trademark of Corintech Ltd.  
Ashford Mill, Station Road, Fordingbridge, Hampshire, SP6 1DZ, UK