

### 1. SMA Straight Plug ( With Center Contact )

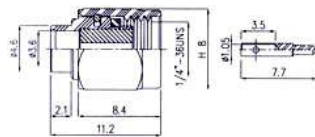

Finish: gold plated center contact & body  
Insulation: Teflon



Semi-Rigid  
Cable -Direct  
Solder Attachment

Ordering Code	Applicable Cable RG/U	Notes
SMA-50PAG0112BRX	RG 402/U (.141")	
SMA-50PAG0113BRX	RG 405/U (.085")	

### 2. SMA Right Angle Plug



Finish: gold plated center contact & body  
Insulation: Teflon

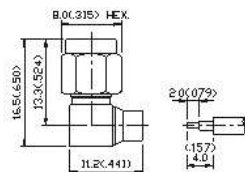

Semi-Rigid  
Cable -Direct  
Solder Attachment

Ordering Code	Applicable Cable RG/U	Notes
SMA-50PAG0612BRX	RG 402/U (.141")	
SMA-50PAG0613BRX	RG 405/U (.085")	

### 3. SMA Straight Jack



Finish: gold plated center contact & body  
Insulation: Teflon

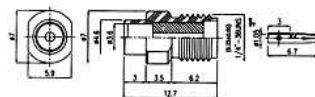

Semi-Rigid  
Cable -Direct  
Solder Attachment

Ordering Code	Applicable Cable RG/U	Notes
SMA-50SAG0112BRX	RG 402/U (.141")	
SMA-50SAG0113BRX	RG 405/U (.085")	

### 4. SMA Straight Bulkhead Jack



Finish: gold plated center contact & body  
Insulation: Teflon

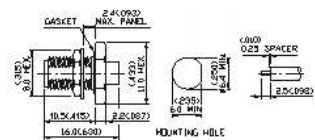

Semi-Rigid  
Cable -Direct  
Solder Attachment

Ordering Code	Applicable Cable RG/U	Notes
SMA-50SAG6412BRX	RG 402/U (.141")	
SMA-50SAG6413BRX	RG 405/U (.085")	

### 5. SMA Straight Square Flange Jack



Finish: gold plated center contact & body  
Insulation: Teflon

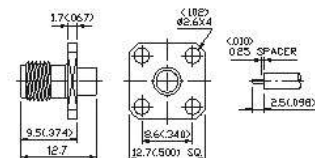

Semi-Rigid  
Cable -Direct  
Solder Attachment

Ordering Code	Applicable Cable RG/U	Notes
SMA-50SAG5612BRX	RG 402/U (.141")	
SMA-50SAG5613BRX	RG 405/U (.085")	

### 6. SMA Straight 2 Hole Flange Jack



Finish: gold plated center contact & body  
Insulation: Teflon

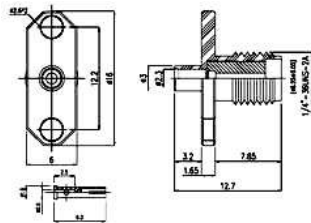

Semi-Rigid  
Cable -Direct  
Solder Attachment

Ordering Code	Applicable Cable RG/U	Notes
SMA-50SAG7812BRX	RG 402/U (.141")	
SMA-50SAG7813BRX	RG 405/U (.085")	

### 7. SMA Straight Plug Clamp



Finish: gold plated center contact & body  
Insulation: Teflon

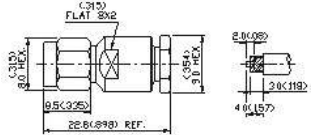

Flexible  
Cable -Clamp  
Attachment

Ordering Code	Applicable Cable RG/U	Notes
SMA-50PAG0704BRX	RG 402/U (.141")	
SMA-50PAG0702BRX	RG 405/U (.085")	

### 8. SMA Right Angle Plug Crimp



Finish: gold plated center contact & body  
Insulation: Teflon

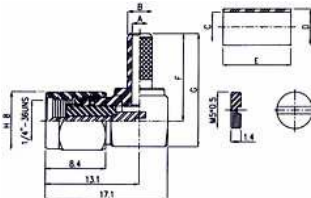

Flexible  
Cable -Clamp  
Attachment

Ordering Code	Applicable Cable RG/U	Notes
SMA-50PAG0404BRX	58,58A,141A	
SMA-50PAG0402BRX	174,188A,316	
SMA-50PAG0416BRX	142B/U	

### 9. SMA Stright Plug Crimp

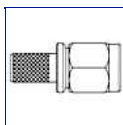

Finish: gold plated center contact & body  
Insulation: Teflon

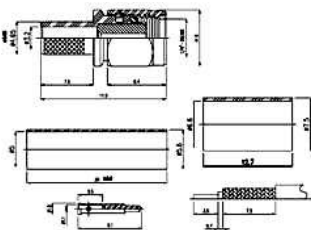

Flexible  
Cable -Clamp  
Attachment

Ordering Code	Applicable Cable RG/U	Notes
SMA-50PAG0321BRX	RG-142/U.223	

### 10. SMA Straight Plug Crimp



Finish: gold plated center contact & body  
Insulation: Teflon

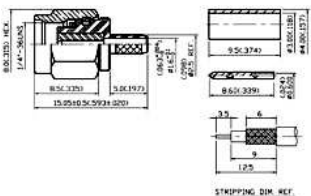

Flexible  
Cable -Clamp  
Attachment

Ordering Code	Applicable Cable RG/U	Notes
SMA-50PAG0304BRX	58,58A,141A	L=17.8mm
SMA-50PAG0302BRX	174,188A,316	L=16.3mm
SMA-50PAG0316BRX	142B/U	L=17.8mm

### 11. SMA Straight Jack Crimp

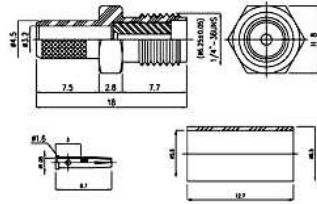

Flexible  
Cable -Clamp  
Attachment

Finish: gold plated center contact & body  
Insulation: Teflon

Ordering Code	Applicable Cable RG/U	Notes
SMA-50SAG0304BRX	58,58A,141A	L=17.5mm
SMA-50SAG0302BRX	174,188A,316	L=16.0mm

### 12. SMA Straight Bulkhead Jack Crimp

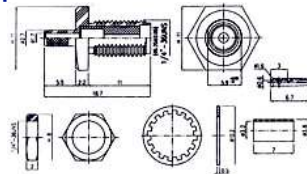

Flexible  
Cable -Clamp  
Attachment

Finish: gold plated center contact & body  
Insulation: Teflon

Ordering Code	Applicable Cable RG/U	Notes
SMA-50SAG6404BRX	58,58A,141A	L=20.2mm
SMA-50SAG6402BRX	174,188A,316	L=18.8mm
SMA-50SAG6416BRX	142B/U	L=20.2mm

### 13. SMA Square Flange Plug Receptacle ( Solder Pot Contact )

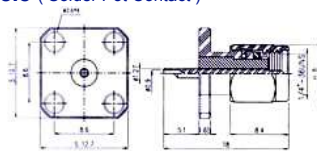

Panel Mount  
Receptacle (Solder  
Pot Contact)

Finish: gold plated center contact & body  
Insulation: Teflon

Ordering Code
SMA-50PAG5899BRX

### 14. SMA Square Flange Jack Receptacle ( Solder Pot Contact )

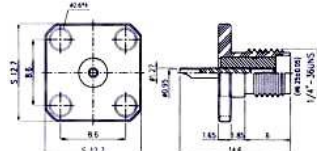

Panel Mount  
Receptacle (Solder  
Pot Contact)

Finish: gold plated center contact & body  
Insulation: Teflon

Ordering Code
SMA-50SAG5899BRX

### 15. SMA 2 Hole Flange Plug Receptacle ( Solder Pot Contact )

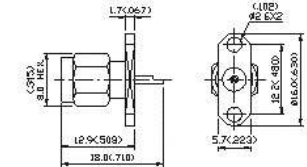

Panel Mount  
Receptacle (Solder  
Pot Contact)

Finish: gold plated center contact & body  
Insulation: Teflon

Ordering Code
SMA-50PAG5999BRX

### 16. SMA 2 Hole Jack Receptacle ( Solder Pot Contact )

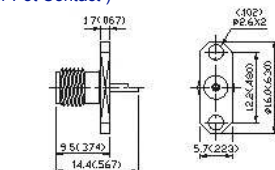

Panel Mount  
Receptacle (Solder  
Pot Contact)

Finish: gold plated center contact & body  
Insulation: Teflon

Ordering Code
SMA-50SAG5999BRX

### 17. SMA Square Flange Jack Receptacle ( Exposed Teflon )

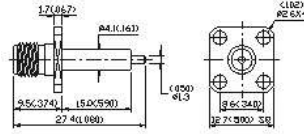

Panel Mount  
Receptacle  
(Exposed Teflon)

Finish: gold plated center contact & body  
Insulation: Teflon

Ordering Code
SMA-50SAG6999BRX

### 18. SMA 2 Hole Flange Jack Receptacle ( Exposed Teflon )

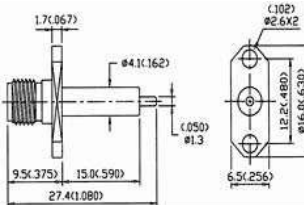

Panel Mount  
Receptacle (Exposed  
Teflon)

Finish: gold plated center contact & body  
Insulation: Teflon

Ordering Code
SMA-50SAG6199BRX
SMA-50SAG6152BRX

### 19. SMA Square Flange Plug Receptacle (Tab Contact)

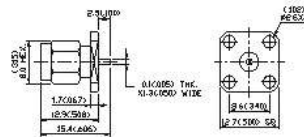

Panel Mount  
Receptacle (Tab  
Contact)

Finish: gold plated center contact & body  
Insulation: Teflon

Ordering Code
SMA-50PAG6299BRX

### 20. SMA Square Flange Jack Receptacle (Tab Contact)



Click on the picture  
for a detailed view

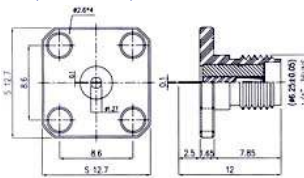

Panel Mount  
Receptacle (Tab  
Contact)

Finish: gold plated center contact & body  
Insulation: Teflon

Ordering Code
SMA-50SAG6299BRX

### 21. SMA 2 Hole Flange Plug Receptacle (Tab Contact)

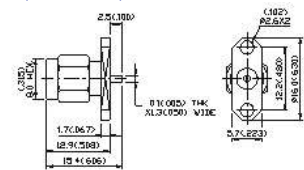

Panel Mount  
Receptacle (Tab  
Contact)

Finish: gold plated center contact & body  
Insulation: Teflon

Ordering Code
SMA-50PAG6399BRX

### 22. SMA 2 Hole Flange Jack Receptacle (Tab Contact)

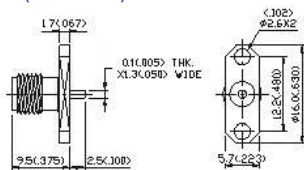

Panel Mount  
Receptacle (Tab  
Contact)

Finish: gold plated center contact & body  
Insulation: Teflon

Ordering Code
SMA-50SAG6399BRX

### 23. SMA Square Flange Plug Receptacle (For Microstrip Line Circuits)

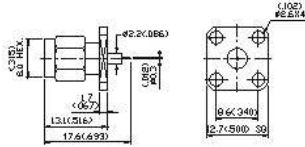

Panel Mount Receptacle (For Microstrip Line Circuits)

Finish: gold plated center contact & body  
Insulation: Teflon

Ordering Code
SMA-50PAG5599BRX

### 24. SMA Square Flange Plug Receptacle (For Microstrip Line Circuits)

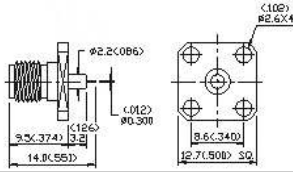

Panel Mount Receptacle (For Microstrip Line Circuits)

Finish: gold plated center contact & body  
Insulation: Teflon

Ordering Code
SMA-50SAG5599BRX

### 25. SMA 2 Hole Flange Jack Receptacle (For Microstrip Line Circuits)

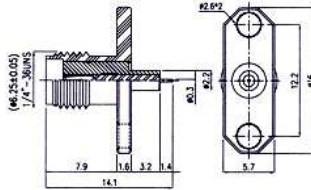

Panel Mount Receptacle (For Microstrip Line Circuits)

Finish: gold plated center contact & body  
Insulation: Teflon

Ordering Code
SMA-50SAG5499BRX

### 26. SMA Square Flange Jack Receptacle (For Microstrip Line Circuits)

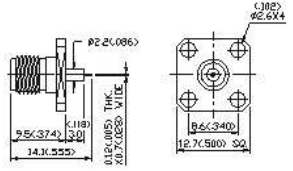

Panel Mount Receptacle (For Microstrip Line Circuits)

Finish: gold plated center contact & body  
Insulation: Teflon

Ordering Code
SMA-50SAG6250BRX

### 27. SMA 2 Hole Flange Jack Receptacle (For Microstrip Line Circuits)

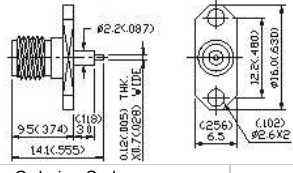

Panel Mount Receptacle (For Microstrip Line Circuits)

Finish: gold plated center contact & body  
Insulation: Teflon

Ordering Code	Contact horizontal to panel
SMA-50SAG6354BRX	

### 28. SMA Right Angle Square Flange Jack Receptacle (Exposed Teflon)

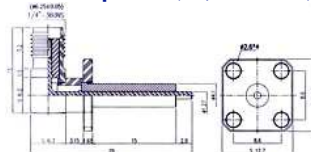

Panel Mount Receptacle (Exposed Teflon)

Finish: gold plated center contact & body  
Insulation: Teflon

Ordering Code
SMA-50SAG6956BRX

### 29. SMA Square Flange Jack Receptacle (Blunt Post Contact)



Finish: gold plated center contact & body  
Insulation: Teflon

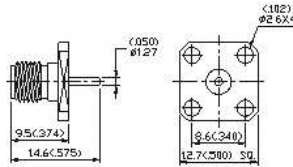

Panel Mount  
Receptacle (Blunt  
Post Contact)

Ordering Code	
SMA-50SAG6099BRX	Captivated
SMA-50SAG6052BRX	Epoxy Captivated

### 30. SMA 2 Hole Flange Jack Receptacle ( Blunt Post Contact )



Finish: gold plated center contact & body  
Insulation: Teflon

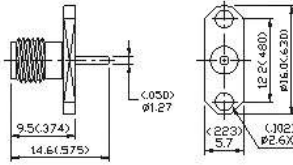

Panel Mount  
Receptacle (Blunt  
Post Contact)

Ordering Code	
SMA-50SAG7960BRX	

### 31. SMA Square Flange Jack Receptacle ( Half Round Contact )



Finish: gold plated center contact & body  
Insulation: Teflon

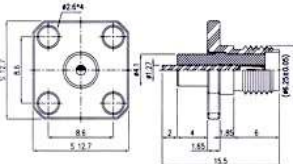

Panel Mount  
Receptacle (Half  
Round Contact)

Ordering Code	
SMA-50SAG7450BRX	

### 32. SMA 2 Hole Flange Jack Receptacle ( Half Round Contact )



Finish: gold plated center contact & body  
Insulation: Teflon

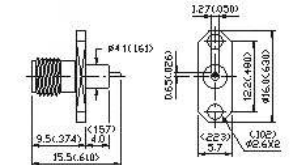

Panel Mount  
Receptacle (Half  
Round Contact)

Ordering Code	
SMA-50SAG5050BRX	

### 33. SMA Straight Bulkhead Jack Receptacle ( Front Mount )



Finish: gold plated center contact & body  
Insulation: Teflon

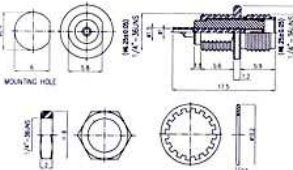

Bulkhead Mount  
Receptacle (Solder  
Pot Contact)

Ordering Code	
SMA-50SAG7361BRX	

### 34. SMA Straight Bulkhead Jack Receptacle ( Rear Mount )



Finish: gold plated center contact & body  
Insulation: Teflon

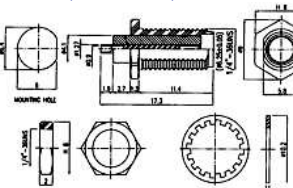

Bulkhead Mount  
Receptacle (Solder  
Pot Contact)

Ordering Code	
SMA-50SAG6461BRX	

### 35. SMA Straight PCB Mount Jack Receptacle

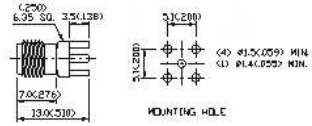

Printed Circuit Board Receptacle

Finish: gold plated center contact & body  
Insulation: Teflon

Ordering Code
SMA-50SAG5199BRX

### 36. SMA Right Angle PCB Mount Jack Receptacle

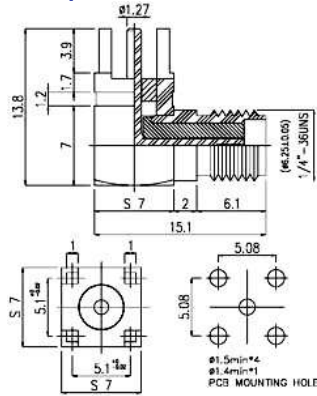

Printed Circuit Board Receptacle

Finish: gold plated center contact & body  
Insulation: Teflon

Ordering Code
SMA-50SAG7599BRX

### 37. SMA Straight Surface Mount Jack Receptacle

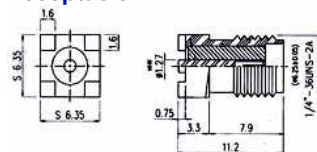

Surface Mount Receptacle

Finish: gold plated center contact & body  
Insulation: Teflon

Ordering Code
SMA-50SAG7650BRX

### 38. SMA Right Angle Surface Mount Jack Receptacle

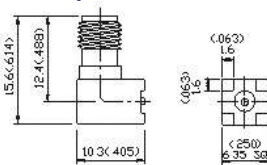

Surface Mount Receptacle

Finish: gold plated center contact & body  
Insulation: Teflon

Ordering Code
SMA-50SAG7656BRX

### 39. SMA End Launch Jack Receptacle

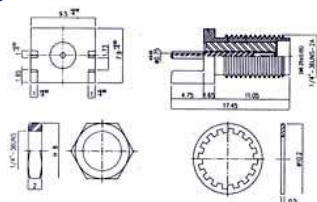

End Launch Jack Receptacle

Finish: gold plated center contact & body  
Insulation: Teflon

Ordering Code	Notes
SMA-50SAG7762BRX	center contact 50 $\mu$ '' gold plated
SMA-50SAG7762BRX	center contact 30 $\mu$ '' gold plated

### 40. SMA Bulkhead Jack-Jack In-series Adapter



Finish: gold plated center contact & body  
Insulation: Teflon

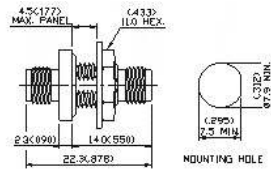

In-Series Adapter

Ordering Code  
SMAS-SMASAG02X

41. SMA Plug-Plug In-series Adapter



Finish: gold plated center contact & body  
Insulation: Teflon

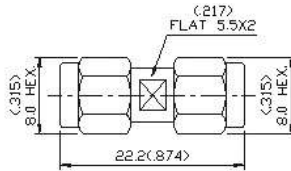

In-Series Adapter

Ordering Code  
SMAP-SMAPAG01X

42. SMA Jack-Jack In-series Adapter



Finish: gold plated center contact & body  
Insulation: Teflon

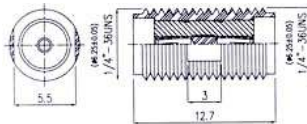

In-Series Adapter

Ordering Code  
SMAS-SMASAG01X

For other plating options contact factory

43. SMA Right Angle PCB Mount Jack Receptacle



Finish: gold plated center contact & body  
Insulation: Teflon

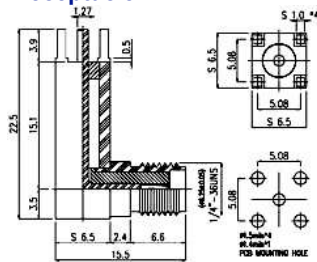

Printed Circuit Board Receptacle

Ordering Code  
SMA-50SAG7567BRX

For other plating options contact factory