

## SMP Terminations

With emergence of 5G market, the SMP interfaces become more popular. Midwest Microwave is now offering its SMP terminations through distribution to complement variety of SMP connectors offerings of its sister brand Johnson. Midwest Microwave is a leader in microwave components manufacturing and utilizes its QPL design and manufacturing expertise into the SMP terminations.

### Features

- DC to 18 GHz operation
- Interface per MIL-STD-348A, SMP series
- Complements Johnson's SMP offering for 5G market
- SMP terminations made by M39030 qualified manufacturer

Part Number	Description
TRM-2109-F0-SMP-09	SMP Female Termination

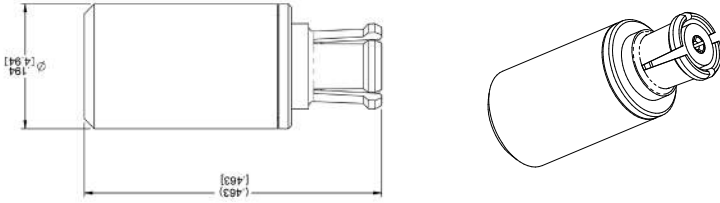

Part Number	Description
TRM-2109-M0-SMP-09	SMP Male Termination

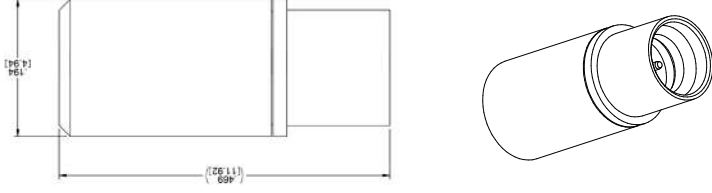

# SMP Termination Specifications



Materials	
Body	Gold plated beryllium copper
Dielectric	PTFE (Teflon)
Center Contact	Gold plated beryllium copper
Environmental	
Operating Temperature	-65°C to +125°C
Thermal Shock	Per MIL-STD-202, Method 107, Condition B
Mechanical Shock	Per MIL-STD-202, Method 213, Condition 1
Salt Spray	Per MIL-STD-202, Method 101, Condition B
Electrical	
Frequency of Operation	DC-18GHz
Impedance	50 Ohms
VSWR	1.20:1 (max.)
Average Power	2W Max @ 25°C derated to 1W @ 125°C
Mechanical	
Interface	Per MIL-STD-348A, Series SMP
Mating Durability	100 Matings
Center Contact Retention	1.5 lbs minimum axial
Engagement Force	15.0 lbs maximum full detent
Disengagement Force	5.0 lbs minimum full detent



© 2019 Cinch Connectivity Solutions

**Asia-Pacific**  
 +86 21 5442 7668  
 ccs.asia.sales@as.cinch.com  
 CinchConnectivity@eu.cinch.com  
 +44 (0) 1245 342060  
 Europe, Middle East  
 North America  
 +1 507 833 8822  
 ccsorders@us.cinch.com  
[belfuse.com/cinch](http://belfuse.com/cinch)