



Electrical specifications

Center Frequency: 2593 MHz
Bandwidth: 194 MHz
Input / Output Impedance: 50 Ohms
Passband: 2496–2690 MHz
Passband Insertion Loss:
Passband Ripple: 2496–2690 MHz 1.00 dB
Passband Return Loss: 2496–2690 MHz -10.00 dB
Rejection: 0.1 – 2300 MHz -40.00 dB
Rejection 2: 2900 – 4000 MHz -40.00 dB
Power Handling: 2 Watt max

Mechanical

Mounting Method: SMT
Dimensions: 10.20 x 7.60 x 4 mm

Environmental

Operating Temperature: -40°C to +85°C
Storage Temperature: -50°C to +90°C



This product is RoHs compliant.

Mechanical Drawing

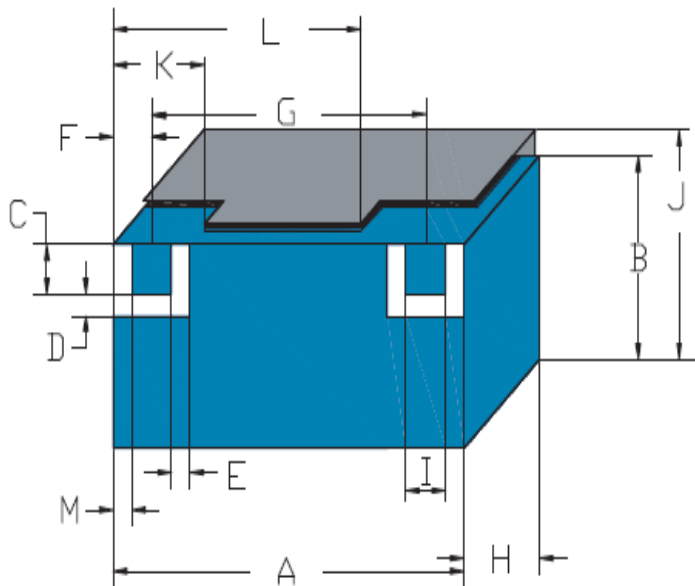

Dim	Nominal (mm)	Tolerance (mm) +/- or max
A	10.20	Max
B	6.60	Max
C	1.60	0.13
D	0.80	0.13
E	0.80	0.13
F	1.20	0.13
G	7.80	0.13
H	4.00	Max
I	1.40	0.13
J	7.60	Max
K	2.70	0.13
L	7.50	0.13
M	0.50	0.13



Response Plot:

