

© - TE Connectivity. All Rights Reserved.

| REVISIONS |     |               |           |        |
|-----------|-----|---------------|-----------|--------|
| P         | LTR | DESCRIPTION   | DATE      | APVD   |
|           | L5  | ECR-22-138429 | 19MAY2022 | LP DSC |

**AMP**  
WIRE RANGE

14 AWG  
STRANDED

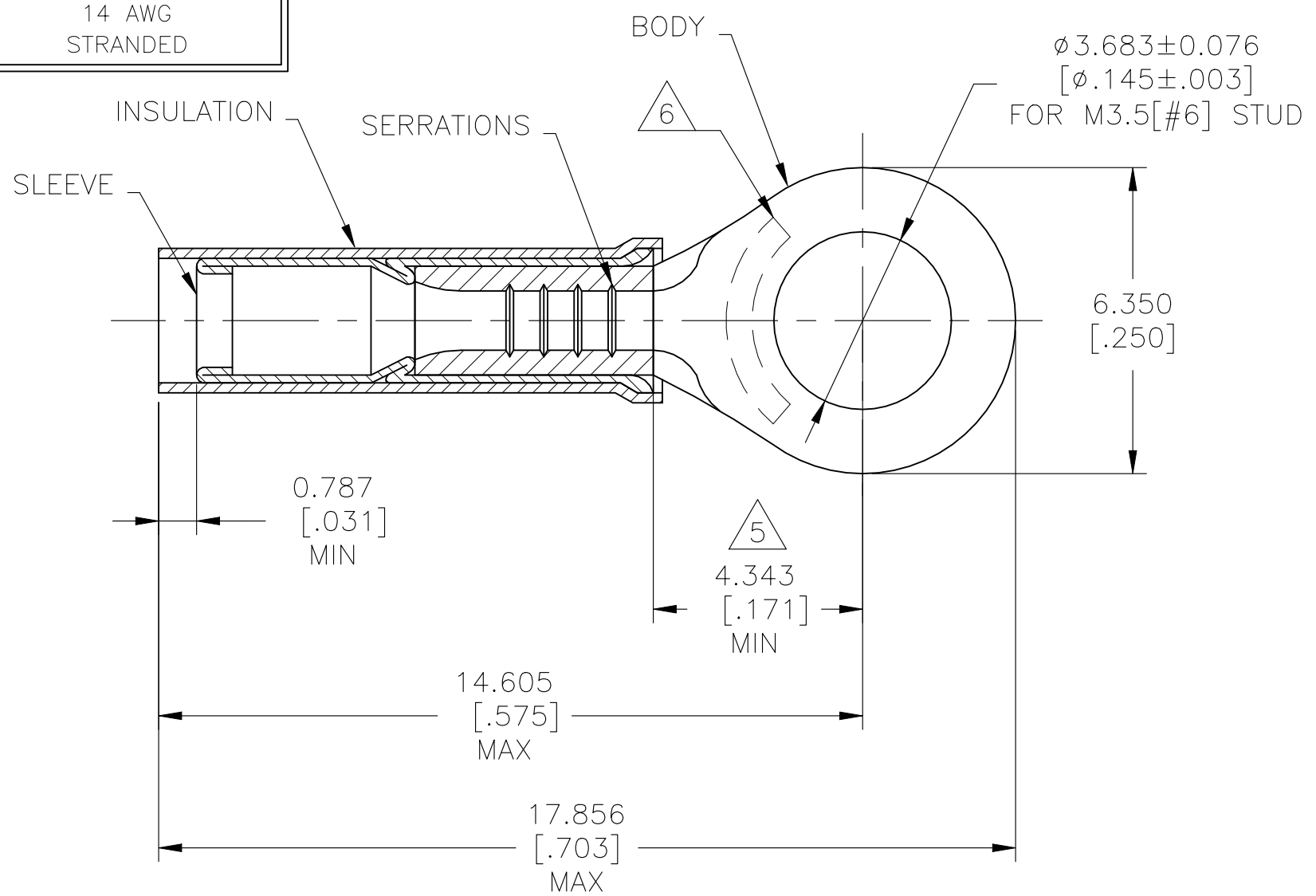

- 1 MATERIAL:  
BODY & SLEEVE - COPPER PER ASTM B152  
INSULATION - PTFE PER ASTM D4895
- FINISH:  
BODY - NICKEL PLATE 0.00762[.00030]  
AVG EXT THK PER SAE AMS-QQ-N-290  
SLEEVE - NICKEL PLATE 0.001651[.000065]  
AVG EXT THK PER SAE AMS-QQ-N-290  
INSULATION COLOR - WHITE
- 2 FOR 2.032[.080] TO 3.810[.150] WIRE INSULATION DIA.
- 3 BODY MATERIAL THK: 0.787±0.051 [.031±.002]
- 4 NOTE DELETED
- 5 DIMENSION APPLIES FROM EDGE OF METAL WIRE BARREL TO CENTER OF STUD HOLE
- 6 STAMP "AMP 14" APPROX AS SHOWN

|      |              |          |
|------|--------------|----------|
| 1000 | LOOSE PIECE  | 50839-1  |
| QTY  | PACKAGE TYPE | PART NO. |

|  |  |  |  |   |                                     |                            |                  |       |  |            |               |
|--|--|--|--|---|-------------------------------------|----------------------------|------------------|-------|--|------------|---------------|
| AMP INCORPORATED<br>CUSTOMER SERVICE SYSTEMS                                     |  | MAX RECOMMENDED OPERATING TEMPERATURE:<br>288°C [550°F]    | THIS DRAWING IS A CONTROLLED DOCUMENT. |   | DWN 130CT2015<br>NAGALAKSHMI K      | <b>STE</b> TE Connectivity |                  |       |  |            |               |
| FOR ADDITIONAL PRODUCT INFORMATION OR COPIES OF DRAWINGS AND TECHNICAL DOCUMENTS | PRODUCT INFORMATION CENTER<br>1-800-522-6752 | VOLTAGE RATING:<br>300V MAX                                | DIMENSIONS:<br>mm [INCHES]             | TOLERANCES UNLESS OTHERWISE SPECIFIED:  | CHK 130CT2015<br>MERCURIO MAURIZIO  |                            |                  |       | NAME<br>TERMINAL, RING TONGUE,<br>PIDG, STRATO-THERM,<br>WIRE SIZE: 14 AWG |            |               |
| FOR APPLICATION TOOLING INFORMATION  | TOOLING ASSISTANCE CENTER<br>1-800-722-1111  | CIRCULAR MIL AREA:<br>2.15mm²[4,234]<br>STRANDED WIRE ONLY |  | 0 PLC ± -<br>1 PLC ± -<br>2 PLC ± -<br>3 PLC ± 0.127[.005]<br>4 PLC ± - ± -<br>ANGLES | APVD 130CT2015<br>MERCURIO MAURIZIO | PRODUCT SPEC               | APPLICATION SPEC | SIZE  | CAGE CODE  | DRAWING NO | RESTRICTED TO |
| FOR ORDER ENTRY  | 1-800-526-5142                               |  | MATERIAL                               | FINISH  |                                     |                            | 114-2162         | A3    | 00779  | C-50839    |               |
| CUSTOMER DRAWING   |  |  |  |   |                                     | WEIGHT                     |                  |       |  |            |               |
|  |  |  |  |   |                                     | SCALE                      | NTS              | SHEET | 1 OF 1   | REV        | L5            |