

0.50mm CENTER FLAT FLEX CABLE (FFC) (105°C, Au PLATING)

"L" DIM. →	30 ± 2 MM		51 ± 2 MM		76 ± 3 MM		102 ± 3 MM		127 ± 4 MM		152 ± 4 MM		178 ± 4 MM		203 ± 4 MM		229 ± 5 MM		254 ± 5 MM		305 ± 5 MM	
REF DIM →	(1.18 INCH)		(2 INCHES)		(3 INCHES)		(4 INCHES)		(5 INCHES)		(6 INCHES)		(7 INCHES)		(8 INCHES)		(9 INCHES)		(10 INCHES)		(12 INCHES)	
CABLE TYPE →	A	D	A	D	A	D	A	D	A	D	A	D	A	D	A	D	A	D	A	D	A	D
CIRCUITS ↓																						
7	150200745	150200744	150200747	150200746	150200749	150200748	150200751	150200750	150200753	150200752	150200755	150200754	150200757	150200756	150200759	150200758	150200761	150200760	150200763	150200762	150200765	150200764
9	150200767	150200766	150200769	150200768	150200771	150200770	150200773	150200772	150200775	150200774	150200777	150200776	150200779	150200778	150200781	150200780	150200783	150200782	150200785	150200784	150200787	150200786
11	150200789	150200788	150200791	150200790	150200793	150200792	150200795	150200794	150200797	150200796	150200799	150200798	150200801	150200800	150200803	150200802	150200805	150200804	150200807	150200806	150200809	150200808
13	150200811	150200810	150200813	150200812	150200815	150200814	150200817	150200816	150200819	150200818	150200821	150200820	150200823	150200822	150200825	150200824	150200827	150200826	150200829	150200828	150200831	150200830
15	150200833	150200832	150200835	150200834	150200837	150200836	150200839	150200838	150200841	150200840	150200843	150200842	150200845	150200844	150200847	150200846	150200849	150200848	150200851	150200850	150200853	150200852
17	150200855	150200854	150200857	150200856	150200859	150200858	150200861	150200860	150200863	150200862	150200865	150200864	150200867	150200866	150200869	150200868	150200871	150200870	150200873	150200872	150200875	150200874
19	150200877	150200876	150200879	150200878	150200881	150200880	150200883	150200882	150200885	150200884	150200887	150200886	150200889	150200888	150200891	150200890	150200893	150200892	150200895	150200894	150200897	150200896
21	150200899	150200898	150200901	150200900	150200903	150200902	150200905	150200904	150200907	150200906	150200909	150200908	150200911	150200910	150200913	150200912	150200915	150200914	150200917	150200916	150200919	150200918
23	150200921	150200920	150200923	150200922	150200925	150200924	150200927	150200926	150200929	150200928	150200931	150200930	150200933	150200932	150200935	150200934	150200937	150200936	150200939	150200938	150200941	150200940
25	150200943	150200942	150200945	150200944	150200947	150200946	150200949	150200948	150200951	150200950	150200953	150200952	150200955	150200954	150200957	150200956	150200959	150200958	150200961	150200960	150200963	150200962
27	150200965	150200964	150200967	150200966	150200969	150200968	150200971	150200970	150200973	150200972	150200975	150200974	150200977	150200976	150200979	150200978	150200981	150200980	150200983	150200982	150200985	150200984
29	150200987	150200986	150200989	150200988	150200991	150200990	150200993	150200992	150200995	150200994	150200997	150200996	150200999	150200998	150201001	150201000	150201003	150201002	150201005	150201004	150201007	150201006
31	150201009	150201008	150201011	150201010	150201013	150201012	150201015	150201014	150201017	150201016	150201019	150201018	150201021	150201020	150201023	150201022	150201025	150201024	150201027	150201026	150201029	150201028
33	150201031	150201030	150201033	150201032	150201035	150201034	150201037	150201036	150201039	150201038	150201041	150201040	150201043	150201042	150201045	150201044	150201047	150201046	150201049	150201048	150201051	150201050
35	150201053	150201052	150201055	150201054	150201057	150201056	150201059	150201058	150201061	150201060	150201063	150201062	150201065	150201064	150201067	150201066	150201069	150201068	150201071	150201070	150201073	150201072
37	150201075	150201074	150201077	150201076	150201079	150201078	150201081	150201080	150201083	150201082	150201085	150201084	150201087	150201086	150201089	150201088	150201091	150201090	150201093	150201092	150201095	150201094
39	150201097	150201096	150201099	150201098	150201101	150201100	150201103	150201102	150201105	150201104	150201107	150201106	150201109	150201108	150201111	150201110	150201113	150201112	150201115	150201114	150201117	150201116
41	150201119	150201118	150201121	150201120	150201123	150201122	150201125	150201124	150201127	150201126	150201129	150201128	150201131	150201130	150201133	150201132	150201135	150201134	150201137	150201136	150201139	150201138
43	150201141	150201140	150201143	150201142	150201145	150201144	150201147	150201146	150201149	150201148	150201151	150201150	150201153	150201152	150201155	150201154	150201157	150201156	150201159	150201158	150201161	150201160
45	150201163	150201162	150201165	150201164	150201167	150201166	150201169	150201168	150201171	150201170	150201173	150201172	150201175	150201174	150201177	150201176	150201179	150201178	150201181	150201180	150201183	150201182
47	150201185	150201184	150201187	150201186	150201189	150201188	150201191	150201190	150201193	150201192	150201195	150201194	150201197	150201196	150201199	150201198	150201201	150201200	150201203	150201202	150201205	150201204
49	150201207	150201206	150201209	150201208	150201211	150201210	150201213	150201212	150201215	150201214	150201217	150201216	150201219	150201218	150201221	150201220	150201223	150201222	150201225	150201224	150201227	150201226



0.155 mm POLYESTER

CROSS-SECTION

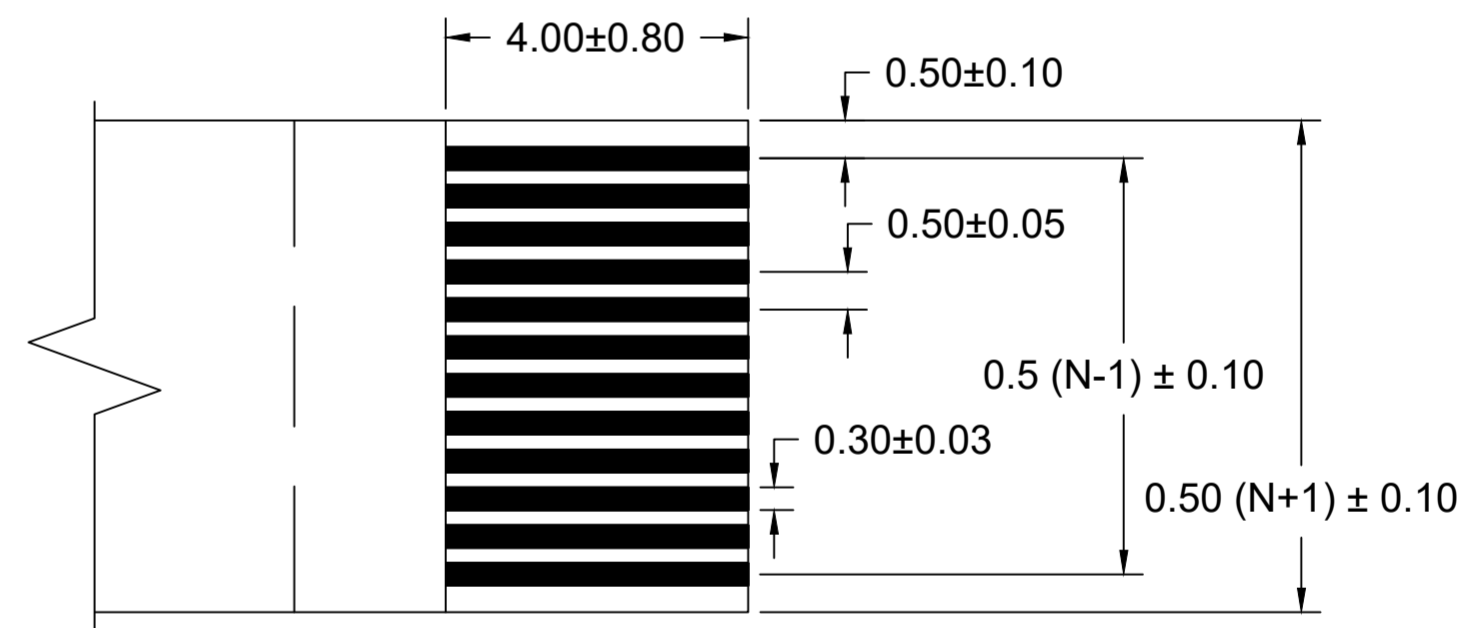

END TAIL DETAIL
SCALE 10:1

NOTES:

1. NO PRINTING ON JUMPER CABLE UNLESS OTHERWISE SPECIFIED. IF PRINTING IS REQUIRED, THEN IT WOULD BE CONSIDERED A SPECIAL JUMPER CABLE.

THIS DRAWING CONTAINS INFORMATION THAT IS PROPRIETARY TO MOLEX ELECTRONIC TECHNOLOGIES, LLC AND SHOULD NOT BE USED WITHOUT WRITTEN PERMISSION														
DIMENSION UNITS			SCALE			CURRENT REV DESC: TOLERANCES UPDATED								
MM			NA											
GENERAL TOLERANCES (UNLESS SPECIFIED)						EC NO: 735490								
			mm			INCH			DRWN: DIEGOG7	2023/01/18				
4 PLACES			±----			±----			CHK'D: JSMITH11		2023/01/26			
3 PLACES			±----			±----			APPR: JSMITH11		2023/01/26			
2 PLACES			±----			±----			INITIAL REVISION:					
1 PLACE			±----			±----			DRWN: MIMIG					
0 PLACES			±----			±----			APPR: DRASMUSS	2010/01/04				
ANGULAR TOL ± 0.5 °						THIRD ANGLE PROJECTION			DRAWING	SERIES	DOCUMENT NUMBER			
DRAFT WHERE APPLICABLE MUST REMAIN WITHIN DIMENSIONS						C-SIZE			15020	MATERIAL NUMBER	CUSTOMER	DOC TYPE DOC PART REVISION		
										SD-15020-001		PSD	001	C
										SEE CHART	GENERAL MARKET		SHEET NUMBER	
												2 OF 2		