

LOC		DIST		REVISIONS			
P	LTR	DESCRIPTION	DATE	DWN	APVD		
S1		REVISED PER ECO-08-009162	17APR08	DH	AS		
S2		REVISED PER ECO-09-024717	06NOV09	KK	AEG		

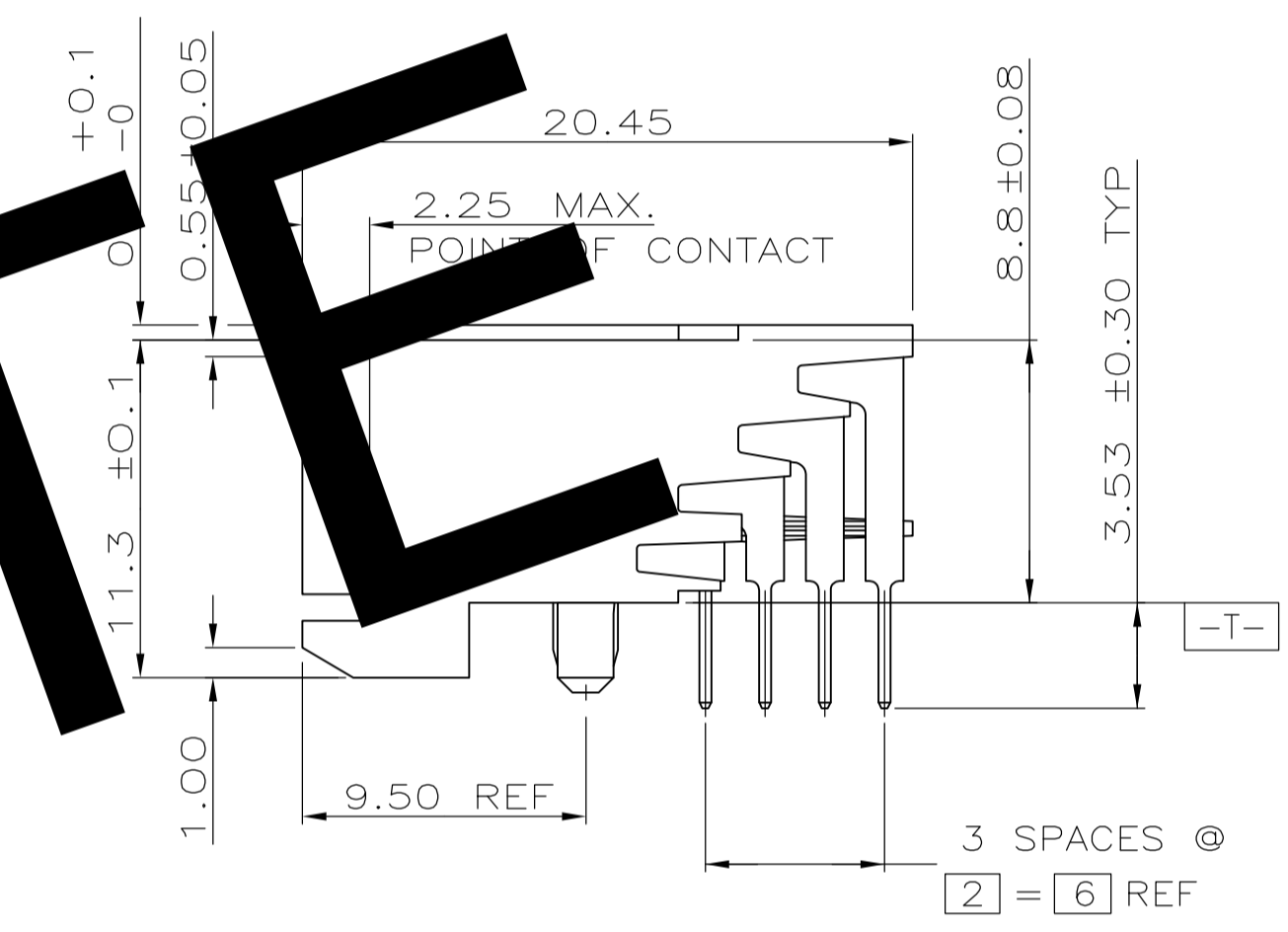
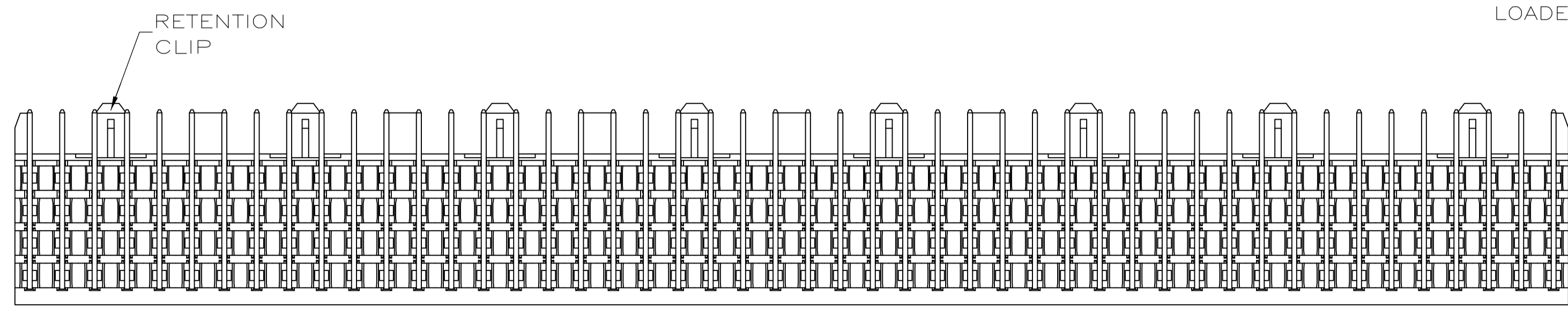
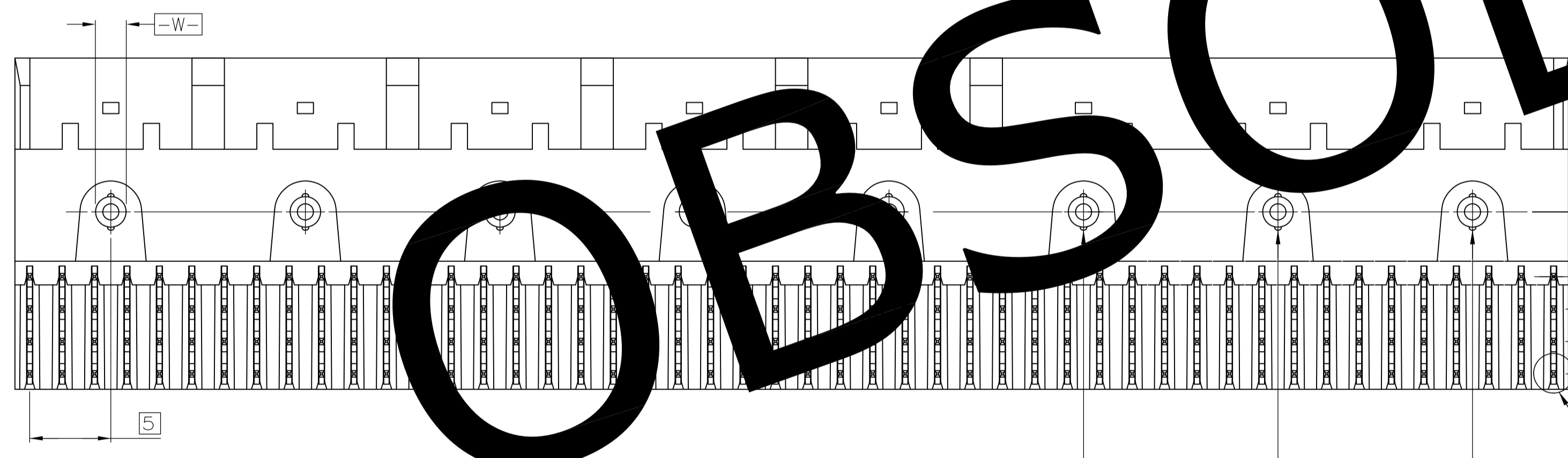
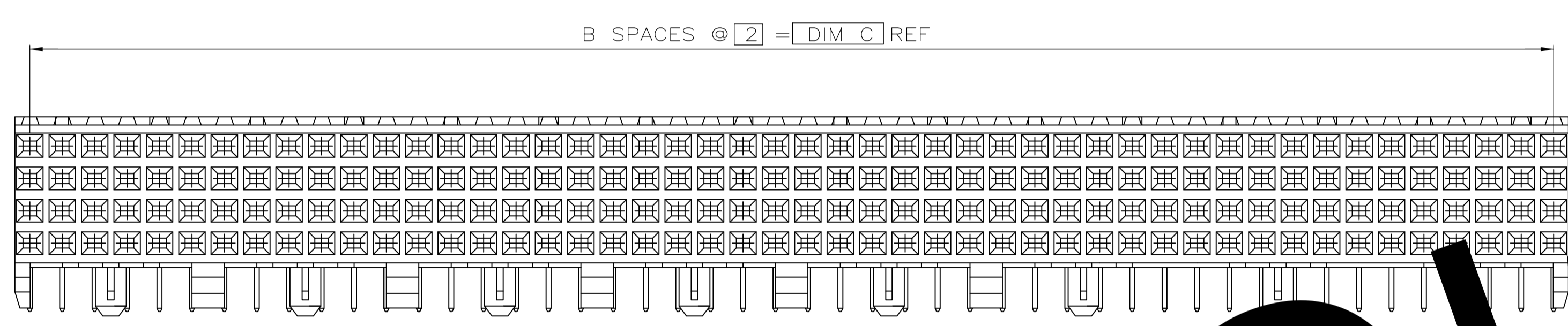
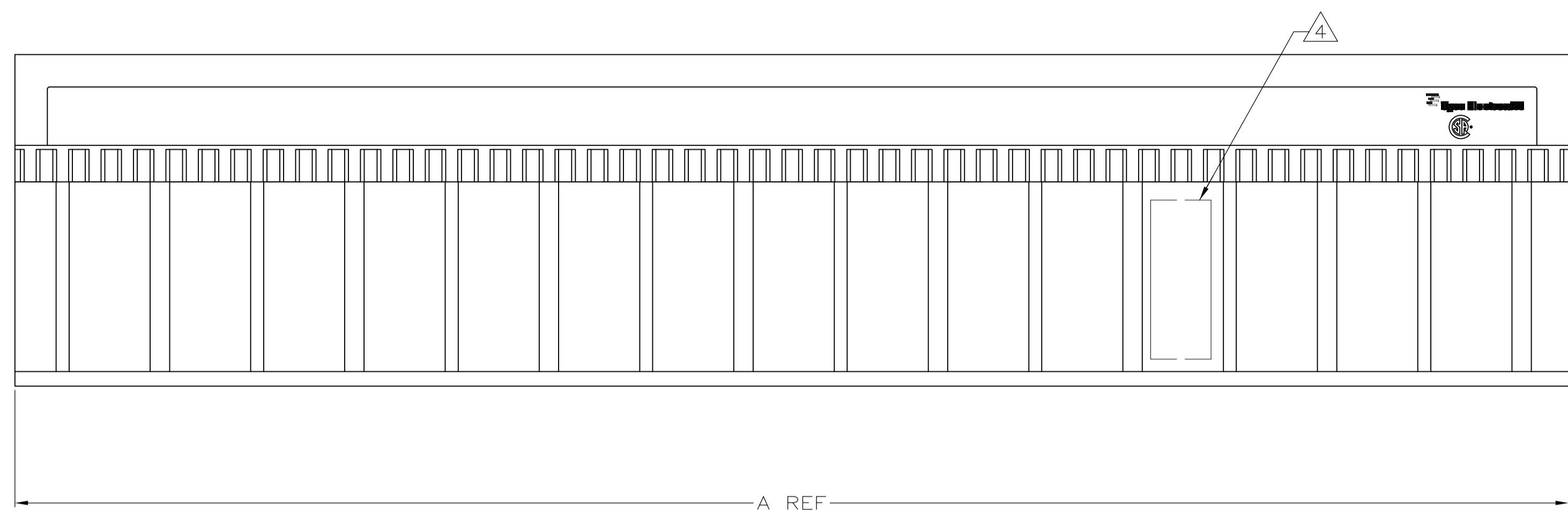

OBSOLETE

NO COLD-HOLD CLIP LOADED IN THIS POST

THIS DRAWING IS A CONTROLLED DOCUMENT.		DIN J.LOCONDRO 01/03/94	Tyco Electronics Tyco Electronics Corporation Harrisburg, Pa 17105-3608	
DIMENSIONS: mm		CHK D.R.BAECHTLE 1/10/94	NAME RECEPTACLE ASSEMBLY, SIGNAL MODULE, Z-PACK 2mm FB, 4 ROW, 3.53mm LEAD LENGTH	
TOLERANCES UNLESS OTHERWISE SPECIFIED:		APVD D.R.BAECHTLE 1/10/94	SIZE A1	RESTRICTED TO
0. PLC ± -	1. PLC ± -	APPLICATION SPEC	CAGE CODE DRAWING NO	SCALE 4:1
2. PLC ± 0.13	3. PLC ± -	WEIGHT	A1 00779 C=536520	SHEET 1 OF 2
4. PLC ± -	ANGLES ± -	CUSTOMER DRAWING	REV S2	

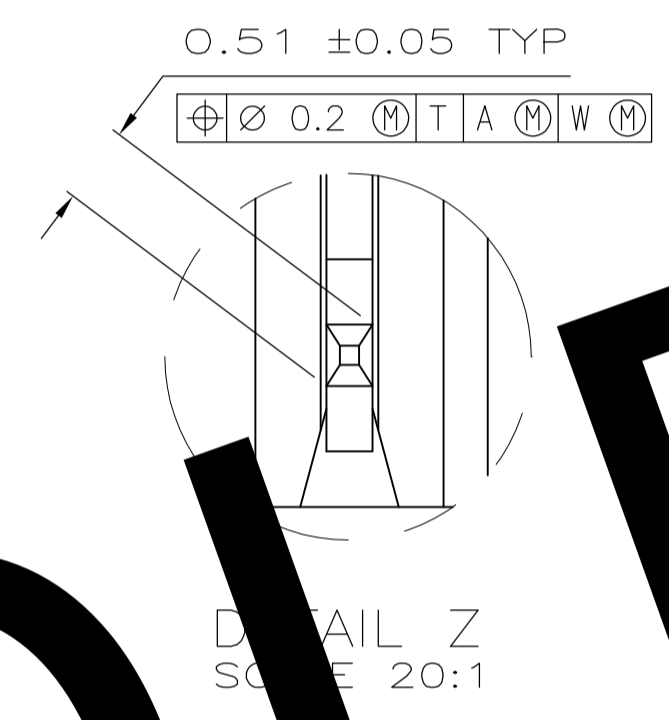
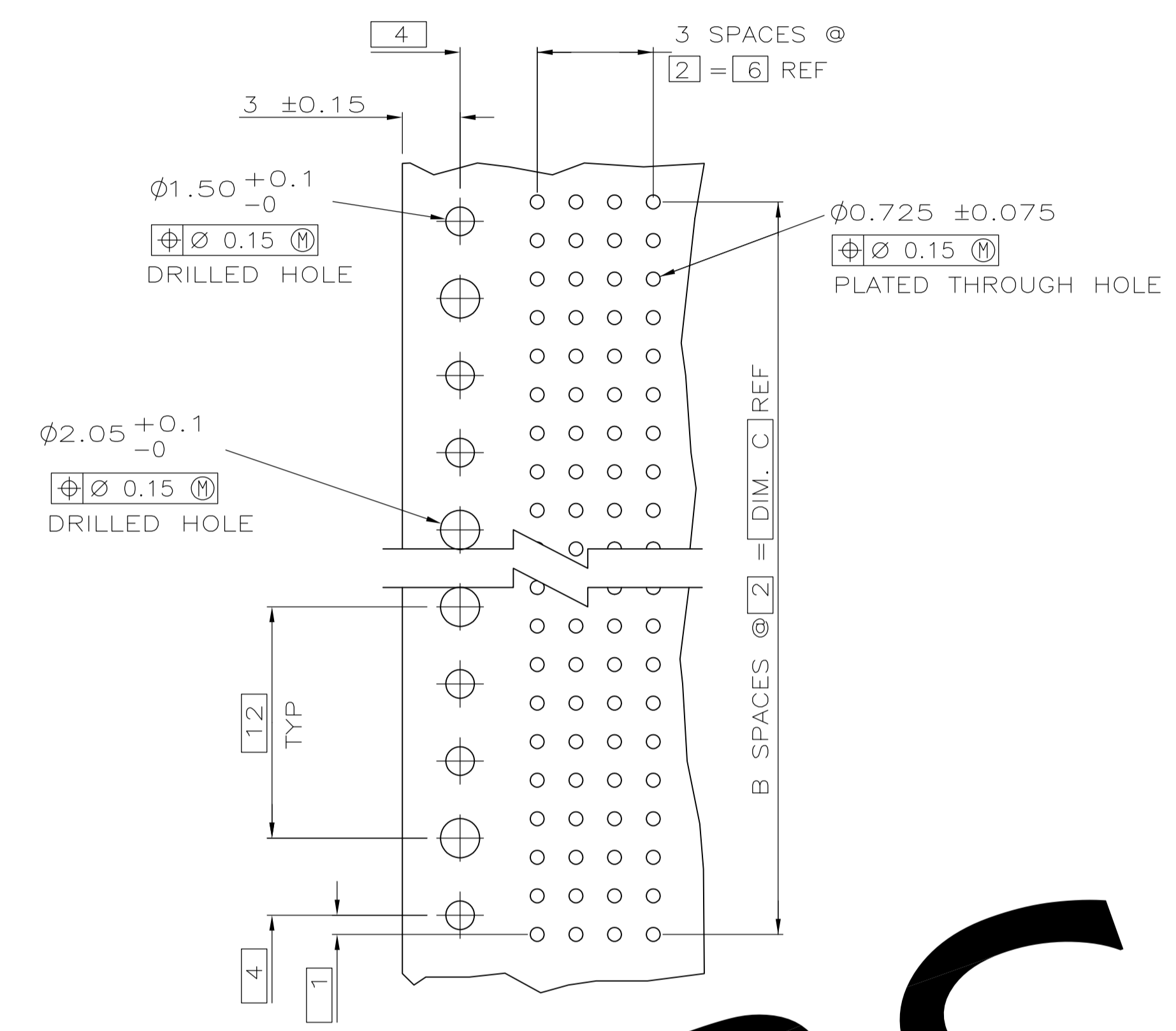

RECOMMENDED CIRCUIT PATTERN
 FOR 700 TYPICAL CLASS
 (COMPONENT)

OBSOLETE

- ① HOUSING MATERIAL: LIQUID CRYSTAL POLYMER.
COLOR: NATURAL.
- ② CONTACT MATERIAL: PHOSPHOR-BRONZE.
- ③ CONTACT FINISH:
UNDERPLATE (ENTIRE CONTACT) –
0.00127 MIN. NICKEL
ON MATING SURFACES–
CONFORMS TO ALL TESTING SPECIFIED FOR TELCORDIA
UNCONTROLLED ENVIRONMENT
ON LEADS–
0.00381 MIN. TIN-LEAD, OVER UNDERPLATE
LUBRICATION (ENTIRE CONTACT):
SURFACE CONDITIONER PER TYCO SPEC 112-1002 AFTER PLATING.
- ④ PART MARKING PER AMP INCORPORATED SPECIFICATION 115-9009, LOCATED APPROXIMATELY AS SHOWN.
- ⑤ OBSOLETE PARTS: OBSOLETE CIS STREAMLINING PER D.RENAUD/D.SINISI

⑤ OBSOLETE	94	47	95.88	③	192	-536520-1-
	C	B	A	FINISH	NO OF POSN	PART NUMBER

THIS DRAWING IS A CONTROLLED DOCUMENT.		DIN	J.LOCONDRO	01/03/94	Tyco Electronics Corporation Harrisburg, Pa 17105-3608	
DIMENSIONS: mm		CHK	D.R.BAECHTLE	1/10/94	NAME	
TOLERANCES UNLESS OTHERWISE SPECIFIED:		APVD	D.R.BAECHTLE	1/10/94	RECEPTACLE ASSEMBLY, SIGNAL MODULE, Z-PACK 2mm FB, 4 ROW, 3.53mm LEAD LENGTH	
0 PLC	± -	APPLICATION SPEC				
1 PLC	± -	SIZE	A1	CAGE CODE	00779	DRAWING NO
2 PLC	± 0.13	WEIGHT	C=536520			
3 PLC	± -	CUSTOMER DRAWING				
4 PLC	± -	SCALE	4:1	SHEET	2 OF 2	REV
ANGLES	± -					S2