

RECOMMENDED PCB LAYOUT (TOP VIEW)

MATERIAL
 INSULATOR: GLASS-REINFORCED THERMOPLASTIC.
 CONTACT: COPPER ALLOY.
 PLATING: GILD OVER NICKEL.
 SOLDER AREA - TIV/LEAD OVER NICKEL.

ELECTRICAL
 VOLTAGE RATING: 250 VAC RMS.
 CURRENT RATING: 1 AMP.
 DELTA I: WITHSTANDING VOLTAGE: 500 VAC RMS @ 50 HZ FOR 1 MINUTE.
 INSULATION RESISTANCE: 1000 MEGOHMS MIN AT 500 VDC.
 CONTACT RESISTANCE: 30 MILLIOHMS MAX.

MECHANICAL
 RETENTION FORCE: 480 GRAMS MIN PER CONTACT.
 INSERTION FORCE: 230 GRAMS MAX PER CONTACT PAIR.
 WITHDRAWAL FORCE: 15 GRAMS MIN PER CONTACT PAIR.
 ENVIRONMENTAL
 TEMPERATURE RANGE: -55°C TO +85°C.

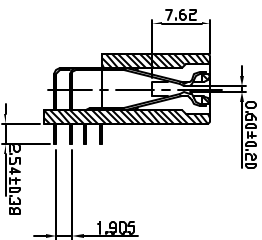

TOLERANCE	
LINEAR	ANGLES
X.±0.20	X.±
X±0.15	X±
XX±0.10	XX±
XXX±0.05	XXX±

Sullins Electronics
 San Marcos, CA
 WWW.SULLINSELECTRONICS.COM

TITLE: 64 BIT PCI CONN , 3.3V TYPE RIGHT ANGLE
 PART NO. TRWB0920KAV-1329
 DWG NO. 1329

REV	ECN NO.	NAME	DATE	APPD.	CHKD.	FINISH:	MATL:	UNITS	SCALE	SHEET	REV
A	0601	Jason	90.06.01					MM	2 : 1	1 OF 1	A

1	2	3	4	5	6	7	8
E	D	C	B	A	A	B	A