

THIS COPY IS PROVIDED ON A RESTRICTED BASIS AND IS NOT TO BE USED IN ANY WAY DETRIMENTAL TO THE INTERESTS OF PANDUIT CORP.

PANDUIT PART NO.	WEIGHT
T130DMC	7.8 LB/100 PCS (3.54 Kg/100 PCS)

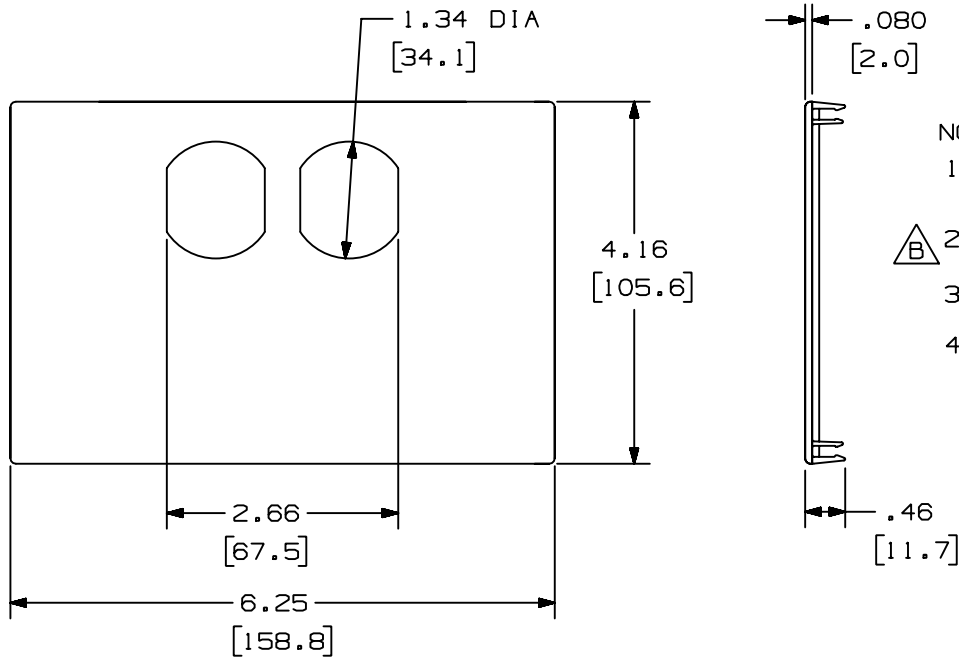

△ A △ C

NOTES:

- SEE CURRENT CATALOG FOR ADDITIONAL PART NUMBER SUFFIXES TO INDICATE COLOR AND OR PACKAGE QUANTITY.
- △ B TO BE USED WITH T130 RACEWAY AND PANDUIT RECEPTACLE BRACKET (T130DB).
- FOR USE WITH STANDARD U.S. DUPLEX RECEPTACLE.
- DIMENSIONS IN PARENTHESES ARE IN METRIC.

CAD FILENAME/LAYERS D34901BE\_T130DMC\_C\_02

REV	DATE	BY	CHK	DESCRIPTION	ECN	R	CUST	SUP
2	07-09-99	DW	HIW	C. REVISED MAT'L AND WEIGHT.	34901-05	HIW	HIW	
1	03-04-97	RCA	CEF	B. CHANGED TD130 TO T130 & TD130DB TO T130DB. A. CHANGED WEIGHT & MAT'L FROM ABS(94V-0).	34901-05	CEF	CEF	
R	10-04-94	DW	KRKE	RELEASED TO PRODUCTION.	34901-05	CEF		

PANDUIT CORP. TINLEY PARK, ILLINOIS

T130 DUPLEX COVER  
△ B (T130DMC) CUSTOMER DRAWING

UNLESS OTHERWISE SPECIFIED, DIMENSIONAL TOLERANCES ARE:  
(.X) ± .03(.8)(.XXX) ± .015(.4)  
(.XX) ± .03(.8) ANGLES ±

UNLESS OTHERWISE SPECIFIED, ALL DIMENSIONS ARE GIVEN IN INCHES, THIRD ANGLE PROJECTION.

SCALE NONE

DRAWING NO. 34901-05

DWG SIZE A

MAT'L: PVC

△ A △ C

DRWN BY DW DATE 09-29-94 CHK'D KRKE