

NOTES

- 1 SINGLE PACK IN ACCORDANCE WITH AMP SPEC 107-3275
- 2 50 TRAY PACK IN ACCORDANCE WITH AMP SPEC 107-3275
- 3 Au PLATING
- 4 Ni PLATING
- 5 HAND TOOL: 9-1478240-0; DIE SET: 1213806-1
- 6 ELECTRICAL CHARACTERISTICS
 FREQUENCY RANGE: DC - 2 GHz
 NOMINAL IMPEDANCE: 50 Ohm
 INSULATION RESISTANCE: 5000 MOhm
 WORKING VOLTAGE: 335 Volts RMS at Sea Level
 DIELECTRIC WITHSTAND VOLTAGE: 1000 Volts RMS Max
 CONTACT RESISTANCE:
 CENTRE CONTACT: 10.00 mOhm Max
 OUTER CONTACT: 5.00 mOhm Max
 VSWR @ 1.8GHz: 1.50:1 Max
 INSERTION LOSS dB @ x 1.8 GHz: 0.20 Max
- 7 MECHANICAL CHARACTERISTICS
 CABLE RETENTION FORCE: 170N Min
 RG58C/U, DURABILITY: 500 Cycles Min
- 8 ENVIRONMENTAL CHARACTERISTICS
 OPERATING TEMPERATURE: -40 to +85 DegC

REVISIONS					
P	LTR	DESCRIPTION	DATE	DWN	APVD
	A	FIRST RELEASED PER ECN-21-102416	15APR2021	RZ	WK

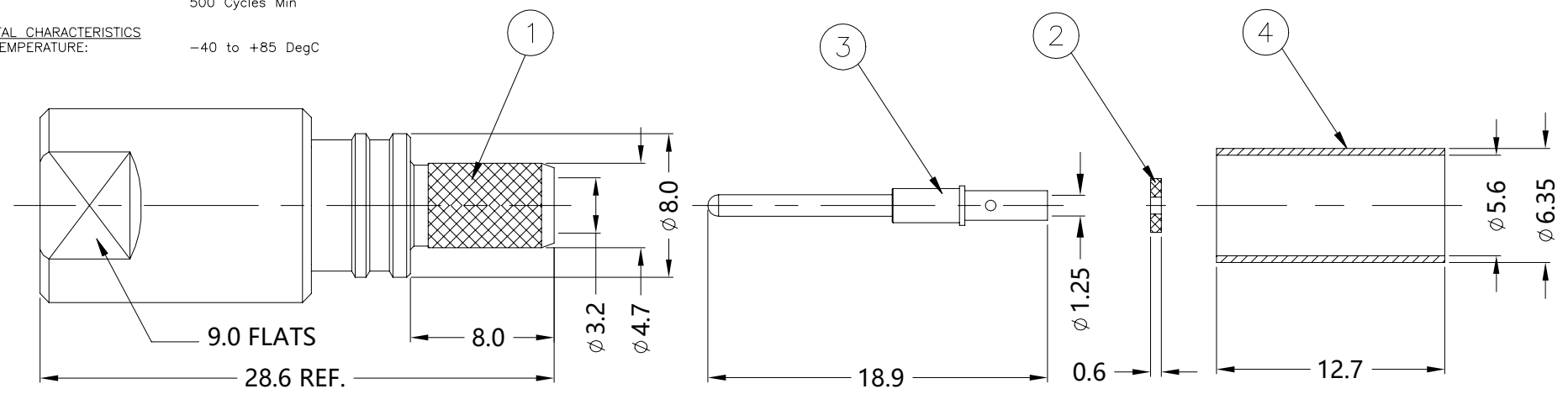

QTY	QTY PER ASSY	PARTS LIST
1	BRASS	CRIMP SLEEVE 4
1	BRASS	CONTACT 3
1	PTFE	INSULATOR 2
1	BRASS	BODY 1
-1	MATERIAL	DESCRIPTION ITEM

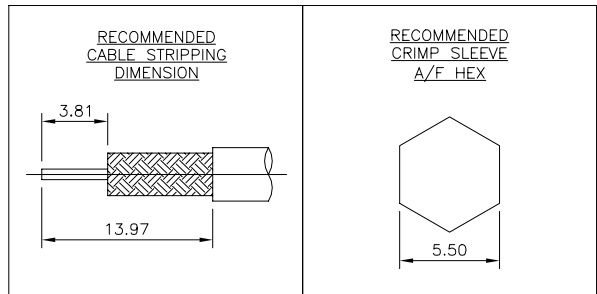

THIS DRAWING IS A CONTROLLED DOCUMENT.

DIMENSIONS: mm	TOLERANCES UNLESS OTHERWISE SPECIFIED:	DWN RANDY Z 21FEB2021	TE Connectivity FME STRAIGHT PLUG CRIMP 50 OHMS
	0 PLC ± -	CHK ERIC D 21FEB2021	
	1 PLC ± -	APVD ROGER S 21FEB2021	
	2 PLC ± -	PRODUCT SPEC	
	3 PLC ± -	APPLICATION SPEC	NAME
	4 PLC ± -		SIZE CAGE CODE DRAWING NO RESTRICTED TO
	4 PLC ANGLES ± ±		A3 00779 C=2387154
MATERIAL	FINISH	WEIGHT	CUSTOMER DRAWING SCALE NTS SHEET 1 of 1 REV A