

# HLA·HLC·HLS

## Miniature Rocker Switches

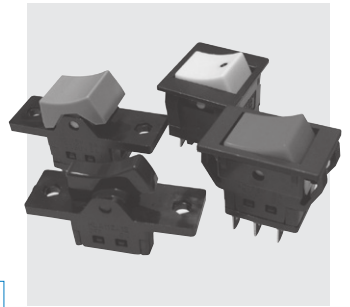

UL CSA

RoHS Compliant

### ■ Features

Economical prices are achieved through out-and-out VA and silver-saving design. Contact stability and high reliability are ensured thanks to the adoption of the seesaw type sliding contact mechanism (patented) (see the figure below) and the switches are usable for a wide range of current capacity from 1 mA to 12 A. In addition, the self-extinguishing phenol resin is used for the housing material, thereby ensuring excellent insulation and surge resistance. All models (excluding HLS308A) are UL and CSA approved for high reliability.

● For the detailed specifications, see Common Specifications on page 564.

### ■ Part Numbering

**HLA**   **1**   **12**   **A**   **12**

Series code   Number of poles   Current   Switching function   Terminal style

Series code	Actuator shape
HLA	
HLC	
HLS	

Fig.	Number of poles
1	1 pole
2	2 poles
3	3 poles

Fig.	Current
08	8A
12	12A

Code		Switching function	
1 pole/2 poles/3 poles			
A	K	OFF	— ON
D	N	ON	— ON

Fig.	Terminal styles
None	TAB:#187 (t=0.5)
12	Solder Terminal

### ■ Terminal Styles

1 pole		2 poles, 3poles	
TAB #187 Style : -	Solder Terminal Style : 12	TAB #187 Style : -	Solder Terminal Style : 12
t=0.5	t=1	t=0.5	t=0.5

Note: For the overseas standards, see page 326.

### ■ Seesaw Type Sliding Mechanism (Patented)

The movable contact moves from (A) to (B) as it wipes the contact surface and, at (B) and (C), the switching feel can be obtained due to the seesaw effect on the common terminal (2). Then, the movable contact moves from (C) to (D) as it wipes the contact surface and, at the point (D), the common terminal (2) and the terminal (3) are turned ON.

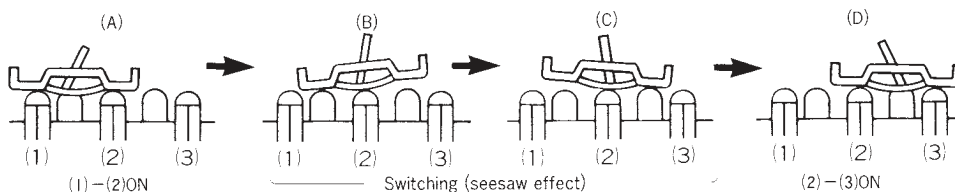





# HLS

## HLS112

### 1 pole

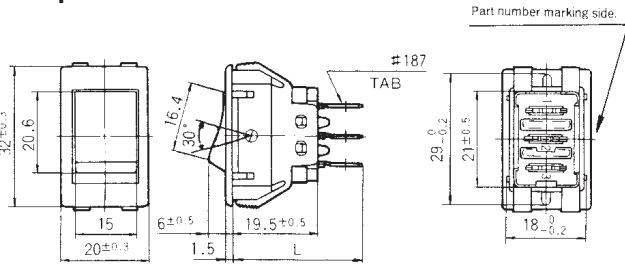
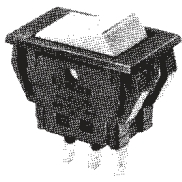

## ■L寸法図/Dimension L

端子形状 Terminal style 形名 Part No.	タブ端子 TAB:#187	はんだ端子 Solder Terminal
HLS112A■	29.5	26
HLS112D■	29.5	26

Switching function Part No.	Viewed from part No. marking side	
HLS112A■	OFF	ON
Connecting terminals	-	2-1
HLS112D■	ON	ON
Connecting terminals	2-3	2-1
HLS208K■	OFF	ON
Connecting terminals	-	2-1 5-4
HLS208N■	ON	ON
Connecting terminals	2-3 5-6	2-1 5-4

**TAB:#187 Terminal**

Terminal numbers are shown on the bottom of the switch.

The switching function Type "A" is without terminal number (3).

## ■Specifications

Rating		Initial contact resistance	Dielectric strength	Insulation resistance	Electrical life
HLS112A HLS112D	AC125V 12A Max. AC250V 6A Max. AC-DC6V 1mA Min.	20mΩ Max. (DC2~4V 1A)	AC1500V 1 minute	100MΩ Min. (DC500V)	15,000 cycles

To check the Part No. marked with the ■, refer to List of Part Numbers on Page 325.

## HLS208

### 2 poles

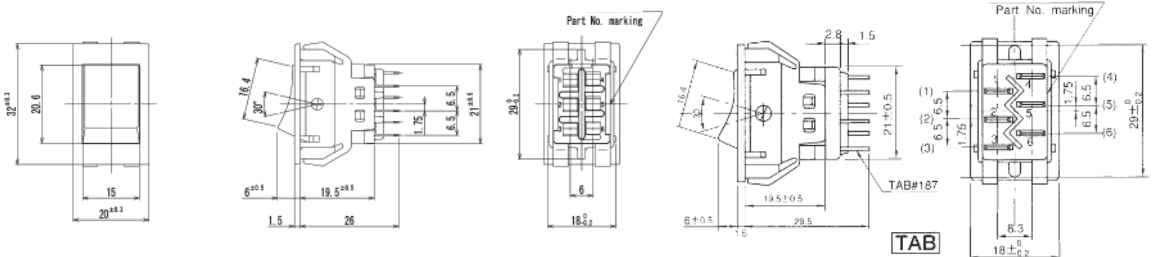

**Solder Terminal**

Terminal numbers are shown on the bottom of the switch.

The switching function Type "K" is without terminal numbers (3) and (6).

## ■Specifications

Rating		Initial contact resistance	Dielectric strength	Insulation resistance	Electrical life
HLS208K HLS208N	AC125V 8A Max. AC250V 5A Max. AC-DC6V 1mA Min.	20mΩ Max. (DC2~4V 1A)	AC1500V 1 minute	100MΩ Min. (DC500V)	15,000 cycles

## ■Panel Cut-Out Dimension

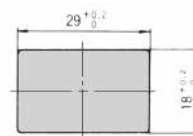

Panel thickness : 1~3mm

## ■Mounting the HLS Type Button

To mount the button, insert the lower-rocker side first, and press in the other side while pressing the button with the ball of a finger.

The button is not replaceable once it is mounted.

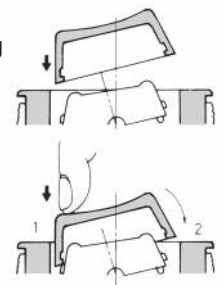

## ■Placing an order

The button of the HLS type comes as an accessory. Choose one from the table on page 329 and specify the color by part number when placing an order.

HLS308

3-poles

Terminal numbers are shown on the bottom of the switch.

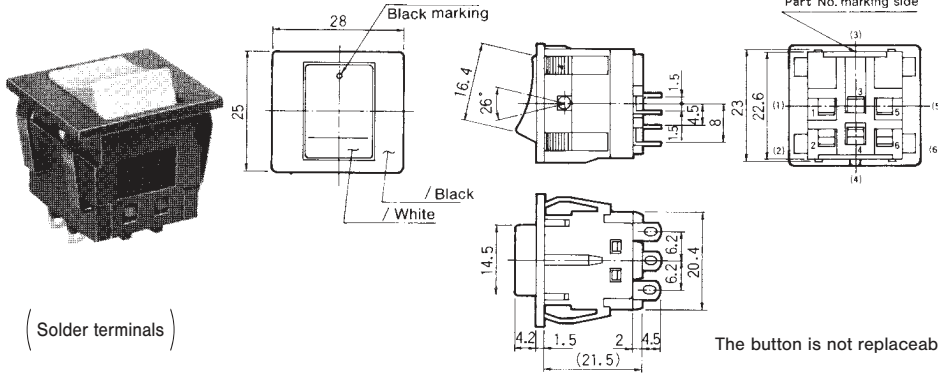

(Solder terminals)

Part No.	Marking	
HLS308A12	ON	OFF
Connecting terminals	1-2 3-4 5-6	-

Specifications

Rating		Initial contact resistance	Dielectric strength	Insulation resistance	Electrical life	Operating temperature range
Maximum rating	AC125V 8A AC250V 5A	100mΩ Max. (DC2~4V 1A)	AC2000V 1 minute	100MΩ Min. (DC500V)	5,000 cycles	-15~+85°C
Minimum rating	AC·DC6V 1mA					

Panel Cut-Out Dimensions

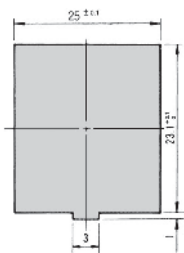

Panel thickness : 1~2mm

Soldering Specifications

Device : Soldering iron  
420°C, Max.; 3 seconds, Max.

Accessories (For HLC·HLS : Without HLS308)

《Supplied separately》

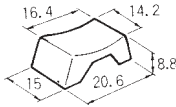
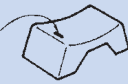
Accessories	Standard accessories	Optional accessories		
Part name	Button	Button		
Dimensions		 <p>Matte finish with φ2.5 concave</p>		
Button color	Part number	Button color	Dot marking	Part number
White	140000480738	White	Red	140000480874
Red	140000480628	White	Black	140000481081
Black	140000480621	Red	White	140000480711
Gray	140000480629	—	—	—
Green	140000480631	Black	White	140000480710
Blue	140000480632	Black	Red	140000480650