

Quality Control Standard

出货品质标准

Valued customer 客户名称 :	Customer Product Name/No. (客户产品名称/编号):	打印机切刀	
Model No 机种编号 :	Swatch No.: 样品编号	Date作成日: 2023/1/10	Rev.
Our Code No. 仕样编号 :	(Please Use Our Code No. To Order) (订货时请用此仕样编号)	Rev. Date修订日:	
		备注	DV ROHS

1. Conditions of Standard Operation / 工作条件

1- 1)Driving Voltage 驱动电压	: 20 V	DC Constant between motor terminals. 马达端子电压 20 V 直流恒压。
1- 2)Direction of Rotation 回转方向	: CW	viewing from metal housing. CW 面对马达金属外壳时。
1- 3)Position of Motor 马达放置状态	: To be placed horizontally when measuring. 测试时水平放置。	

1- 4)Operating Temperature工作温度	: -10 °C to 60 °C	
1- 5)Operating Humidity工作湿度	: 30%RH to 95%RH	

2. Conditions of Standard Test / 测试条件

2- 1)Testing Temperature测试温度	: 10°C to 30°C	
2- 2)Testing Humidity测试湿度	: 30%RH to 95%RH	

噪音测试示意图

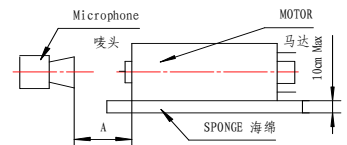

3. Initial Electrical Characteristics / 初期特性

3- 1) No Load Speed 无负荷转速	: 8000 ± 1200 rpm	
	: 8000 ± 1200 转/分	
3- 2) No Load Current 无负荷电流	: 50 mA max.	
	: 最大 50 毫安培	
3- 3) Load Speed 负荷转速	At Load 1.96 mNm : 6950 ± 1050 rpm	
	: 6950 ± 1050 转/分	
3- 4) Load Current 负荷电流	负载 1.96 mNm : 160 mA max.	
	: 最大 160 毫安培	
3- 5) Stall Torque 堵转扭力	At Load 1.6 & 6.4 mNm : 11.5 mNm min.	
	: 最小 11.5 mNm	
3- 6) Stall Current 堵转电流	在负载点 1.6 & 6.4 mNm : 970 mA max.	
	: 最大 970 毫安培	
3- 7) Mechanical Noise(vertical from housing side 30 cm Background noise 30dB Max) 机械噪音(距离铁壳侧 30 cm, 环境噪音30dB Max)	: 55	dB Or below(RMS)JIS-A Characteristics dB 以下(RMS) JIS-A特性
3- 8) Reference Performance Curve 参考性能曲线	: As per attached Sheet FP180-KT-10370	
	: 所附图表为 FP180-KT-10370	
3- 9) Dimensions 外形尺寸	: As per Drawing attached WG- F180T-Y390	
	: 所附图面为 WG- F180T-Y390	
3- 10) End play of Shaft 虚位	: 0.05 ~ 0.60 mm	
	: 0.05 ~ 0.60 毫米	

For & on behalf of Customer

For & on behalf of Standard Motor Co., Ltd.

Jack Lee 2023/01/11



As a reminder, the specification should be signed and returned within two weeks, or it will be considered as acceptable by the customer. 如果客户两周内不签字确认并返回, 将被视为已认可此规格。

性能表只供参考
马达实际参数请以马达出货标准为主



STANDARDMOTOR 標準微型摩打有限公司

两点法: 16.3 g.cm & 65.3 g.cm

Model/Winding 型号/卷线	Voltage 电压 V	No Load 无负荷		At Maximum Efficiency 最大效率点				At Maximum Output 最大功率点				Stall 停止	
		Current 电流 A	Speed 转速 rpm	Current 电流 A	Speed 转速 rpm	Torque 扭矩 g.cm	Efficiency 效率 %	Current 电流 A	Speed 转速 rpm	Torque 扭矩 g.cm	Output 功率 W	Current 电流 A	Torque 扭矩 g.cm
FP180-KT-10370	20.0	0.034	7998	0.157	6584	28.0	60.0	0.384	3999	79.1	3.24	0.733	158.2

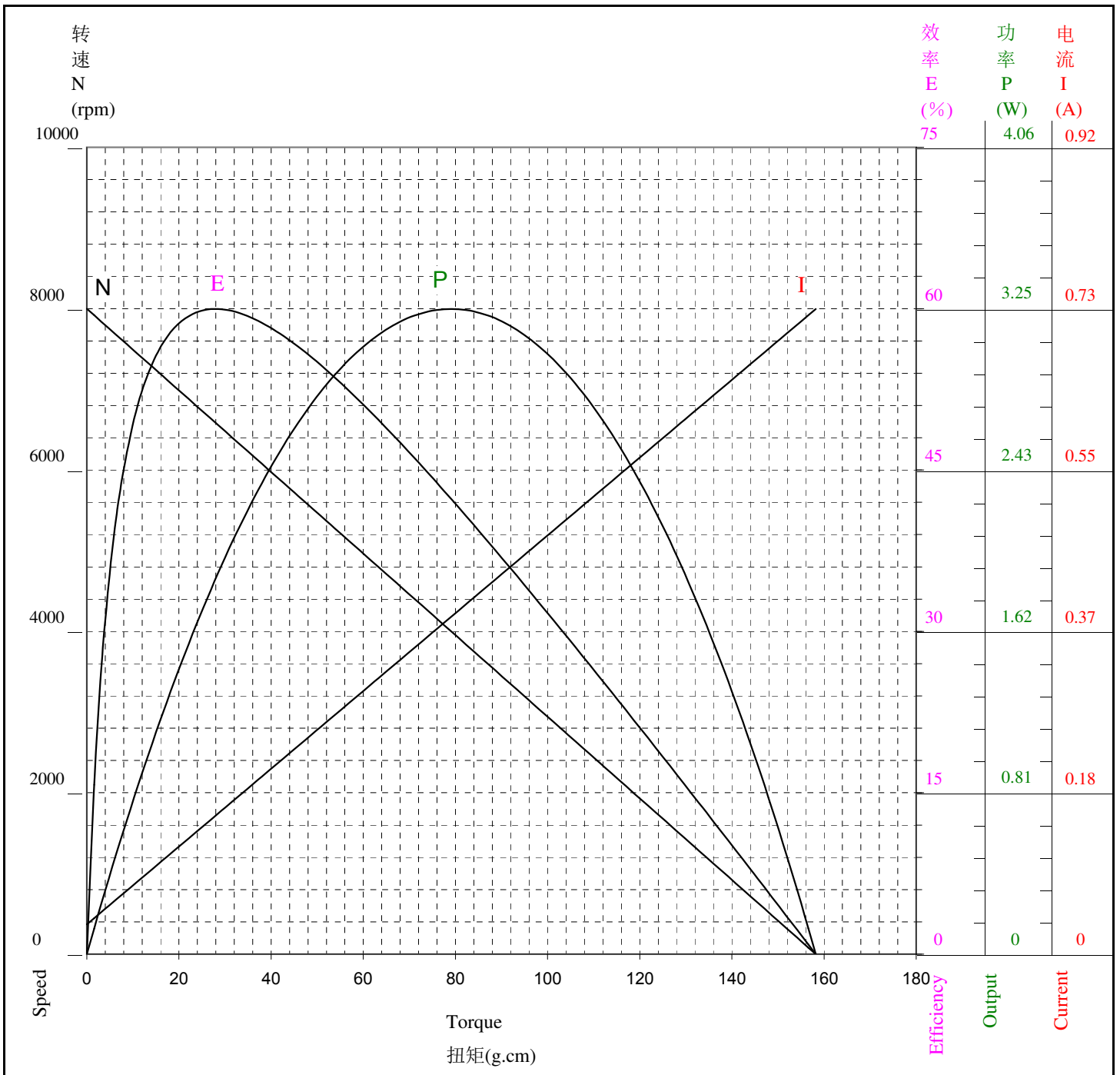

MARK	POSITION	DESCRIPTION	DATE	BY

马达回转向
DIRECTION OF ROTATION

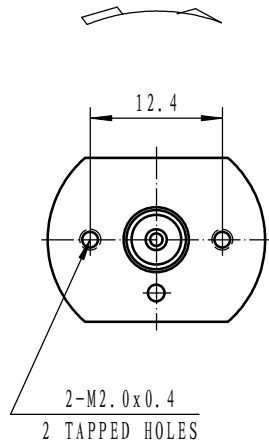

SEE NOTES 1
参见备注 1

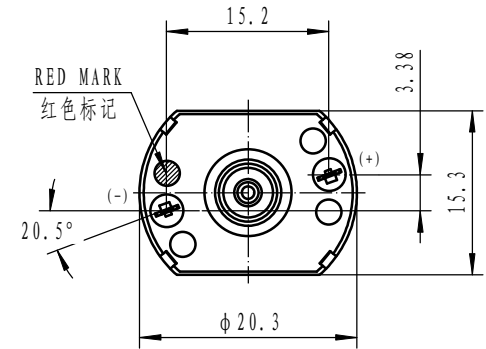
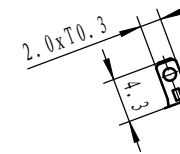
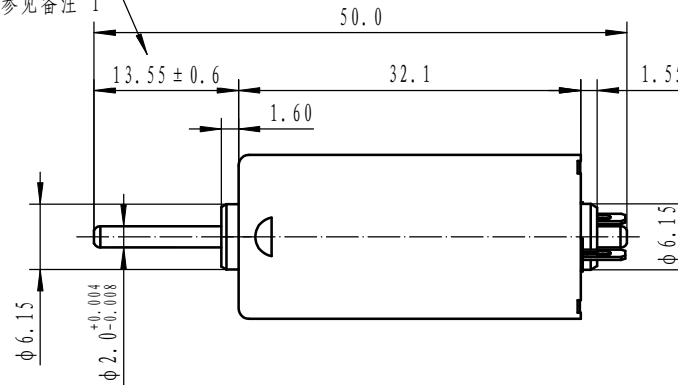

SEE NOTE 3
参见备注 3

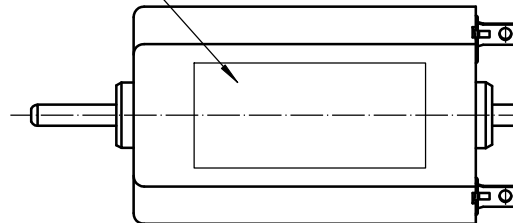

NOTES(备注):

1. THIS DIM APPLIES ONLY WHEN MOTOR SHAFT IS IN EXTREME RIGHT POSITION
该尺寸适用于将轴压于右侧时
2. SHAFT END PLAY 0.05~0.50
马达虚位(轴向串动)0.05~0.50
3. SPECIFIED CONTENT WILL BE TYPEGRAPHICALED IN CONFORMITY TO GETUP BOOK OF MOTOR
按马达仕様书印刷指定内容

Characteristic	DWN. BY	刘露	DWN. DATE	2023.01.04	TITLE	Motor Outline Drawing		
Cpk ≥ 1.33	CHK. BY		CHK. DATE		DWG. No.	WG-F180T-Y390		
Quality control	APP. BY		APP. DATE		Undeclared tolerance	± 0.3	Angle tolerance	± 3°
Not mark	Not required	STANDARD MOTOR CO., LTD.			SCALE	2:1	Rev.	- A3