

## OMX-01HMBT0010 HDBaseT 4K HDMI Extender Set

### INSTALLATION & SPECIFICATIONS

#### Transmitter

Front



- |   |   |
|---|---|
| 1 Power LED Indicator   | 6 HDMI IN 2 LED Indicator<br>Orange-Connected to source<br>Green-Device is selected as source |
| 2 Link LED Indicator  | 7 HDMI IN 2-Connect second source   |
| 3 HDCP LED Indicator<br>Green-HDMI with HDCP<br>Flashing Green-No HDCP<br>Off-No HDMI Signal  | 8 RESET-Press to reboot the TX  |
| 4 HDMI IN 1 LED Indicator<br>Orange-Connected to source<br>Green-Device is selected as source | 9 Factory Use Only  |
| 5 HDMI IN 1-Connect source  | 10 TO PC-Connect to Computer  |
|   | 11 DISPLAY ON/OFF via CEC/RS232   |
|   | 12 SOURCE SELECT  |

#### Receiver

Front



Back



- |  |  |
|--|--|
| 1 Power LED Indicator  | 6 HDMI OUT-Connect display   |
| 2 ON LED-Indicates working status  | 7 HDBT IN-Connect to HDBT OUT on TX  |
| 3 LINK LED Indicator   | 8 USB IN-Connect HID devices such as mouse or keyboard to control device connected to the TO PC on TX. |
| 4 HDCP LED Indicator<br>Green-HDMI with HDCP<br>Flashing Green-No HDCP<br>Off-No HDMI Signal | 9 RS232-Connect RS232 device   |
| 5 Factory Use Only   | 10 Plug in Power Supply  |

Back



- |   |
|---|
| 13 PoC IN/HDBT OUT-connect to HDBT IN on RX       |
| 14 DC OUT-Connect compatible device to be powered |
| 15 RS232-Connect RS232 computer or controller     |

#### Typical Application

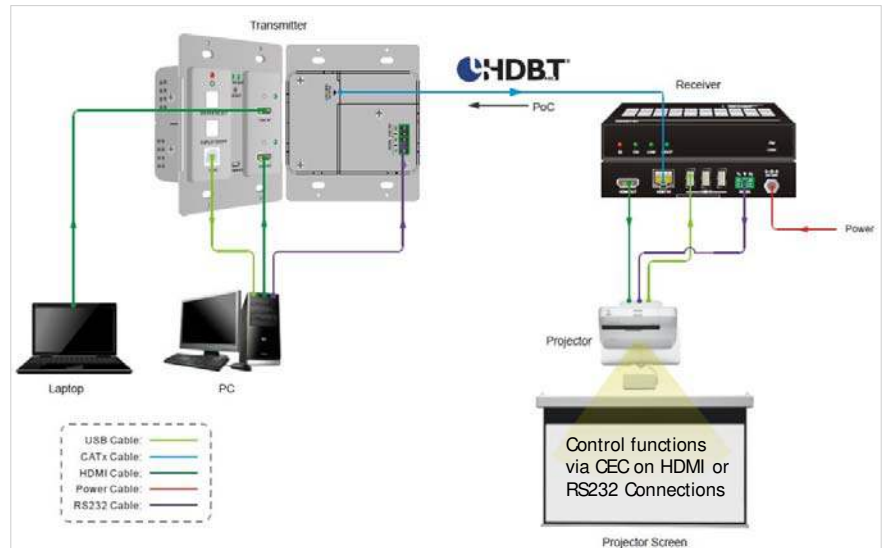

## SIGNAL SWITCHING

Press SOURCE SELECT to switch to the next source device.

**AUTO-SWITCHING:** To enable auto-switching, press and hold SOURCE SELECT for 3 seconds. When a new input signal is detected, the transmitter will automatically switch to this new signal. To exit this mode, press and hold SOURCE SELECT.

**REBOOTING:** Upon rebooting, the transmitter will retain the last setting for switching mode.

## DISPLAY CONTROL

Press DISPLAY ON/OFF to turn the display on or off.

## RS232 CONTROL

**LOCAL TRANSMITTER CONTROL:** Connect a control device, such as a computer, to the TX RS232 port.



## THIRD PARTY DEVICE CONTROL

1. Connect the computer to the TX RS232 port.
2. Connect third party device, such as a projector, to the RX RS232 port.

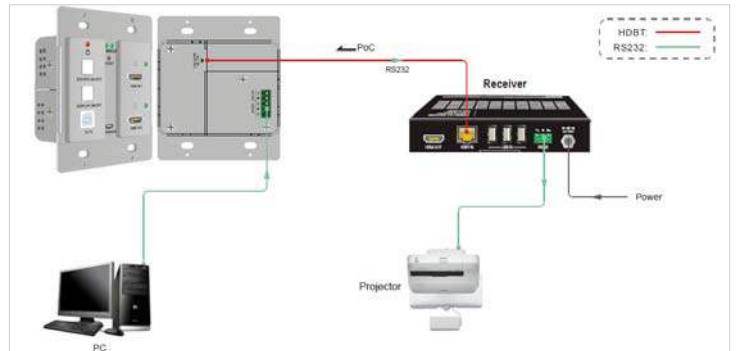

## THIRD PARTY DEVICE CONTROL BY COMPUTER

1. Connect the computer to the RX RS232 port.
2. Connect third party device to the TX RS232 port.

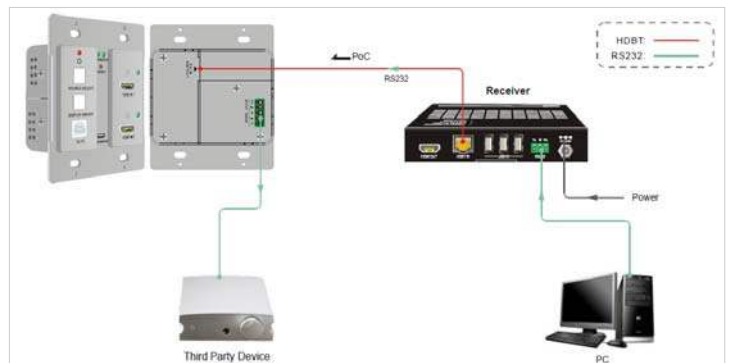

## RS232 STANDARD SERIAL CONTROLLER TERMINAL

Download the control software. Find the download on the Ocean Matrix website on the OMX-01HMBT0010 product page.

1. Copy the control software file to the control PC
2. Set the following parameters:
  - COM Number
  - Baud Rate: 2400, 4800, 9600, 19200, 38400, 57600 or 115200
  - Data Bit: 8
  - Stop Bit: 1
  - Parity Bit: None

## RS232 COMMAND

### TRANSMITTER CONTROL

Set the following Commands:

- Baud Rate: 9600
- Data Bit: 8
- Stop Bit: 1
- Parity Bit: None

### Signal Switching

| Command | Function                       | Feedback Example                   |
|---------|--------------------------------|------------------------------------|
| 50701%  | Switch to HDMI IN 1 input.     | SWITCH TO HDMI 1                   |
| 50702%  | Switch to HDMI IN 2 input.     | SWITCH TO HDMI 2                   |
| 50710%  | Enable auto-switching mode.    | AUTO SWITCHING                     |
| 50711%  | Disable auto-switching mode.   | MANUAL SWITCHING                   |
| 50712%  | Get the signal switching mode. | AUTO SWITCHING or MANUAL SWITCHING |

### CEC Command—Display must Support CEC

Note: Not all displays/monitors with CEC adhere fully to all command functions.

| Command | Function               | Feedback Example    |
|---------|------------------------|---------------------|
| 50730%  | Volume Up on Display   | CEC VOLUME INCREASE |
| 50731%  | Volume Down on Display | CEC VOLUME DECREASE |
| 50732%  | Mute                   | CEC VOLUME MUTE     |
| 50733%  | Display ON             | CEC DISPLAY ON      |
| 50734%  | Display OFF            | CEC DISPLAY OFF     |

### HDCP Command

| Command | Function    | Feedback Example      |
|---------|-------------|-----------------------|
| 50709%  | HDCP Mode   | HDCP: ON<br>HDCP: OFF |
| 50713%  | HDCP Status | HDCP 2.2<br>NO HDCP   |

### Factory Default

| Command | Function                | Feedback Example |
|---------|-------------------------|------------------|
| 50617%  | Restore Factory Default | FACTORY RESET    |
| 50699%  | Firmware Version        | VERSION Vx.x.x   |

| FEATURES   |
|--|
| Extends Two-Way IR Signals   |
| RS232 & CEC Pass Through   |
| EDID Management  |
| Supports ARC & Audio De-embedding – TOSLINK/SPDIF Out on Receiver  |
| Transmission Distance: 1080P up to 230 Feet, 4K up to 131 Feet   |
| Two-Way PoC  |
| Rugged Black Powder-Coated Metal Enclosure   |
| CE, FCC Certified  |
| Includes: (1) 3Pin Terminal Block,(4) Mounting Ears & (4) Screws,, (1) RS232 Cable (3Pin to DB9), (1) 24V/1.25A power supply |

| SPECIFICATIONS         |  |
|------------------------|--|
| Compliance             | HDMI 2.0, HDCP 2.2/1.4                         |
| Video Bandwidth        | 18Gpbs   |
| HDMI Video Resolutions | up to 4Kx2K@60Hz 4:4:4                         |
| Audio Formats          | PCM, Dolby Digital, Dolby True-HD, DTS, DTS-HD |
| Frequency Response     | 20Hz-20KHz, +/- 3dB                            |
| Power Consumption      | 12W  |
| Power Input            | 100-240VAC, 50/60Hz                            |
| Dimensions (HxWxD)     | 0.77 x 5.7 x 3.3 in                            |
| Weight                 | TX 9.7 oz, RX 10.23 oz                         |

## SAFETY PRECAUTIONS

- To prevent fire or shock hazard, do not expose this equipment to dust or high humidity. Do not use in an unprotected outdoor installation or in areas classified as overly damp or wet.
- The installation temperature should be kept between 32°F to 140°F (0°C to 60°C). Avoid direct sunlight exposure or extreme changes of temperature over a short period of time.
- Do not place the unit on an unstable base and avoid heavy impact.
- Proper ventilation is required for permanent installation. Do not block or cover enclosure openings as they protect the unit from overheating.
- Prior to cleaning, turn the power off and unplug the unit from all connections. Use a damp cloth. Do not use liquid or aerosol cleaners.
- Do not overload outlets and extension cords as this may result in a risk of fire or electric shock.
- Enclosure entry is dangerous. Never push objects of any kind, including liquids, through openings as they may touch dangerous voltage points or short-out parts that could result in a fire or electric shock.
- Do not open or service this unit yourself as opening or removing covers may expose you to dangerous voltage and other hazards.
- There are no user-serviceable parts inside the unit. If the unit requires service contact your authorized dealer, or authorized repair service company.

## Federal Communications Commission (FCC) Compliance Notices

### Class A Interference Statement

This equipment has been tested and found to comply with the limits for a Class A digital device, pursuant to part 15 of the FCC Rules. These limits are designed to provide reasonable protection against harmful interference when the equipment is operated in a commercial environment. This equipment generates, uses, and can radiate radio frequency energy and, if not installed and used in accordance with the instruction manual, may cause harmful interference to radio communications. Operation of this equipment in a residential area is likely to cause harmful interference in which case the user will be required to correct the interference at his own expense.

### FCC Caution

This device complies with part 15 of the FCC Rules. Operation is subject to the following two conditions: (1) This device may not cause harmful interference, and (2) this device must accept any interference received, including interference that may cause undesired operation.