

1) STATO DI FORNITURA - SCALA 1:1
(SUPPLY CONDITION - SCALE 1:1)

SENSO DI USCITA
DEL TERMINALE
DALLA BOBINA
(DIRECTION OFF
TOP OF REEL)

16.9
PITCH

2) SPECIFICA DI PRODOTTO 108-20019
(PRODUCT SPEC. 108-20019)

3) PER LE VERSIONI IN PEZZI SCIOLTI
VEDERE DISEGNO 180440
(FOR LOOSE PIECE VERSION SEE DRAWING 180440).

ADATTO PER LINGUETTA
DI 0.5 mm.
(TO FIT TAB 0.5 mm.)

SEZIONE A-A
(SECTION A-A)

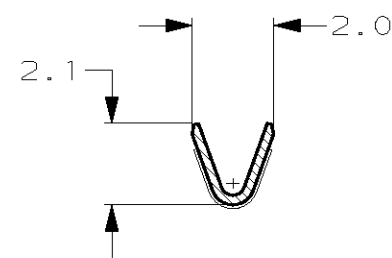

SEZIONE B-B
(SECTION B-B)

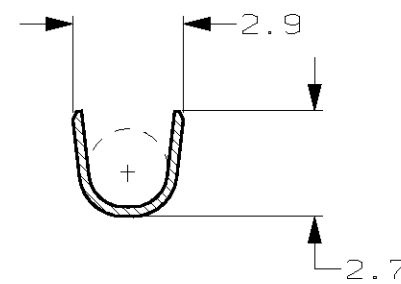

| | | | | |
|---------------------|--|--|--|---|
| | STAGNATO (TIN PLATED) | OTTONE (BRASS) | 180436-2 | R |
| NOTE | FINITURA / COLORE (FINISH / COLOUR) | MATERIALE (MATERIAL) | NUMERO (AMP P/N) | REV. |
| | CUSTOMER DWG. FOR REFERENCE ONLY | | | DISEGNO PER CLIENTE SOLO PER RIFERIMENTO |
| | THIS DRAWING IS UNPUBLISHED | | | RELEASE FOR PUBLICATION 19 |
| | © COPYRIGHT 19 BY AMP INCORPORATED, HARRISBURG, PA. ALL INTERNATIONAL RIGHT RESERVED. AMP PRODUCTS MAY BE COVERED BY U.S. AND FOREIGN PATENT AND/OR PATENT PENDING | | | |
| | TOLLERANZE: SE NON DIVERSAMENTE SPECIFICATO (TOLERANCES: UNLESS OTHERWISE SPECIFIED) | DIAM. ISOLANTE (INS. DIA. RANGE) | RANGO FILO (WIRE RANGE) mm ² | SCALA (SCALE) |
| | ± 0.4 | 1.0-2.0 | 0.20-0.56 | 5:1 |
| | ANGOLI (ANGLES) | AMP AMP ITALIA Sp.A. Corso F.lli Cervi, 15 COLLEGNO (TORINO) | | |
| | DIS. H. YAALI (DR.) 18 DEC 2000 | DESCRIZIONE (DESCRIPTION) FASTON® Connector .110" sr. REC. CONTACT | | |
| R1 | REVISED ET00-0025-03 | H. Y. | 05 MAR 2003 | CONT.C. TARTARI |
| R | ACTIVATED DRAWING ET00-0004-01 | H. Y. | 08 JAN 2001 | |
| REV. (REV. LTR.) | REVISIONI (REVISION RECORD) | DIS. (DR.) | DATA (DATE) | APP. (APP.) |
| | | | | |
| | | | LOC. SIZE NUMERO (DWG NO) | REV. FOGLIO (SHEET) |
| | | | I A3 C-180436 | R1 1 OF 1 |

DISTRIBUZIONE
(PRINT DIST.)