

LOC		DIST		REVISIONS			
P	LTR	DESCRIPTION	DATE	DMN	APVD		
D		REVISED PER ECO-12-000090	26JAN2012	CJV	SLB		

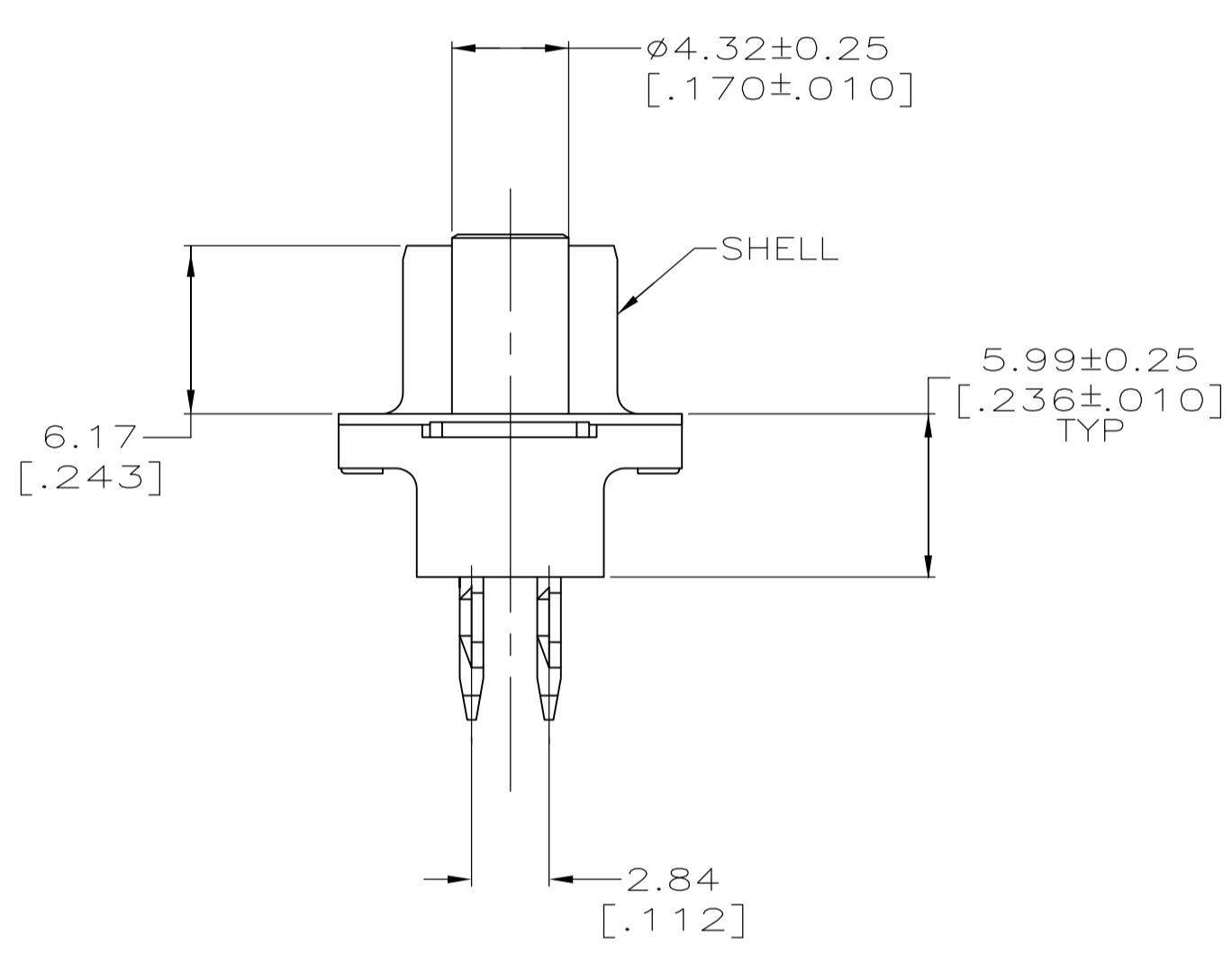
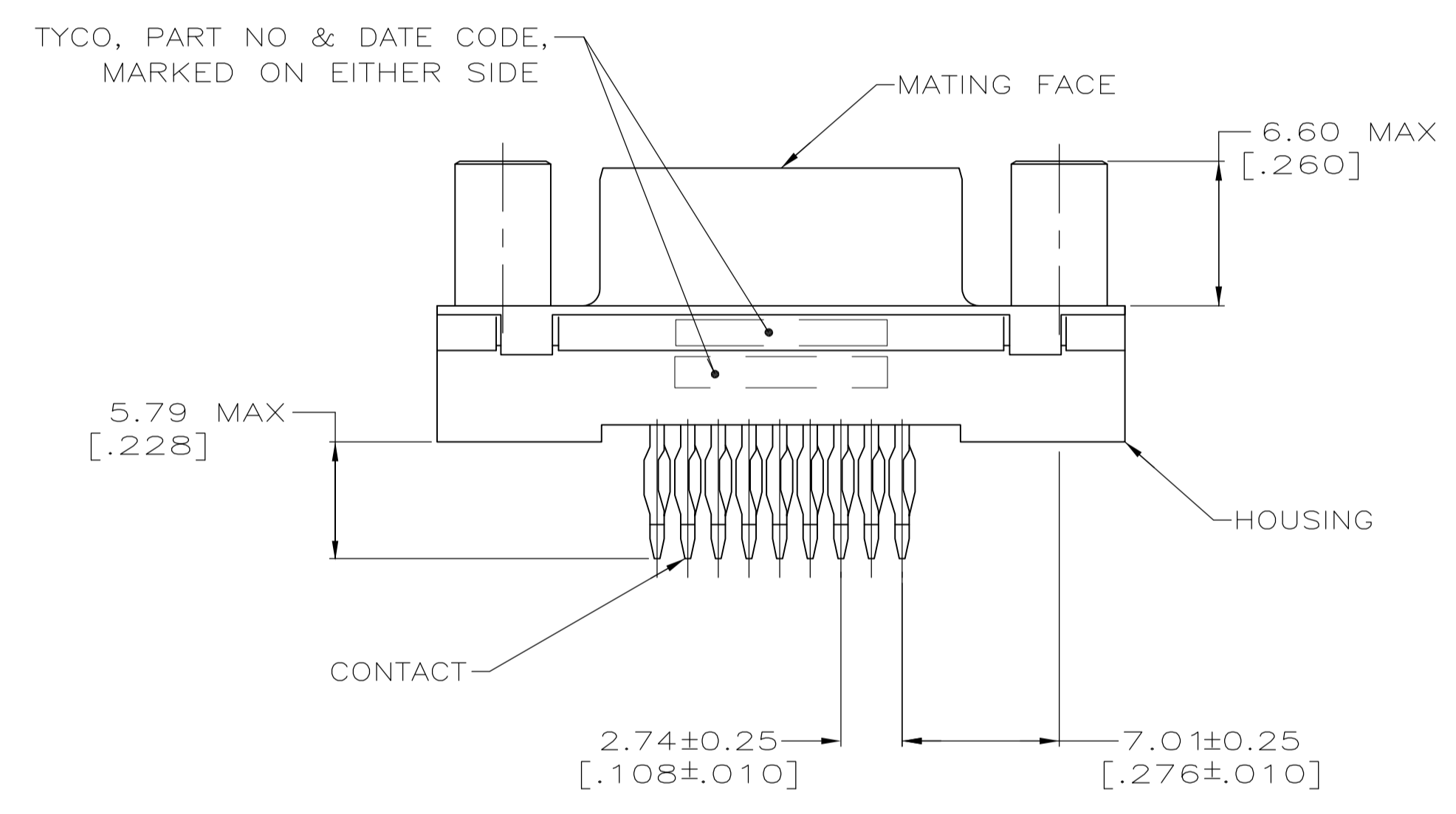
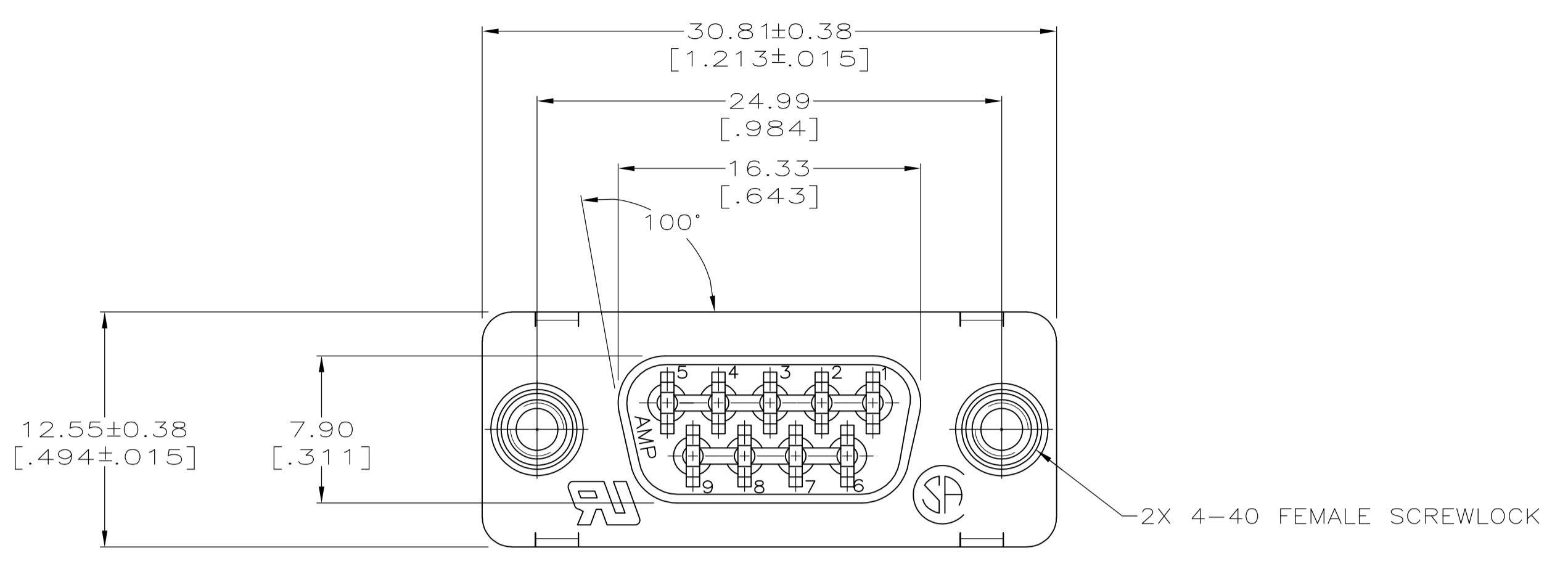

- ⚠ FOR USE WITH 2.36 (.093) MINIMUM THICK PRINTED CIRCUIT BOARD. REFER TO APPLICATION SPECIFICATION FOR PRINTED CIRCUIT BOARD LAYOUT DIMENSIONS AND FINISH RECOMMENDATIONS.
- ⚠ HOUSING: NYLON OR POLYESTER, UL 94V-0 RATED, GLASS FILLED, BLACK.
- ⚠ CONTACTS: COPPER ALLOY.
- ⚠ SHELL: CARBON STEEL.
- ⚠ SCREWLOCKS: ZINC.
- ⚠ SHELL: $5.08 \mu\text{m}$ [$.000200$] MIN TIN OVER $2.54 \mu\text{m}$ [$.000100$] MIN COPPER.
- ⚠ SCREWLOCKS: CLEAR CHROMATE.
- ⚠ GOLD FLASH ON MATING SURFACE, $2.54 \mu\text{m}$ [$.000100$] MIN TIN ON COMPLIANT PIN, ALL OVER $1.27 \mu\text{m}$ [$.000050$] MIN NICKEL.
- ⚠ 0.76 MICRO METERS [$.000030$] MINIMUM GOLD IN MATING AREA. 2.54 MICRO METERS [$.000100$] MINIMUM TIN ON COMPLIANT PIN. ALL OVER 1.27 MICRO METERS [$.000050$] MINIMUM NICKEL. OR GOLD FLASH OVER PALLADIUM NICKEL. 0.76 MICRO METERS [$.000030$] MINIMUM TOTAL IN MATING AREA. 2.54 MICRO METERS [$.000100$] MINIMUM TIN ON COMPLIANT PIN. ALL OVER 1.27 MICRO METERS [$.000050$] MINIMUM NICKEL.
- ⚠ DATUMS AND BASIC DIMENSIONS ESTABLISHED BY CUSTOMERS.

OBSELETE	5747091-2
	5747091-1
CONTACT FINISH	PART NO

THIS DRAWING IS A CONTROLLED DOCUMENT. DIMENSIONING AND TOLERANCING PER ASME Y14.5M-2009.

DIMENSIONS:	TOLERANCES UNLESS OTHERWISE SPECIFIED:	DIN G. PETERS/DTI 03FEB06	03FEB06
INCHES		03FEB06	03FEB06
0. PLC	± -	APVD S. BOLASH 03FEB06	NAME
1. PLC	± -	M. WALMSLEY 03FEB06	RECEPTACLE ASSEMBLY, SIZE 1,
2. PLC	± 0.13 [.005]	PRODUCT SPEC	9 POSITION, ACTION PIN
3. PLC	± -	APPLICATION SPEC	VERTICAL, FRONT METAL SHELL
4. PLC	± -	114-40026	SIZE
ANGLES	± -	108-40014	CAGE CODE
		114-40026	DRAWING NO
MATERIAL	FINISH	114-40026	RESTRICTED TO
		114-40026	A1 00779
		114-40026	5747091
		114-40026	SCALE 4:1 SHEET 1 OF 1 REV D

CUSTOMER DRAWING