

THIS DRAWING IS A CONTROLLED DOCUMENT.

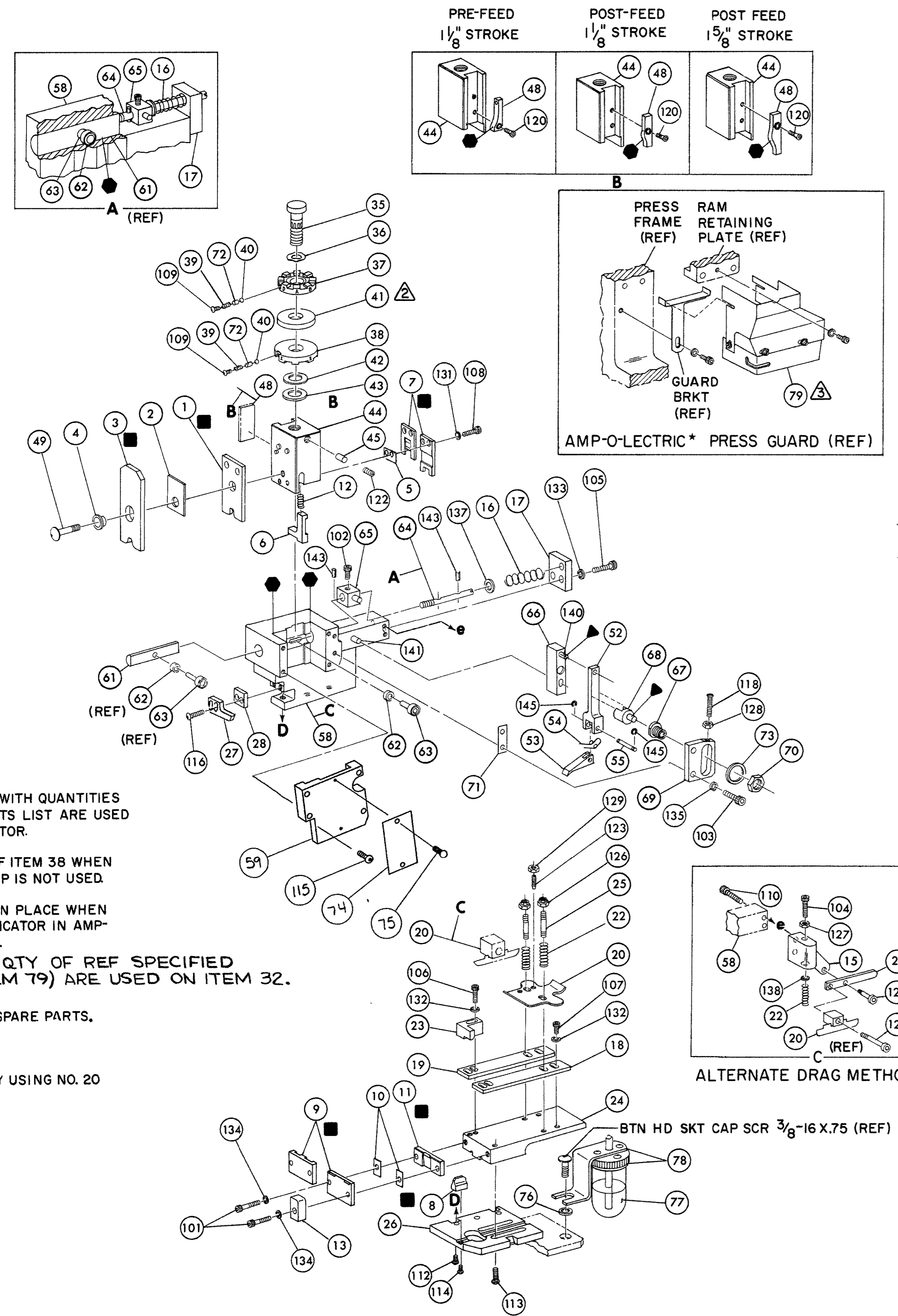

- NOTES:**
- 1. ONLY THE ITEMS WITH QUANTITIES SPECIFIED ON PARTS LIST ARE USED ON THIS APPLICATOR.
 - △ USED IN PLACE OF ITEM 38 WHEN INSULATION CRIMP IS NOT USED.
 - △ GUARD MUST BE IN PLACE WHEN OPERATING APPLICATOR IN AMP-O-LECTRIC PRESS.
 - 4. ITEMS WITH QTY OF REF SPECIFIED (EXCEPT ITEM 79) ARE USED ON ITEM 32.
- KEY:**
- RECOMMENDED SPARE PARTS.
 - ▲ LUBRICATE DAILY USING NO. 20 MACHINE OIL.
 - GREASE LIGHTLY.

REF	QTY	PART NO	DESCRIPTION	ITEM NO
REF		21045-3	RING, RETAINING 'C' (.187 DIA) FEED PIN	145
REF		5-21028-1	PIN, SLOT SPG (.12 DIA X .50) FD ADJ ROD	143
REF		1-21030-7	PIN, DOWEL (.187 DIA X 1.50) HOUSING	141
REF		1-21030-1	PIN, DOWEL (.187 DIA X .50) LEVER	140
REF		22260-5	WASHER, FLAT (NO 6) DRAG SPRING	138
REF		21899-4	WASHER, FLAT (5/16 DIA) SCR ADJ	137
REF		21024-5	WASHER, LOCK (NO 10) FEED ADJ PLATE	136
REF		21024-5	WASHER, LOCK (NO 10) SHEAR PLATES	134
REF		21024-5	WASHER, LOCK (NO 10) FEED ROD GUIDE	133
REF		21024-4	WASHER, LOCK (NO 8) STRIP GUIDE	132
REF		21024-4	WASHER, LOCK (NO 8) SHEAR BLADE	131
REF		21018-4	NUT, HEX MACH (4-40) DRAG	130
REF		21068-5	NUT, HEX MACH (6-32) FD ADJ PLATE	128
REF		21018-7	NUT, HEX MACH (10-32) DRAG SPRING	127
REF		21022-2	NUT, HEX SELF-LKG (8-32) DRAG STUD	126
REF		5-21004-7	SCR, SKT HD SHLD (250 DIA X .25) DRAG ARM	125
REF		21004-5	SCR, SKT HD SHLD (250 DIA X 1.00) DRAG	124
REF		4-21078-8	SCR, SKT SET OVAL POINT (4-40 X .75) DRAG	123
REF		21009-2	SCR, SKT SET (1/4-20 X 25) (LOC-WEL) RAM	122
REF		1-21002-7	SCR, BTN HD SKT CAP (6-32 X .38) CAM	120
REF		3-21064-2	SCR, RD HD MACH (6-32 X 1.50) FEED ADJ	118
REF		2-21002-4	SCR, BTN HD SKT CAP (8-32 X .75) STRIPPER	116
REF		2-21002-9	SCR, BTN HD SKT CAP (10-32 X .75) HSG CAP	115
REF		22733-8	SCR, BTN HD SKT CAP (8-32 X .38) (LOC-WEL) ANVIL	114
REF		3-21002-3	SCR, BTN HD SKT CAP (1/4-20 X .50) STR GDE PL	113
REF		2-22733-8	SCR, BTN HD SKT CAP (1/4-20 X .62) BASE PL	112
REF		2-21000-4	SCR, SKT HD CAP (6-32 X 1.00) DRAG ADAPTOR	110
REF		23030-1	SCR, SKT HD CAP (6-32 X .25) (LOC-WEL) CP DISC	109
REF		2-21000-7	SCR, SKT HD CAP (8-32 X .50) SHEAR BLADE	108
REF		2-21000-6	SCR, SKT HD CAP (8-32 X .38) STRIP GUIDE	107
REF		2-21000-9	SCR, SKT HD CAP (8-32 X .75) STRIP GUIDE	106
REF		3-21000-7	SCR, SKT HD CAP (10-32 X .75) FD ROD GUIDE	105
REF		3-21000-9	SCR, SKT HD CAP (10-32 X 1.00) DRAG SPRING	104
REF		3-21000-6	SCR, SKT HD CAP (10-32 X .62) FD ADJ PLATE	103
REF		3-21000-4	SCR, SKT HD CAP (10-32 X .38) PIVOT BLK	102
REF		3-21000-8	SCR, SKT HD CAP (10-32 X .88) SHEAR PLATE	101
REF		455750-4	GUARD ASSY	79
REF		465184-9	LUBRICATOR ASSY	78
REF		455985-1	OIL, LUBRICATING	77
REF		454406-1	SPACER, LUB BRACKET	76
REF		21017-2	SCR, DRIVE (#2 X .19) ID PLATE	75
REF		461264-1	PLATE, ID	74
REF		458109-1	WASHER, FLAT (SPECIAL)	73
REF		690603-1	SPRING, ASSIST	72
REF		690517-1	SPACER	71
REF		22594-8	NUT, HEX	70
REF		240628-1	PLATE, ADJ	69
REF		240626-1	SHAFT, PIVOT	68
REF		240633-1	BUSHING	67
REF		455680-1	LEVER, INTERMEDIATE	66
REF		240629-1	BLOCK, PIVOT	65
REF		240632-2	SCREW, ADJ	64
REF		240659-3	PIN, CAM ROLLER	63
REF		240658-1	CAM, ROLLER	62
REF		454398-1	ROD, FEED	61
REF				60

CRIMPING DATA				APPLICATOR WILL APPLY	
PAD LTR	CRIMP HEIGHT	WIRE SIZE	WIRE STRIP LENGTH		
A	.065	16			505002
B	.058	18			770325
C	.055	20			
D	NOT USED				
CRIMP	SIZE	TYPE	FEED	APPL INST	
WIRE	.090	F			
INSUL			.630	A1 8039	
WIRE RANGE	20-16	INSULATION RANGE	PRESS NO		

REMARKS: AMPOMATOR
CAUTION: DO NOT USE LUBRICATION ON TERM. STRIP.
FEED OFF RECEPTACLE

REMARKS	NO	REV
APPL USED ON MACHINE PART NO	MACH SERIAL NO	TO APPLY TERMINAL
CUSTOMER NAME	APPL SERIAL NO	DISTRIBUTION
ADDRESS	PURCHASE ORDER	ORIGINAL
CITY	ENG APP	CUSTOMER COPY
		FIELD ENG COPY

PIF	LTR	REVISION RECORD	APP DATE	APP	LTR	REVISION RECORD	APP DATE	APP

REVISION RECORD