

## Mechanical Dimensions: Inches [mm]

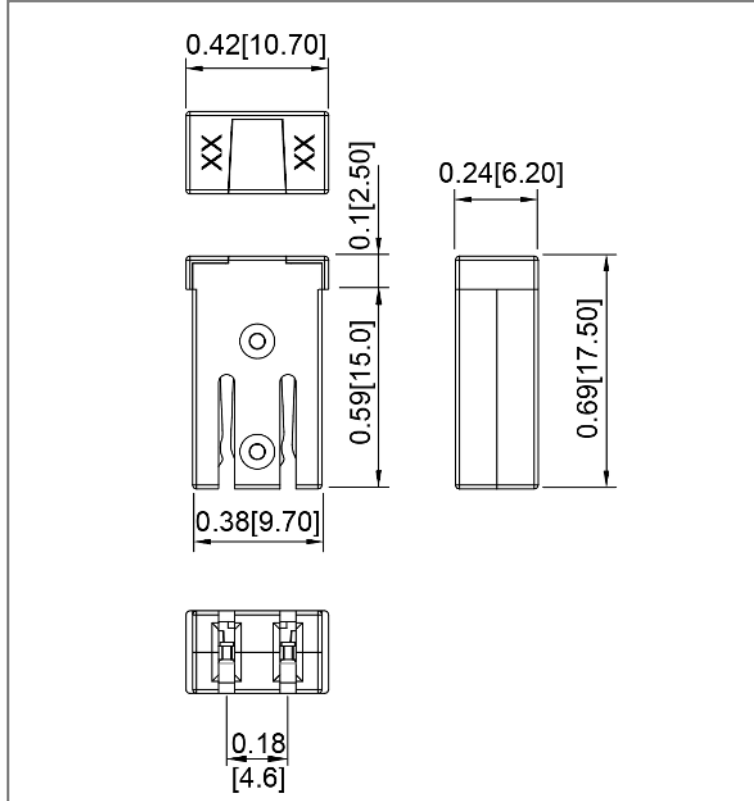

## Part Numbers Information

Optifuse P/N	Current	Body Color
FMX-MS-15A	15A	Gray
FMX-MS-20A	20A	Blue
FMX-MS-25A	25A	White
FMX-MS-30A	30A	Pink
FMX-MS-40A	40A	Green
FMX-MS-50A	50A	Red
FMX-MS-60A	60A	Yellow

## Mounting Hole

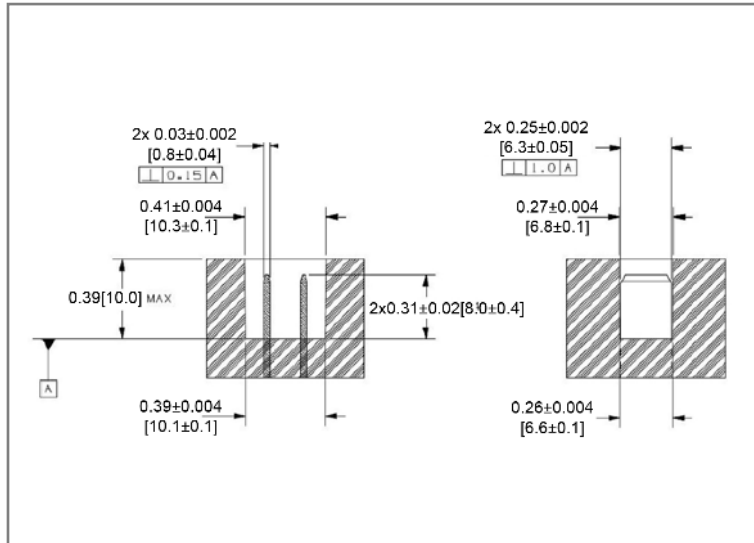

## Time vs. Percent of Rated Current

% of Rated Current	Min Hold Time	Max Hold Time
110%	4hr	-
135%	60s	1800s
200%	2s	60s
350%	200ms	7s
600%	40ms	1s

## Electrical Specifications

Voltage Rating	58VDC
Interrupting Rating	1000A 58VDC
Operating Temperature	-40°F~260°F

## Material Specifications

Body Material	Nylon with Fiberglass
Cover Material	Nylon 66
Insertion Force	45N Max.
Extraction Force	45N Min. / 35N Max.

**Rev**    **Date of issue**    **Revision Notes**

**Designed**    **Approved**

A	05-20-2020	Initial Drawing	RC	OF
---	------------	-----------------	----	----