

## WR-112 Waveguide Shim, UG-Cover Square Flange, 2mm Brass

### Waveguide Accessories Technical Data Sheet

**PEW112FS2**

#### Features

- WR-112 Waveguide Shim
- Square UG-Cover Flange Configuration
- Frequency Range: 6.57 GHz to 9.99 GHz
- 2 mm Thick Brass Construction

#### Description

PEW112FS2 is a WR-112 waveguide shim with operating frequency range from 6.57 GHz to 9.99 GHz. This waveguide shim is fabricated with 2 mm thick brass by high precision manufacturing process. PEW112FS2 can be used to bridge gaps between WR-112 waveguide components with UG-Cover Square flanges. Pasternack offers wide selection of waveguide components with high performance available in stock and same-day shipping to customers worldwide.

#### Electrical Specifications

Description	Minimum	Typical	Maximum	Units
Frequency Range	6.57		9.99	GHz

#### Mechanical Specifications

Body Material	Brass
Body Finish	Passivation
Length	0.079 in [2.01 mm]
Width	1.882 in [47.8 mm]
Height	1.882 in [47.8 mm]
Weight	0.132 lbs [59.87 g]

#### Compliance Certifications (see [product page](#) for current document)

WR-112 Waveguide Shim, UG-Cover Square Flange, 2mm Brass from Pasternack Enterprises has same day shipment for domestic and International orders. Our RF, microwave and millimeter wave products maintain a 99.4% availability and are part of the broadest selection in the industry.

Click the following link (or enter part number in "SEARCH" on website) to obtain additional part information including price, inventory and certifications: [WR-112 Waveguide Shim, UG-Cover Square Flange, 2mm Brass PEW112FS2](#)

URL: <https://www.pasternack.com/wr-112-waveguide-shim-2-mm-brass-ug-cover-square-pew112fs2-p.aspx>

The information contained in this document is accurate to the best of our knowledge and representative of the part described herein. It may be necessary to make modifications to the part and/or the documentation of the part, in order to implement improvements. Pasternack reserves the right to make such changes as required. Unless otherwise stated, all specifications are nominal. Pasternack does not make any representation or warranty regarding the suitability of the part described herein for any particular purpose, and Pasternack does not assume any liability arising out of the use of any part or documentation.

# PEW112FS2 CAD Drawing

WR-112 Waveguide Shim, UG-Cover Square Flange, 2mm Brass

REVISIONS			
REV.	DESCRIPTION	DATE	APPROVED
A	INITIAL RELEASE	4/11/2022	S. PONG

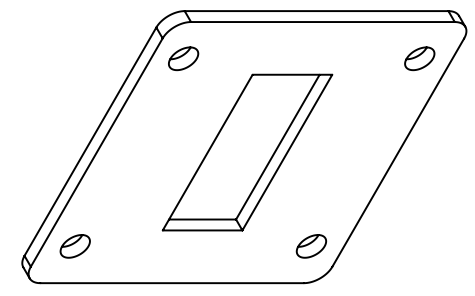
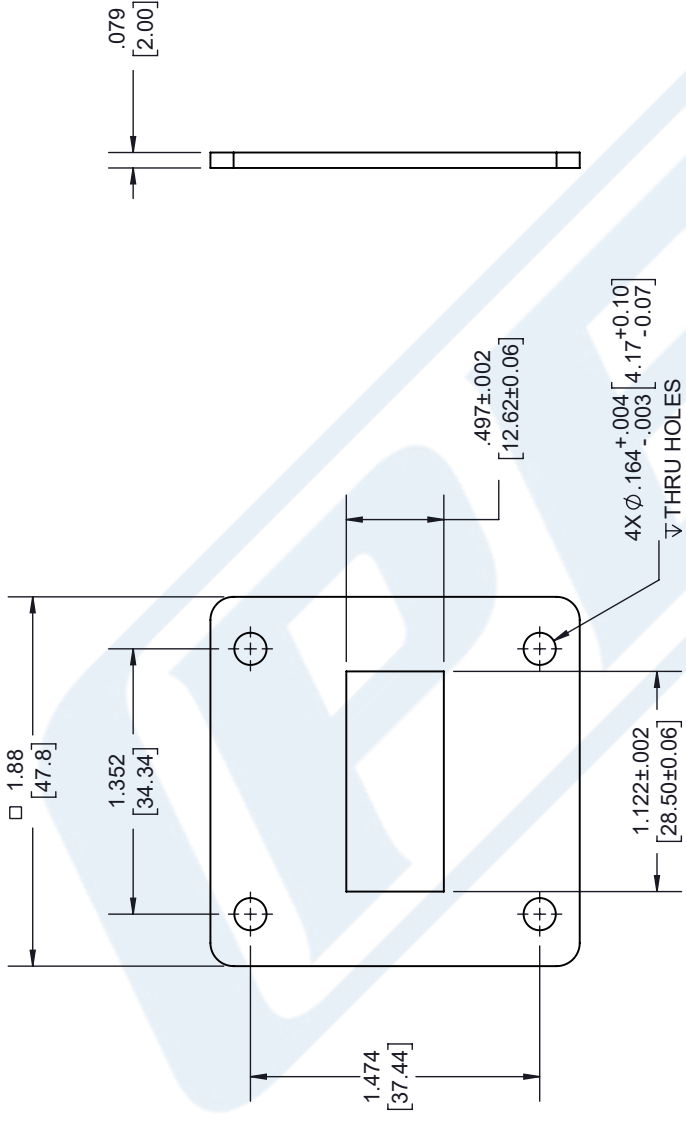

**PE PASTERNAK**  
an INFINITE brand

Pasternack Enterprises, Inc.  
P. O. Box 16759, Irvine, CA 92623.  
Phone: 1.949.261.1920 | 1.866.727.8376  
Fax: 1.949.261.7451  
Website: www.pasternack.com  
E-mail: sales@pasternack.com

THIRD-ANGLE PROJECTION

THE INFORMATION AND DESIGN IN THIS DOCUMENT IS THE PROPERTY OF PASTERNAK CORPORATION. ALL RIGHTS RESERVED.

SHEET 1 OF 1

SCALE N/A

REV A

ITEM NO. PEW112FS2

DRAWN BY K.DANG

SIZE A

CAGE CODE 53919

UNLESS OTHERWISE SPECIFIED LEADING DIMENSIONS ARE INCHES DIMENSIONS IN [ ] ARE MILLIMETERS

TOLERANCES:

FRACTIONS: .X = ±.2 [5.08] ±.1/32  
.XX = ±.02 [51] ±.1/32  
.XXX = ±.005 [13] ANGLES ± 1°

CABLE LENGTH (L), TOLERANCES:  
L ≤ 12 [305] = +1 [25] / -0  
12 [305] < L ≤ 60 [1524] = +2 [51] / -0  
60 [1524] < L ≤ 120 [3048] = +4 [102] / -0  
120 [3048] < L ≤ 300 [7620] = +6 [152] / -0  
300 [7620] < L = +5% / -0

ALL DIMENSIONS SHOWN ARE FOR REFERENCE ONLY.

THESE COMMODITIES, TECHNOLOGY OR SOFTWARE WERE EXPORTED FROM THE UNITED STATES IN ACCORDANCE WITH THE EXPORT ADMINISTRATION REGULATIONS. DIVERSION CONTRARY TO U.S. LAW PROHIBITED.