

THIS DRAWING IS UNPUBLISHED. RELEASED FOR PUBLICATION, 19 .
 © COPYRIGHT 19 BY AMP INCORPORATED. ALL INTERNATIONAL RIGHTS RESERVED.

LOC	DIST	P	F	REVISIONS				
				ZONE	LTR	DESCRIPTION	DATE	APPD
AG	1				G	SUPERSEDED -3, -5, -6, -9 & 1--1 PER 0440-0120-96	7-2-97	RT

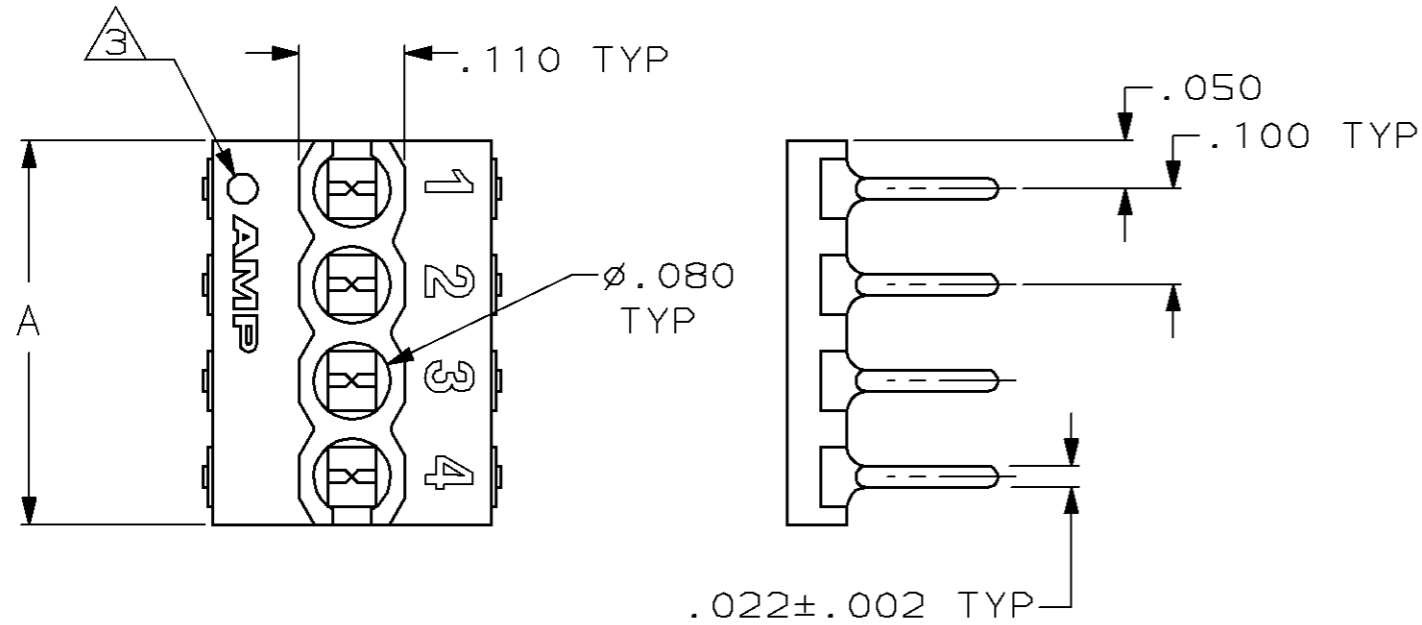

1. 5 TO 10 LBS REQUIRED TO PROGRAM EACH SHUNT POSITION.
2. MOUNTING SURFACE WHEN INSERTED IN .040 DIA MOUNTING HOLES
3. PIN NO. 1 IDENTIFICATION.
4. PIN 1 IDENT, AMP, AND POSITION NUMBERS ARE RECESSED.

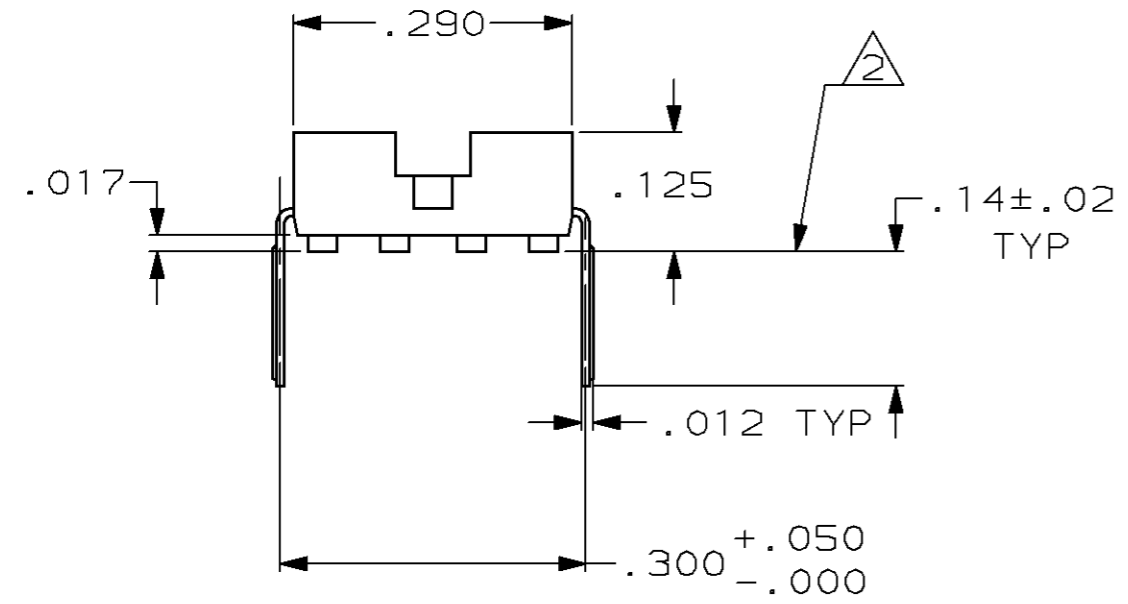

SUPERSEDED BY 1-435704-2	1.200	12	1-436860-1
SUPERSEDED BY 1-435704-0	1.000	10	436860-9
	.800	8	436860-7
SUPERSEDED BY 435704-7	.700	7	436860-6
SUPERSEDED BY 435704-6	.600	6	436860-5
SUPERSEDED BY 435704-4	.400	4	436860-3

		A	NO. OF POSN	PART NO
DO NOT SCALE PRINT. UNLESS SPECIFIED DIMENSIONS TOLERANCES ON: 2 PLC DEC ± - 3 PLC DEC ± .005 ANGLES ± -		DR 13 OCT 1989 M.CYRUS	AMP AMP INCORPORATED Harrisburg, Pa. 17105	
MATERIAL HOUSING: GRAY THERMOPLASTIC CONTACT: COPPER ALLOY		CHK 10-31-89 R.MILLER		
FINISH CONTACTS: .000100 MIN TIN OVER NICKEL		APPD 10-31-89 H.LEITER	NAME SHUNT, DIP, PROGRAMMABLE MACHINE INSERTABLE	
		APPD -	SIZE B	CAGE CODE 00779
		PRODUCT SPEC -	DRAWING NO 436860	
		APPLICATION SPEC -	SCALE 5:1	SHEET 1 OF 1
		WEIGHT -		