

MATERIALS AND FINISHES

BODY ZINC  
PLATED TIN

CENTER CONTACT BRASS  
PLATED GOLD

OUTER CASING HIGH  
TEMPERATURE PLASTIC  
KEYING SEE TABLE  
COLOR SEE TABLE

INSULATOR PA46

CAP BRASS  
PLATED NICKEL

PACKAGING BY TRAY

RETENTION SPECIFICATION

THE FAKRA CONNECTOR SHROUD  
WILL WITHSTAND A LONGITUDINAL  
FORCE OF 110 N (24.75 LBS)

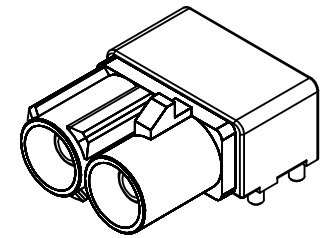
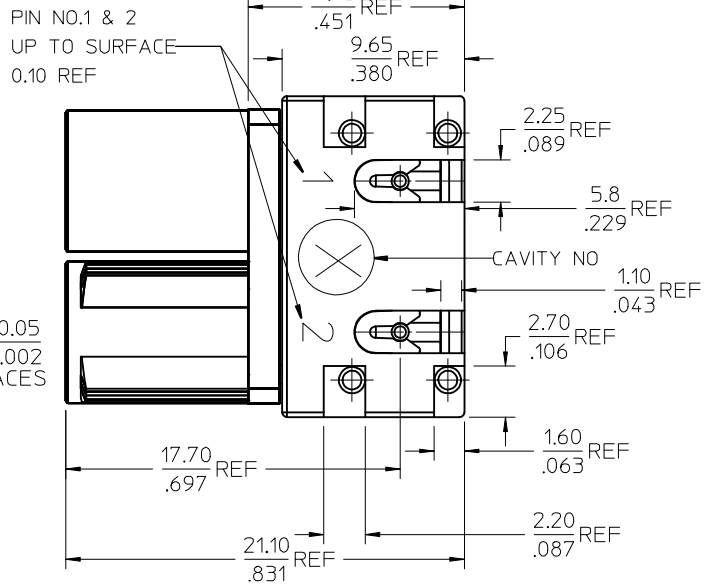
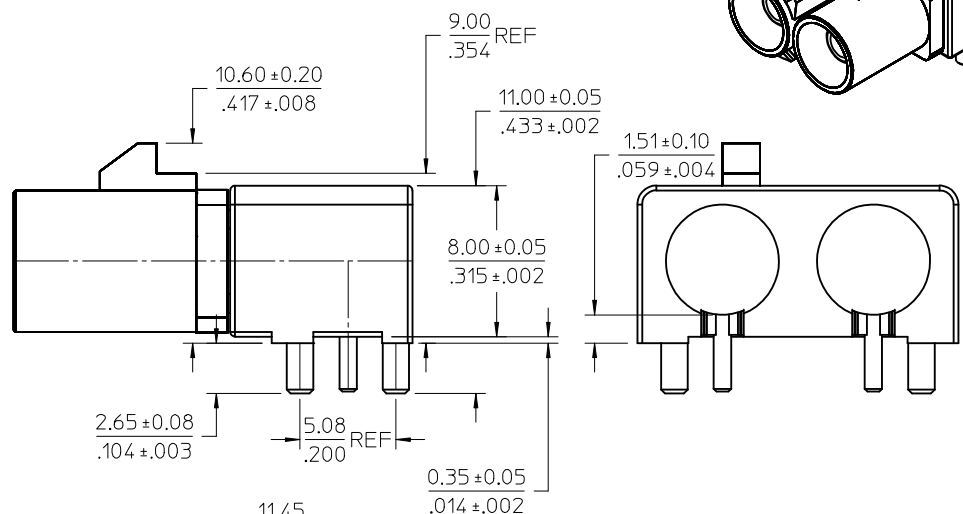
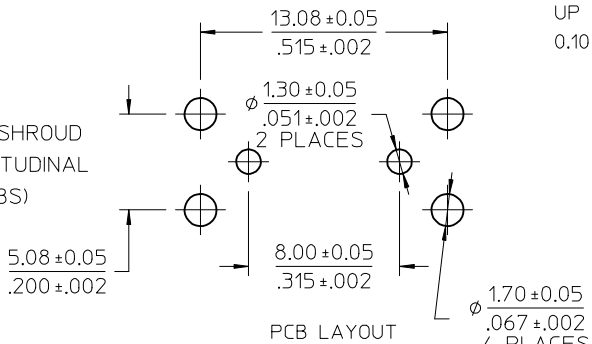
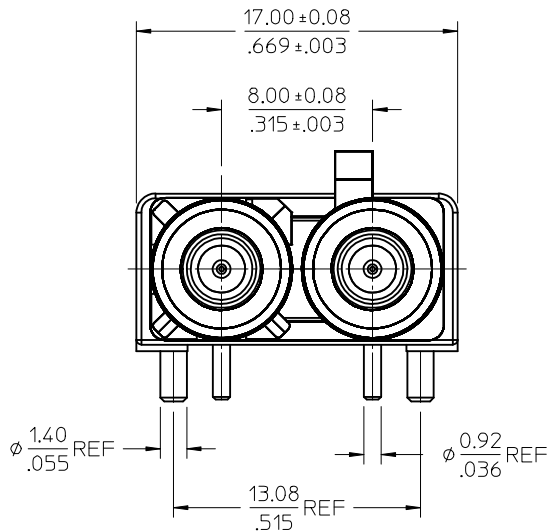

PS-89675-3310	PRODUCT SPECIFICATION
MIL-STD-348A, FIG. 311.1	INTERFACE SPECIFICATION
SPECIFICATION	DESCRIPTION

CHG P1& P2 MARK POSITION, ADD CAVITY NO.	EC NO: URF2009-0646
POSITION PDR0812149-D	DRWNSCHOU 2009/05/15
	CHKD: 2009/05/19
	APPR:MHUANG 2009/05/19

QUALITY SYMBOLS	GENERAL TOLERANCES (UNLESS SPECIFIED)
▽=0	mm INCH
▽=0	4 PLACES ± --- ± ---
	3 PLACES ± --- ± ---
	2 PLACES ± --- ± ---
	1 PLACE ± --- ± ---
	ANGULAR ± 2 °

DRAWN BY	DATE	TITLE
JOYCE	2008/12/24	SMB JACK, FAKRA DUAL
CHECKED BY	DATE	R/A PCB 50 OHMS
KERRIE	2008/12/24	SMB-J/PCB
APPROVED BY	DATE	
MISEN	2008/12/24	

DIMENSION STYLE	SCALE	DESIGN UNITS	THIRD ANGLE PROJECTION
MM/IN		METRIC	
MATERIAL NO.	DOCUMENT NO.	SHEET NO.	
SEE TABLE	SD-73403-519	1 OF 2	

MOLEX INCORPORATED	
THIS DRAWING CONTAINS INFORMATION THAT IS PROPRIETARY TO MOLEX INCORPORATED AND SHOULD NOT BE USED WITHOUT WRITTEN PERMISSION	

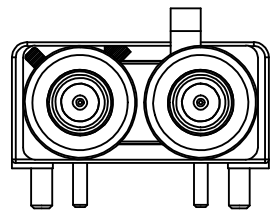

CODE-A

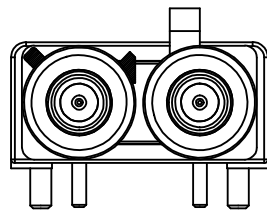

CODE-B

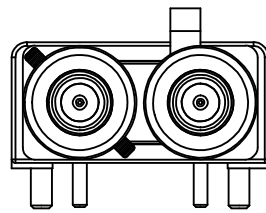

CODE-C

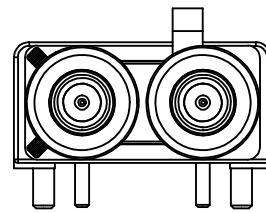

CODE-D

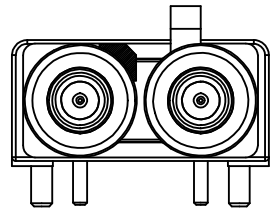

CODE-E

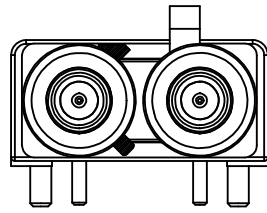

CODE-F

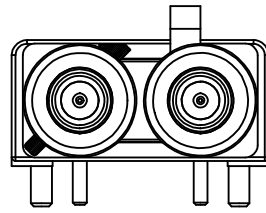

CODE-G

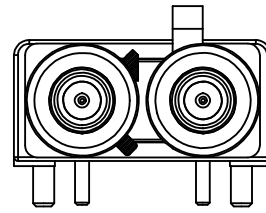

CODE-H

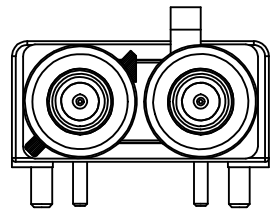

CODE-I

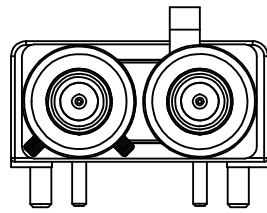

CODE-K

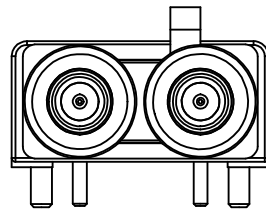

CODE-Z

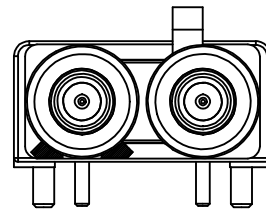

CODE-L

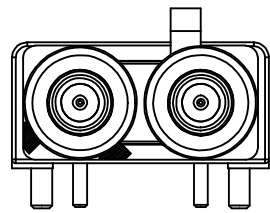

CODE-M

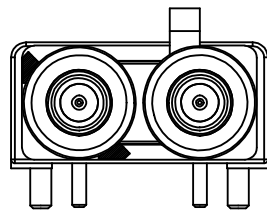

CODE-N

N	PASTEL GREEN	73403-5203
M	PASTEL ORANGE	73403-5202
L	CARMINE RED	73403-5201
Z	WATER BLUE	73403-5200
K	CURRY YELLOW	73403-5199
I	BEIGE	73403-5198
H	VIOLET	73403-5197
G	GRAY	73403-5196
F	BROWN	73403-5195
E	GREEN	73403-5194
D	BORDEAUXVIOLET	73403-5193
C	BLUE	73403-5192
B	CREAM WHITE	73403-5191
A	BLACK	73403-5190
KEYING CODE	COLOR	PART NO.

SEE SHEET 1 EC NO: URF2009-0646 2009/05/15 DRWNSCHOU 2009/05/19 CHKD: APPR:MHUANG 2009/05/19	QUALITY SYMBOLS ▽=0 ▽=0	GENERAL TOLERANCES (UNLESS SPECIFIED) <table border="1"> <tr> <td></td> <td>mm</td> <td>INCH</td> </tr> <tr> <td>4 PLACES</td> <td>± .---</td> <td>± .---</td> </tr> <tr> <td>3 PLACES</td> <td>± .---</td> <td>± .---</td> </tr> <tr> <td>2 PLACES</td> <td>± .---</td> <td>± .---</td> </tr> <tr> <td>1 PLACE</td> <td>± .---</td> <td>± .---</td> </tr> </table> ANGULAR ± 2 °		mm	INCH	4 PLACES	± .---	± .---	3 PLACES	± .---	± .---	2 PLACES	± .---	± .---	1 PLACE	± .---	± .---	DIMENSION STYLE MM/IN DRAWN BY DATE JOYCE 2008/12/24 CHECKED BY DATE KERRIE 2008/12/24 APPROVED BY DATE MISEN 2008/12/24	SCALE DESIGN UNITS METRIC THIRD ANGLE PROJECTION	TITLE SMB JACK, FAKRA DUAL R/A PCB 50 OHMS SMB-J/PCB
		mm	INCH																	
	4 PLACES	± .---	± .---																	
	3 PLACES	± .---	± .---																	
2 PLACES	± .---	± .---																		
1 PLACE	± .---	± .---																		
MATERIAL NO. SEE TABLE	DOCUMENT NO. SD-73403-519	SHEET NO. 2 OF 2																		
DRAFT WHERE APPLICABLE MUST REMAIN WITHIN DIMENSIONS			MOLEX INCORPORATED																	
THIS DRAWING CONTAINS INFORMATION THAT IS PROPRIETARY TO MOLEX INCORPORATED AND SHOULD NOT BE USED WITHOUT WRITTEN PERMISSION			MOLEX																	

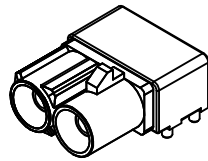

P/N 73403-519X

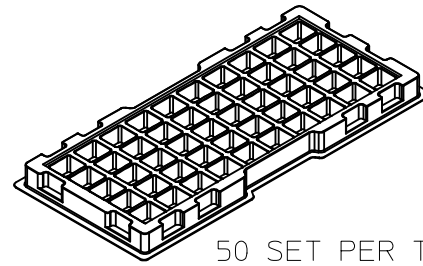

50 SET PER TRAY  
TRAY P/N 89707-0343

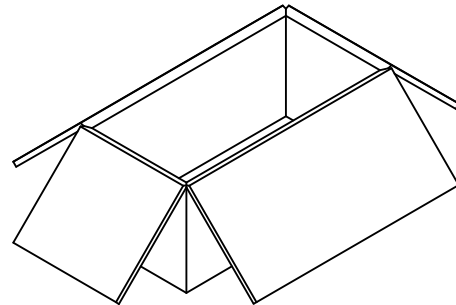

400 SET PER INNER  
CARTON BOX  
P/N 96707-0001

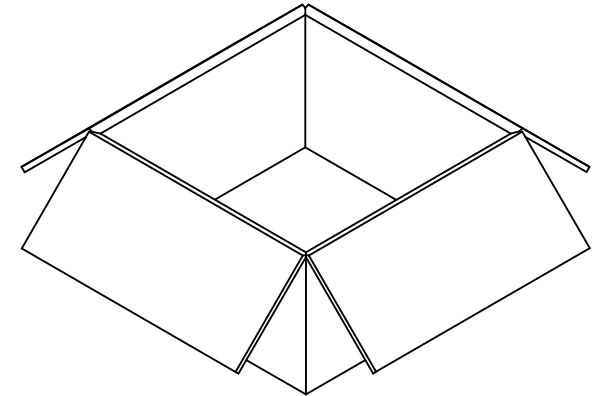

800 SET PER OUTER  
CARTON BOX  
P/N 96708-0005

<b>PDR0812149-D</b> EC NO: URF2009-0646 DRWNSCHOU 2009/05/15 CHKD: 2009/05/19 APPR: MHUANG 2009/05/19	QUALITY SYMBOLS = 0 = 0	GENERAL TOLERANCES (UNLESS SPECIFIED)		DIMENSION STYLE <b>MM/IN</b>	SCALE DESIGN UNITS <b>METRIC</b>	THIRD ANGLE PROJECTION																									
		<table border="1"> <tr> <th></th> <th>mm</th> <th>INCH</th> </tr> <tr> <td>4 PLACES</td> <td>± ---</td> <td>± ---</td> </tr> <tr> <td>3 PLACES</td> <td>± ---</td> <td>± ---</td> </tr> <tr> <td>2 PLACES</td> <td>± ---</td> <td>± ---</td> </tr> <tr> <td>1 PLACE</td> <td>± ---</td> <td>± ---</td> </tr> </table>		mm	INCH	4 PLACES	± ---	± ---	3 PLACES	± ---	± ---	2 PLACES	± ---	± ---	1 PLACE	± ---	± ---	<table border="1"> <tr> <th>DRAWN BY</th> <th>DATE</th> </tr> <tr> <td>JOYCE</td> <td>2009/04/17</td> </tr> <tr> <th>CHECKED BY</th> <th>DATE</th> </tr> <tr> <td>KERRIE</td> <td>2009/04/17</td> </tr> <tr> <th>APPROVED BY</th> <th>DATE</th> </tr> <tr> <td>MISEN</td> <td>2009/04/17</td> </tr> </table>	DRAWN BY	DATE	JOYCE	2009/04/17	CHECKED BY	DATE	KERRIE	2009/04/17	APPROVED BY	DATE	MISEN	2009/04/17	TITLE <b>PACKAGING FOR 73403-519X</b>
		mm	INCH																												
	4 PLACES	± ---	± ---																												
3 PLACES	± ---	± ---																													
2 PLACES	± ---	± ---																													
1 PLACE	± ---	± ---																													
DRAWN BY	DATE																														
JOYCE	2009/04/17																														
CHECKED BY	DATE																														
KERRIE	2009/04/17																														
APPROVED BY	DATE																														
MISEN	2009/04/17																														
	ANGULAR ± 2 °	MATERIAL NO. -----	DOCUMENT NO. <b>SD-73403-519-PKG</b>	SHEET NO. <b>1 OF 1</b>																											
DRAFT WHERE APPLICABLE MUST REMAIN WITHIN DIMENSIONS	THIS DRAWING CONTAINS INFORMATION THAT IS PROPRIETARY TO MOLEX INCORPORATED AND SHOULD NOT BE USED WITHOUT WRITTEN PERMISSION		<b>MOLEX INCORPORATED</b>																												