

motor operator 110-230V AC/110-250V DC accessory for: 3VA5/6 400/600



| Model                                                                                                       |                                    |
|-------------------------------------------------------------------------------------------------------------|------------------------------------|
| product brand name                                                                                          | SETRON                             |
| product designation                                                                                         | Accessories                        |
| Product version                                                                                             | Motorized operating mechanism (MO) |
| General technical data                                                                                      |                                    |
| Voltage                                                                                                     |                                    |
| Type de tension pour la commande                                                                            | AC/DC                              |
| <ul style="list-style-type: none"> <li>Rated control supply voltage <math>U_s</math> at AC 50 Hz</li> </ul> | 110 V                              |
| <ul style="list-style-type: none"> <li>Rated control supply voltage <math>U_s</math> at AC 50 Hz</li> </ul> | 230 V                              |
| <ul style="list-style-type: none"> <li>Rated control supply voltage <math>U_s</math> at AC 60 Hz</li> </ul> | 110 V                              |
| <ul style="list-style-type: none"> <li>Rated control supply voltage <math>U_s</math> at AC 60 Hz</li> </ul> | 230 V                              |
| Rated operational power                                                                                     | 250 V·A                            |
| Current                                                                                                     |                                    |
| Mechanical Design                                                                                           |                                    |
| Rated control supply voltage $U_s$ with DC                                                                  | 110 V                              |
| connectable conductor cross-section / solid                                                                 |                                    |
| <ul style="list-style-type: none"> <li>minimum</li> </ul>                                                   | 1.5 mm <sup>2</sup>                |
| <ul style="list-style-type: none"> <li>maximum</li> </ul>                                                   | 2.5 mm <sup>2</sup>                |
| connectable conductor cross-section / finely stranded / with core end processing                            |                                    |
| <ul style="list-style-type: none"> <li>minimum</li> </ul>                                                   | 1.5 mm <sup>2</sup>                |
| <ul style="list-style-type: none"> <li>maximum</li> </ul>                                                   | 2.5 mm <sup>2</sup>                |
| connectable conductor cross-section / stranded                                                              |                                    |
| <ul style="list-style-type: none"> <li>minimum</li> </ul>                                                   | 1.5 mm <sup>2</sup>                |
| <ul style="list-style-type: none"> <li>maximum</li> </ul>                                                   | 2.5 mm <sup>2</sup>                |
| ambient temperature / during operation                                                                      |                                    |
| <ul style="list-style-type: none"> <li>minimum</li> </ul>                                                   | -25 °C                             |
| <ul style="list-style-type: none"> <li>maximum</li> </ul>                                                   | 70 °C                              |
| ambient temperature / during storage                                                                        |                                    |
| <ul style="list-style-type: none"> <li>minimum</li> </ul>                                                   | -40 ... +80                        |
| <ul style="list-style-type: none"> <li>maximum</li> </ul>                                                   |                                    |
| tightening torque                                                                                           |                                    |
| <ul style="list-style-type: none"> <li>minimum</li> </ul>                                                   | 0.36 N·m                           |
| <ul style="list-style-type: none"> <li>maximum</li> </ul>                                                   | 0.44 N·m                           |
| Connections according IEC                                                                                   |                                    |
| stripped length                                                                                             | 7 mm                               |

## Connections according UL

### Certificates

| General Product Approval | EMC | Declaration of Conformity |
|--------------------------|-----|---------------------------|
|--------------------------|-----|---------------------------|



[Miscellaneous](#)



| Declaration of Conformity | Shipping Approval | other |
|---------------------------|-------------------|-------|
|---------------------------|-------------------|-------|



EG-Konf.



EG-Konf.



EG-Konf.



EG-Konf.



URS

[Manufacturer Declaration](#)

other

[Miscellaneous](#)

### Further information

Information- and Downloadcenter (Catalogs, Brochures,...)

<http://www.siemens.com/lowvoltage/catalogs>

Industry Mall (Online ordering system)

<https://mall.industry.siemens.com/mall/en/en/Catalog/product?mlfb=3VA9447-0HA20>

Service&Support (Manuals, Certificates, Characteristics, FAQs,...)

<https://support.industry.siemens.com/cs/ww/en/ps/3VA9447-0HA20>

Image database (product images, 2D dimension drawings, 3D models, device circuit diagrams, ...)

[http://www.automation.siemens.com/bilddb/cax\\_en.aspx?mlfb=3VA9447-0HA20](http://www.automation.siemens.com/bilddb/cax_en.aspx?mlfb=3VA9447-0HA20)

Tender specifications

<http://www.siemens.com/specifications>

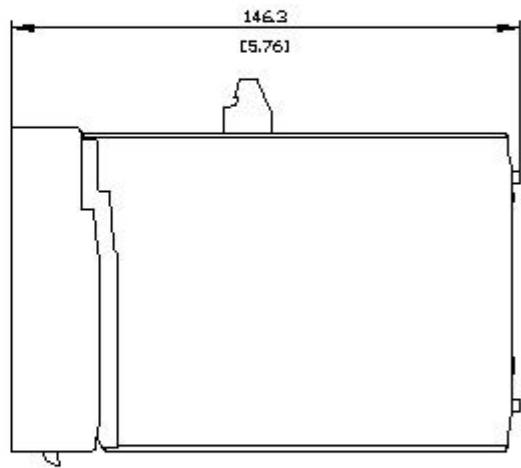
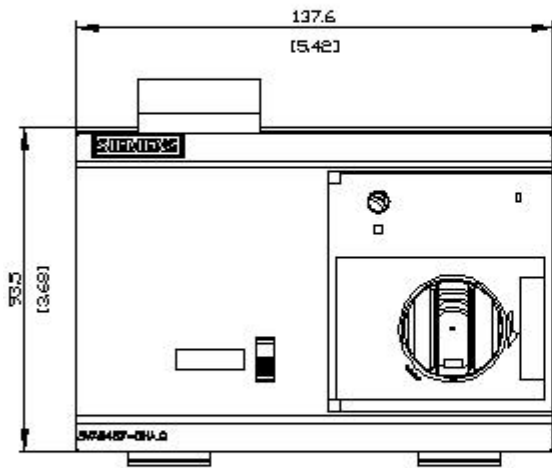

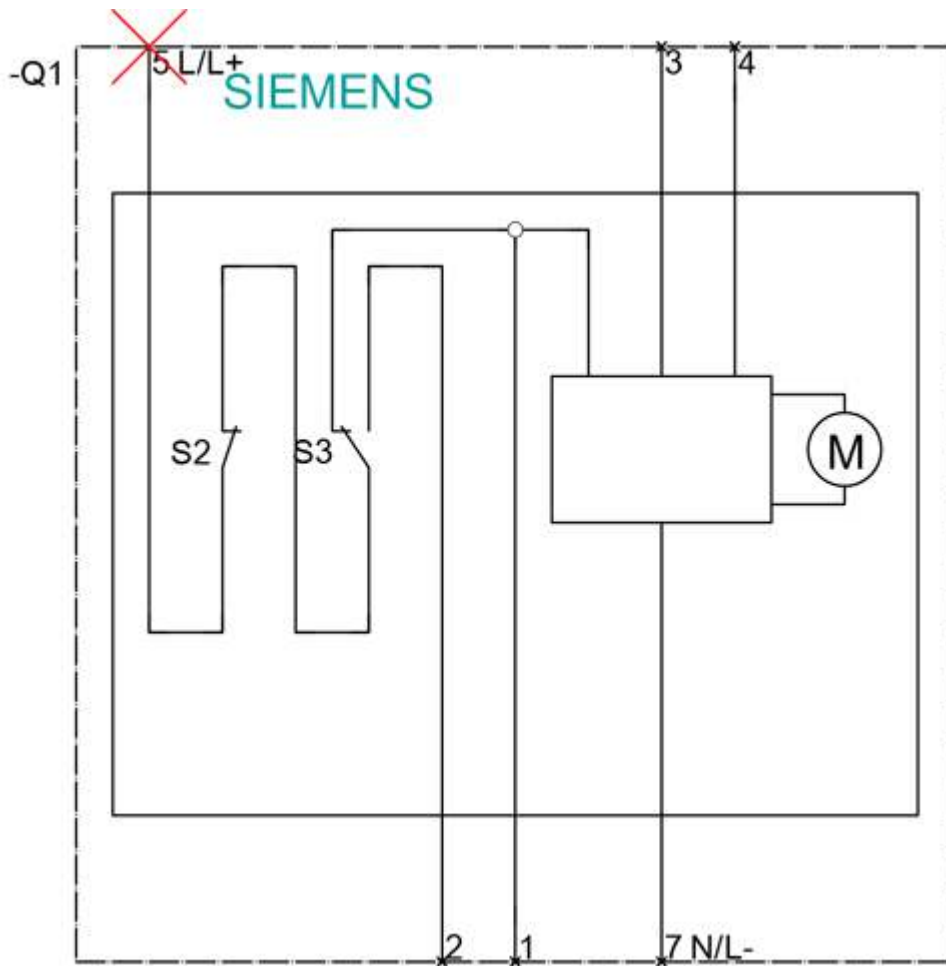

last modified:

12/18/2020