

MATERIALS AND FINISHES

BODY: BRASS
 OPTION 1:
 PLATED GOLD (8μ-in MIN)
 OVER NICKEL PHOSPHOR (80μ-in MIN)
 OVER COPPER (20μ-in MIN)
 OPTION 2:
 PLATED SILVER (200μ-in MIN)
 (WITH TARNISH RESISTANT TREATMENT)
 OVER COPPER (100μ-in MIN)
 OPTION 3:
 PLATED TRI-M (80μ-in MIN)

CONTACT: BRASS
 OPTION 1:
 PLATED GOLD (8μ-in MIN)
 OVER NICKEL PHOSPHOR (80μ-in MIN)
 OVER COPPER (20μ-in MIN)
 OPTION 2:
 PLATED SILVER (200μ-in MIN)
 (WITH TARNISH RESISTANT TREATMENT)
 OVER COPPER (100μ-in MIN)

INSULATOR: PTFE

ELECTRICAL

FREQUENCY RANGE: DC-10 GHz	
1.07 / -30dB	1.12 / -25dB
DC - 4 GHz	4 - 6 GHz
VSWR / RL	

NOTE: ABOVE DATA ARE FOR INDIVIDUAL CONNECTOR

73420-0395	OPTION 3	OPTION 1	TRAY
73420-0394			SINGLE PC
73420-0393	OPTION 2	OPTION 2	TRAY
73420-0392			SINGLE PC
73420-0391	OPTION 1	OPTION 1	TRAY
73420-0390			SINGLE PC
PART NO.	BODY	CONTACT	
	FINISH		PACKAGING

PS-89675-3760	ELEC/MECH PERFORMANCE
SPECIFICATION	DESCRIPTION

NOTE:

CENTER CONTACT RETENTION 15N MIN AXIAL FORCE

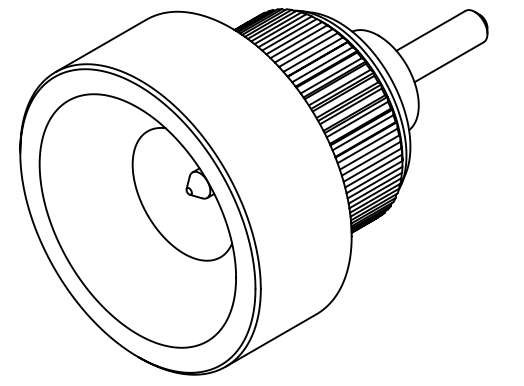
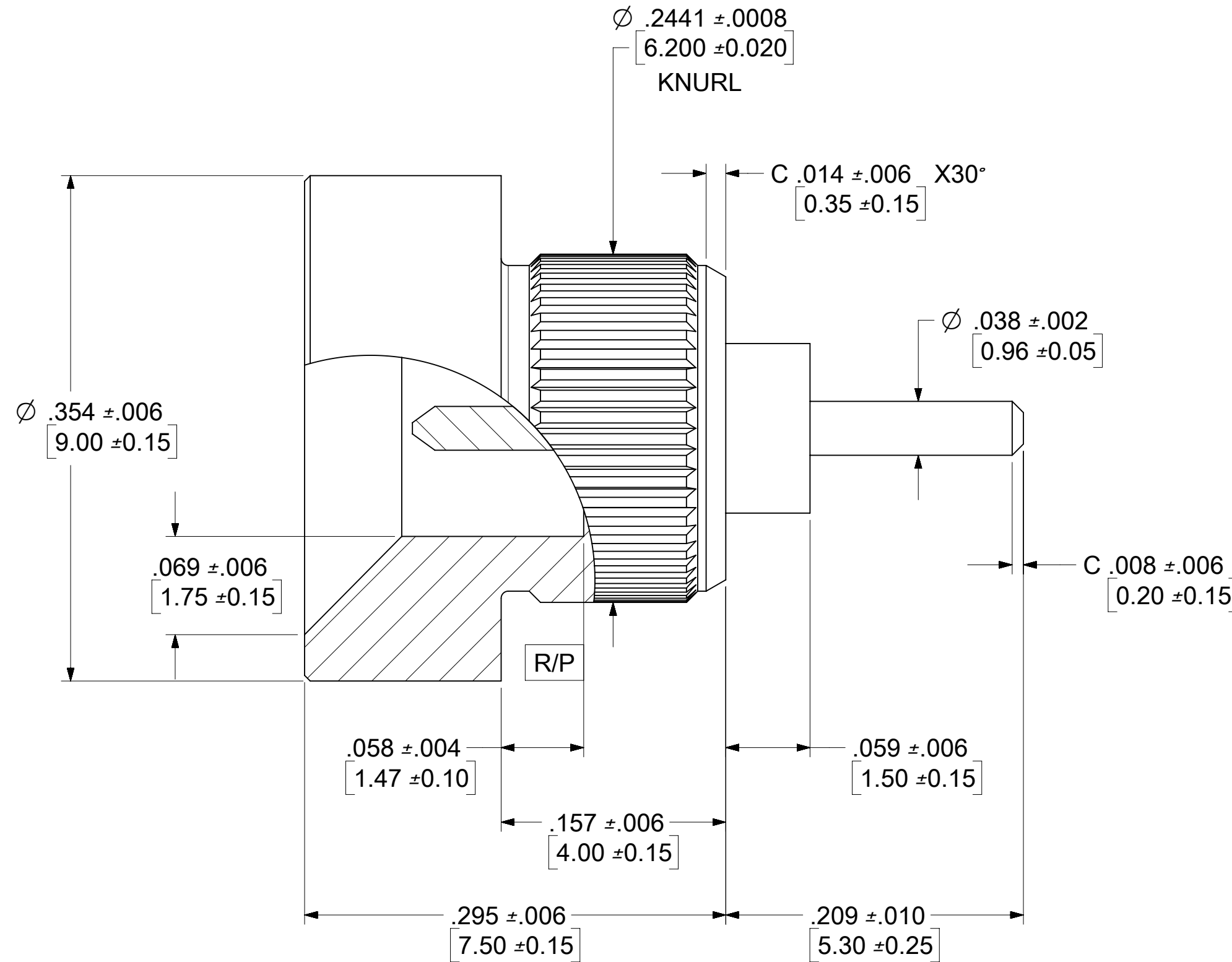

PANEL CUTOUT

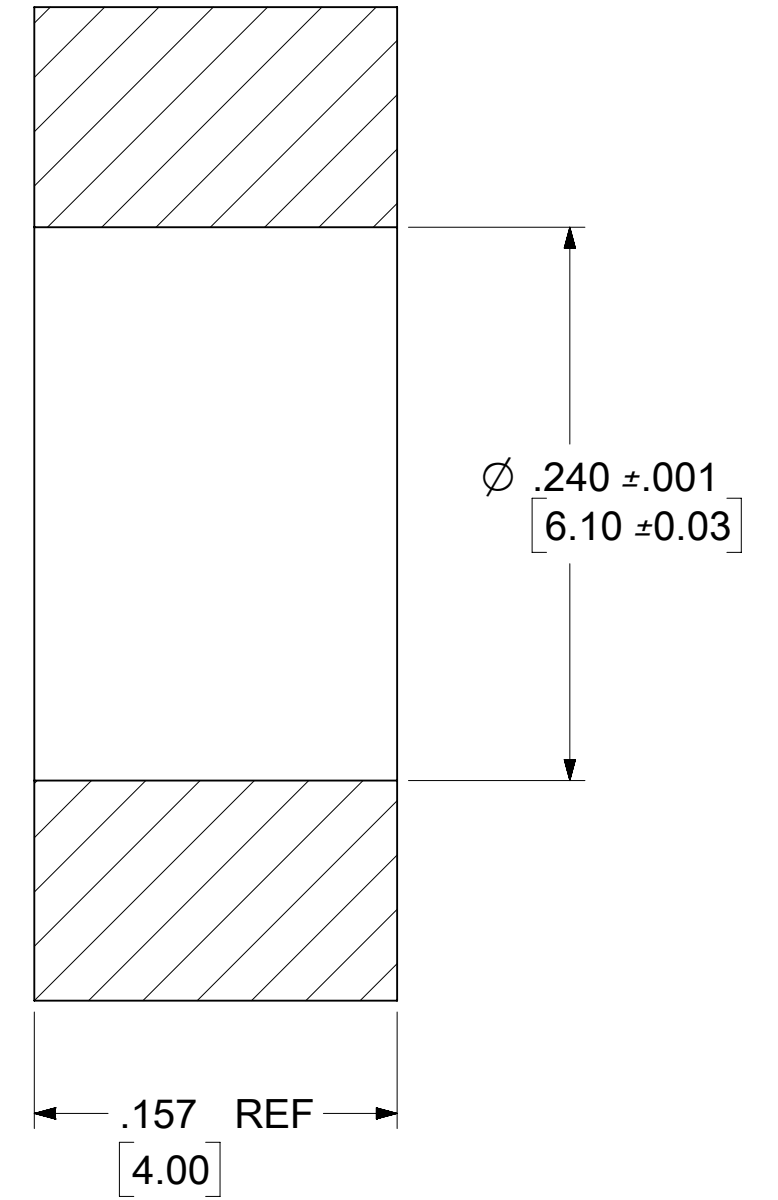

C7	2019/6/12	ADD -0394 & -0395 PER EWR #12677-C
REV	DATE	DESCRIPTION

THIS DRAWING CONTAINS INFORMATION THAT IS PROPRIETARY TO MOLEX ELECTRONIC TECHNOLOGIES, LLC AND SHOULD NOT BE USED WITHOUT WRITTEN PERMISSION									
DIMENSION UNITS	SCALE	CURRENT REV DESC:							
INCH/MM	NTS								
GENERAL TOLERANCES (UNLESS SPECIFIED)		EC NO: 619682			SMP-MAX RECEPTACLE STR				
ANGULAR TOL ± 2.0°		DRWN: RYEH 2019/06/12			SLIDE TYPE PANEL MOUNT EWR-10999				
4 PLACES ±		CHK'D: YCHENG 2019/07/04			PRODUCT CUSTOMER DRAWING				
3 PLACES ±		APPR: YCHENG 2019/07/04			DOCUMENT NUMBER				
2 PLACES ±		INITIAL REVISION:			SD-73420-039				
1 PLACE ±		DRWN: SSHAH 2010/10/05			DOC TYPE		DOC PART		REVISION
0 PLACES ±		APPR: JWIENER 2011/06/13			PSD		001		C7
DRAFT WHERE APPLICABLE MUST REMAIN WITHIN DIMENSIONS		THIRD ANGLE PROJECTION		DRAWING		SERIES		MATERIAL NUMBER	
				C-SIZE		73420		SEE TABLE	
				GENERAL MARKET				SHEET NUMBER	
								1 OF 3	

DOCUMENT STATUS	P1	RELEASE DATE	2019/07/04	03:14:29
-----------------	----	--------------	------------	----------



P/N: 73420-0390
 OR
 P/N: 73420-0392
 OR
 P/N: 73420-0394

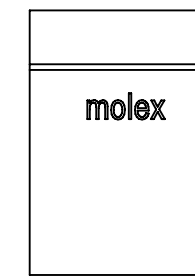
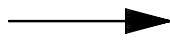

ONE PER BAG
 P/N: 89707-0135

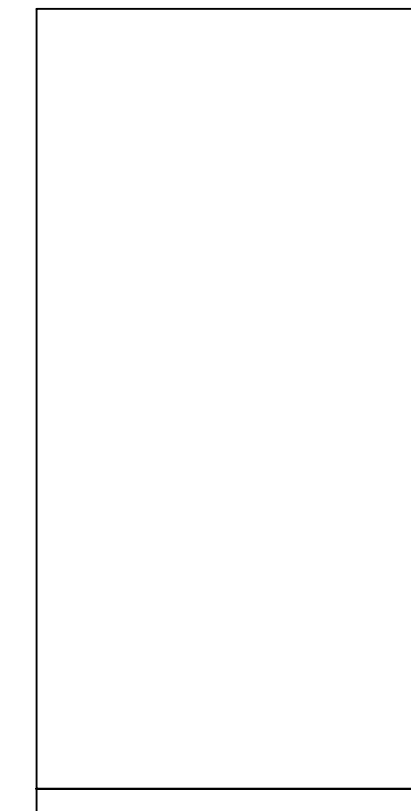

50 SETS PER BAG
 P/N: 89707-0174

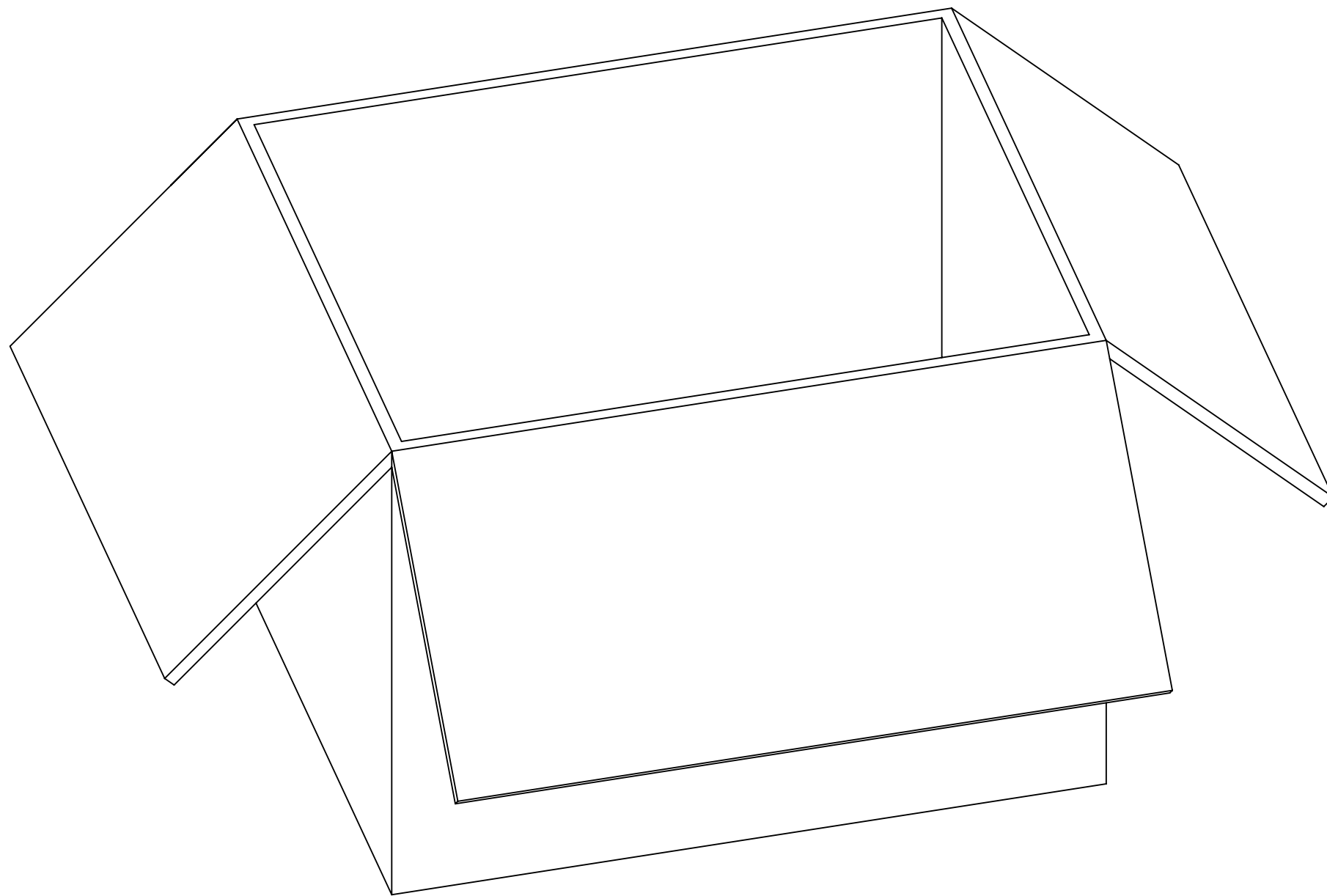
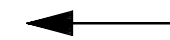

500 SETS PER CARTON
 BOX
 P/N: 89499-9027

THIS DRAWING CONTAINS INFORMATION THAT IS PROPRIETARY TO MOLEX ELECTRONIC TECHNOLOGIES, LLC AND SHOULD NOT BE USED WITHOUT WRITTEN PERMISSION

DIMENSION UNITS		SCALE		CURRENT REV DESC:		molex				
INCH/MM		NTS								
GENERAL TOLERANCES (UNLESS SPECIFIED)				EC NO: 619682		SMP-MAX RECEPTACLE STR SLIDE TYPE PANEL MOUNT EWR-10999				
ANGULAR TOL ± 2.0°				DRWN: RYEH 2019/06/12						
4 PLACES ±				CHK'D: YCHENG 2019/07/04		PRODUCT CUSTOMER DRAWING				
3 PLACES ±				APPR: YCHENG 2019/07/04						
2 PLACES ±				INITIAL REVISION:		DOCUMENT NUMBER				
1 PLACE ±				DRWN: SSHAH 2010/10/05						
0 PLACES ±				APPR: JWIENER 2011/06/13		SD-73420-039		DOC TYPE	DOC PART	REVISION
DRAFT WHERE APPLICABLE MUST REMAIN WITHIN DIMENSIONS		THIRD ANGLE PROJECTION		DRAWING	SERIES	MATERIAL NUMBER		CUSTOMER		SHEET NUMBER
				C-SIZE	73420	SEE TABLE		GENERAL MARKET		2 OF 3

DOCUMENT STATUS	P1	RELEASE DATE	2019/07/04	03:14:29
-----------------	----	--------------	------------	----------



P/N: 73420-0391
 OR
 P/N: 73420-0393
 OR
 P/N: 73420-0395

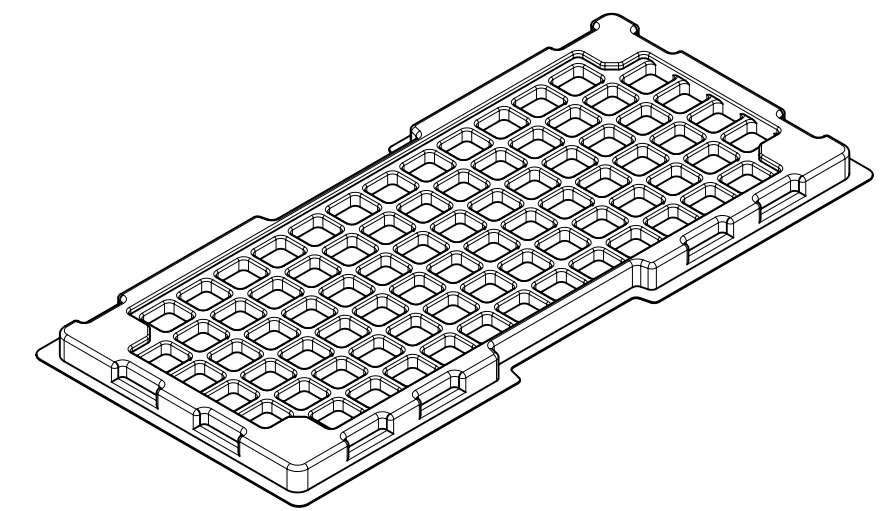
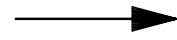

80 SETS PER TRAY
 P/N: 89707-0190

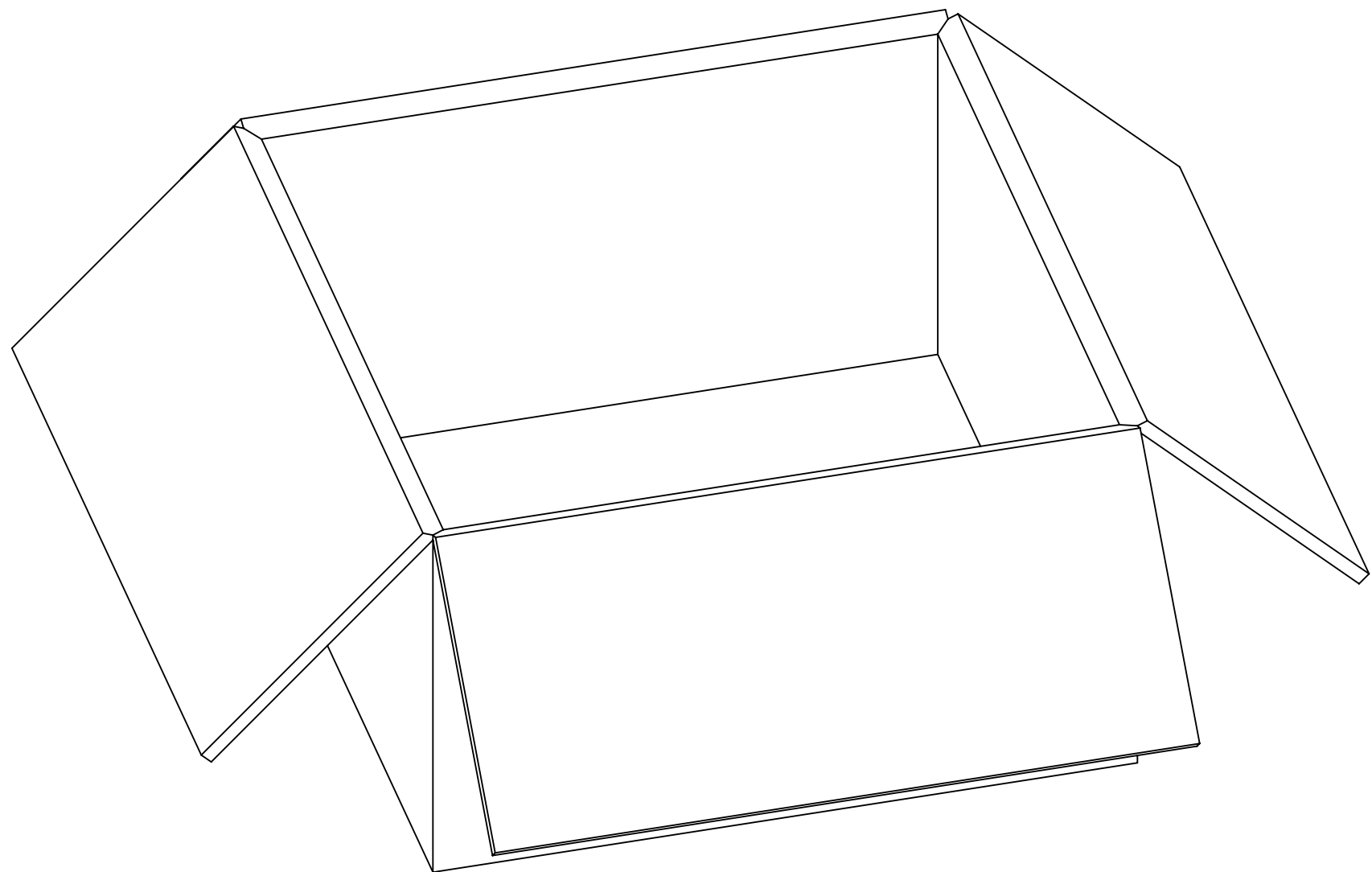
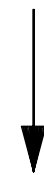

2400 SETS PER OUTER
 CARTON BOX
 P/N: 96708-0005

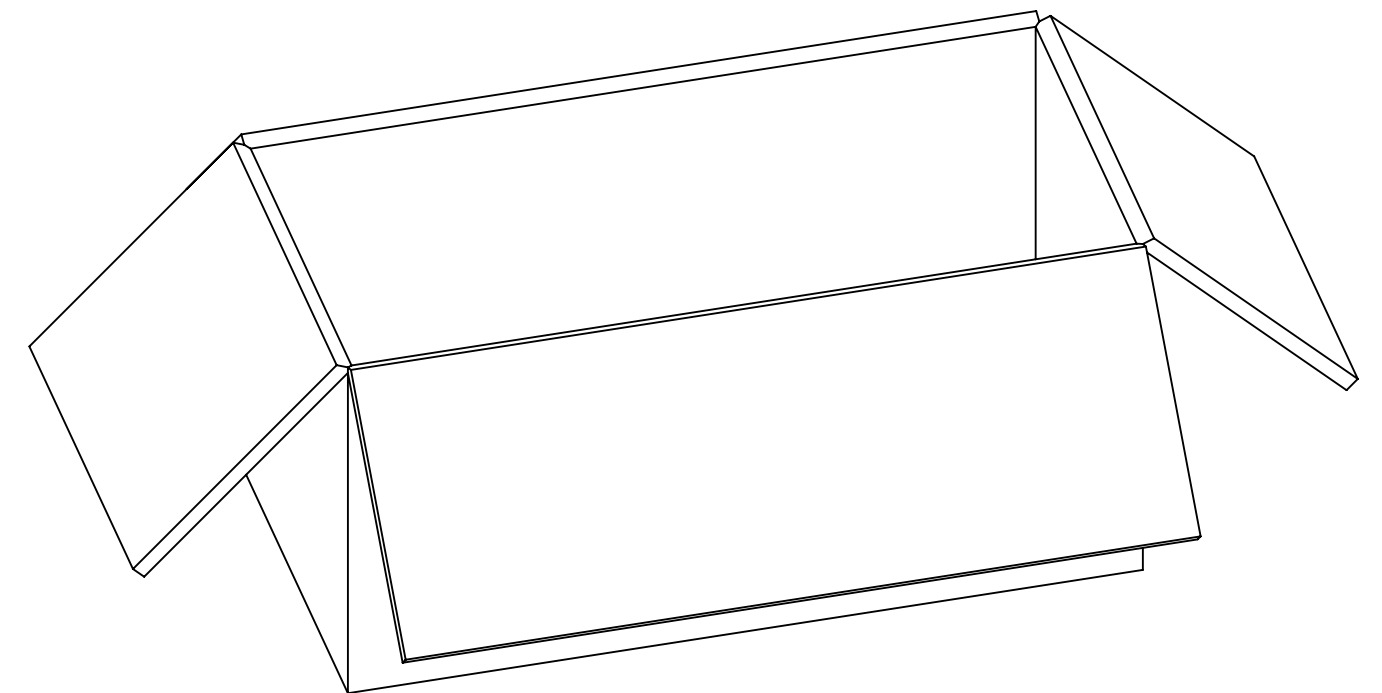
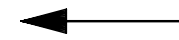

1200 SETS PER INNER
 CARTON BOX
 P/N: 96707-0001

THIS DRAWING CONTAINS INFORMATION THAT IS PROPRIETARY TO MOLEX ELECTRONIC TECHNOLOGIES, LLC AND SHOULD NOT BE USED WITHOUT WRITTEN PERMISSION									
DIMENSION UNITS		SCALE		CURRENT REV DESC:				molex	
INCH/MM		NTS							
GENERAL TOLERANCES (UNLESS SPECIFIED)				EC NO: 619682				SMP-MAX RECEPTACLE STR SLIDE TYPE PANEL MOUNT EWR-10999	
ANGULAR TOL ± 2.0°				DRWN: RYEH 2019/06/12					
4 PLACES ±				CHK'D: YCHENG 2019/07/04					
3 PLACES ±				APPR: YCHENG 2019/07/04				PRODUCT CUSTOMER DRAWING	
2 PLACES ±				INITIAL REVISION:				DOCUMENT NUMBER	
1 PLACE ±				DRWN: SSHAH 2010/10/05				SD-73420-039	
0 PLACES ±				APPR: JWIENER 2011/06/13				PSD 001 C7	
DRAFT WHERE APPLICABLE MUST REMAIN WITHIN DIMENSIONS		THIRD ANGLE PROJECTION		DRAWING		SERIES		MATERIAL NUMBER	
				C-SIZE		73420		SEE TABLE	
CUSTOMER		GENERAL MARKET		SHEET NUMBER		3 OF 3			

DOCUMENT STATUS	P1	RELEASE DATE	2019/07/04	03:14:29
-----------------	----	--------------	------------	----------