



sensor switches, compact, 22 mm, round, plastic, black, momentary contact type, with holder, Operating voltage 24 V DC, M12 connector, 4-pole

| | |
|---|---|
| product brand name | SIRIUS ACT |
| product designation | Sensor switches |
| design of the product | Compact unit |
| product type designation | 3SU1 |
| product line | Plastic, black, 22 mm |
| Enclosure | |
| shape of the enclosure front | round |
| number of command points | 1 |
| Actuator | |
| principle of operation of the actuating element | capacitive |
| product extension optional light source | No |
| color of the actuating element | black |
| material of the actuating element | plastic |
| shape of the actuating element | round |
| outer diameter of the actuating element | 53.6 mm |
| Front ring | |
| product component front ring | No |
| Holder | |
| material of the holder | Plastic |
| General technical data | |
| product function positive opening | No |
| insulation voltage rated value | 32 V |
| degree of pollution | 3 |
| type of voltage of the operating voltage | DC |
| protection class IP | IP66, IP67, IP69(IP69K) |
| degree of protection NEMA rating | 1, 2, 3, 3R, 4, 4X, 12, 13 |
| shock resistance | |
| <ul style="list-style-type: none"> according to IEC 60068-2-27 for railway applications according to EN 61373 | sinusoidal half-wave 15g / 11 ms Category 1, Class B |
| vibration resistance | |
| <ul style="list-style-type: none"> according to IEC 60068-2-6 for railway applications according to EN 61373 | 10 ... 500 Hz: 5g Category 1, Class B |
| operating frequency maximum | 3 600 1/h |
| reference code according to IEC 81346-2 | S |
| Substance Prohibitance (Date) | 10/01/2014 |
| operating voltage rated value | 24 V |
| Auxiliary circuit | |
| design of the contact of auxiliary contacts | electrical |
| number of NC contacts for auxiliary contacts | 0 |

| | |
|--|---|
| number of NO contacts for auxiliary contacts | 1 |
| Inputs/ Outputs | |
| number of outputs as contact-affected switching element as NO contact for signaling function instantaneous contact | 1 |
| Connections/ Terminals | |
| type of electrical connection | M12 connector, 4-pole |
| tightening torque of the screws in the bracket | 1 ... 1.2 N·m |
| Lamp | |
| type of light source | LED |
| Safety related data | |
| failure rate [FIT] with high demand rate according to SN 31920 | 213 FIT |
| MTTFd | 1 071 y |
| Ambient conditions | |
| ambient temperature <ul style="list-style-type: none"> during operation during storage | -25 ... +70 °C -40 ... +80 °C |
| environmental category during operation according to IEC 60721 | 3M6, 3S2, 3B2, 3C3, 3K6 (with relative air humidity of 10 ... 95%, no condensation in operation permitted for all devices behind front panel) |
| Installation/ mounting/ dimensions | |
| fastening method <ul style="list-style-type: none"> of modules and accessories | Front plate mounting |
| height | 40 mm |
| width | 30 mm |
| shape of the installation opening | round |
| mounting diameter | 22.3 mm |
| positive tolerance of installation diameter | 0.4 mm |
| mounting height | 19.6 mm |
| installation width | 53.6 mm |
| installation depth | 34 mm |
| Certificates/ approvals | |
| General Product Approval | Declaration of Conformity |

[Confirmation](#)



Test Certificates other

[Type Test Certificates/Test Report](#)

[Confirmation](#)

[Environmental Confirmations](#)

Further information

Information- and Downloadcenter (Catalogs, Brochures,...)

<https://www.siemens.com/ic10>

Industry Mall (Online ordering system)

<https://mall.industry.siemens.com/mall/en/en/Catalog/product?mlfb=3SU1200-1SK10-2SA0>

Cax online generator

<http://support.automation.siemens.com/WW/CAXorder/default.aspx?lang=en&mlfb=3SU1200-1SK10-2SA0>

Service&Support (Manuals, Certificates, Characteristics, FAQs,...)

<https://support.industry.siemens.com/cs/ww/en/ps/3SU1200-1SK10-2SA0>

Image database (product images, 2D dimension drawings, 3D models, device circuit diagrams, EPLAN macros, ...)

http://www.automation.siemens.com/bilddb/cax_de.aspx?mlfb=3SU1200-1SK10-2SA0&lang=en

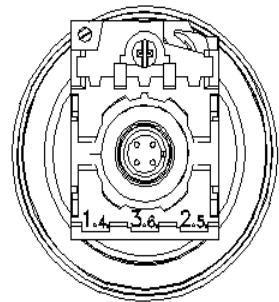
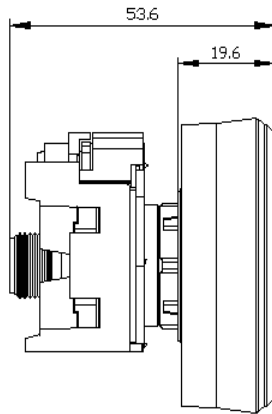
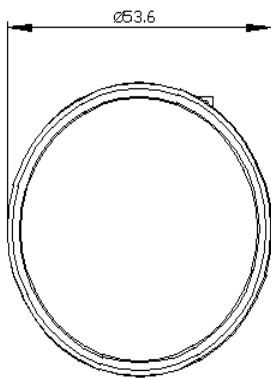

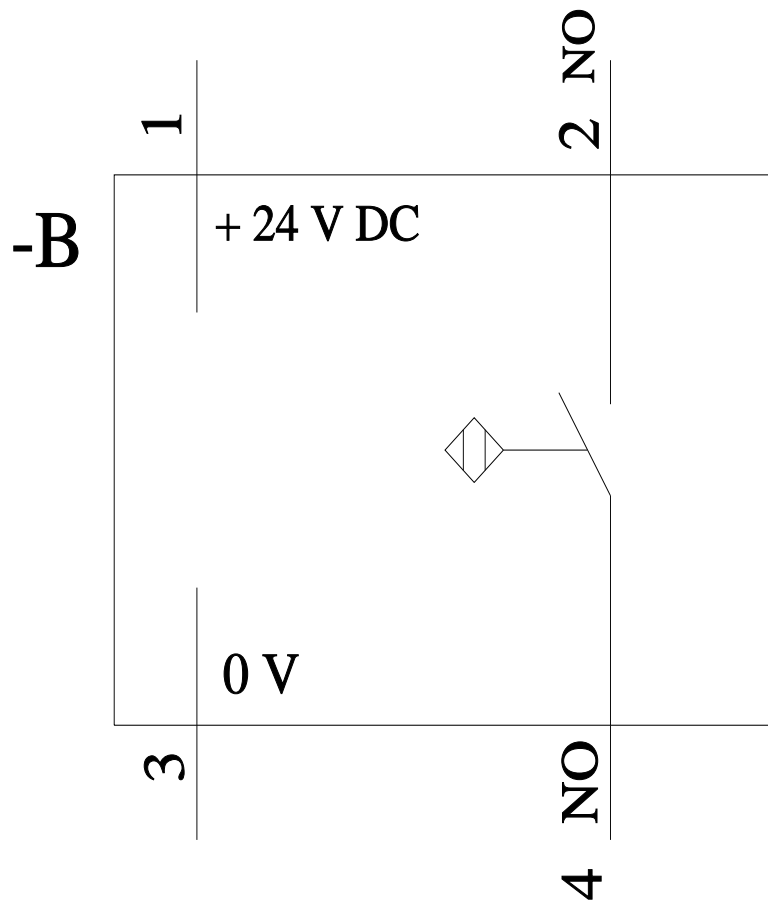

last modified:

1/27/2022 