

THIS DRAWING IS UNPUBLISHED. RELEASED FOR PUBLICATION
 © COPYRIGHT - BY TYCO ELECTRONICS CORPORATION. ALL RIGHTS RESERVED.

| LOC | DIST | REVISIONS | | | | | |
|-----|------|-----------|-----|------------------------------------|---------|-----|------|
| G | 86 | P | LTR | DESCRIPTION | DATE | DWN | APVD |
| | | G | | ECR-07-024762 (REDRAWN IN AUTOCAD) | 08APR08 | HMR | JR |

- 1 TONGUE MATERIAL THICKNESS: .072±.004.
- 2 BODY - CU PER ASTM B-152
INSERT - BRASS PER ASTM B-36
- 3 BODY - TIN PLATING PER ASTM B-545
INSERT - .000300 MIN EXT. THICK
TIN PLATE PER ASTM B-545

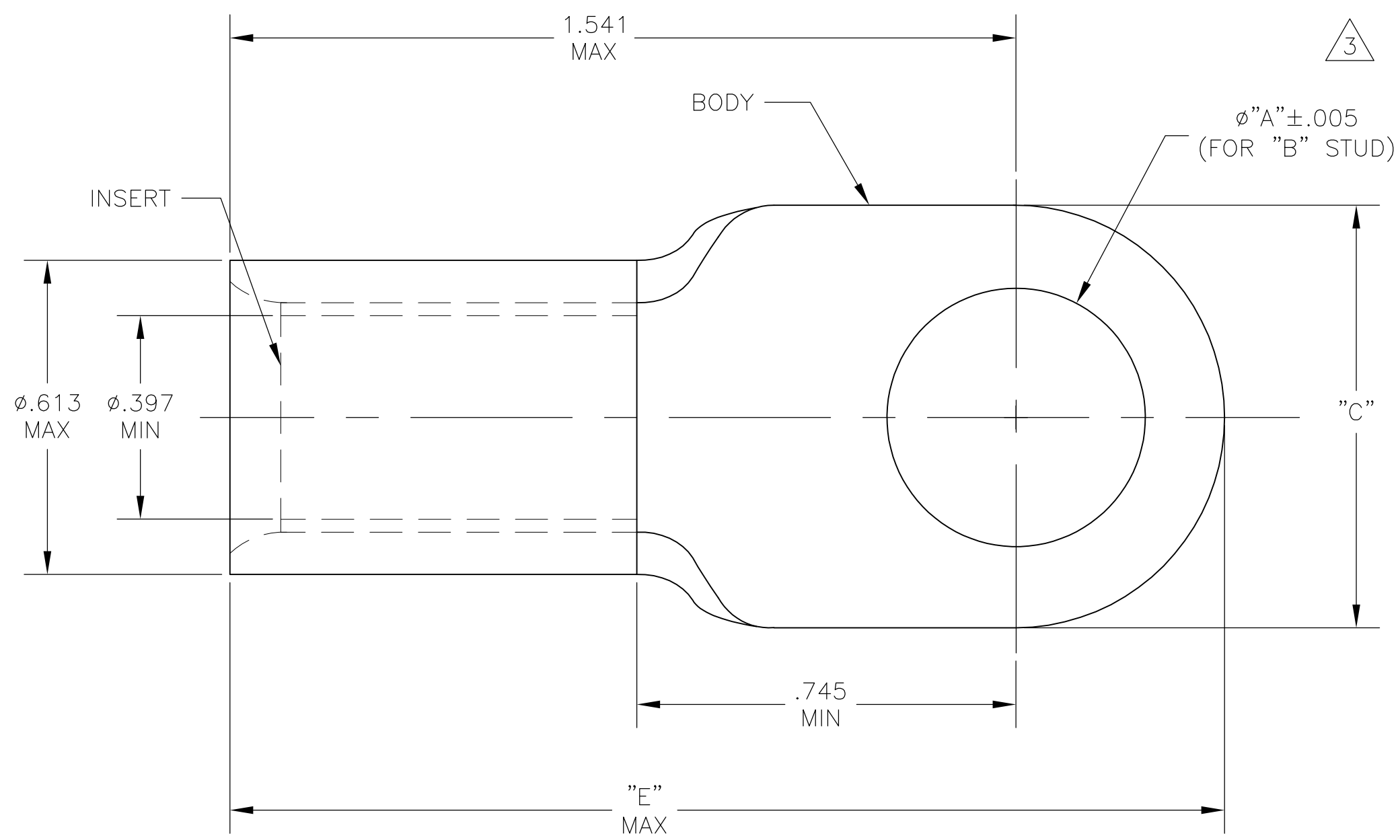

| | | | | |
|-------|------|------|------|---------|
| 1.925 | .807 | 1/2 | .515 | 51986-3 |
| 1.859 | .675 | 3/8 | .390 | 51986-2 |
| 1.859 | .675 | 5/16 | .328 | 51986-1 |
| 1.859 | .675 | 1/4 | .265 | 51986 |
| "E" | "C" | "B" | "A" | PART NO |

| | | |
|-----|---------------|-----------------|
| 1 | WIRE TERMINAL | SEE ABOVE TABLE |
| QTY | DESCRIPTION | PART NO |

| | | | | |
|---|-------------|---------------------------------|--|--------------------|
| THIS DRAWING IS A CONTROLLED DOCUMENT. | | DWN RAGHAVENDRA 08APR2008 | Tyco Electronics Corporation Harrisburg, PA 17105-3608 | |
| DIMENSIONS: INCHES | | CHK JEFF RUTH 08APR2008 | NAME | |
| TOLERANCES UNLESS OTHERWISE SPECIFIED: | | APVD JEFF RUTH 08APR2008 | WIRE TERMINAL COPALUM - STRANDED/SOLID WIRE SIZE 1/0 | |
| 0 PLC ± - 1 PLC ± - 2 PLC ± - 3 PLC ± .008 4 PLC ± - ANGLES ± 5° | | PRODUCT SPEC - | SIZE A3 | CAGE CODE 00779 |
| MATERIAL 2 | FINISH 3 | APPLICATION SPEC - | DRAWING NO G-51986 | RESTRICTED TO - |
| CUSTOMER DRAWING | | | SCALE 4:1 | SHEET 1 OF 1 |
| | | | REV G | |