

- PFC
- Wide Range AC Input
- Low Profile, Industry Standard Footprint
- Global Safety Agency Compliance
- RoHS Compliant

**Key Market Segments & Applications**

- Video/Audio Routers
- Datacom
- Point of Sale
- Test & Measurement
- LED Signs and Lighting

# ZPS100 Series

3" x 5" 100W AC-DC  
Power Supplies

## ZPS100 Features and Benefits

**Features**

- Industry Standard Footprint
- Up to 85% efficiency
- Broad product range
- Meets EN61000-4 immunity

**Benefits**

- Available to second source
- Less system heating
- Optimisation of power supply to system
- Greater reliability

### Specifications

MODEL		ZPS100
ITEMS		
Input Voltage range	-	90 - 264VAC (47 - 440Hz) or 120 - 370VDC
Inrush Current (132/264VAC)	A	25 / 50 (cold start)
Input Current (115/230VAC)	A	1.1 / 0.6
Temperature Coefficient	-	±0.05%/°C
Voltage Accuracy	-	±1%
Minimum Load	A	None
Load Regulation	-	±1%
Line Regulation	-	±0.5%
Ripple & Noise (1)	mV	1% or 50mV whichever is greater
Short Circuit Protection	-	Continuous - hiccup mode
Overvoltage Protection	V	Typically 110-130% of nominal
Hold Up Time (Typ)	ms	8ms at 115VAC input
LED Indicator	-	Green LED = OK
Operating Temperature		0 to +70°C with derating
Storage Temperature	-	-20 to +85°C
Humidity (non condensing)	-	10 - 95% RH
Cooling	-	Convection
Withstand Voltage		Input to Ground 1.5kVAC, Input to Output 3kVAC, Output to Ground 500VAC for 1 min.
Isolation Resistance		>100M at 25C & 70%RH, Output to Ground 500VDC
Vibration (non operating)		23.52m/s <sup>2</sup> (10 - 55Hz: constant sweep 1 min X, Y, Z for 1 hour)
Shock	-	< 196.1 m/s <sup>2</sup> (20G)
Class 1	-	UL60950, CSA60950, EN60950-1 Class 1, CE Mark (LVD)
Conducted & Radiated EMI	-	EN55022-B, FCC Class B
Immunity	-	EN61000-4-2,-3,-4,-5,-6,-8
Weight (Typ)	g	385g
Size (WxLxH)	mm	127 X 76.2 X 34 (including underside components )
Warranty	-	2 Year

**Notes:** (1) Measured with 0.1uF ceramic & 10uF electrolytic at 20MHz BW



Model Selector

Model	Output Voltage (V)	Maximum Output (A)	
ZPS100-3R3	V1	3.3	20
ZPS100-5	V1	5	20
ZPS100-9	V1	9	11.2
ZPS100-12	V1	12	8.4
ZPS100-15	V1	15	6.7
ZPS100-18	V1	18	5.6
ZPS100-24	V1	24	4.2
ZPS100-28	V1	28	3.6
ZPS100-48	V1	48	2.1

INTERMEDIATE VOLTAGES AVAILABLE  
PLEASE CONSULT SALES

For full data and drawings please visit  
[www.emea.tdk-lambda.com/www/zp](http://www.emea.tdk-lambda.com/www/zp)

Derating Curve ZPS100 Series

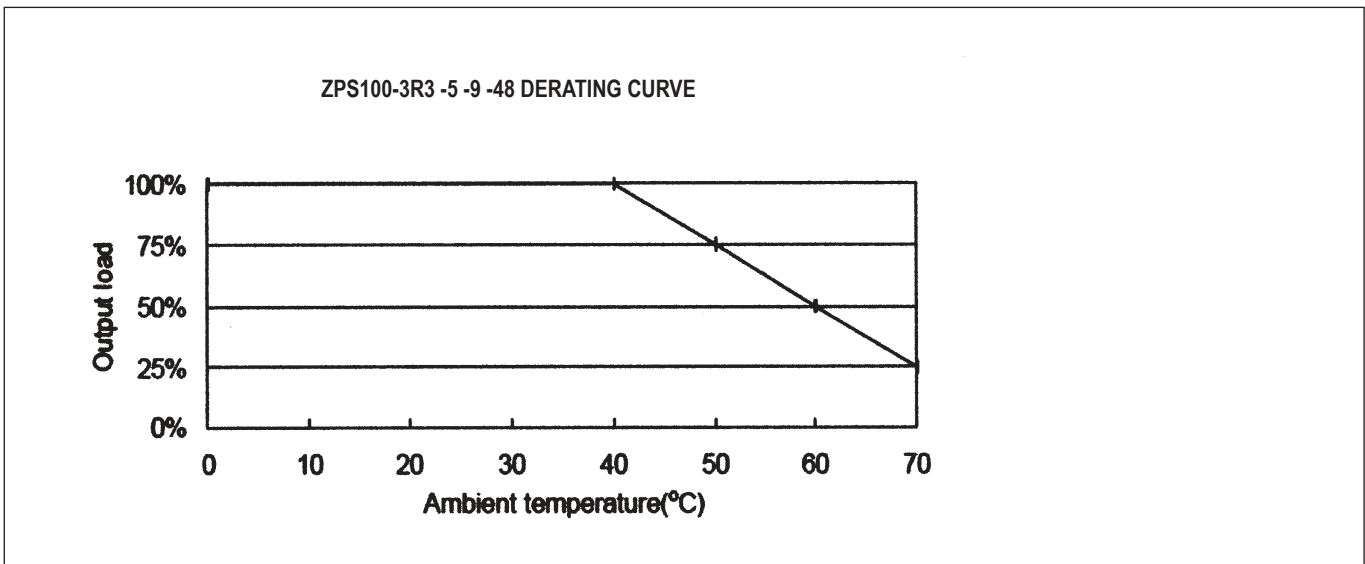

Derating Curve ZPS100 Series

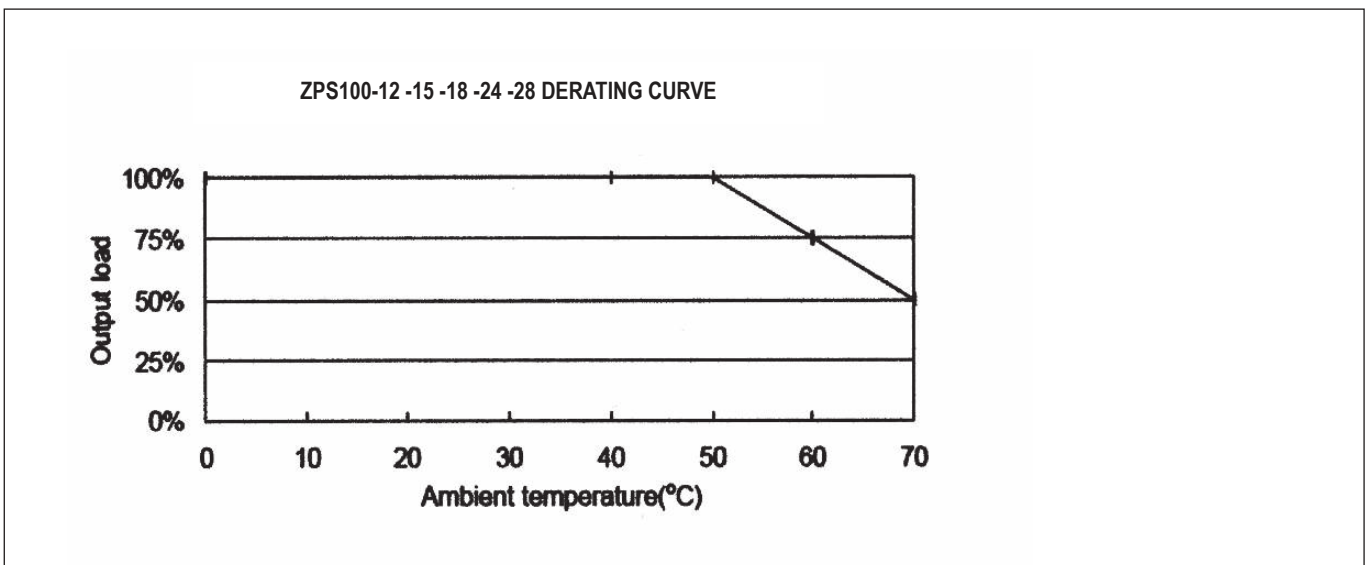



Outline Drawing ZPS100 Series

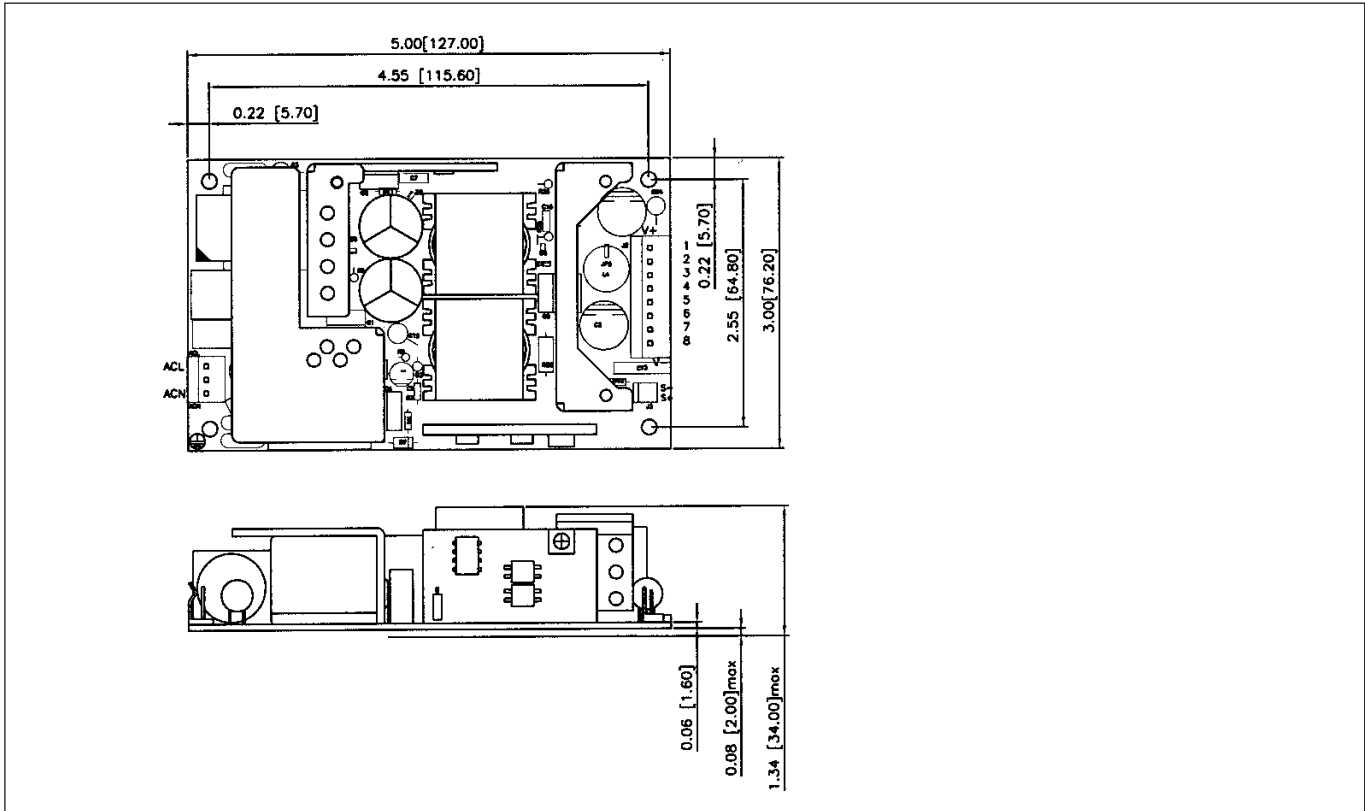

Outline Drawing ZPS100-5 Series

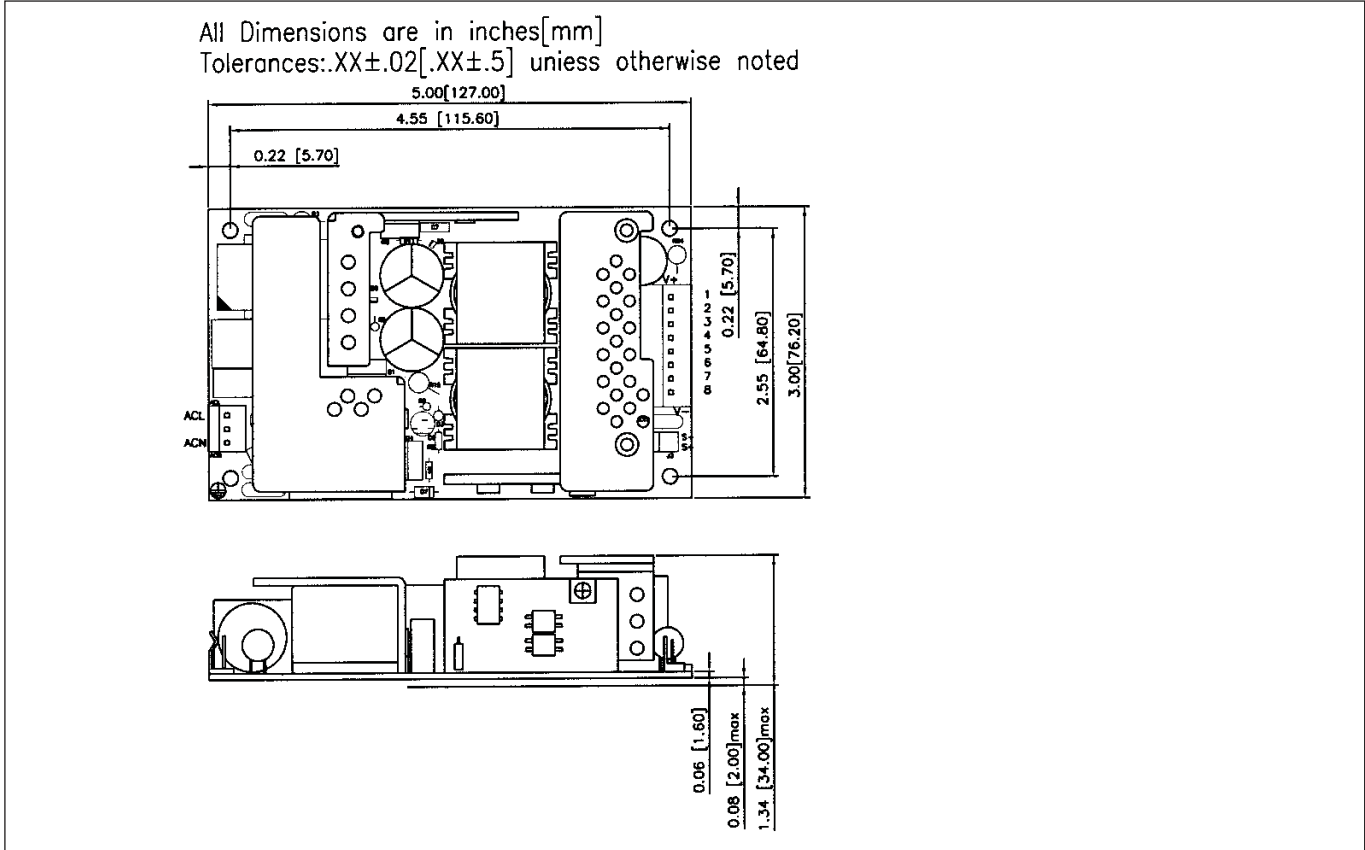

Input Connector Mates with Molex Housing 09-50-3031 and Molex 2478 Series Crimp Terminal  
Output Connector Mates with Molex Housing 09-50-1081 and Molex 5194 Series Crimp Terminal



TDK-LAMBDA EMEA

www.emea-tdk-lambda.com



**TDK-Lambda France SAS**

ZAC des Delaches  
BP 1077-Gometz-le-Chatel  
91940 Les Ulis  
France  
Tel: +33 1 60 12 71 65  
Fax: +33 1 60 12 71 66  
france@fr.tdk-lambda.com  
www.fr.tdk-lambda.com



**TDK-Lambda Italy**

Via dei Lavoratori 128/130  
20092 Cinisello Balsamo (MI)  
Italy  
Tel: +39 02 61 29 38 63  
Fax: +39 02 61 29 09 00  
info.italia@it.tdk-lambda.com  
www.it.tdk-lambda.com



**TDK-Lambda Germany GmbH**

Karl-Bold-Strasse 40  
77855 Achern  
Germany  
Tel: +49 7841 666 0  
Fax: +49 7841 5000  
info.germany@de.tdk-lambda.com  
www.de.tdk-lambda.com



**TDK-Lambda UK Ltd.**

Kingsley Avenue  
Ilfracombe  
Devon EX34 8ES  
United Kingdom  
Tel: +44 (0) 12 71 85 66 66  
Fax: +44 (0) 12 71 86 48 94  
powersolutions@uk.tdk-lambda.com  
www.uk.tdk-lambda.com



**Austria Sales Office**

Aredstrasse 22  
2544 Leobersdorf  
Austria  
Tel: +43 2256 655 84  
Fax: +43 2256 645 12  
info.germany@de.tdk-lambda.com  
www.de.tdk-lambda.com



**Nemic Lambda Ltd.**

Kibbutz Givat  
Hashlosha 48800  
Israel  
Tel: +9 723 902 4333  
Fax: +9 723 902 4777  
info@nemic.co.il  
www.nemic.co.il

LOCAL DISTRIBUTION

