

1

2

3

4

5

6

7

N x 7,62

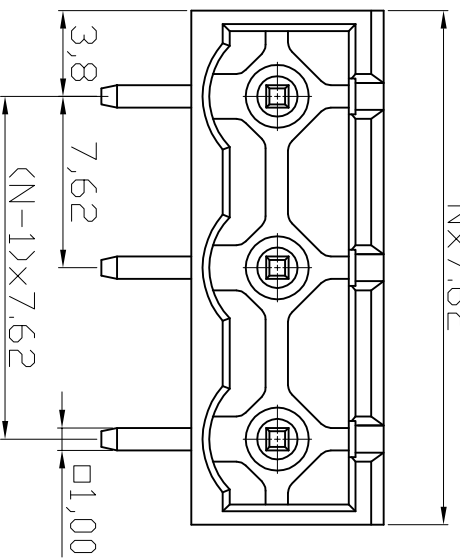

N=Number of contacts

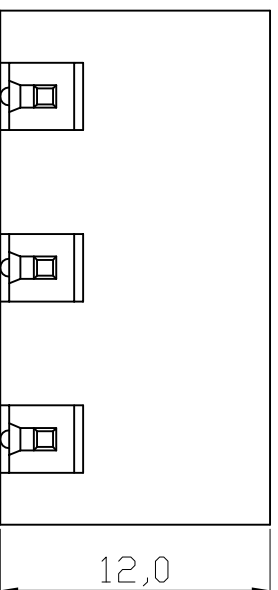

## P.C.B LAYOUT

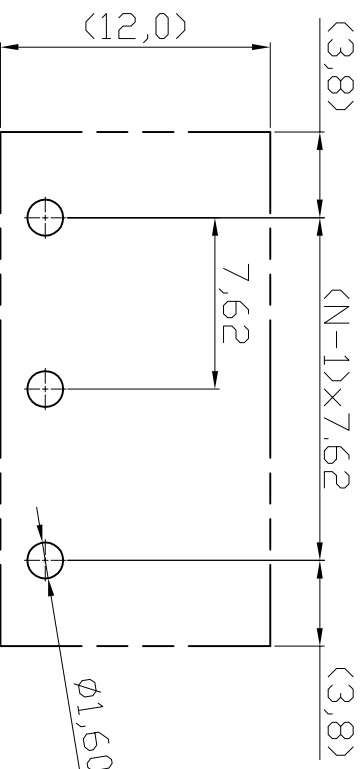

## Material

Terminal body  
(contact pin): Brass(CuZn) Tin plated  
Insulator (housing): Thermoplastic (UL94V-0)Green

## Electrical

cULus

Voltage rating: 300VAC  
Current rating: 20A  
Withstanding Voltage: 1.6KV  
Operating temperature: -30°C to +105°C  
Soldering temperature: 250°C±10°C/5 Sec  
Safety Approved: 

RoHS compliant



File No.: E349947

Scale 1:1

TOLERANCE

X. ±0.50

X.X ±0.30

X.XX ±0.10

DIM TOL

X. ° ±1°

Angle

TOL

③ Add the UL File No.

② Update

① Drawn

Modification

19.04.2016

10.12.2009

29.07.2009

Date

Winnie

Dean

Dean

Name

Customer-No.

ASSMANN WSW-No.

A-TB762-00XXCH

Drawing-No.

ASS 3600 CO

rev03

Replace

Sheet

G

E

D

C

B

A

F

H

G

E

D

C

B

A

F

H

1

2

3

4

5

6

7