

PAGE 1/2	ISSUE 1446 W	SERIES <b>BNC-HT / MHV</b>	PART NUMBER <b>R316011000</b>
----------	--------------	----------------------------	-------------------------------

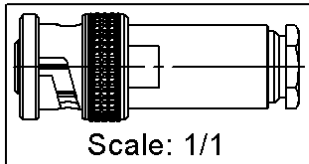

All dimensions are in mm.

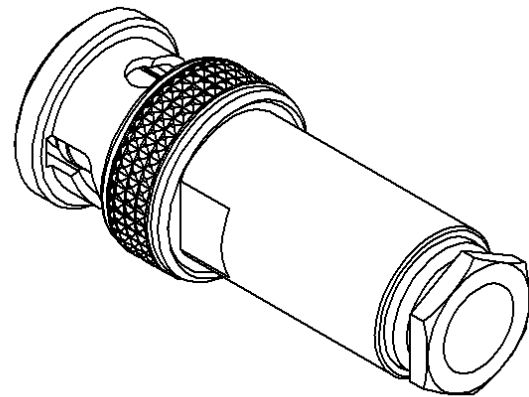
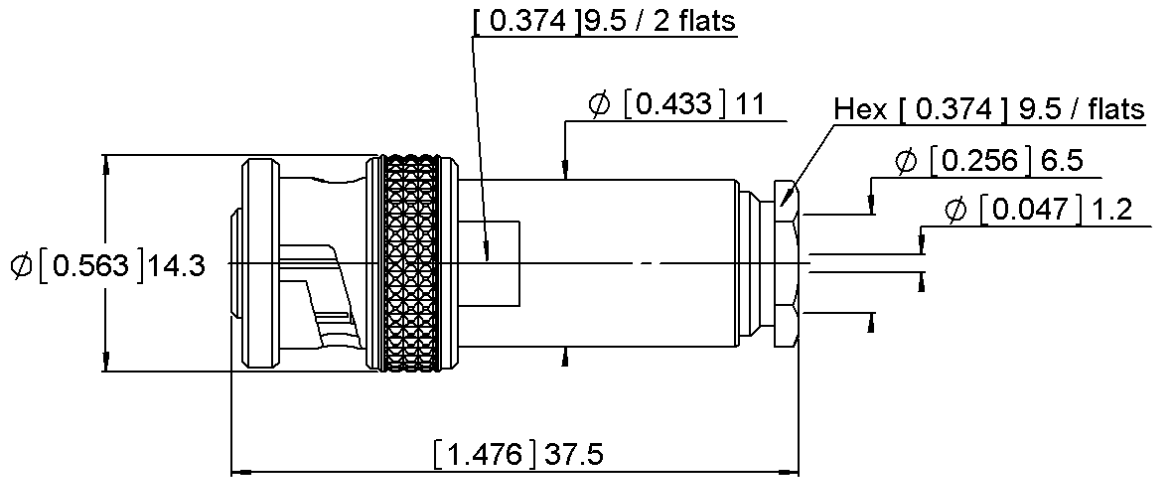
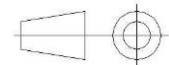

COMPONENTS	MATERIALS	PLATING (µm)
Body	<b>BRASS</b>	<b>NICKEL 2</b>
Center contact	<b>BRASS</b>	<b>SILVER</b>
Outer contact	-	-
Insulator	<b>PTFE</b>	-
Gasket	-	-
Others parts	<b>BRASS</b>	<b>NICKEL 2</b>
-	-	-
-	-	-

PAGE 2/2	ISSUE 1446 W	SERIES <b>BNC-HT / MHV</b>	<b>PART NUMBER R316011000</b>
----------	--------------	----------------------------	-------------------------------

**PACKAGING**

Standard	Unit	Other
<b>100</b>	<b>Contact us</b>	<b>Contact us</b>

**ELECTRICAL CHARACTERISTICS**

Impedance	<b>50</b>	Ω
Frequency	<b>0-2</b>	GHz
VSWR	<b>1.2 + 0.2000</b>	x F(GHz) Maxi
Insertion loss	-	√F(GHz) dB Maxi
RF leakage	-	- F(GHz) dB Maxi
Voltage rating	-	Veff Maxi
Dielectric withstanding voltage	<b>6000*</b>	Veff mini
Insulation resistance	-	MΩ mini

**MECHANICAL CHARACTERISTICS**

Center contact retention			
Axial force – Mating End	<b>NA</b>	N mini	
Axial force – Opposite end	<b>NA</b>	N mini	
Torque	-	N.cm mini	
Recommended torque			
Mating	<b>0</b>	N.cm	
Panel nut	<b>0</b>	N.cm	
Clamp nut	<b>150</b>	N.cm	
A/F clamp nut	<b>9.5000</b>	mm	
Mating life	<b>500</b>	Cycles mini	
Weight	<b>26.5600</b>	g	

**ENVIRONMENTAL**

Operating temperature	<b>-55/+155</b>	°C
Hermetic seal	-	Atm.cm3/s
Panel leakage	-	

**SPECIFICATION**

**CABLE ASSEMBLY**

Stripping	a	b	c	d	e	f
mm	<b>2.5</b>	<b>14.7</b>	<b>0</b>	<b>0</b>	<b>11.5</b>	<b>0</b>

Assembly instruction: **Clamp 03**

Recommended cable(s)

**RG 62**  
**KX 6A**

Characteristics indicated on this data sheet are those that can be achieved with the highest performance cable. Intrinsic limitations of the cable may diminish the performance of the assembly

Cable retention

- pull off	<b>181</b>	N mini
- torque	<b>NA</b>	N.cm

**TOOLING**

Part Number	Description	Hexagon
-	-	-

**OTHER CHARACTERISTICS**

**\*Test frequency at 60Hz;  
10 KVeFF for mated pair**