

MATERIALS AND FINISHES

BODY ZINC ALLOY  
PLATED NICKEL

CENTER CONTACT PHOSPHOR BRONZE  
PLATED GOLD

INSULATOR POLYPROPYLENE (UL94-V2)

HOUSING P.B.T.  
COLOR WHITE

SOLDER TAIL  
COPPER COVERED STEEL WIRE  
PLATED TIN

BOARD LOCK CLIP  
PHOSPHOR BRONZE  
PLATED TIN

BNC JACK  
INTERFACE

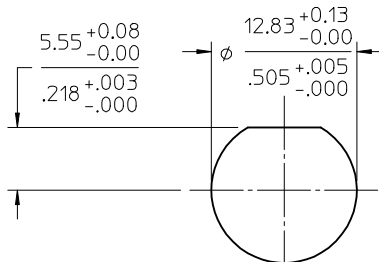
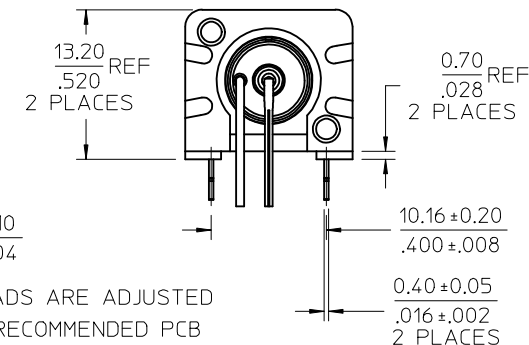
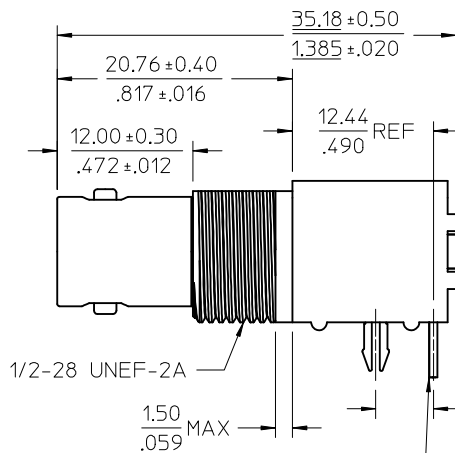
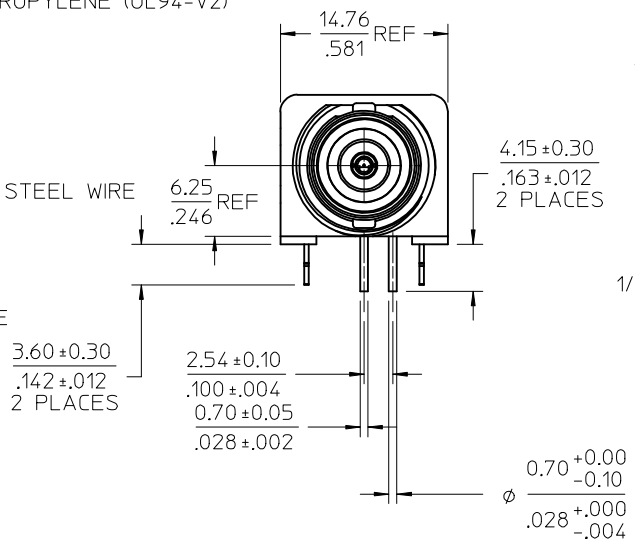
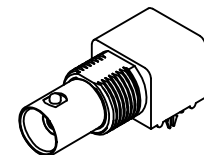
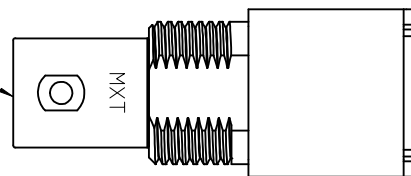

RECOMMENDED MOUNTING HOLE  
RECOMMENDED MOUNTING  
TORQUE: 0.56 N-m(5.0 IN-LBS)  
PANEL THICKNESS: 5.5(.217) MAX

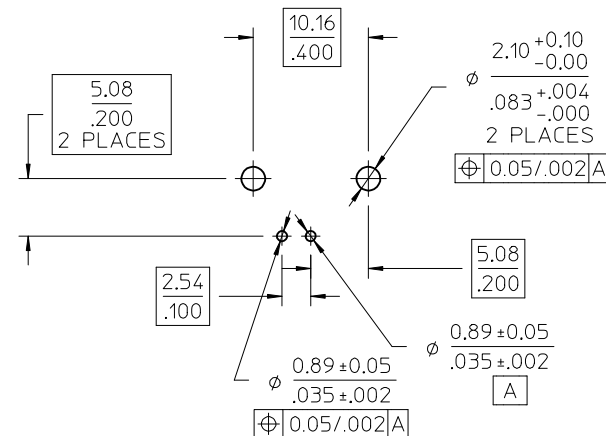

RECOMMENDED PCB LAYOUT

73171-3040	73100-0131, ONE PER BAG
73100-0131	TRAY PACK
PART NO.	PACKAGING

ES-73599-0000	INTERFACE
PS-73598-0050	ELECTRO/MECH PERFORM
SPECIFICATION	DESCRIPTION

CHG: REDREW IN SD ADDED P/N 73171-3070 EC NO: URF2007-0396 DRWIN:ELAHERTY 2007/05/01 CHKD:SSHAH 2007/05/01 APPR:JWENER 2007/05/01 REV B1	QUALITY SYMBOLS ▽=0 ▽=0	GENERAL TOLERANCES (UNLESS SPECIFIED) <table border="1"> <tr> <th></th> <th>mm</th> <th>INCH</th> </tr> <tr> <td>4 PLACES</td> <td>± .005</td> <td>± .0004</td> </tr> <tr> <td>3 PLACES</td> <td>± .003</td> <td>± .0003</td> </tr> <tr> <td>2 PLACES</td> <td>± .002</td> <td>± .0002</td> </tr> <tr> <td>1 PLACE</td> <td>± .001</td> <td>± .0001</td> </tr> <tr> <td>ANGULAR</td> <td colspan="2">± .0001°</td> </tr> </table>		mm	INCH	4 PLACES	± .005	± .0004	3 PLACES	± .003	± .0003	2 PLACES	± .002	± .0002	1 PLACE	± .001	± .0001	ANGULAR	± .0001°		DIMENSION STYLE MM/IN	SCALE DESIGN UNITS METRIC	THIRD ANGLE PROJECTION
				mm	INCH																		
4 PLACES	± .005	± .0004																					
3 PLACES	± .003	± .0003																					
2 PLACES	± .002	± .0002																					
1 PLACE	± .001	± .0001																					
ANGULAR	± .0001°																						
DRAFT WHERE APPLICABLE MUST REMAIN WITHIN DIMENSIONS	DRAWN BY KELLY	DATE 1994/01/14	TITLE BNC JACK ,R/A, PCB RECEPTACLE, 50 OHM BNC-JC	MOLEX INCORPORATED	SHEET NO. 1 OF 1																		
MATERIAL NO. SEE TABLE		DOCUMENT NO. SD-73100-0131		THIS DRAWING CONTAINS INFORMATION THAT IS PROPRIETARY TO MOLEX INCORPORATED AND SHOULD NOT BE USED WITHOUT WRITTEN PERMISSION																			