

## UW 25

Order No.: 3073364



<http://eshop.phoenixcontact.de/phoenix/treeViewClick.do?UID=3073364>

Feed-through terminal block, Connection method: Screw connection,  
Load current : 125 A, Cross-section: 6 mm<sup>2</sup> - 35 mm<sup>2</sup>, Connection  
direction of the conductor to plug-in direction: 0 °, Width: 15.1 mm,  
Color: gray

### Commercial data

GTIN (EAN)	
sales group	A420
Pack	25 pcs.
Customs tariff	85369010
Catalog page information	Page 52 (NTK-2010)

### Product notes

WEEE/RoHS-compliant since:  
02/19/2008



<http://www.download.phoenixcontact.com>  
Please note that the data given here has been taken from the online catalog. For comprehensive information and data, please refer to the user documentation. The General Terms and Conditions of Use apply to Internet downloads.

### Technical data

#### General

Number of levels	1
Number of connections	2
Color	gray

Insulating material	PA
Inflammability class acc. to UL 94	V0

**Dimensions**

Width	15.1 mm
-------	---------

**Technical data**

Maximum load current	125 A
Rated surge voltage	6 kV
Pollution degree	3
Surge voltage category	III
Insulating material group	I
Connection in acc. with standard	IEC 60947-7-1
Nominal current $I_N$	101 A
Nominal voltage $U_N$	800 V with spacer plate

**Connection data**

Conductor cross section solid min.	6 mm <sup>2</sup>
Conductor cross section solid max.	35 mm <sup>2</sup>
Conductor cross section stranded min.	10 mm <sup>2</sup>
Conductor cross section stranded max.	25 mm <sup>2</sup>
Conductor cross section AWG/kcmil min.	10
Conductor cross section AWG/kcmil max	2
Conductor cross section stranded, with ferrule without plastic sleeve min.	4 mm <sup>2</sup>
Conductor cross section stranded, with ferrule without plastic sleeve max.	25 mm <sup>2</sup>
Conductor cross section stranded, with ferrule with plastic sleeve min.	4 mm <sup>2</sup>
Conductor cross section stranded, with ferrule with plastic sleeve max.	25 mm <sup>2</sup>
2 conductors with same cross section, solid min.	2.5 mm <sup>2</sup>
2 conductors with same cross section, solid max.	10 mm <sup>2</sup>
2 conductors with same cross section, stranded min.	4 mm <sup>2</sup>
2 conductors with same cross section, stranded max.	10 mm <sup>2</sup>
2 conductors with same cross section, stranded, ferrules without plastic sleeve, min.	2.5 mm <sup>2</sup>

2 conductors with same cross section, stranded, ferrules without plastic sleeve, max.	10 mm <sup>2</sup>
2 conductors with same cross section, stranded, TWIN ferrules with plastic sleeve, min.	2.5 mm <sup>2</sup>
2 conductors with same cross section, stranded, TWIN ferrules with plastic sleeve, max.	10 mm <sup>2</sup>
Connection method	Screw connection
Stripping length	19 mm
Internal cylindrical gage	B 7
Screw thread	M5
Tightening torque, min	4 Nm
Tightening torque max	4.5 Nm

### Certificates / Approvals



Certification

UL

### Accessories

Item	Designation	Description
<b>General</b>		
3074402	DP-UW 25	Spacer plate, Color: gray
3074075	POT-UW 25	Sealing plate, Color: gray
3074541	UW 25-F	Flange cover, Color: gray

### Marking

0828295	TMT (EX9,5)R	Terminal marking with 9.5 mm strip height, continuous, without color print, for all terminals with ZB or ZBF groove, can be labeled using a thermal transfer printer, 1 roll = 50 m
0816605	TMT 100 R	Marker for terminal blocks, unperforated, unprinted, for all terminal blocks with ZB or ZBF groove, can be labeled with thermal transfer printer, 1 roll = 1000 strips, strip height: 6.4 mm, strip width 101.5 mm
0811972	ZB 15:UNBEDRUCKT	Zack marker strip, unprinted: 5-section, for individual labeling with M-PEN, ZB-T or CMS system, sufficient for 100 terminal blocks, for a terminal width of 15 mm, color: White

0811202	ZBF 15:UNBEDRUCKT	Zack strip, flat, unprinted, 5-section, divisible, for labeling by the customer
---------	-------------------	---

**Tools**

1205079	SZS 1,0X6,5 VDE	Screwdriver, bladed, VDE insulated, size: 1.0 x 6.5 x 150 mm, 2-component grip, with non-slip grip
---------	-----------------	--

**Diagrams/Drawings**

Dimensioned drawing

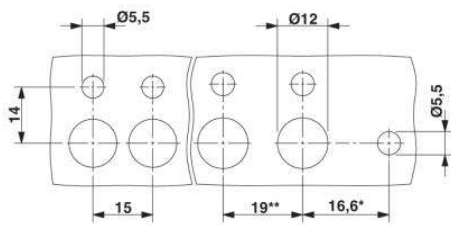

\* Only when using the **UW...□F** flange plate

\*\* Dimensions when using the **DP-UW...** spacer plate

**Address**

PHOENIX CONTACT Inc., USA  
586 Fulling Mill Road  
Middletown, PA 17057, USA  
Phone (800) 888-7388  
Fax (717) 944-1625  
<http://www.phoenixcon.com>



© 2011 Phoenix Contact  
Technical modifications reserved;