

(7.62)  
.300

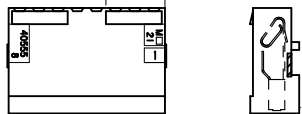

40555-AN  
FEED TO WITH RAMP

(7.62)  
.300

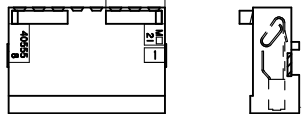

40555-BN  
FEED TO WITH RAMP  
AND POLARIZING RIBS

40555-N  
FEED TO

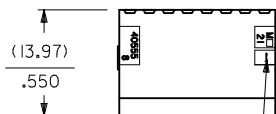
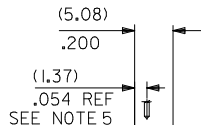

CIRCUIT 1



TERMINAL NO.  
SEE CHART

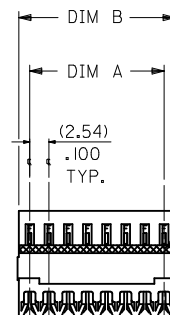

COLOR STRIPE  
SEE NOTE 6

(.13)  
.005  
MAX. STRAP REMAINING  
AFTER CUTOFF

NOTES:

- MATERIAL: HOUSING: UNFILLED NYLON UL94V-2, MOLDED NATURAL (WHITE)  
TERMINAL: SEE LEGEND
- FINISH:
  - (154) OVERALL TIN: (0.00254)/.000100 MIN. OVER NICKEL: (0.00127)/.000050 MIN.
  - (208) SELECT GOLD: (0.00038)/.000015 MIN.,  
SELECT TIN: (0.00254)/.000100 MIN.,  
OVERALL NICKEL UNDERPLATE: (0.00127)/.000050 MIN.
  - (228) SELECT GOLD: (0.00076)/.000030 MIN.,  
SELECT TIN: (0.00254)/.000100 MIN.,  
OVERALL NICKEL UNDERPLATE: (0.00127)/.000050 MIN.
  - (909) OVERALL HOT TIN DIPPED. (0.00254)/.000100 MIN.
- PRODUCT SPECIFICATION: PS-7720-001
- PACKAGING: ALL PARTS ARE TO BE BULK PACKED PER PK-40555-001 UNLESS OTHERWISE SPECIFIED IN CHART.
- FOR USE WITH (0.64)/.025 SQUARE OR ROUND PINS. INSERTION DEPTH OF (6.10/7.87)/.240/.310
- COLOR STRIPE TO RUN LENGTH OF RIB AS SHOWN.
- WIRE TERMINATION SPECIFICATION: SMES-7720-0002
- THIS PART CONFORMS TO CLASS B REQUIREMENTS OF COSMETIC SPECIFICATION PS-45499-002.

A-40555- \* N \* \*

HOUSING OPTIONS

BLANK=40555-N  
A=40555-AN  
B=40555-BN

TERMINAL OPTIONS

F = 40554-F(154), BRASS  
 H = 40627-H(154), BRASS  
 HA = 40921-H(154), BRASS HUMPBACK  
 (SEE SHEET 2)  
 HB = 40554-H(154), BRASS  
 FA = 40554-F(P909), BRASS  
 HE = 40554-H(P909), BRASS  
 HF = 41138-H(228), PHOS. BRONZE  
 A = 7691-A(154), BRASS  
 HG = 41138-H(208), PHOS. BRONZE  
 HK = 41138-H(154), PHOS. BRONZE

NO. OF CKTS

WIRE SPECIFICATIONS (INSULATION DIA. (1.47)/.058 MAX.)

TERMINAL OPTION	COLOR STRIPE	ACCEPTS WIRE:
-A(***)	BROWN	28 AWG. STRANDED TOPCOATED 28 AWG. STRANDED TINNED 28 AWG. SOLID TINNED 26 AWG. STRANDED TINNED 26 AWG. SOLID TINNED
-F(***)	NONE	24 AWG. STRANDED TOPCOATED
-H(***)	GREEN	24 AWG. STRANDED TOPCOATED 24 AWG. STRANDED TINNED 24 AWG. SOLID TINNED 26 AWG. STRANDED TOPCOATED

REV.	SH.	REV.	DESCRIPTION
8	BK2		
7	BK2		
6	BK2		
3	BK2		
5	BK2		
4	BL		
3	BL		
2	BL		
1	BL		

OBsolete P/Ns  
 EC NO: UCP2011-1314  
 DRWN:KIPPER 2011/01/04  
 CHKD:JBELL  
 APPR:FSM/TH 2011/03/09

QUALITY SYMBOLS  
 ▽=0  
 ▽=0  
 ▽=0

GENERAL TOLERANCES (UNLESS SPECIFIED)

	mm	INCH
4 PLACES	± ---	± ---
3 PLACES	± ---	± ---
2 PLACES	± ---	± ---
1 PLACE	± ---	± ---

ANGULAR ±1/2°

DRAFT WHERE APPLICABLE  
MUST REMAIN  
WITHIN DIMENSIONS

DIMENSION STYLE  
MM/IN

SCALE  
---

DESIGN UNITS  
INCH

THIRD ANGLE PROJECTION

DRAWN BY  
R/JG

CHECKED BY  
EDGLEJ

APPROVED BY  
LENZ

DATE  
1985/09/16

DATE  
1985/09/16

DATE  
1985/09/16

MATERIAL NO.  
SEE CHART

DOCUMENT NO.  
SDA-40555-\*N\*

SHEET NO.  
1 OF 8

INSULATION DISPLACEMENT  
CONNECTOR ASSEMBLY  
(2.54)/.100 CENTERS

MOLEX INCORPORATED

THIS DRAWING CONTAINS INFORMATION THAT IS PROPRIETARY TO MOLEX  
INCORPORATED AND SHOULD NOT BE USED WITHOUT WRITTEN PERMISSION

NO OF CKTS	DIM A	DIM B
2	(2.54 ) .100	(5.44 ) .214
3	(5.08 ) .200	(7.98 ) .314
4	(7.62 ) .300	(10.52) .414
5	(10.16) .400	(13.06) .514
6	(12.70) .500	(15.60) .614
7	(15.24) .600	(18.14) .714
8	(17.78) .700	(20.68) .814
9	(20.30) .800	(23.22) .914
10	(22.86) .900	(25.76) 1.014
11	(25.40) 1.000	(28.30) 1.114
12	(27.94) 1.100	(30.84) 1.214
13	(30.48) 1.200	(33.38) 1.314
14	(33.02) 1.300	(35.92) 1.414
15	(35.56) 1.400	(38.46) 1.514
16	(38.10) 1.500	(41.00) 1.614
17	(40.64) 1.600	(43.54) 1.714
18	(43.18) 1.700	(46.08) 1.814
19	(45.72) 1.800	(48.62) 1.914
20	(48.26) 1.900	(51.16) 2.014
21	(50.80) 2.000	(53.70) 2.114
22	(53.34) 2.100	(56.24) 2.214
23	(55.88) 2.200	(58.78) 2.314
24	(58.42) 2.300	(61.32) 2.414
25	(60.96) 2.400	(63.86) 2.514
26	(63.50) 2.500	(66.40) 2.614
27	(66.04) 2.600	(68.94) 2.714
28	(68.58) 2.700	(71.48) 2.814

	13	12	11	10	9	8	7	6	5	4	3	2	1
J	ENG. NO.	HOUSING NO	TERMINAL NO.	COLOR ID	EDP ON SHT./COL.								
	A-40555-NF	40555-N	40554-F(154)	NONE	5 / 1								
	A-40555-ANF	40555-AN	40554-F(154)	NONE	5 / 2								
	A-40555-BNF	40555-BN	40554-F(154)	NONE	5 / 3								
					/								
					/								
I	A-40555-NH	40555-N	40627-H(154)	GREEN	5 / 7								
	A-40555-ANH	40555-AN	40627-H(154)	GREEN	5 / 8								
	A-40555-BNH	40555-BN	40627-H(154)	GREEN	5 / 9								
					/								
					/								
H	A-40555-NHA	40555-N	40921-H(154)	GREEN	6 / 1								
	A-40555-ANHA	40555-AN	40921-H(154)	GREEN	6 / 2								
	A-40555-BNHA	40555-BN	40921-H(154)	GREEN	6 / 3								
					/								
					/								
G	A-40555-NFA	40555-N	40554-F(P909)	NONE	6 / 7								
	A-40555-ANFA	40555-AN	40554-F(P909)	NONE	6 / 8								
	A-40555-BNFA	40555-BN	40554-F(P909)	NONE	6 / 9								
					/								
					/								
F	A-40555-NHF	40555-N	41138-H(228)	GREEN	7 / 1								
	A-40555-ANHF	40555-AN	41138-H(228)	GREEN	7 / 2								
	A-40555-BNHF	40555-BN	41138-H(228)	GREEN	7 / 3								
					/								
					/								
E	A-40555-NA	40555-N	7691-A(154)	BROWN	7 / 1								
	A-40555-ANA	40555-AN	7691-A(154)	BROWN	7 / 2								
	A-40555-BNA	40555-BN	7691-A(154)	BROWN	7 / 3								
					/								
					/								
	A-40555-NHG	40555-N	41138-H(208)	GREEN	8 / 1								
	A-40555-ANHG	40555-AN	41138-H(208)	GREEN	8 / 2								
	A-40555-BNHG	40555-BN	41138-H(208)	GREEN	8 / 3								
					/								
					/								
B	A-40555-NHK	40555-N	41138-H(154)	GREEN	8 / 5								
	A-40555-ANHK	40555-AN	41138-H(154)	GREEN	8 / 6								
	A-40555-BNHK	40555-BN	41138-H(154)	GREEN	8 / 7								

<b>SEE SHEET 1</b> EC NO: UCP2011-1314 DRAWN:KIPPER 2011/01/04 CHKD:JBELL APPR:FSMITH 2011/03/09	QUALITY SYMBOLS 	GENERAL TOLERANCES (UNLESS SPECIFIED)		DIMENSION STYLE <b>MM/IN</b>		SCALE ---	DESIGN UNITS <b>INCH</b>	THIRD ANGLE PROJECTION			
		4 PLACES ± --- ± ---	3 PLACES ± --- ± ---	2 PLACES ± --- ± ---	1 PLACE ± --- ± ---	DRAWN BY SAMI EC	DATE 1991/10/29	TITLE <b>INSULATION DISPLACEMENT CONNECTOR ASSEMBLY .100 CENTERS</b>			
		ANGULAR ±1/2°				CHECKED BY EDGLEY	DATE 1991/10/29	APPROVED BY LENZ 1991/10/29			
		DRAFT WHERE APPLICABLE MUST REMAIN WITHIN DIMENSIONS				SEE CHART		MATERIAL NO. SDA-40555-*N*		SHEET NO. 4 OF 8	

THIS DRAWING CONTAINS INFORMATION THAT IS PROPRIETARY TO MOLEX INCORPORATED AND SHOULD NOT BE USED WITHOUT WRITTEN PERMISSION

	13	12	11	10	9	8	7	6	5	4	3	2	1	
	A-40555-NF		A-40555-ANF		A-40555-BNF						A-40555-NH			
J	PART NO.	ENG. NO.	PART NO.	ENG. NO.	PART NO.	ENG. NO.	PART NO.	ENG. NO.	PART NO.	ENG. NO.	PART NO.	ENG. NO.	PART NO.	ENG. NO.
	22-41-8021	A-40555-2F	OBSELETE	A-40555-A2F	22-41-8022	A-40555-B2F							22-41-8025	A-40555-2H
	22-41-8031	A-40555-3F		A-40555-A3F	OBSELETE	A-40555-B3F							22-41-8035	A-40555-3H
	22-41-8041	A-40555-4F		A-40555-A4F	OBSELETE	A-40555-B4F							22-41-8045	A-40555-4H
	22-41-8051	A-40555-5F		A-40555-A5F	OBSELETE	A-40555-B5F							22-41-8055	A-40555-5H
	22-41-8061	A-40555-6F		A-40555-A6F	OBSELETE	A-40555-B6F							22-41-8065	A-40555-6H
I	22-41-8071	A-40555-7F		A-40555-A7F	22-41-8072	A-40555-B7F							22-41-8075	A-40555-7H
	22-41-8081	A-40555-8F		A-40555-A8F	22-41-8082	A-40555-B8F							22-41-8085	A-40555-8H
	22-41-8091	A-40555-9F		A-40555-A9F	22-41-8092	A-40555-B9F							22-41-8095	A-40555-9H
	22-41-8101	A-40555-10F		A-40555-A10F	OBSELETE	A-40555-B10F							22-41-8105	A-40555-10H
	22-41-8111	A-40555-11F		A-40555-A11F	OBSELETE	A-40555-B11F							22-41-8115	A-40555-11H
	22-41-8121	A-40555-12F		A-40555-A12F	22-41-8122	A-40555-B12F							22-41-8125	A-40555-12H
		A-40555-13F		A-40555-A13F	22-41-8132	A-40555-B13F							22-41-8135	A-40555-13H
H		A-40555-14F		A-40555-A14F	22-41-8142	A-40555-B14F							22-41-8145	A-40555-14H
	OBSELETE	A-40555-15F		A-40555-A15F	OBSELETE	A-40555-B15F							OBSELETE	A-40555-15H
		A-40555-16F		A-40555-A16F	22-41-8162	A-40555-B16F							22-41-8165	A-40555-16H
		A-40555-17F		A-40555-A17F		A-40555-B17F							22-41-8175	A-40555-17H
		A-40555-18F		A-40555-A18F		A-40555-B18F							22-41-8185	A-40555-18H
		A-40555-19F		A-40555-A19F		A-40555-B19F							22-41-8195	A-40555-19H
		A-40555-20F		A-40555-A20F		A-40555-B20F							22-41-8205	A-40555-20H
G		A-40555-21F		A-40555-A21F		A-40555-B21F							22-41-8215	A-40555-21H
		A-40555-22F		A-40555-A22F		A-40555-B22F							22-41-8225	A-40555-22H
		A-40555-23F		A-40555-A23F		A-40555-B23F							22-41-8235	A-40555-23H
		A-40555-24F		A-40555-A24F		A-40555-B24F							22-41-8245	A-40555-24H
		A-40555-25F		A-40555-A25F		A-40555-B25F							22-41-8255	A-40555-25H
		A-40555-26F		A-40555-A26F		A-40555-B26F							22-41-8265	A-40555-26H
F		A-40555-27F		A-40555-A27F		A-40555-B27F							22-41-8275	A-40555-27H
		A-40555-28F		A-40555-A28F		A-40555-B28F							22-41-8285	A-40555-28H

	A-40555-ANH		A-40555-BNH			
	PART NO.	ENG. NO.	PART NO.	ENG. NO.	PART NO.	ENG. NO.
E	OBSELETE	A-40555-A2H		A-40555-B2H		
	22-41-8039	A-40555-A3H	OBSELETE	A-40555-B3H		
	22-41-8049	A-40555-A4H	OBSELETE	A-40555-B4H		
	22-41-8059	A-40555-A5H	OBSELETE	A-40555-B5H		
	22-41-8069	A-40555-A6H	OBSELETE	A-40555-B6H		
D	22-41-8079	A-40555-A7H		A-40555-B7H		
	22-41-8089	A-40555-A8H		A-40555-B8H		
	22-41-8099	A-40555-A9H		A-40555-B9H		
	22-41-8109	A-40555-A10H	OBSELETE	A-40555-B10H		
	22-41-8119	A-40555-A11H	OBSELETE	A-40555-B11H		
	22-41-8129	A-40555-A12H		A-40555-B12H		
		A-40555-A13H		A-40555-B13H		
C	22-41-8149	A-40555-A14H		A-40555-B14H		
		A-40555-A15H	OBSELETE	A-40555-B15H		
		A-40555-A16H		A-40555-B16H		
		A-40555-A17H		A-40555-B17H		
		A-40555-A18H		A-40555-B18H		
		A-40555-A19H		A-40555-B19H		
		A-40555-A20H		A-40555-B20H		
B		A-40555-A21H		A-40555-B21H		
	22-41-8229	A-40555-A22H		A-40555-B22H		
		A-40555-A23H		A-40555-B23H		
		A-40555-A24H		A-40555-B24H		
		A-40555-A25H		A-40555-B25H		
		A-40555-A26H		A-40555-B26H		
		A-40555-A27H		A-40555-B27H		
A		A-40555-A28H		A-40555-B28H		

<b>SEE SHEET 1</b> EC NO: UCP2010-0587 DRAWN:TBENES 2009/10/23 CHKD:MKIPPER 2009/11/11 APPR:FSMLTH 2009/11/11	QUALITY SYMBOLS ▽=0 ▽=0 ▽=0	GENERAL TOLERANCES (UNLESS SPECIFIED)		DIMENSION STYLE <b>MM/IN</b>		SCALE ---	DESIGN UNITS <b>INCH</b>	THIRD ANGLE PROJECTION	
		4 PLACES ± --- INCH 3 PLACES ± --- INCH 2 PLACES ± --- INCH 1 PLACE ± --- INCH		DRAWN BY DATE SAMIEC 1991/10/30		TITLE <b>INSULATION DISPLACEMENT CONNECTOR ASSEMBLY .100 CENTERS</b>			
		ANGULAR ±1/2°		CHECKED BY DATE EDGLEY 1991/10/30		MOLEX MOLEX INCORPORATED			
		DRAFT WHERE APPLICABLE MUST REMAIN WITHIN DIMENSIONS		APPROVED BY DATE LENZ 1991/10/30		MATERIAL NO. <b>SEE CHART</b>		DOCUMENT NO. <b>SDA-40555-*N*</b>	