

LOADING PATTERN MATING SIDE

f	0	0	0	0	0	0	0	0	0	0
e	4	4	4	4	4	4	6	4	4	4
d	4	4	4	4	4	4	5	4	4	4
c	4	4	5	4	4	4	4	4	4	4
b	6	4	6	4	4	4	4	4	4	4
a	4	4	4	4	4	4	4	4	4	4
z	0	0	0	0	0	0	0	0	0	0
POS	0	1	0	5	0	1	0			

LOADED CONNECTOR ASSEMBLY (FOR EXAMPLE)

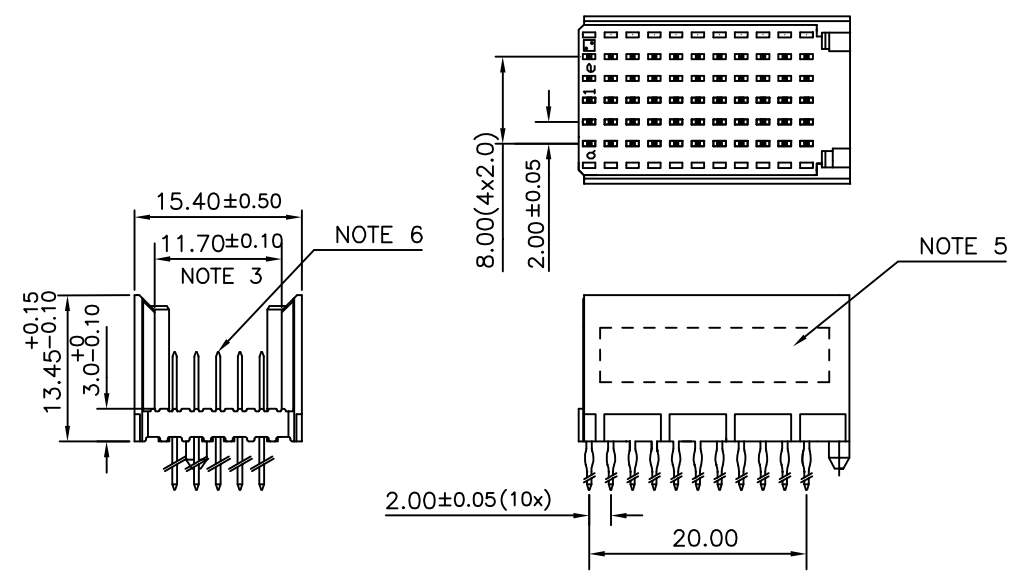

CONTACT OVERVIEW

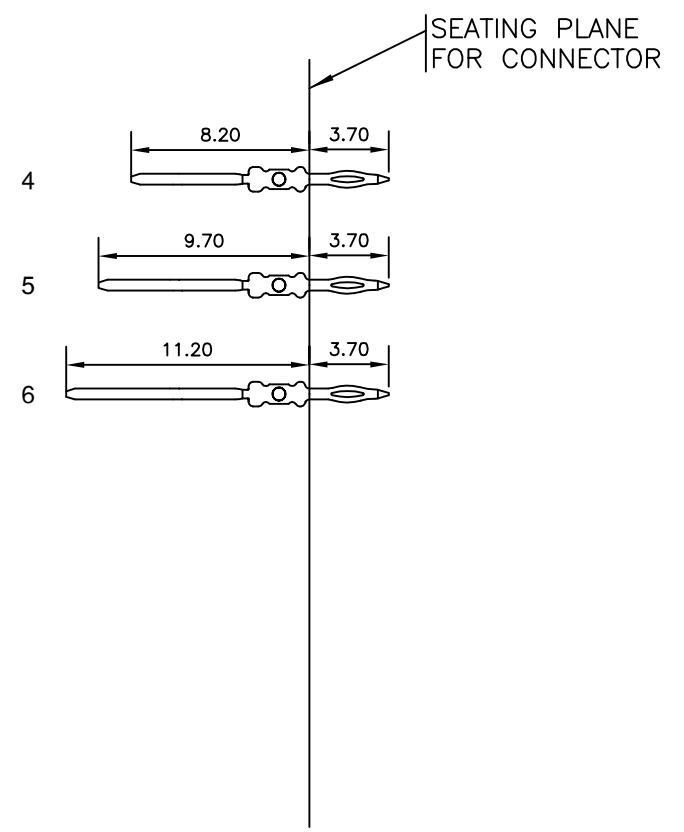

LAY-OUT P.C.B.-HOLE

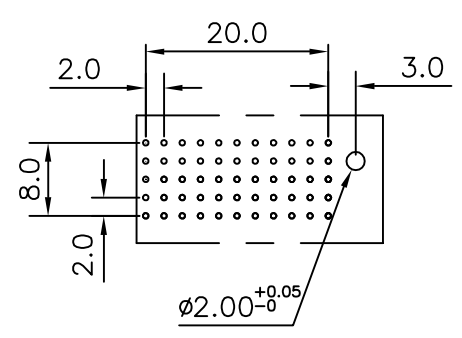

HM2P09PDF3J0 LEAD FREE INDICATOR : LF = LEAD FREE (DIGIT 15 & 16)
PLATING CODE (DIGIT 13 AND 14)
(REF DRW NO. BS,C , 201844 , 003)

NOTES

- THIS PRODUCT IS CSA APPROVED.
 - THIS PRODUCT IS UL RECOGNIZED.
 - MEASURED AT THE BOTTOM.
 - MATERIAL CONTACT: PHOSPHORBRONZE
HOUSING: CREAM WHITE GLASS FILLED POLYESTER UL-94V0
 - CONNECTOR PRINTED WITH P/N AND DATE CODE.
 - FOR ACTUAL CONTACT LOADINGS, SEE LOADING PATTERN MATING SIDE.
 - SHAPE OF CONNECTOR HOUSING CAN ALTER DEPENDING ON PRODUCTION LOCATION
 - THE PRODUCT (LF) MEETS EUROPEAN UNION DIRECTIVES AND OTHER COUNTRY REGULATIONS AS DESCRIBED IN GS-22-008
 - FOR RECOMMENDED PTH DIMENSIONS REFER DRAWING : BS, A , 201572 , 001
- CATALOG NO: HM2P09PDF3J0- - -

mat'l. code SEE NOTE 4				surface ISO 1302 ✓	tolerance ISO 406 ISO 1101	projection 	product family MLLIPACS
ltr	ecn no	dr	date	tolerances unless otherwise specified		MM	title MPACS 5+2R STR HDR PF CONN TYPE C
A	I04-0103	MINI	2004/ 11/ 13	angles	linear		
B	I05-0190	MINI	2005/ 10/ 14	0°±1°			
C	I06-0090	MINI	2006/ 06/ 29			scale -	
				dr	MINI K VANDANATH	2004/ 11/ 13	dwg no sheet 1 of 1 size BS, C ,203028, 180 A3 type Product Customer Drawing
				engr	BIJU K PAUL	2004/ 11/ 13	
				chr	BIJU K PAUL	2006/ 06/ 29	
				appd	BIJU K PAUL	2006/ 06/ 29	
sheet index	revision sheet	c					

FCI
 FCconnect.com
 Copyright FCI