

ITEM	PART#	DESCRIPTION	QTY	UOM
A	5601230200	DuraClik ISL housing 2p	1	PC
B	5601250200	DURACLIK ISL RETAINER 2P	1	PC
C	5601240101	DURACLIK ISL crimp receptacle terminal	2	PC
D	--	PAPER PRINTED PAPER WHITE	1	PC

FROM	TO	DESCRIPTION	COLOR
A1	--	1X0.35 SQMM PVC BARE CU BK FLRY-A	BLACK
A2	--	1X0.35 SQMM PVC BARE CU BK FLRY-A	BLACK

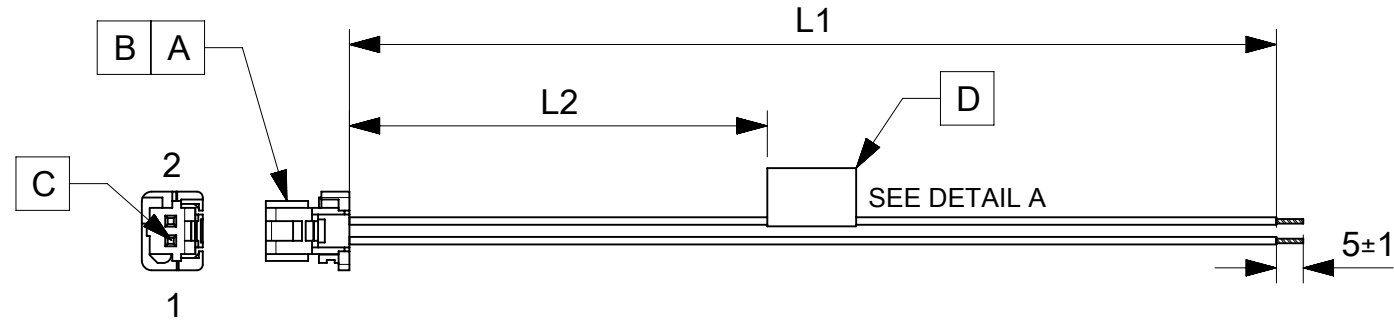

TABLE			
PART NUMBER	L1	L2 (REF)	TITLE
2183231021	150±8	63	DURA-CLIK ISL R-S 2CKT 150MM DISC Sn
2183231022	300±10	138	DURA-CLIK ISL R-S 2CKT 300MM DISC Sn
2183231023	600±10	288	DURA-CLIK ISL R-S 2CKT 600MM DISC Sn

**NOTES**

- Free ends must be stripped, twisted & tinned. The length of tinning is 5±1mm. Tinning dia must be 1mm Max.
- Connector view shown is from mating side.
- Label text must be 2mm max. in height with Arial font.
- Label must be wrapped in Flag type on a single cable.

MOLEX P/N  
MOLEX  
BATCH WK/YR  
DETAIL A

REVISION			
DATE	REV	DESCRIPTION	CHANGER
24/05/2021	A	INITIAL RELEASE	ARAJU

FUNCTIONAL SYMBOLS $\frac{F}{A} = 0$ $\frac{F}{E} = 0$ $\frac{F}{P} = 0$ DIVISIONAL SYMBOLS	THIS DRAWING CONTAINS INFORMATION THAT IS PROPRIETARY TO MOLEX ELECTRONIC TECHNOLOGIES, LLC AND SHOULD NOT BE USED WITHOUT WRITTEN PERMISSION		CURRENT REV DESC:				
	DIMENSION UNITS	SCALE	GENERAL TOLERANCES (UNLESS SPECIFIED)				
	mm	NTS	ANGULAR TOL ± °				
	4 PLACES ±		3 PLACES ±				
3 PLACES ±		2 PLACES ±		EC NO: 665457	2021/05/22		
2 PLACES ±		1 PLACE ±		DRWN: ARAJU		2021/05/28	
1 PLACE ±		0 PLACES ±		CHK'D: RDESAI01	2021/05/28		
DRAFT WHERE APPLICABLE MUST REMAIN WITHIN DIMENSIONS		THIRD ANGLE PROJECTION	DRAWING	SERIES	MATERIAL NUMBER	CUSTOMER	SHEET NUMBER
			A4-SIZE	218323	2183231021	GENERAL MARKET	1 OF 1