



1 Watt RF Load Up to 18 GHz with Mini SMP Female Push-On

RF Terminations Technical Data Sheet

PE6TR1117

Features

- 50 Ohm RF Load
- DC to 18 GHz Frequency Range
- VSWR 1.15:1 Max
- Max Power 1 Watt (CW)
- Mini SMP Female Coaxial Interface

Applications

- Wireless
- SatCom
- Radar Systems
- Test and Measurement
- Commercial and Military Communication

Description

RF termination (also called RF load or dummy load) PE6TR1117 from Pasternack operates from DC to 18 GHz and handles up to 1 Watt (CW). This Mini SMP termination (or load) is a 50 Ohm impedance and has a Female gender. PE6TR1117 50 Ohm Mini SMP load termination offers 1.15:1 max VSWR. RF terminations / loads are critical passive components in many RF, microwave and millimeter wave systems where signal reflection from unused ports can reduce the signal integrity and potentially damage the device. By terminating an unused port with a matched load (dummy load), the incident energy will be absorbed with minimal reflection. These radio frequency termination components are commonly used to terminate devices such as couplers, circulators, and switches. Loads / terminations are also widely used in measurement systems to ensure accurate results. Pasternack offers a large selection of in-stock RF, microwave and millimeter wave terminations up to 65 GHz with great performance over the entire operating range and with power handling capabilities up to 800 Watts (CW).

Electrical Specifications

| Description | Minimum | Typical | Maximum | Units |
|------------------|---------|---------|---------|-------|
| Frequency Range | DC | | 18 | GHz |
| Impedance | | 50 | | Ohms |
| VSWR | | | 1.15:1 | |
| Input Power (CW) | | | 1 | Watt |

Mechanical Specifications

Size

Length 0.38 in [9.65 mm]
Width 0.24 in [6.1 mm]

Configuration

Connector Push-On Mini SMP Female
Durability 100 Cycles

Click the following link (or enter part number in "SEARCH" on website) to obtain additional part information including price, inventory and certifications: [1 Watt RF Load Up to 18 GHz with Mini SMP Female Push-On PE6TR1117](#)



1 Watt RF Load Up to 18 GHz with Mini SMP Female Push-On

RF Terminations Technical Data Sheet

PE6TR1117

Material Specifications

| Description | Material | Plating |
|---------------------|------------------|---------|
| Connector 1 Contact | Beryllium Copper | Gold |
| Outer Conductor | Beryllium Copper | Gold |
| Body | Beryllium Copper | Gold |

Mechanical Specification Notes:
Interface: MIL-STD-348B

Environmental Specifications

Temperature

Operating Range

-40 to +105 deg C

Humidity

MIL-STD-202, Method 106

Thermal Shock

MIL-STD-202, Method 107, Condition B

Salt Spray

MIL-STD-202, Method 101, Condition B

Compliance Certifications (see [product page](#) for current document)

Plotted and Other Data

Notes:

1 Watt RF Load Up to 18 GHz with Mini SMP Female Push-On from Pasternack Enterprises has same day shipment for domestic and International orders. Our RF, microwave and millimeter wave products maintain a 99.4% availability and are part of the broadest selection in the industry.

Click the following link (or enter part number in "SEARCH" on website) to obtain additional part information including price, inventory and certifications: [1 Watt RF Load Up to 18 GHz with Mini SMP Female Push-On PE6TR1117](#)

URL: <https://www.pasternack.com/1-watts-mini-smp-female-rf-load-18-ghz-pe6tr1117-p.aspx>

The information contained in this document is accurate to the best of our knowledge and representative of the part described herein. It may be necessary to make modifications to the part and/or the documentation of the part, in order to implement improvements. Pasternack reserves the right to make such changes as required. Unless otherwise stated, all specifications are nominal. Pasternack does not make any representation or warranty regarding the suitability of the part described herein for any particular purpose, and Pasternack does not assume any liability arising out of the use of any part or documentation.

PE6TR1117 CAD Drawing

1 Watt RF Load Up to 18 GHz with Mini SMP Female Push-On

| REVISIONS | | | |
|-----------|-----------------|------------|----------|
| REV. | DESCRIPTION | DATE | APPROVED |
| A | INITIAL RELEASE | 01/06/2021 | SPONG |

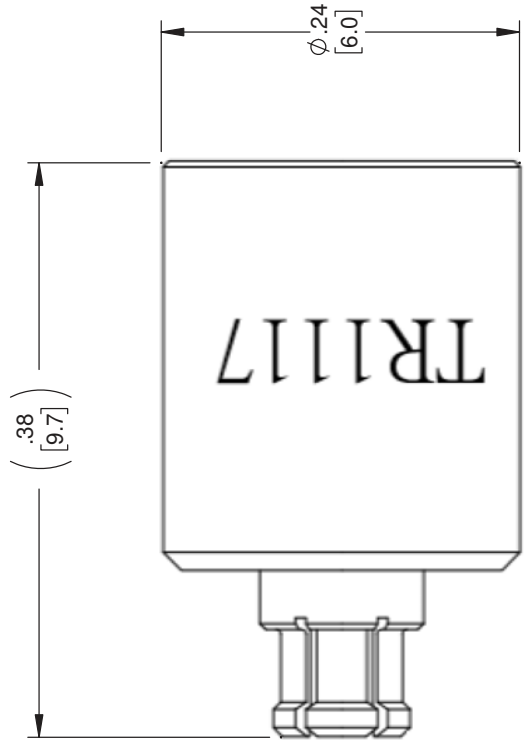

| | | |
|---|--|--|
| <p>UNLESS OTHERWISE SPECIFIED LEADING DIMENSIONS ARE IN INCHES DIMENSIONS IN [] ARE MILLIMETERS</p> <p>TOLERANCES:</p> <p>X = +.2 [5.08] FRACTIONS XX = +.02 [.51] +.132 .XXX = ±.005 [.13] ANGLES ± 1°</p> <p>CABLE LENGTH (L) TOLERANCES:</p> <p>L ≤ 12 [305] = +.1 [25] / -0 12 [305] < L ≤ 60 [1524] = +.2 [51] / -0 60 [1524] < L ≤ 120 [3048] = +.4 [102] / -0 120 [3048] < L ≤ 300 [7620] = +.6 [152] / -0 300 [7620] < L = +5% / -0</p> <p>ALL DIMENSIONS SHOWN ARE FOR REFERENCE ONLY.</p> | <p>PE PASTERNAK an INFINITI® brand</p> <p>Pasternack Enterprises, Inc. P. O. Box 16759, Irvine, CA 92623. Phone: 1.949.261.1920 1.866.727.8376 Fax: 1.949.261.7451 Website: www.pasternack.com E-mail: sales@pasternack.com</p> | <p>THIRD-ANGLE PROJECTION</p> <p>THE INFORMATION AND DESIGN IN THIS DOCUMENT IS THE PROPERTY OF PASTERNAK CORPORATION. ALL RIGHTS RESERVED.</p> <p>SHEET 1 OF 1</p> <p>SCALE N/A</p> |
| | | <p>SIZE A</p> <p>CAGE CODE 53919</p> <p>DRAWN BY DFRISIELLO</p> <p>ITEM NO. PE6TR1117</p> <p>REV A</p> |

THESE COMMODITIES, TECHNOLOGY OR SOFTWARE WERE EXPORTED FROM THE UNITED STATES IN ACCORDANCE WITH THE EXPORT ADMINISTRATION REGULATIONS. DIVERSION CONTRARY TO U.S. LAW PROHIBITED.