

PRODUCT NO.	PACKAGING
10100774-001LF	TUBE

50.800±0.127
(20 POSITIONS X 2.540)
48.260±0.127

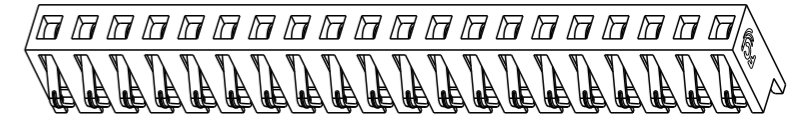

SCALE 2.000

1.270 REF.

8.480 REF.

0.380 REF.

3.810 REF.
1.140

45.720 REF.

48.260 REF.

SEE NOTE 4

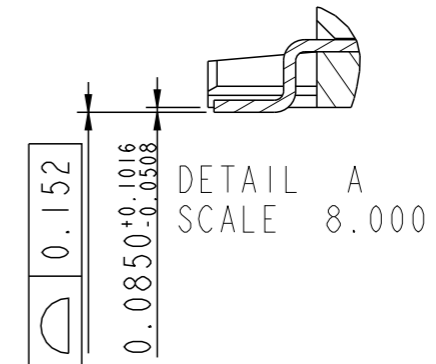

DETAIL A
SCALE 8.000

0.152
0.0850^{+0.0016}/_{-0.0008}

0.80 (NOMINAL COMPRESSION)
1.00 (FULLY COMPRESSION)

SEE DETAIL A

1.100 REF.

1.800±0.076

4.450 REF.

1.4200 REF.

5.150

SECTION A-A

NOTES:

- MATERIAL:
HOUSING: HIGH TEMPERATURE THERMOPLASTIC, UL94V-0, BLACK
TERMINAL & CLIP: COPPER ALLOY
- PLATING:
TERMINAL: 0.76um MIN. Au ON CONTACT AREA, 2.54um MIN. Sn(100% MATTE TIN) ON SOLDER TAILS,
1.27um MIN. Ni UNDERPLATE OVERALL
CLIP: 2.54um MIN. Sn(100% MATTE TIN) OVER 1.27um MIN. Ni UNDERPLATE OVERALL
- NORMAL FORCE PER EACH TERMINAL SHOULD BE 50gf MIN. ~ 200gf MAX. AT NOMINAL COMPRESSION HEIGHT AT 25±6mm/min COMPRESSION SPEED
- VENDOR ID TO BE ON AREA INDICATED
- PRODUCT SPECIFICATION: GS-12-626
- THIS PRODUCT MEETS EUROPEAN UNION DIRECTIVES AND OTHER COUNTRY REGULATIONS AS DESCRIBED IN GS-22-008
- THE HOUSING WILL WITHSTAND EXPOSURE TO 260°C PEAK TEMPERATURE FOR 10 SECONDS IN A CONVECTION, INFRA-RED OR VAPOR PHASE REFLOW OVEN

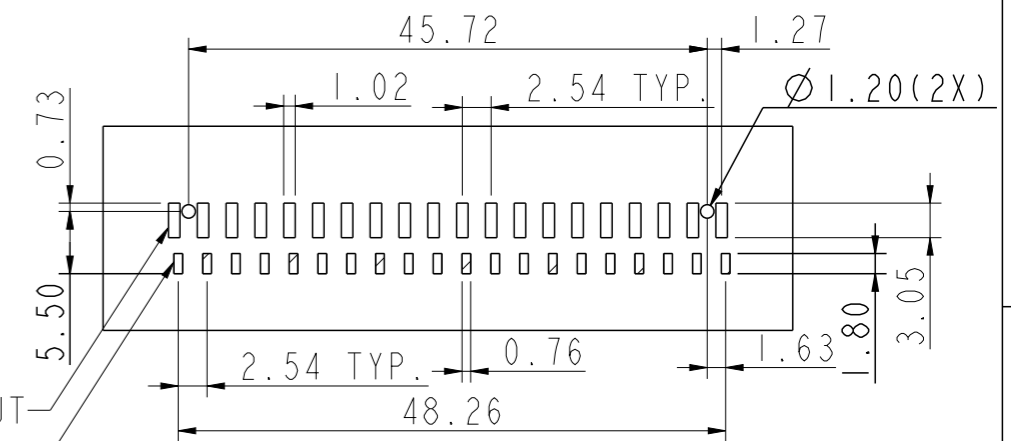

CONTACT PAD LAYOUT
SOLDER PAD LAYOUT

SCALE 1.500

RECOMMENDED SOLDER AND CONTACT PAD LAYOUT

spec ref	-	dr	Jeffrey Lim	2011/09/16	projection	mm	size	A3	scale	4.000
tolerance std	ISO 406 ISO 1101	eng	Jeffrey Lim	2011/10/11			ecn no	-	rel level	Released
surface	ISO 1302	chr	-	2011/10/12						
	linear	0.X	±0.35		title	dwg no	10100774	rev	A	www.fci.com
		0.XX	±0.30							
	angular	0°	±2°							
		cat. no.	Product - Customer Drw		sheet 1 of 1					