

PRODUCT NO.
10152065-X0XXXX

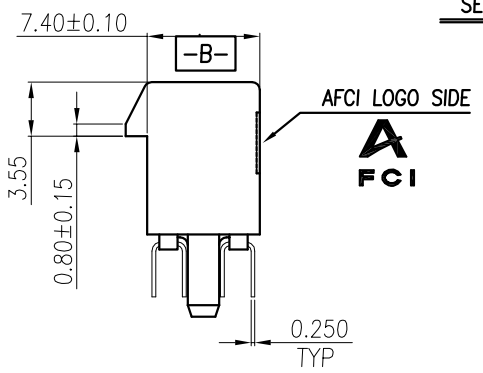
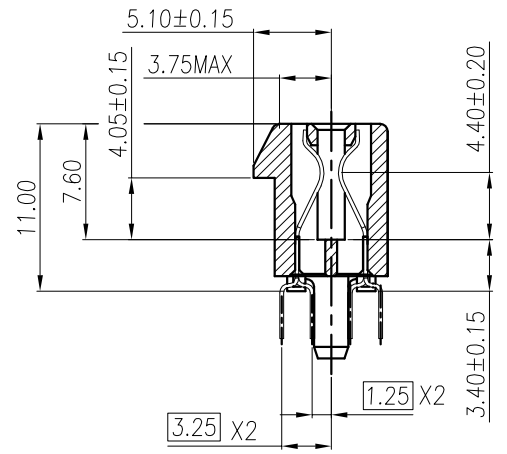
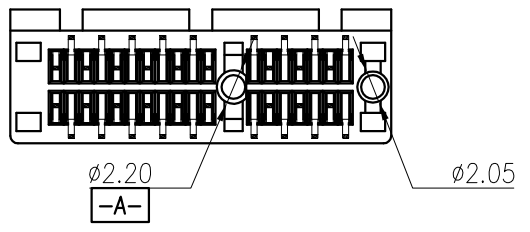
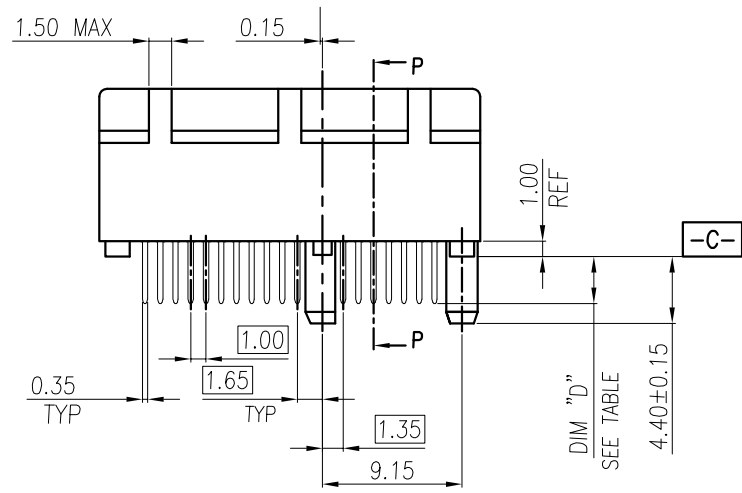
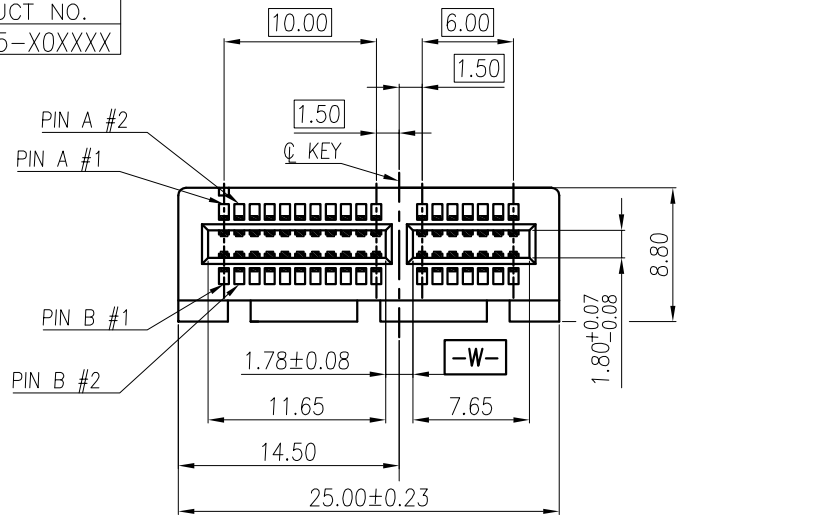

TWIN PLASTIC PEG TYPE

mat'l. code		-		surface		- ✓		tolerance		ASME_Y14.5		projection		product family		PCI_EXPRESS	
ltr		ecn no		dr		date		tolerances unless otherwise specified		MM		title		PCI_EXPRESS_CARD_EDGE_GEN3		5	
								angles		Linear		scale N/A		dwg no		sheet 1 of 6 size	
								±2'		.02±0.30		Amphenol FCI		10152065		A4	
				dr		WINSTON_ZHU		2020-06-09		.00±0.20				type		CUSTOMER Drawing	
				enr		ZHENHUA_LIU		2020-06-09		.000±0.10							
				chr													
				appd		HEAVEN_CEN		2020-06-09									
sheet index		revision sheet		A													

PRODUCT NO.
10152065-X2XXXX

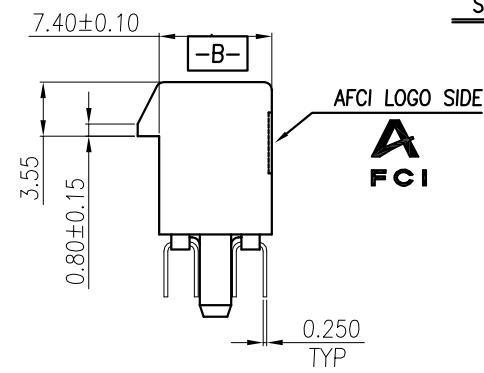
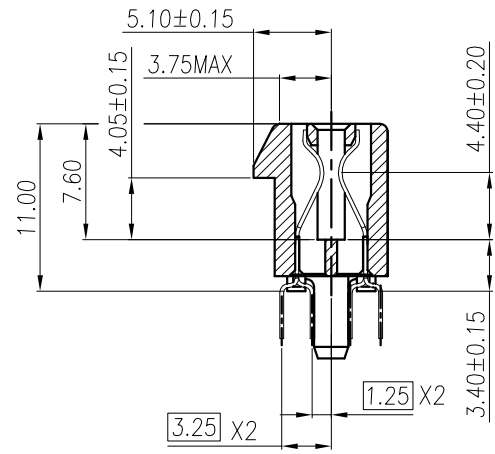
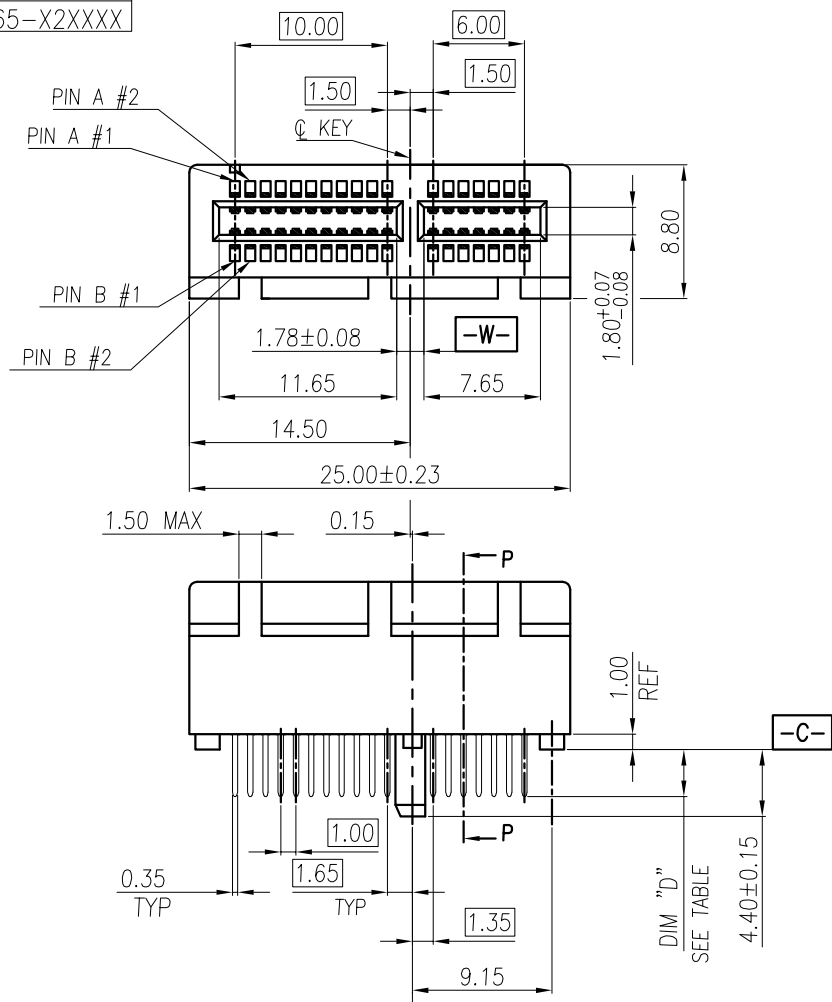

SINGLE PLASTIC PEG TYPE

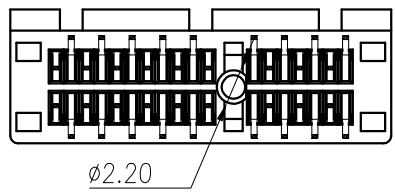

mat'l. code		-		surface	-	tolerance	ASME_Y14.5	projection	product family	PCI_EXPRESS	
ltr	ecn no	dr	date	tolerances unless otherwise specified				MM	title		
				angles	Linear	.02±0.30		scale N/A	PCI_EXPRESS_CARD_EDGE_GEN3 TH_ASS'Y		
				±2'		.00±0.20		Amphenol FCI	dwg no		
				dr	WINSTON_ZHU	2020-06-09			sheet 2 of 6 size		
				enr	ZHENHUA_LIU	2020-06-09			10152065 A4		
				chr					type		
				appd	HEAVEN_CEN	2020-06-09			CUSTOMER Drawing		
sheet index	revision sheet	A									

PRODUCT NO.
10152065-X1XXXX

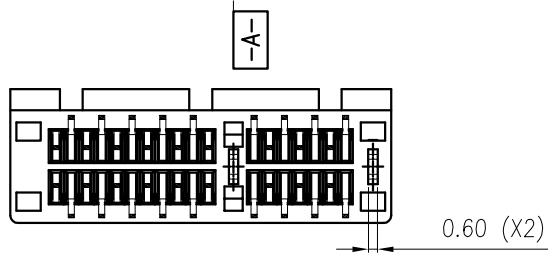
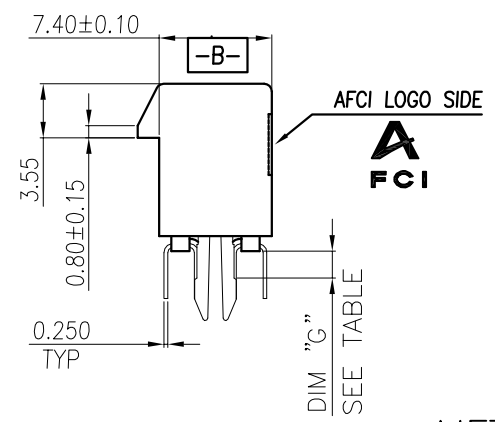
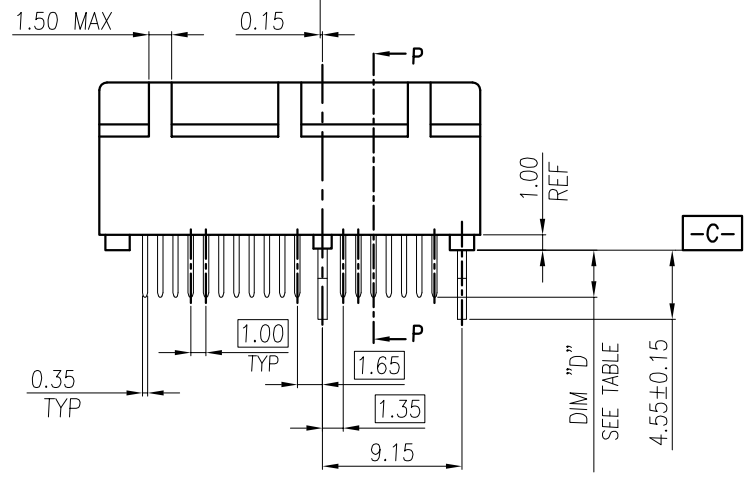
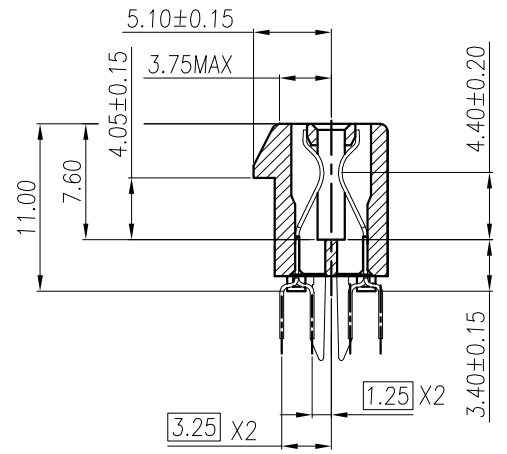
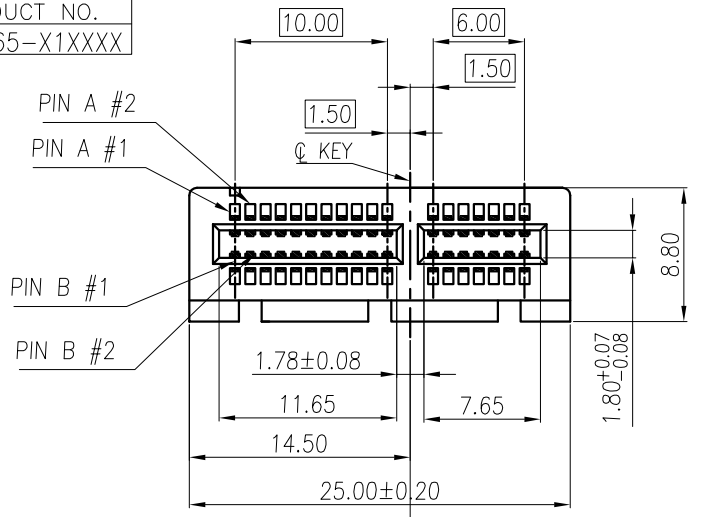

METAL BOARD LOCKS

mat'l. code		surface		tolerance		projection		product family	
-		-		ASME_Y14.5		⊕		PCI_EXPRESS	
ltr		ecn no		dr		date		title	
								PCI_EXPRESS_CARD_EDGE_GEN3	
								TH_ASS'Y	
								sheet 3 of 6 size	
								10152065 A4	
								type CUSTOMER Drawing	
sheet index		revision sheet		A					

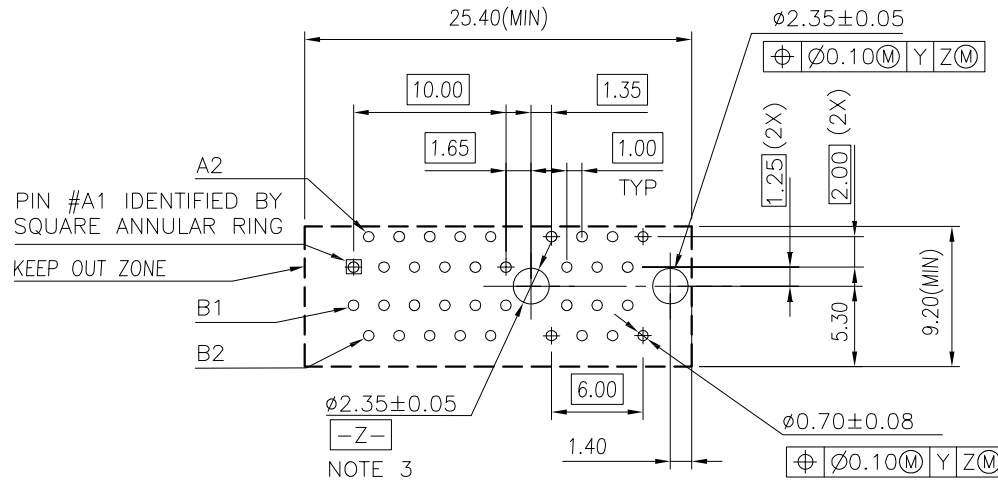

PCB SURFACE
-Y-

← I/O PANEL DIRECTION

RECOMMENDED FOOTPRINT

mat'l. code		-		surface		- ✓		tolerance		ASME_Y14.5		projection		product family		PCI_EXPRESS		
ltr	ecn no	dr	date	tolerances unless otherwise specified								title		PCI_EXPRESS_CARD_EDGE_GEN3				
				angles	line										TH_ASS'Y		5	
				±2'											scale N/A			
		dr	WINSTON_ZHU	2020-06-09	Amphenol		FCI		dwg no		sheet 4 of 6		size					
		enr	ZHENHUA_LIU	2020-06-09					10152065				A4					
		chr							type		CUSTOMER Drawing							
		appd	HEAVEN_CEN	2020-06-09														
sheet index	revision	A																
	sheet																	

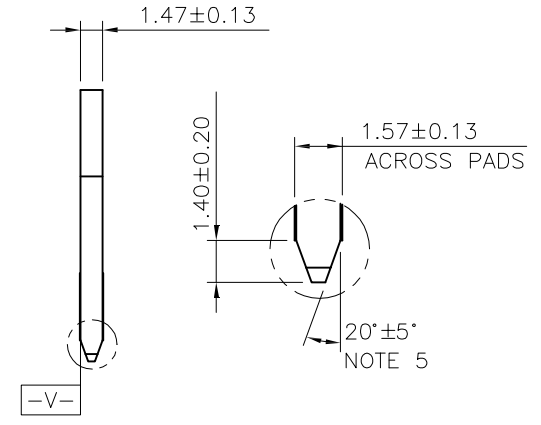
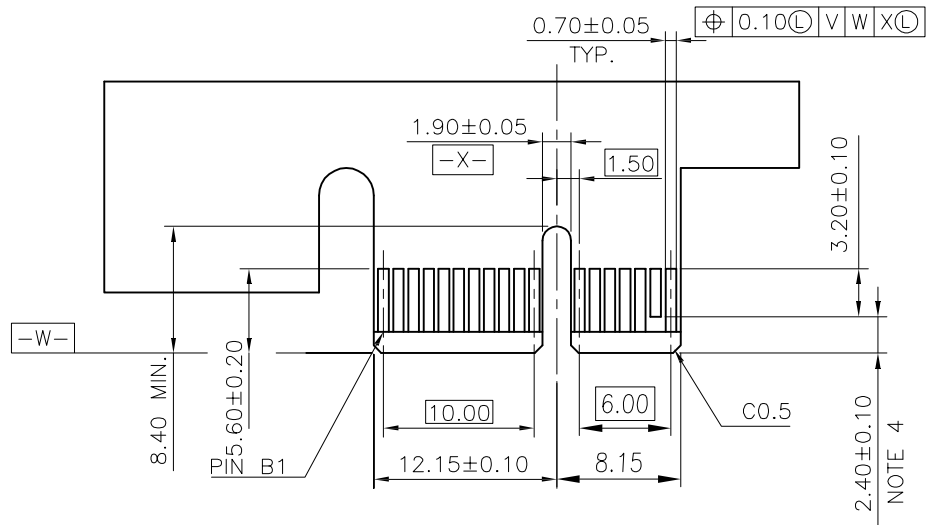

SCALE 2:1

I/O PANEL DIRECTION
PRIMARY (COMPONENT) SIDE

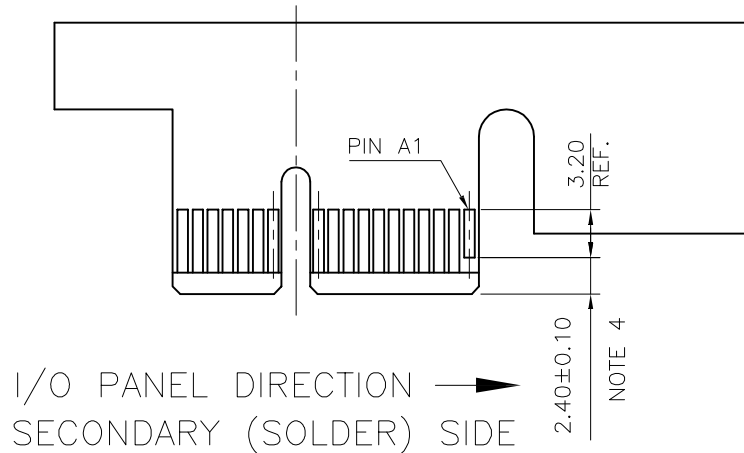

I/O PANEL DIRECTION
SECONDARY (SOLDER) SIDE

ADD-IN CARD EDGE-FINGER DIMENSIONS

mat'l. code		-		surface		- ✓		tolerance		ASME_Y14.5		projection		product family		PCI_EXPRESS	
ltr	ecn no	dr	date	tolerances unless otherwise specified								title		PCI_EXPRESS_CARD_EDGE_GEN3			
				angles	linear	.02±0.30	MM		title		TH_ASS'Y						
				±2'	linear	.00±0.20	scale N/A		dwg no		sheet 5 of 6		size				
				dr	WINSTON_ZHU	2020-06-09	Amphenol FCI		10152065		A4						
				enr	ZHENHUA_LIU	2020-06-09			type		CUSTOMER Drawing						
				chr													
				appd	HEAVEN_CEN	2020-06-09											
sheet index	revision	A															
	sheet																

NOTES:

1.MATERIAL:

HOUSING: HIGH TEMPERATURE NYLON, HF, GLASS FILLED UL94V-0 RATED.
 TERMINAL: COPPER ALLOY.
 PLATING: SEE PRODUCT NUMBER CODE
 METAL BOARD LOCKS: COPPER ALLOY.
 FINISH: 100u" TIN OVER 50u" NICKEL

2.PRODUCT SPECIFICATION: GS-12-233.

③THE HORIZONTAL AXIS FOR THE HOLE PATTERN IS ESTABLISHED BY
 A LINE THROUGH THE CENTER OF THE TWO ϕ 2.35 HOLES.
 THE VERTICAL AXIS IS 90° TO THE HORIZONTAL AXIS, THROUGH THE CENTER
 OF DATUM Z.

④NO TIE BAR PERMITTED FROM CARD EDGE TO LEADING EDGE OF PAD.

⑤CHAMFER EDGES MUST BE FREE OF CUTTING BURRS.

⑥FREQUENCY & LOCATION AT SUPPLIER DISCRETION. RIDGE MAY BE CONTINUOUS WITH NO BREAKS.

7.RoHS COMPATIBLE PRODUCT SPECIFICATIONS:

a - PLATING:

- "LF" MEANS THE PRODUCT IS LEAD-FREE.

b - MANUFACTURING PROCESS COMPATIBILITY:

- THE HOUSING WILL WITHSTAND EXPOSURE TO 260°C PEAK TEMPERATURE FOR 10 SECONDS IN WAVE-SOLDERING APPLICATION,

PRODUCT NUMBER CODE

10152065 -X X X X 0 X LF

HOUSING COLOR OPTIONS

0-NATURAL
 1-BLACK

PEGS OPTIONS

0-PLASTIC PEGS
 1-METAL BOARD LOCKS
 2-SINGLE PLASTIC PEGS

TERMINAL PLATING OPTIONS

0-50u" Ni UNDERPLATE
 30u" Au CONTACT AREA
 100u" TIN TAIL AREA ----- COMPATIBLE RoHS
 1-50u" Ni UNDERPLATE
 15u" Au CONTACT AREA
 100u" TIN TAIL AREA ----- COMPATIBLE RoHS
 2-50u" Ni UNDERPLATE
 GOLD FLASH CONTACT AREA
 100u" TIN TAIL AREA ----- COMPATIBLE RoHS

LEAD FREE

PACKAGING OPTIONS

T-SOFT TRAY PACKAGING
 R-44MM WIDTH TAPE&REEL PACKING

POS OPTIONS

0-36

TAIL LENGTH OPTION

	DIM "D"	PCB THICKNESS	BOARD LOCKS DIM "G"
0	2.30 \pm 0.25	1.56 \pm 0.10	1.70 \pm 0.15
1	3.10 \pm 0.25	2.36 \pm 0.10	2.50 \pm 0.15
2	2.54 \pm 0.25	1.56 \pm 0.10	1.70 \pm 0.15
3	1.90 \pm 0.25	1.56 \pm 0.10	1.70 \pm 0.15

TWIN PLASTIC PEG TYPE

mat'l. code		-		surface	-	tolerance	ASME_Y14.5	projection	product family	PCI_EXPRESS
lfr	ecn no	dr	date	tolerances unless otherwise specified		.02±0.30		MM	title	
				angles	lineal	.00±0.20			PCI_EXPRESS_CARD_EDGE_GEN3	
				±2'		.000±0.10		scale	N/A	
				dr	WINSTON_ZHU	2020-06-09		Amphenol FCI	sheet 6 of 6 size	
				enr	ZHENHUA_LIU	2020-06-09			10152065	
				chr					A4	
				appd	HEAVEN_CEN	2020-06-09		type		CUSTOMER Drawing
sheet index	revision	A								
	sheet									