

THIS COPY IS PROVIDED ON A RESTRICTED BASIS AND IS NOT TO BE USED IN ANY WAY DETRIMENTAL TO THE INTERESTS OF PANDUIT CORP.

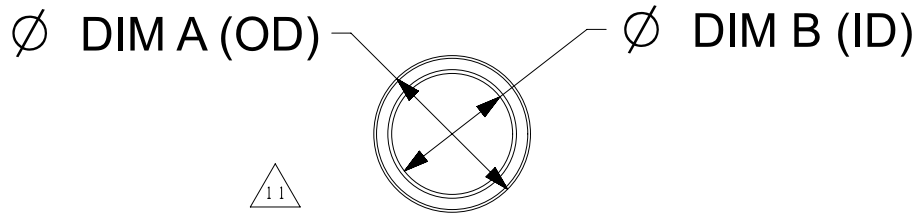

Material: Nylon 6				
SLIT PART NUMBERS	NON-SLIT PART NUMBERS	DIM A Target (OD)	DIM B Target (ID)	Wall Thickness
CLT25N-*	CLTS25N-*	0.378 [9.60]	0.281 [7.14]	.007-.023 [0.18-0.51]
CLT35N-*	CLTS35N-*	0.417 [10.59]	0.323 [8.20]	
CLT38N-*	CLTS38N-*	0.535 [13.59]	0.421 [10.69]	
CLT50N-*	CLTS50N-*	0.675 [17.15]	0.518 [13.16]	
CLT62N-*	CLTS62N-*	0.815 [20.70]	0.665 [16.89]	
CLT75N-*	CLTS75N-*	0.933 [23.70]	0.762 [19.35]	
CLT100N-*	CLTS100N-*	1.114 [28.30]	0.917 [23.29]	.008-.031 [0.20-0.79]
CLT125N-*	CLTS125N-*	1.524 [38.71]	1.303 [33.10]	
CLT150N-*	CLTS150N-*	1.728 [43.89]	1.484 [37.69]	
CLT188N-*	NA	2.157 [54.79]	1.870 [47.50]	

Material: Polyethylene				
SLIT PART NUMBERS	NON-SLIT PART NUMBERS	DIM A Target (OD)	DIM B Target (ID)	Wall Thickness
CLT25F-*	CLTS25F-*	0.378 [9.60]	0.281 [7.14]	.007-.023 [0.18-0.51]
CLT35F-*	CLTS35F-*	0.417 [10.59]	0.323 [8.20]	
CLT38F-*	CLTS38F-*	0.535 [13.59]	0.421 [10.69]	
CLT50F-*	CLTS50F-*	0.675 [17.15]	0.518 [13.16]	
CLT62F-*	CLTS62F-*	0.815 [20.70]	0.665 [16.89]	
CLT75F-*	CLTS75F-*	0.933 [23.70]	0.762 [19.35]	
CLT100F-*	CLTS100F-*	1.114 [28.30]	0.917 [23.29]	.008-.031 [0.20-0.79]
CLT125F-*	CLTS125F-*	1.524 [38.71]	1.303 [33.10]	
CLT150F-*	CLTS150F-*	1.728 [43.89]	1.484 [37.69]	
CLT188F-*	NA	2.157 [54.79]	1.870 [47.50]	



**\* NOTES:**

1. SEE [www.panduit.com](http://www.panduit.com) FOR PART NUMBER SUFFIX DESIGNATION FOR PACKAGE SIZE, PART MATERIAL AND PART COLOR.
2. FOR ROLL SIZES LARGER THAN 10 FEET, SPLICES MAY OCCUR.
3. SLIT PART NUMBERS HAVE ONE CONTINUOUS SLIT ALONG ENTIRE LENGTH TUBING.

TITLE					Slit & Non-slit Corrugated Loom Tubing				
CUSTOMER DRAWING									
ITEM REVISION NAME					G03597BN/02				
DATASET FILE NAME					G03597BN_DC_GB0222BP_11/00A				
UNLESS OTHERWISE SPECIFIED, DIMENSIONAL TOLERANCES ARE: IN (mm)									
.X ± .XXX ± .050 (1.27)									
.XX ± ANGLES ±					MATERIAL: Nylon 6 or Polyethylene				
THIRD ANGLE PROJECTION					DRAWING NUMBER: GB0222BP				
DRAWN BY	DATE	CHK	SCALE						
CPE	9-18-97	VJS	NONE	SHT 1 OF 1					
				SIZE	A				

REV	DATE	BY	CHK	APR	DESCRIPTION	ECN
11	4/2/2020	RVU	DJW	JHAC	REBUILD MODEL AND REDRAWING DRAWING. ADDED NEW TWO TABLE TO INCLUDE SLIT AND NON-SLIT. CHANGED ALL A DIM AND B DIM MEASUREMENTS. UPDATED TITLE AND NOTES.	GAECN05626
10	02.10.15	BDK	VJS	RGRO	E. ADDED DUAL RIB PROFILE AND DETAIL F. REMOVED DENSITY FROM POLYETHYLENE	GB0222BP
09	5/09/14	BWG	VJS	JADE	△ REVISED DIMENSIONS AND WEIGHTS, REMOVED PREVIOUS REVISION BALLONS FOR CLARITY AND UPDATED TITLE BORDER, ADDED * TO PART NUMBERS, REVISED NOTE 1.	GB0222BP/09