

- NOTES:
- 1 RECOMMENDED SPARE PARTS.
 - 2 GREASE LIGHTLY.
 - 3 LUBRICATE DAILY USING NO. 20 MACHINE OIL.
 - 4 GUARD MUST BE IN PLACE WHEN OPERATING APPLICATOR IN AMP-O-ELECTRIC MACHINE.
 - 5. PARTS WITH QTY OF REF SPECIFIED (EXCEPT ITEM 79) ARE USED ON ITEM 46.

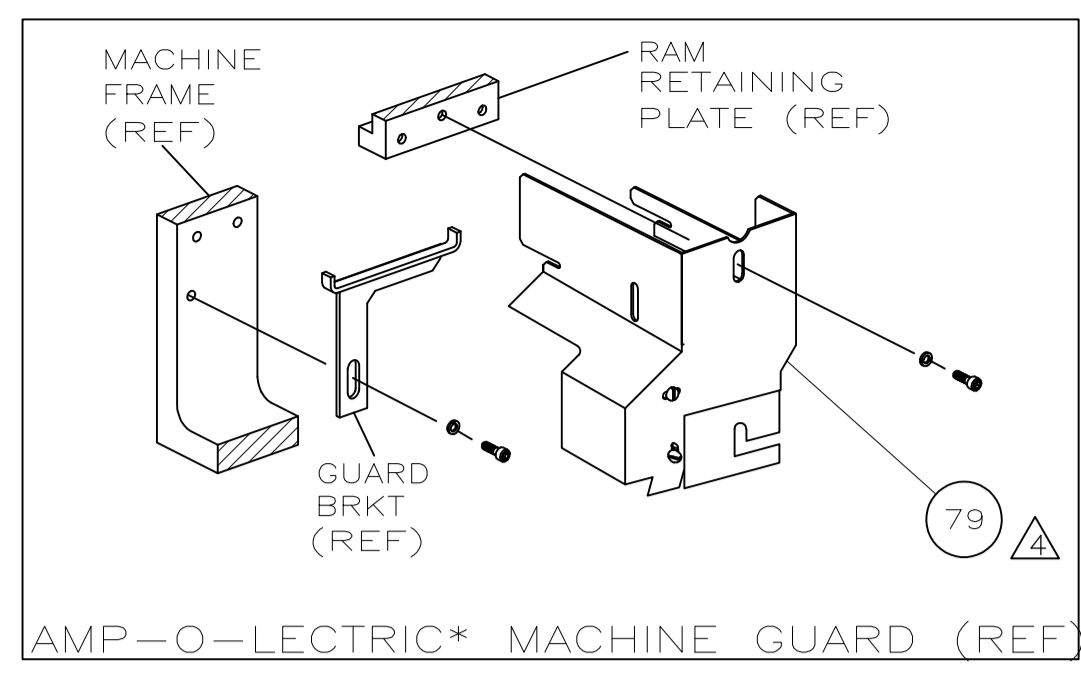
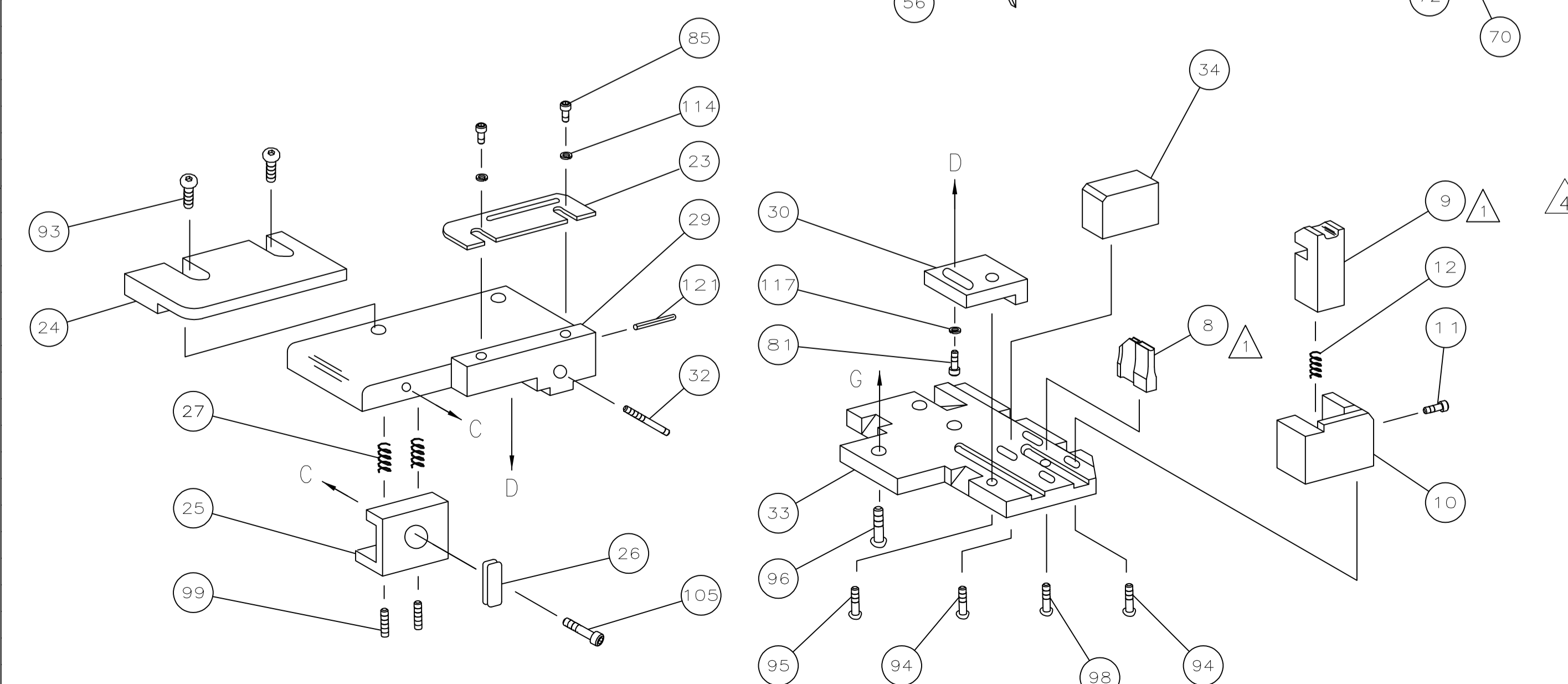

| TERMINAL NAME: | | CRIMPING DATA | | |
|----------------|----------|-------------------|--------------|---------------------|
| | 556135-1 | PAD LTR | CRIMP HEIGHT | WIRE SIZE |
| | 556883-2 | A | .098+.002 | 14 |
| | | B | .091+.002 | 16 |
| | | C | .087+.002 | 18 |
| | | D | NOT USED | |
| | | CRIMP | SIZE | TYPE |
| | | WIRE | .110 | F |
| | | FEED | .730 | |
| | | APPL INST | 408-8040 | SET UP GAGE |
| | | | | 10-1 458637-1 L1410 |
| | | WIRE STRIP LENGTH | - | |
| | | MACHINE NO | 565435-5 | |
| | | TERM APPL SPEC | 114-6044 | |

| REVISONS | | DATE | BY | APPRO |
|----------|---|---------------|---------|-------|
| LOC | A | 66 | | |
| F LTR | G | ECR-07-023780 | 10-2007 | MY TE |

| QTY | PART NO | DESCRIPTION | ITEM NO |
|-----|-----------|------------------------------------|---------|
| | | | 129 |
| | | | 128 |
| | | | 127 |
| | | | 126 |
| | | | 125 |
| REF | 21045-3 | RING,RET "C"(.187φ)FEED FINGER PIN | 124 |
| | | | 123 |
| REF | 5-21028-1 | PIN,SLT SPR(.125φx.50)ADJ ROD | 122 |
| 1 | 4-21028-0 | PIN,SLT SPR(.093φx.75)ST GUIDE PL | 121 |
| REF | 1-21030-1 | PIN,DOWEL(.187φx.50)LEVER | 120 |
| REF | 1-21030-6 | PIN,DOWEL(.187φx1.25)HOUSING | 119 |
| | | | 118 |
| 1 | 21024-5 | WASHER,LOCK(NO.10)ADJ BLOCK | 117 |
| REF | 21024-5 | WASHER,LOCK(NO.10)ADJ PLATE | 116 |
| REF | 21024-5 | WASHER,LOCK(NO.10)FEED GUIDE ROD | 115 |
| 2 | 21024-2 | WASHER,LOCK(NO.4)FRONT STRIP GUIDE | 114 |
| | | | 113 |
| | | | 112 |
| 4 | 21024-4 | WASHER,LOCK(NO.8)STRIPPER | 111 |
| REF | 21899-4 | WASHER,FLAT(5/16 DIA)SCREW ADJ | 110 |
| | | | 109 |
| | | | 108 |
| REF | 21018-5 | NUT,HEX(6-32)FEED ADJ | 107 |
| | | | 106 |
| 1 | 22353-8 | SCR,SHLD(.187φx.25)DRAG LEVER | 105 |
| | | | 104 |
| 1 | 21009-2 | SCR,SKT SET(1/4-20x.25LOC-WEL)RAM | 103 |
| 2 | 21017-2 | SCR,DRIVE(#2x.19)ID PLATE | 102 |
| REF | 6-23715-5 | SCR,PAN HD(6-32x1.50)FEED ADJ | 101 |
| 1 | 461264-1 | PLATE, IDENTIFICATION | 100 |
| 2 | 5-21006-6 | SCR,BHC(10-32x.88)DRAG | 99 |
| 1 | 22733-8 | SCR,BHC(8-32x.38LOC-WEL)ANVIL | 98 |
| REF | 2-21002-9 | SCR,BHC(10-32x.75)CAP | 97 |
| REF | 2-22733-8 | SCR,BHC(1/4-20x.62)HOUSING | 96 |
| REF | 2-21002-7 | SCR,BHC(10-32x.50)SG ADJ BLOCK | 95 |
| 4 | 2-21002-2 | SCR,BHC(8-32x.50)SHEAR | 94 |
| 2 | 2-21002-2 | SCR,BHC(8-32x.50)R STRIP GUIDE | 93 |
| | | | 92 |
| 1 | 1-21002-7 | SCR,BHC(6-32x.38)CAM | 91 |
| | | | 90 |
| | | | 89 |
| | | | 88 |
| 2 | 2-21000-7 | SCR,SKT CAP(8-32x.50)DEP-HOLD DOWN | 87 |
| 1 | 2-22603-0 | SCR,HEX HEAD(8-32x.31)FEED FINGER | 86 |
| 2 | 1-21000-3 | SCR,SKT CAP(4-40x.25)F STRIP GUIDE | 85 |
| 1 | 2-21000-7 | SCR,SKT CAP(8-32x.50)STRIPPER | 84 |
| REF | 3-21000-7 | SCR,SKT CAP(10-32x.75)FEED ROD GD | 83 |
| REF | 3-21000-6 | SCR,SKT CAP(10-32x.62)FEED ADJ BLK | 82 |
| 1 | 3-21000-4 | SCR,SKT CAP(10-32x.38)SG ADJ BL | 81 |
| REF | 3-21000-4 | SCR,SKT CAP(10-32x.38)PIVOT BLOCK | 80 |
| REF | 455755-1 | GUARD, WINDOW | 79 |
| 1 | 21018-5 | NUT, HEX (6-32) | 78 |
| 1 | 811242-2 | SCR,SKT CAP(10-32x.38)SG ADJ BL | 77 |
| | | | 76 |
| | | | 75 |
| 1 | 690603-1 | SPRING, ASSIST | 74 |
| 1 | 23030-1 | SCR,SKT CAP(6-32x.25)CP DISC | 73 |
| REF | 458109-1 | WASHER, SPECIAL | 72 |
| REF | 690517-1 | SPACER | 71 |
| QTY | PART NO | DESCRIPTION | ITEM NO |

| QTY | PART NO | DESCRIPTION | ITEM NO |
|-----|------------|-----------------------------|---------|
| | | | 70 |
| REF | 22594-8 | NUT, HEX | 69 |
| REF | 240628-1 | PLATE, ADJUSTMENT | 68 |
| REF | 240626-1 | SHAFT, PIVOT | 67 |
| REF | 240633-1 | BUSHING | 66 |
| REF | 455680-1 | LEVER, INTERMEDIATE | 65 |
| REF | 240629-1 | BLOCK, PIVOT | 64 |
| REF | 240632-2 | SCREW, ADJUSTMENT FEED ROD | 63 |
| REF | 240659-3 | PIN, CAM ROLLER | 62 |
| REF | 240658-1 | ROLLER, CAM | 61 |
| REF | 454398-2 | ROD, FEED | 60 |
| REF | 454178-1 | GUIDE, FEED ROD | 59 |
| REF | 454220-1 | CAP, HOUSING | 58 |
| REF | 454485-1 | HOUSING | 57 |
| | | | 56 |
| 1 | 458537-2 | PAWL, FEED | 55 |
| REF | 240624-1 | PIN, FEED FINGER | 54 |
| REF | 691499-1 | SPRING, FEED FINGER | 53 |
| REF | 690541-1 | FINGER, FEED | 52 |
| REF | 455679-1 | LEVER, TERMINAL FEED ARM | 51 |
| | | | 50 |
| 1 | 7-21002-9 | BOLT, CRIMPER(5/16-24x1.00) | 49 |
| 1 | 690602-5 | CAM, PRE-FEED 1 1/8 STROKE | 48 |
| | | | 47 |
| 1 | 459456-1 | APPLICATOR, BASIC (SUBASSY) | 46 |
| 1 | 690191-1 | PLUG, NYLON | 45 |
| 1 | 455673-1 | RAM | 44 |
| 1 | 690125-1 | WASHER, LAMINATED | 43 |
| 1 | 690124-1 | WASHER, RAM | 42 |
| 1 | 690223-1 | DISC, SPACER | 41 |
| 1 | 23241-6 | BALL, STEEL | 40 |
| 1 | 690170-1 | SPRING, COMPRESSION | 39 |
| | | | 38 |
| 1 | 1-690141-0 | DISC, WIRE | 37 |
| 1 | 22480-5 | WASHER, SPRING | 36 |
| 1 | 690212-1 | POST, RAM | 35 |
| 1 | 690786-3 | SUPPORT, TERMINAL | 34 |
| REF | 455675-1 | PLATE, BASE | 33 |
| 1 | 690432-3 | SCREW, ADJUSTMENT | 32 |
| | | | 31 |
| REF | 455689-1 | BLOCK, STRIP GUIDE ADJ | 30 |
| 1 | 458144-1 | PLATE, STRIP GUIDE | 29 |
| 1 | 2-455888-5 | SPACER, FRONT SHEAR DEP | 28 |
| 2 | 1-22284-0 | SPRING, DRAG | 27 |
| 1 | 356835-1 | LEVER, DRAG RELEASE | 26 |
| 1 | 240792-1 | DRAG, STOCK | 25 |
| 1 | 9-690504-7 | GUIDE, STRIP (REAR) | 24 |
| 1 | 690438-1 | GUIDE, STRIP (FRONT) | 23 |
| | | | 22 |
| REF | 4-22284-9 | SPRING, FEED RETURN | 21 |
| | | | 20 |
| 1 | 691353-1 | STRIPPER | 19 |
| 1 | 690753-1 | HOLDER, TERMINAL | 18 |
| | | | 17 |
| | | | 16 |
| | | | 15 |
| | | | 14 |
| | | | 13 |
| 1 | 3-22280-3 | SPRING, SHEAR | 12 |
| 1 | 690461-1 | STOP, SHEAR | 11 |
| 1 | 690459-5 | HOLDER, SHEAR (FRONT) | 10 |
| 1 | 454276-8 | SHEAR, FLOAT (FRONT) | 9 |
| 1 | 5-683403-0 | ANVIL | 8 |
| | | | 7 |
| | | | 6 |
| 1 | 1-455889-4 | DEPRESSOR, SHEAR (FRONT) | 5 |
| | | | 4 |
| | | | 3 |
| | | | 2 |
| 1 | 456411-2 | CRIMPER, WIRE | 1 |
| QTY | PART NO | DESCRIPTION | ITEM NO |

* Trademark of AMP Incorporated

THIS DRAWING IS A CONTROLLED DOCUMENT.

| | | | |
|--------------------|--|-----------------------|---|
| DIMENSIONS: INCHES | TOLERANCES UNLESS OTHERWISE SPECIFIED: | DIN D. SALTZER 6-3-97 | By Tyco Electronics Corporation Harrisburg, PA 17105-3608 |
| 0 PLC ± .005 | 1 PLC ± .002 | 6-3-97 | |
| 1 PLC ± .002 | 2 PLC ± .001 | | |
| 2 PLC ± .001 | 3 PLC ± .0005 | | |
| 3 PLC ± .0005 | 4 PLC ± .0002 | | |
| 4 PLC ± .0002 | ANGLES ± .005 | | |
| MATERIAL | FINISH | APPRO T. ELBIN 6-3-97 | NAME |
| | | | MINIATURE QUICK CHANGE APPLICATOR SIDE FEED (INERGY) |
| | | APPLICATION SPEC | SIZE CASE CODE DRAWING NO |
| | | WEIGHT F | A1 00779 C=567403-2 |
| | | CUSTOMER DRAWING | RESTRICTED TO |
| | | SCALE | SHEET 1 of 1 REV G |